

NO.	STATION	DESCRIPTION
WM-F12	10+12	12" D.I. 22-1/2" BEND
WM-F13	10+18	12" X 12" D.I. TEE
WM-F14	10+18	12" D.I. SOLID SLEEVE (NON-PRESSURE CONNECTION)
WM-F15	10+27	12" D.I. SOLID SLEEVE (NON-PRESSURE CONNECTION)
WM-F16	10+27	12" X 12" D.I. TEE
WM-F17	10+32	12" D.I. 22-1/2" BEND
WM-F18	10+65	12" X 6" D.I. TEE
WM-F19	13+30	12" D.I. 45° BEND
WM-F20	13+76	12" D.I. 45° BEND
WM-F21	14+20	12" D.I. SOLID SLEEVE (NON-PRESSURE CONNECTION)

NO.	STATION	DESCRIPTION
WM-V4	10+19	12" D.I. GATE VALVE W/5' DIAMETER VALVE VAULT
WM-V5	10+39	12" D.I. GATE VALVE W/5' DIAMETER VALVE VAULT
WM-V6	14+20	12" D.I. GATE VALVE W/5' DIAMETER VALVE VAULT

NO.	LENGTH	DESCRIPTION
WM-P4	136 LF	12" D.I. R.T.
WM-P5	402 LF	12" D.I. R.T.

NO.	STATION	DESCRIPTION
WM-FH1	10+65	HYDRANT W/AUXILIARY VALVE W/21 LF OF ADDITIONAL LEADER PIPE (RJT)

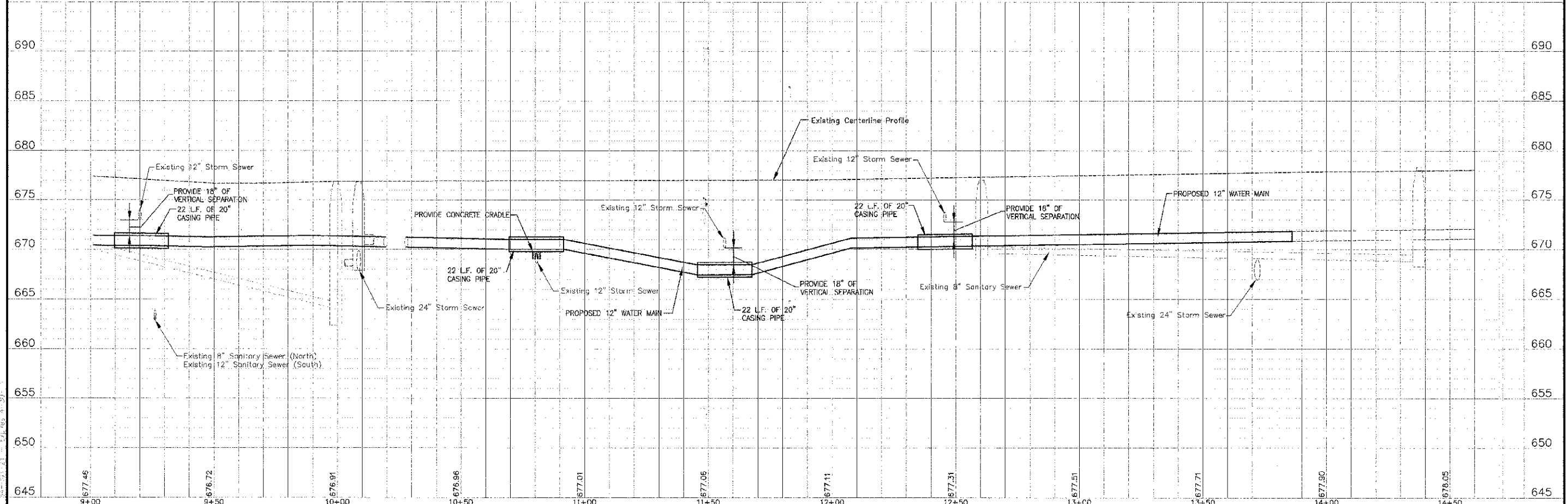

12" D.I. WATER MAIN REPLACEMENT PLAN AND PROFILE
 PROJECT NO. 10-00067-00-RS
 SHEET NO. 37 OF 38
 DATE: 06-18-12
 DESIGNED: ALP
 DRAWN: VSB
 CHECKED: LDH
 DATE: 06-18-12

STATE OF ILLINOIS DEPARTMENT OF TRANSPORTATION	WATER MAIN REPLACEMENT PLAN AND PROFILE GREEN STREET	F.A.L. NO. 3537 SECTION 10-00067-00-RS COUNTY ILLINOIS TOTAL SHEETS 38 SHEET NO. 37 CONTRACT NO. 63759
SCALE: HOR. 1" = 20' / VERT. 1" = 5' PROJECT NO: 100067 STA. 9+00 TO STA. 14+50		FEDERAL ROAD DIST. NO. ILLINOIS FED. AID PROJECT