

WATER MAIN FITTINGS		
NO.	STATION	DESCRIPTION
WM-F36	39+46	12" X 6" D.I. TEE
WM-F37	39+72	12" X 6" D.I. TEE
WM-F38	39+72	6" D.I. 45° BEND
WM-F39	39+72	6" D.I. 45° BEND (NON-PRESSURE CONNECTION)
WM-F40	40+24	12" D.I. 45° BEND
WM-F41	40+29	12" D.I. 45° BEND
WM-F42	40+57	12" D.I. 45° BEND
WM-F43	40+61	12" D.I. 45° BEND
WM-F43A	40+65	12" X 6" D.I. TEE
WM-F44	40+75	12" X 12" D.I. TEE
WM-F45	40+75	12" D.I. CAP
WM-F46	40+90	12" D.I. 45° BEND
WM-F47	40+94	12" X 10" D.I. REDUCER
WM-F48	40+97	10" D.I. 45° BEND (NON-PRESSURE CONNECTION)

WATER MAIN PIPES		
NO.	LENGTH	DESCRIPTION
WM-P13	240 LF	12" D.I. RJT
WM-P14	241 F	6" D.I. RJT

VALVE VAULTS		
NO.	STATION	DESCRIPTION
WM-V13	39+72	6" D.I. GATE VALVE W/6" DIAMETER VALVE VAULT
WM-V14	40+70	12" D.I. GATE VALVE W/6" DIAMETER VALVE VAULT

WATER MAIN FIRE HYDRANTS		
NO.	STATION	DESCRIPTION
WM-FH3	39+46	HYDRANT W/AUXILIARY VALVE W/8 LF OF ADDITIONAL LEADER PIPE (RJT)
WM-FH3A	40+65	HYDRANT W/AUXILIARY VALVE W/7 LF OF ADDITIONAL LEADER PIPE (RJT)

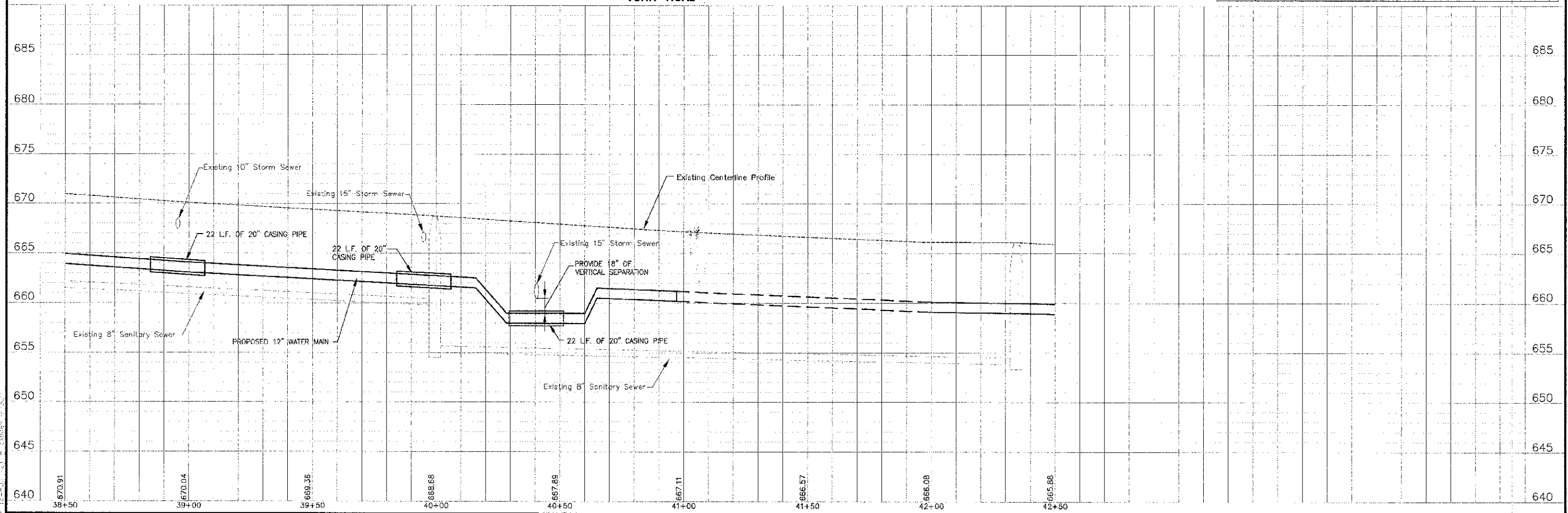

	DESIGNED - ALP	REVISD - DOT REVIEW 12-12-12	STATE OF ILLINOIS DEPARTMENT OF TRANSPORTATION	WATER MAIN REPLACEMENT PLAN AND PROFILE YORK ROAD		F.A.U. NO. 3233	SECTION 0-COC27-00-RS	COUNTY DUPAGE	TOTAL SHEETS 37	SHEET NO. 7
	DRAWN - MSB CHECKED - LCH DATE - 06-18-12	REVISD - REVISD - REVISD - REVISD -		SCALE: HORIZ. 1"=20' / VERT. 1"=5' PROJECT NO. 12-058 STA. 38+50 TO STA. 42+50	FED. ROAD DIST. NO. 1 ILLINOIS FED. AID PROJECT	CONTRACT NO. 85759				

PROJECT NO. 12-058 - YORK ROAD WATER MAIN REPLACEMENT PLAN AND PROFILE
 DRAWN BY: MSB
 CHECKED BY: LCH
 DATE: 06-18-12