

QUANTITY  
 4 (100) LINE = 64.1 ft. (19.7 m)  
 21.1 sq. ft. (1.97 sq. m)

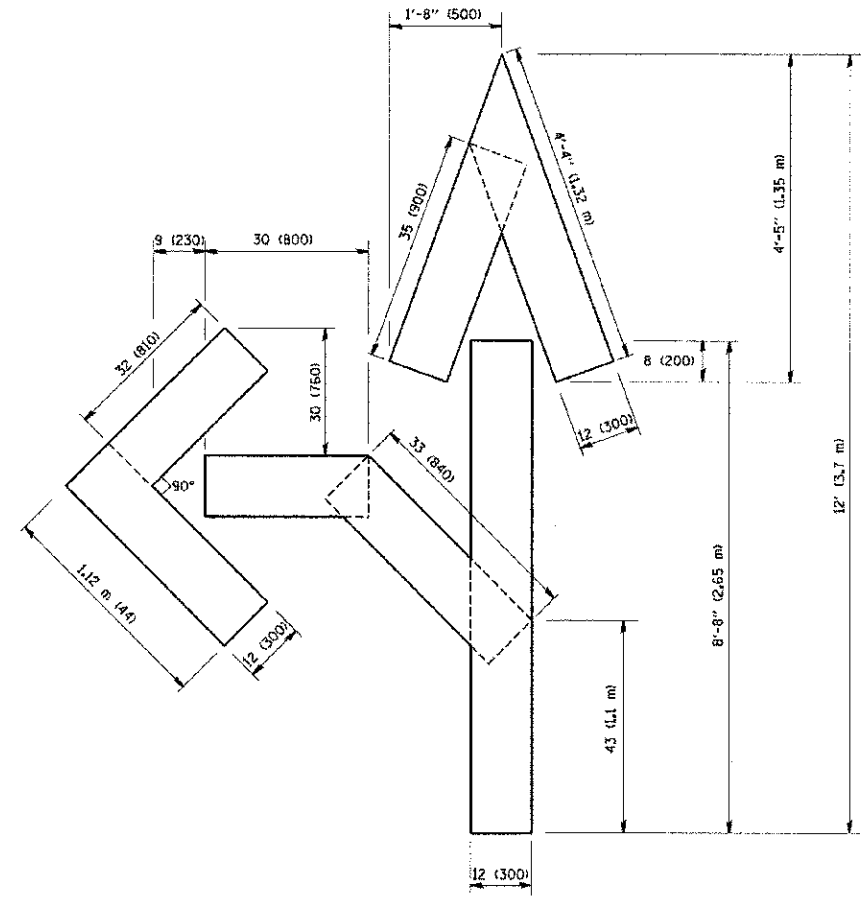

QUANTITY  
 4 (100) LINE = 82.5 ft. (25.3 m)  
 27.5 sq. ft. (2.53 sq. m)

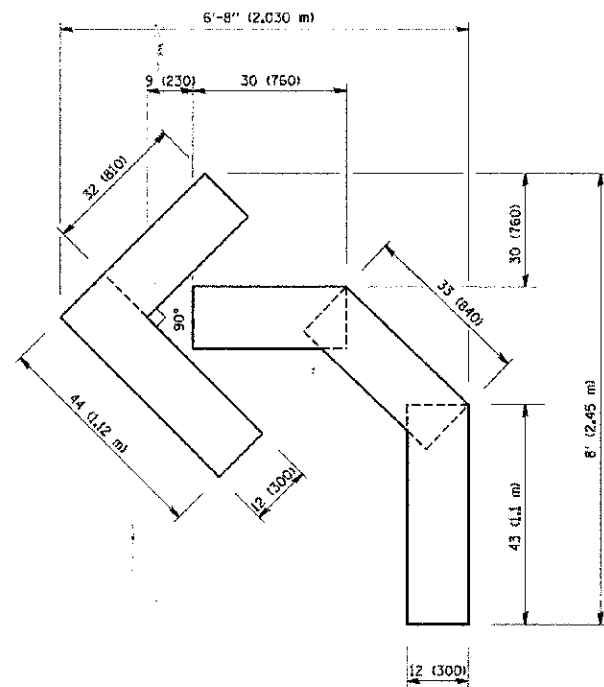

QUANTITY  
 4 (100) LINE = 45.5 ft. (13.9 m)  
 15.2 sq. ft. (1.39 sq. m)

All dimensions are in inches (millimeters) unless otherwise shown.

COMPANY: SCILBY BAXTER & WOODMAN, INC.  
 STATE OF ILLINOIS - PROFESSIONAL ENGINEERING FIRM  
 LICENSE NO. 084 00072 EXPRES 4/30/2010  
 3711/010  
 PROJECT: ILLINOIS STATE ROAD DISTRICT NO. 1 (ILLINOIS) FED. AID PROJECT  
 FILE NAME: W:\projects\22x34\16.dgn  
 USER NAME: gajlanobit  
 DESIGNED: -  
 DRAWN: -  
 CHECKED: -  
 DATE: 09-18-94  
 REVISED: -T. RAMMACHER 06-05-96  
 REVISED: -T. RAMMACHER 11-04-97  
 REVISED: -T. RAMMACHER 03-02-98  
 REVISED: -E. GOMEZ 08-28-00  
 PLOT SCALE: 80.0000 / IN.  
 PLOT DATE: 1/4/2008  
 STATE OF ILLINOIS - PROFESSIONAL ENGINEERING FIRM  
 LICENSE NO. 084 00072 EXPRES 4/30/2010  
 3711/010

FILE NAME: W:\projects\22x34\16.dgn	USER NAME: gajlanobit	DESIGNED: -	REVISED: -T. RAMMACHER 06-05-96	<b>STATE OF ILLINOIS DEPARTMENT OF TRANSPORTATION</b>	<b>PAVEMENT MARKING LETTERS AND SYMBOLS FOR TRAFFIC STAGING</b>		F.A.U. RTE. 3533	SECTION 10-00087-00-RS	COUNTY DEPAGE	TOTAL SHEETS 37	SHEET NO. 32
		DRAWN: -	REVISED: -T. RAMMACHER 11-04-97		SCALE: NONE	SHEET NO. 1 OF 1 SHEETS	STA. TO STA.	<b>TC-16</b>		CONTRACT NO. 63753	
		CHECKED: -	REVISED: -T. RAMMACHER 03-02-98								
		DATE: 09-18-94	REVISED: -E. GOMEZ 08-28-00								