

**STAGE 2a CONSTRUCTION**

**LEGEND**

- CONSTRUCTION WORK ZONE
- DIRECTION OF TRAFFIC FLOW

1. WORK DURING THIS STAGE SHALL CONSIST OF THE REMOVAL AND REPLACEMENT OF UTILITIES AND ROADWAY AS INDICATED ON THE PROPOSED PAVEMENT AND UTILITY PLANS ALONG WEST SIDE OF ELM ST.
2. ALL THE PRIVATE AND COMMERCIAL DRIVEWAYS TO BE OPENED ALL THE TIME FOR TRAFFIC OR AS DIRECTED BY THE ENGINEER AND AS PAID FOR AS TEMPORARY ACCESS (PRIVATE ENTRANCE).
3. IDOT STANDARD 701501-05 SHALL BE USED TO ESTABLISH TRAFFIC CONTROL AND PROTECTION NECESSARY FOR SAW CUTTING, THE REMOVAL OF EXISTING PAVEMENT, EARTH EXCAVATION AS NECESSARY AND PERFORMING ALL THE PROPOSED PAVEMENT WORK ALONG WEST SIDE OF ELM ST.
4. INTERSECTIONS ARE TO REMAIN OPEN AT ALL TIMES, PAID FOR AS AGGREGATE FOR TEMPORARY ACCESS, EXCEPT FOR PREPARATION, POURING AND CURING OF NEW PAVEMENT. THE CONTRACTOR MUST STAGGER INTERSECTIONS THAT ARE CLOSED SUCH THAT NO TWO INTERSECTIONS ADJACENT TO EACH OTHER ARE CLOSED AT THE SAME TIME.

NOTE:  
ONE WAY (R6-1) SIGNS ARE REQUIRED  
IN FRONT OF ALL DRIVEWAYS AS SHOWN

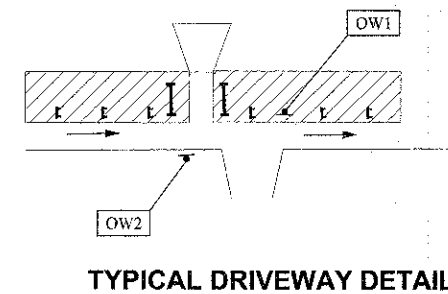

**TYPICAL DRIVEWAY DETAIL**

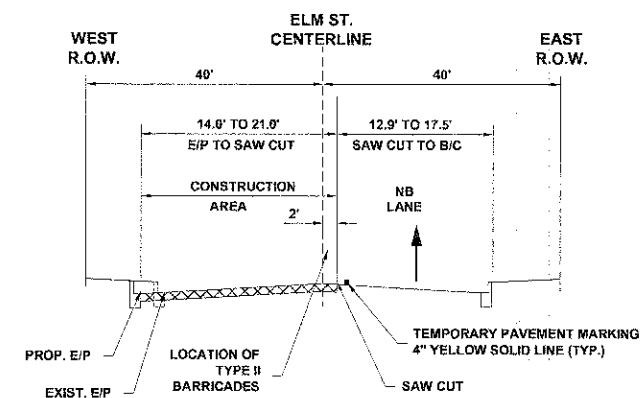

**STAGE 2a CONSTRUCTION  
TYPICAL SECTION**

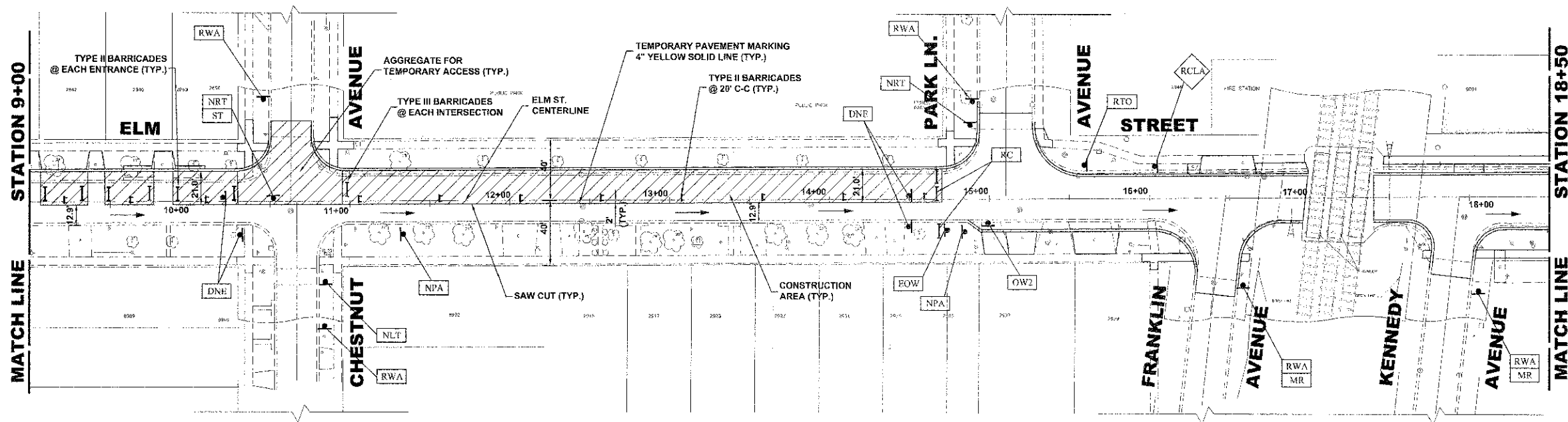

♦ Civil Engineers  
 ♦ Municipal Consultants  
 ♦ Established 1911

9953 Reynolds Road  
 Winchester, Illinois 61894-4789  
 Phone: 708.985.4300  
 Fax: 708.985.1212

DESIGNED - CB/SBC  
 DRAWN - ECW, MK, DMM  
 CHECKED - MDL  
 DATE - 12-7-12

REVISED -  
 REVISED -  
 REVISED -  
 REVISED -

**STATE OF ILLINOIS  
 DEPARTMENT OF TRANSPORTATION**

**MAINTENANCE OF TRAFFIC PLAN  
 STAGE 2a CONSTRUCTION**

SCALE: 1" = 40'    SHEET NO. 1 OF 2 SHEETS    STA. 1+00    TO STA. 18+50

F.A.J. RTE.	SECTION	COUNTY	TOTAL SHEETS	SHEET NO.
1260	12-09097-00-PV	COOK	56	24
FIELD BOOK NO. : X		CONTRACT NO. 63771		
FED. ROAD DIST. NO. 1    ILLINOIS    FED. AID PROJECT				