

NOTES:
 1) ALL DRIVEWAYS NOT DESIGNATED TO BE REPLACED WITH PCC PAVEMENT OR HMA PAVEMENT SHALL BE REPLACED WITH AGGREGATE SURFACE COURSE, TYPE B

STRUCTURE REPAIR SCHEDULE

NUMBER	STRUCTURE TYPE	REMOVAL OF FRAME & RINGS	REMOVAL OF PIPE AT 15TH WALL	CLEAN OUT	REMOVE & REPLACE STRUCTURE	CONVENTIONAL USER	RELOCATE EXISTING STRUCTURE	ADJUST FRAME ELEVATION	REMOVE & REPLACE ALL RINGS	REMOVE & REPLACE FRAME AND COVER	REMARKS
1	4" P.C. CB								X		SEE NOTE 3.
2	4" P.C. WWV								X		SEE NOTE 3.
3	4" P.C. WWV								X		SEE NOTE 3.
4	6" P.C. WWV								X		DETERMINE IN FIELD NO. OF ADJ. RINGS & NOTIFY ENGINEER; SEE NOTE 3.
5	4" BLOCK CB				X					X	REPLACE WITH 4" P.C. CB WITH INSIDE TRAP; SEE NOTES 2 & 3.
6	WWV (COULD NOT OPEN)								X	X	DETERMINE IN FIELD NO. OF ADJ. RINGS & NOTIFY ENGINEER FOR FRAME TYPE; SEE NOTE 3.
7	4" P.C. CB								X		SEE NOTE 3.
8	36" BLOCK CB				X					X	REPLACE WITH 2" P.C. CB; SEE NOTES 2 & 3.
9	4" P.C. & 4" P.C. WWV						X			X	REMOVE TOP 2" OF BRICK; REPLACE WITH P.C. 36"x24" FLAT-BOTTOM OFFSET CONE; SEE NOTES 1 & 3.
10	8" VERTICAL PIPE W/FRAME				X					X	REPLACE WITH 2" P.C. CB WITH INSIDE TRAP; SEE NOTES 2 & 3.
11	6" P.C. WWV								X	X	SEE NOTES 1 & 3.
12	6" P.C. WWV								X		SEE NOTE 3.
13	36" BLOCK CB				X					X	REPLACE WITH 2" P.C. INL; SEE NOTES 2 & 3.
14	36" BLOCK CB				X					X	REPLACE WITH 4" P.C. CB WITH INSIDE TRAP; SEE NOTES 2 & 3.
15	4" BLOCK CB				X					X	REPLACE WITH 4" P.C. CB; SEE NOTES 2 & 3.
16	4" P.C. CB								X		SEE NOTE 3.
17	P.C. WWV								X	X	SEE NOTES 3 & 3.
18	4" P.C. CB	X							X	X	DETERMINE IN FIELD NO. OF ADJ. RINGS & NOTIFY ENGINEER FOR FRAME TYPE; SEE NOTE 3.
19	4" P.C. CB				X					X	REPLACE WITH 4" P.C. CB; SEE NOTES 2 & 3.

- NOTES:
 1) REMOVE EXISTING FRAME AND FURNISH AND INSTALL A NEW TYPE 1 FRAME AND GASKETED CLOSED LID, OR AS DIRECTED BY ENGINEER
 2) REMOVE EXISTING FRAME AND FURNISH AND INSTALL A NEW TYPE 1 FRAME AND OPEN LID, OR AS DIRECTED BY ENGINEER
 3) STRUCTURES WITHIN PAVED AREAS WHERE NO ADJUSTMENT RINGS, FRAME, OR FRAME ADJUSTMENTS (OR OTHER STRUCTURED NOTED IN THE ABOVE CHART) ARE NEEDED ARE TO BE MODIFIED TO INSTALL RUBBERIZED ADJUSTMENT RINGS. MAXIMUM ADJUSTMENT FOR RUBBER RINGS TO BE 3". ADDITIONAL ADJUSTMENTS IN HEIGHT SHALL BE MADE WITH PCC RINGS FOR A TOTAL HEIGHT ADJUSTMENT OF 6-INCHES.
 4) REMOVE EXISTING FRAME AND FURNISH AND INSTALL A NEW TYPE 1 FRAME AND GASKETED CLOSED LID, OR AS DIRECTED BY ENGINEER
 5) REMOVE EXISTING FRAME AND FURNISH AND INSTALL A NEW TYPE 1 FRAME AND GASKETED CLOSED LID, OR AS DIRECTED BY ENGINEER
 6) REMOVE EXISTING FRAME AND FURNISH AND INSTALL A NEW TYPE 1 FRAME AND GASKETED CLOSED LID, OR AS DIRECTED BY ENGINEER

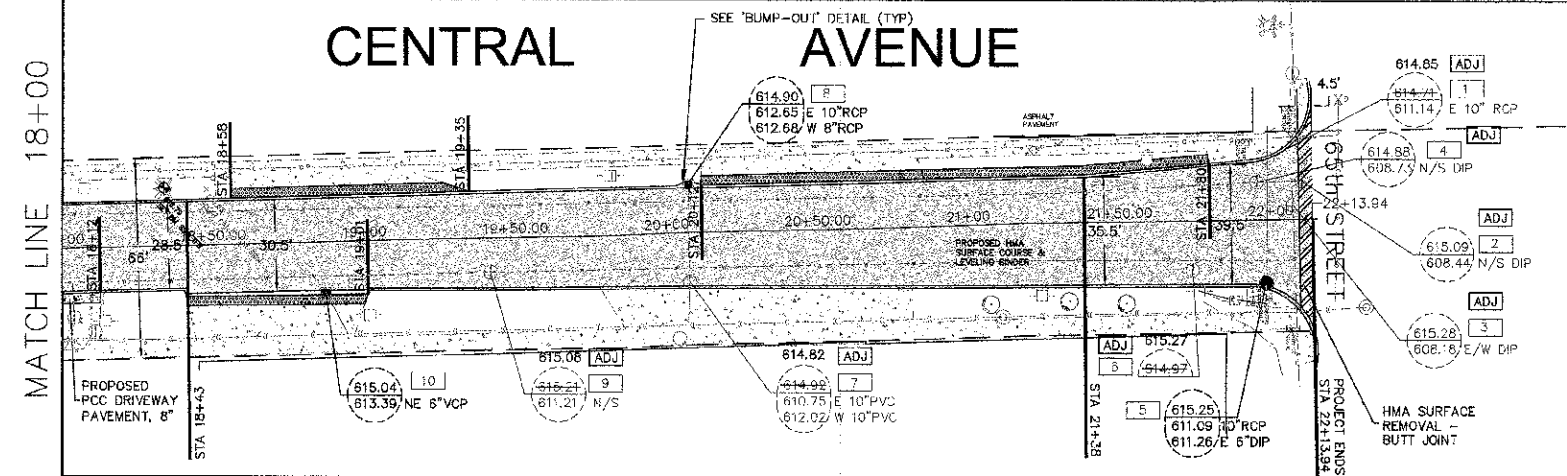
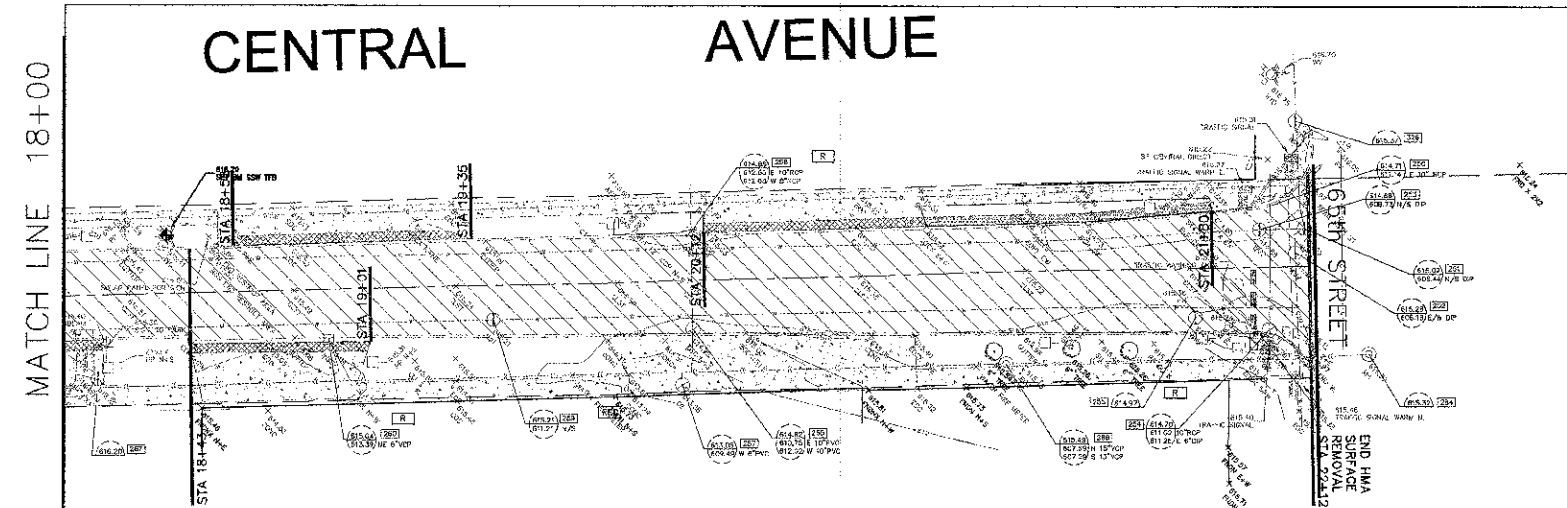

LEGEND

- PROPOSED AGGREGATE SURFACE COURSE, TYPE B
- PROPOSED PCC DRIVEWAY
- PROPOSED HMA SURFACE
- HMA SURFACE REMOVAL
- DRIVEWAY PAVEMENT REMOVAL
- SURFACE REMOVAL - BUTT-JOINT

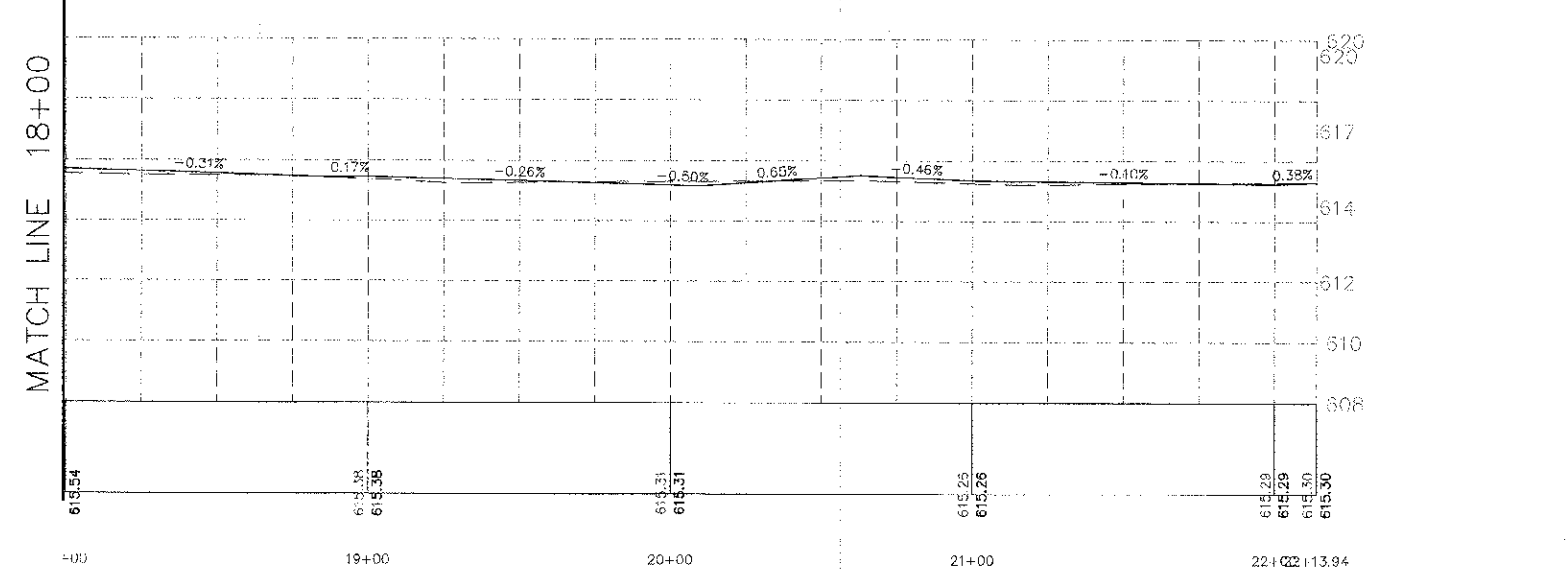
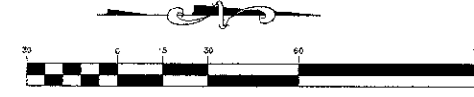

CENTRAL AVENUE STA 10+00 TO STA 22+12	DRAWN BY: JMH	REVISED: _____	STATE OF ILLINOIS DEPARTMENT OF TRANSPORTATION	CENTRAL AVENUE STA 18+00 TO STA 22+12 PLAN SHEET	FAU RTE	SECTION	COUNTY	TOTAL SHEETS	SHEET NO.
	CHECKED BY: SAL	REVISED: _____			FAP RT 366	12-00036-00-RS	COOK	12	6
	DATE: 12.03.12	REVISED: _____			CONTRACT No. 63790				
	REVISED: _____	REVISED: _____			FED. ROAD DIST. NO.	ILLINOIS	FED. AID PROJECT		
				SCALE: H:1"=30' V:1"=3'	SHEET No. 6 OF 12 SHEETS				