

PLAN	SURVEYED	DATE
	PLOTTED	
	CHECKED	
	BY	
	NO. 8008	
	RT. OF WAY CHECKED	
	PAID FILE NAME	

PROFILE	SURVEYED	DATE
	PLOTTED	
	CHECKED	
	BY	
	NO. 8008	
	RT. OF WAY CHECKED	
	PAID FILE NAME	

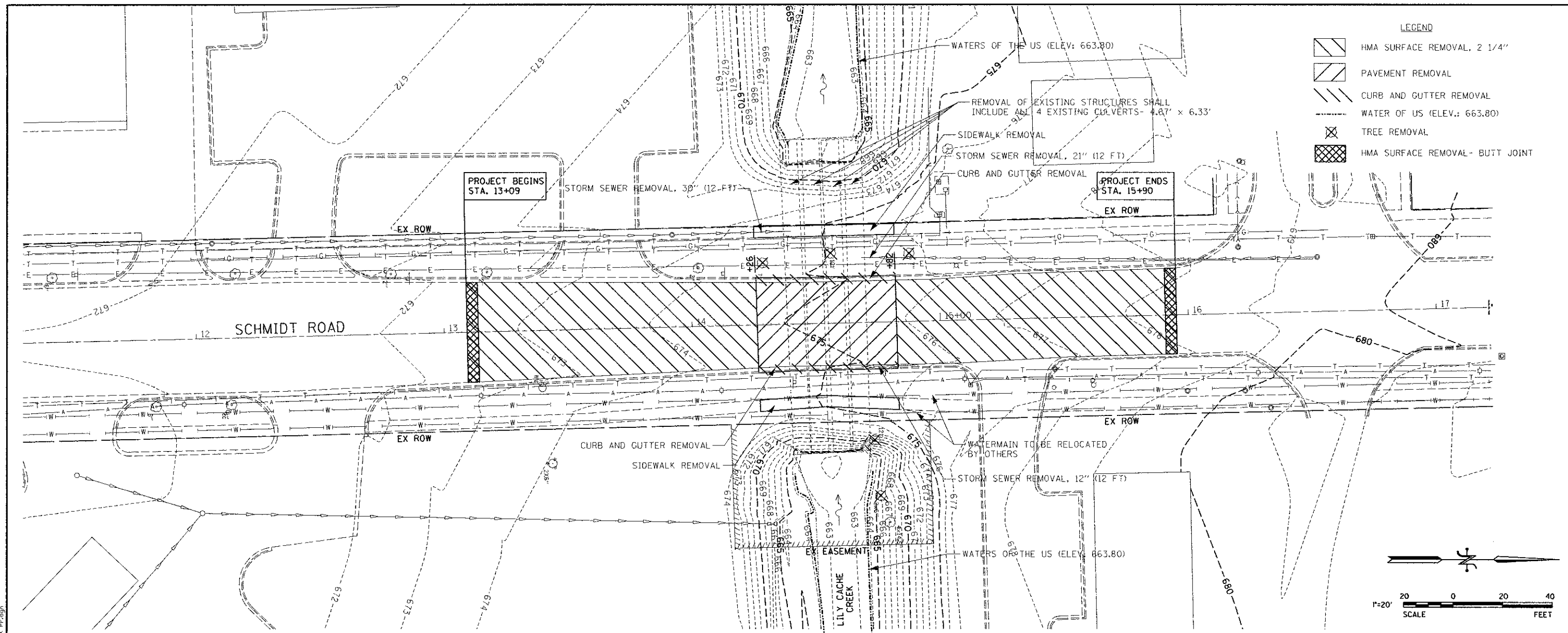

LEGEND

	HMA SURFACE REMOVAL, 2 1/4"
	PAVEMENT REMOVAL
	CURB AND GUTTER REMOVAL
	WATER OF US (ELEV.: 663.80)
	TREE REMOVAL
	HMA SURFACE REMOVAL - BUTT JOINT

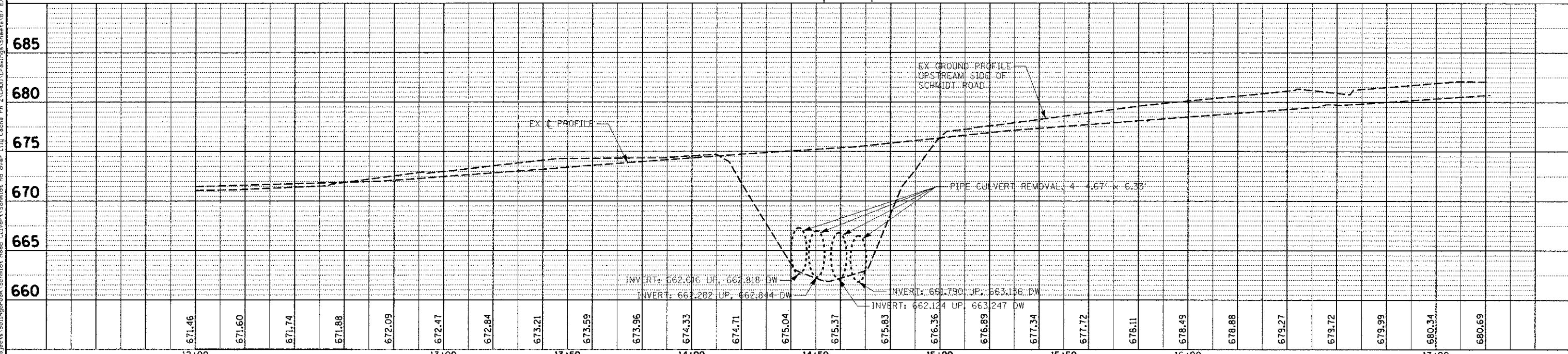
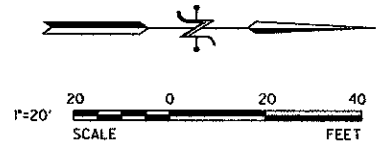

PRINTED DATE: 2/1/2013
 FILE NAME: K:\Projects\Bellevue\Bellevue\Schmidt Road Culvert\Schmidt Rd over Lily Cache Cr. 2\CA000\Overseas\Sheets\07 EX PP.dgn



USER NAME = #USER#	DESIGNED -	REVISED -
PLLOT SCALE = 20,000 / IN.	DRAWN -	REVISED -
PLLOT DATE = 2/1/2013	CHECKED -	REVISED -
	DATE -	REVISED -

STATE OF ILLINOIS
 DEPARTMENT OF TRANSPORTATION

EXISTING REMOVAL PLAN

F.A.V. RTE 2571	SECTION 09-0533-00BR	COUNTY WILL	TOTAL SHEETS 25	SHEET NO 7
CONTRACT NO				
ILLINOIS FEDERAL AID PROJECT				