

SECTION B-B
CONCRETE COLLAR

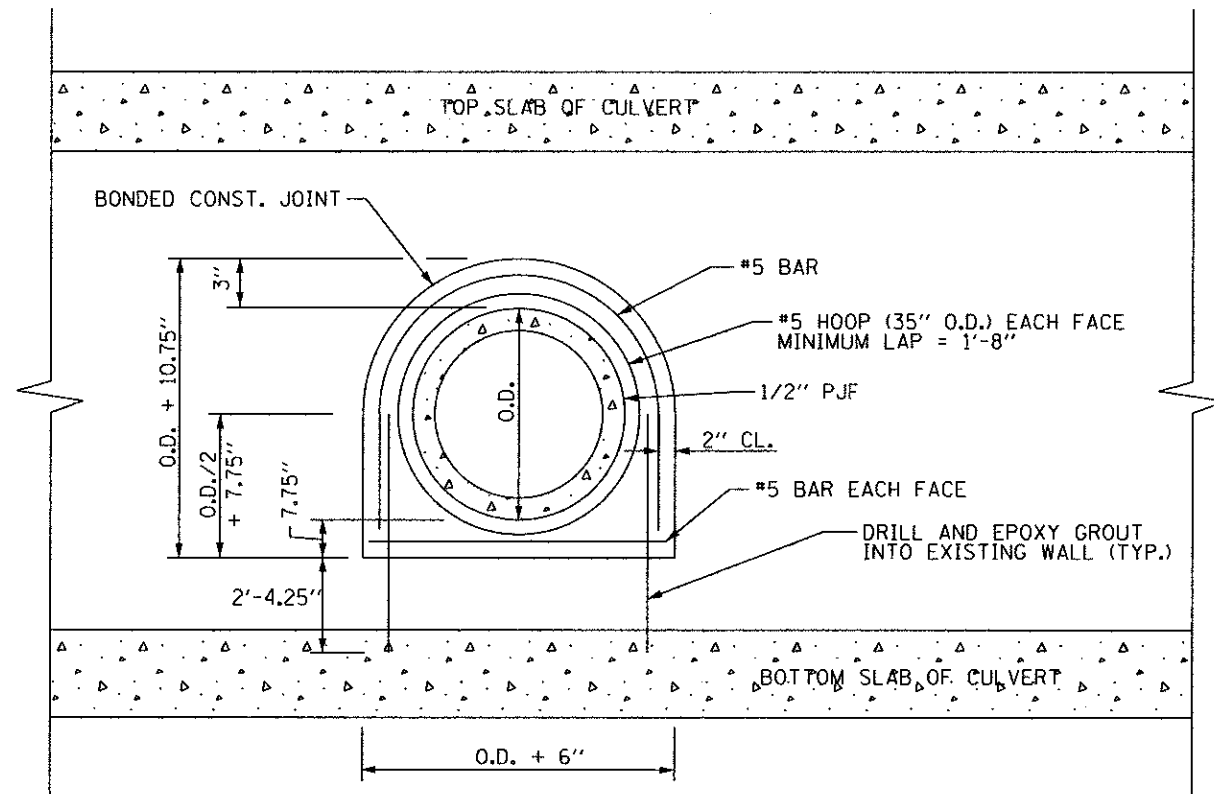

SECTION A-A
EXISTING BOX CULVERT

CONCRETE COLLAR
TOTAL BILL OF MATERIALS

ITEM	UNITS	TOTAL
CONCRETE COLLAR	CU. YD.	3.21
REINFORCEMENT BARS, EPOXY COATED	POUNDS	580
3/4" DIA. EXPANSION (HOOK) BOLTS	EACH	18
CONCRETE REMOVAL	CU. YD.	0.76

NOTE:

EXCAVATION AND BACKFILL IS INCLUDED IN THE COST OF EARTH EXCAVATION.

EXPANSION BOLTS SHALL BE 3/4" DIA. HOOK BOLTS. HOOK BOLTS SHALL EXTEND A MINIMUM OF 9" INTO NEW CONCRETE.

FINAL INVERT ELEVATION WILL BE DETERMINED IN THE FIELD BY THE ENGINEER.

PRINTED DATE: 1/31/2013
FILE NAME: N:\Projects\A6\Longbrook\Schmidt_Road_Culvert\Schmidt_Rd_Over_Lily_Catch_Pi_2\CAD\Drawings\Sheets\03_Schmidt_Collar.dgn



USER NAME = #USER#
PLOT SCALE = 0.10000 1" = 10'
PLOT DATE = 1/31/2013

DESIGNED -
CHECKED -
DRAWN -
CHECKED -
REVISED -
REVISED -
REVISED -
REVISED -

STATE OF ILLINOIS
DEPARTMENT OF TRANSPORTATION

CONCRETE COLLAR DETAILS

F.A.U. RTE.	SECTION	COUNTY	TOTAL SHEETS	SHEET NO.
2571	09-00053-00-BR	WILL	25	17
ILLINOIS FED. AID PROJECT			CONTRACT NO. 63797	