

EXISTING CONDITIONS

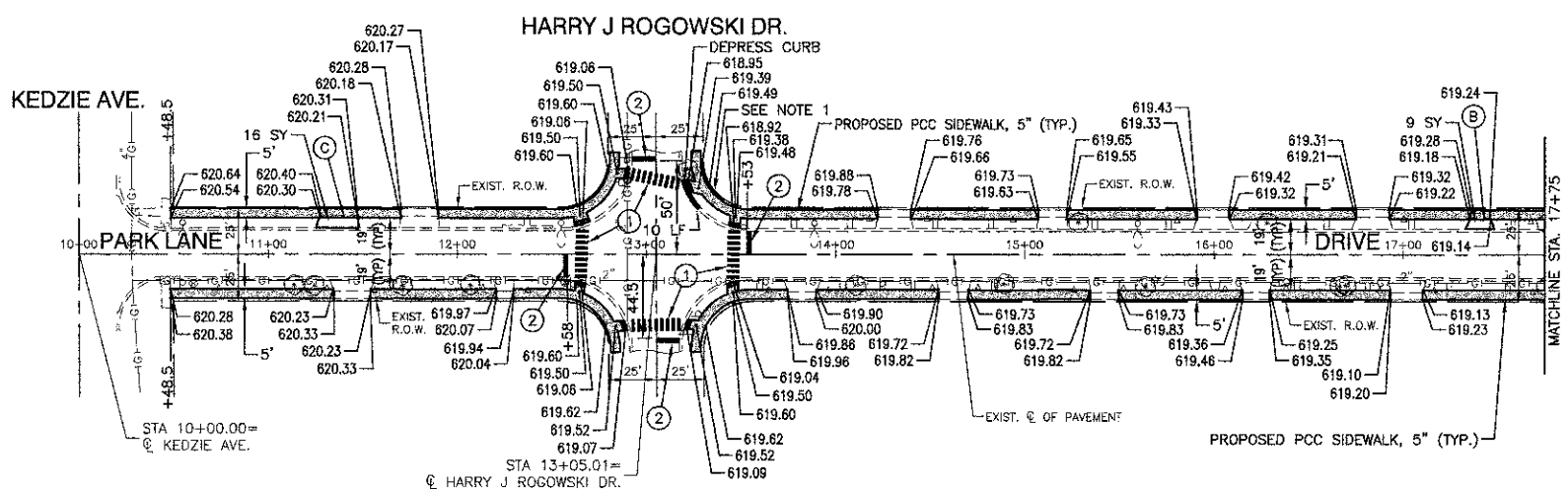

PROPOSED IMPROVEMENT

**NOTE**  
 1. PROPOSED BARRIER CURB (CONCRETE CURB, TYPE B) ALONG BACK OF WALK IF NECESSARY TO MATCH TO EXISTING GRADE AT PROPERTY LINE AT AN ACCEPTABLE SLOPE (TO BE DETERMINED BY THE ENGINEER).

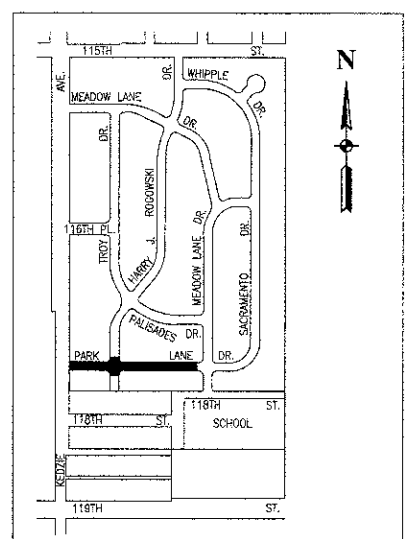

LOCATION MAP  
NOT TO SCALE

- LEGEND**
- CURB & GUTTER REMOVAL & REPLACEMENT
  - SIDEWALK REMOVAL
  - DRIVEWAY PAVEMENT REMOVAL
  - PORTLAND CEMENT CONCRETE SIDEWALK, 5" (6" THROUGH DRIVEWAYS) AGGREGATE BASE COURSE, TYPE B, 3"
  - DETECTABLE WARNINGS
  - THERMOPLASTIC PAVEMENT MARKING - LINE 12"
  - THERMOPLASTIC PAVEMENT MARKING - LINE 24"
  - STABILIZED DRIVEWAY PAVEMENT
  - PCC DRIVEWAY PAVEMENT, 6"

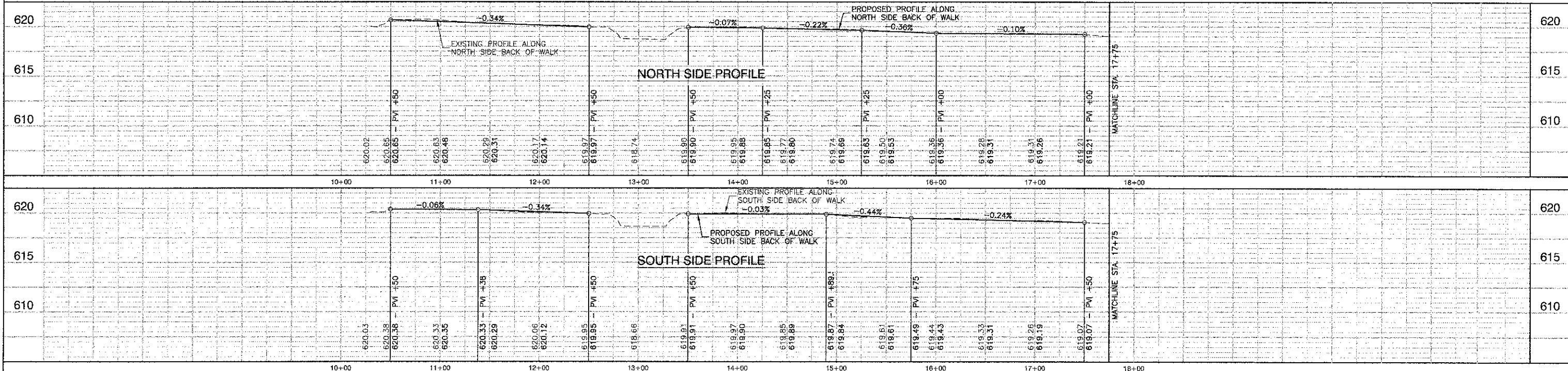

FILE NAME = 12250_01-PLPR-01 1001 P01	USER NAME =	DESIGNED - TAG	REVISED -	STATE OF ILLINOIS DEPARTMENT OF TRANSPORTATION	SIDEWALK REPLACEMENT PARK LANE DRIVE - PLAN & PROFILE VILLAGE OF MERRIONETTE PARK			F.A.U. RTE.	SECTION	COUNTY	TOTAL SHEETS	SHEET NO.
	PLOT SCALE = 1"=50'	CHECKED - PKB	REVISED -					12-00030-00-SW	COOK	08	04	
	PLOT DATE = 02-01-13	DRAWN - KWM	REVISED -			SCALE: 1"=50'	SHEET NO. 04 OF 08 SHEETS	STA. 10+00 TO STA. 17+75	CONTRACT NO. 63799			
		CHECKED - AG	REVISED -			FED. ROAD DIST. NO. ILLINOIS FED. AID PROJECT SRTS-4009(181)						