

NOTE:
EXISTING COMED OVERHEAD POWER LINES ARE
LOCATED ALONG THE SOUTH SIDE OF BLACK ROAD.

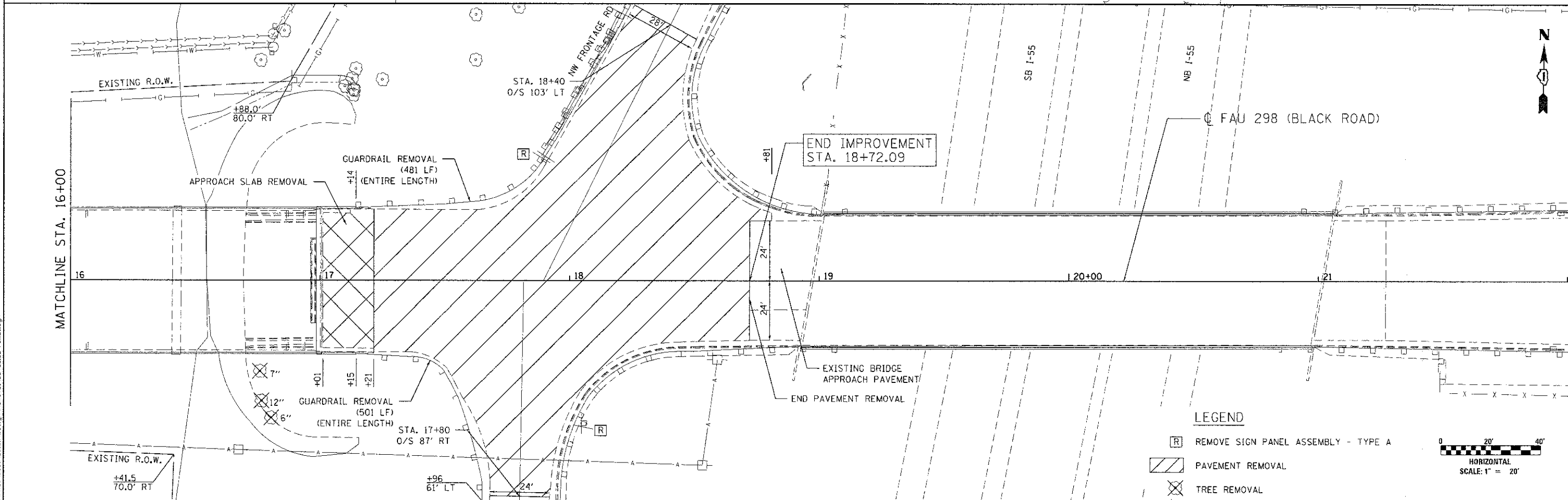

- LEGEND**
- [R] REMOVE SIGN PANEL ASSEMBLY - TYPE A
 - [Hatched Box] PAVEMENT REMOVAL
 - [X] TREE REMOVAL

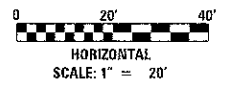

FILE NAME: N:\PROJECTS\2013\18-0001\18-0001.dwg

Ciorba Group, Inc.
CONSULTING ENGINEERS
5507 North Cumberland Avenue, Suite 402
Chicago, Illinois 60656
Tel. 773.775.4009 Fax 773.775.4014

USER NAME = jkellman	DESIGNED - JMK	REVISED -
PLOT SCALE = 40.0000' / in.	DRAWN - JMK	REVISED -
PLOT DATE = 1/25/2013	CHECKED - M.JL	REVISED -
	DATE - 1/29/2013	REVISED -

**STATE OF ILLINOIS
DEPARTMENT OF TRANSPORTATION**

**FAU 298 (BLACK ROAD) OVER THE DUPAGE RIVER
EXISTING CONDITIONS AND REMOVAL PLAN**

C.H. RTE. 298	SECTION 04-00069-18-BR	COUNTY WILL	TOTAL SHEETS 51	SHEET NO. 12
SCALE: SHEET NO. OF SHEETS STA. TO STA.			CONTRACT NO. 63803	
ILLINOIS FED. AID PROJECT				