

**NORTH EDGE OF SHOULDER**

Location	Station	Offset	Theoretical Grade Elevations
W. End of East Appr. Slab	17+01.41	28.00 Lt.	599.23
A3	17+11.41	28.00 Lt.	599.42
A4	17+21.41	28.00 Lt.	599.61
E. End of East Appr. Slab	17+31.41	28.00 Lt.	599.79

**NORTH EDGE OF PAVEMENT**

Location	Station	Offset	Theoretical Grade Elevations
W. End of East Appr. Slab	17+01.41	24.00 Lt.	599.32
A3	17+11.41	24.00 Lt.	599.51
A4	17+21.41	24.00 Lt.	599.70
E. End of East Appr. Slab	17+31.41	24.00 Lt.	599.88

**CL BLACK ROAD, P.G.L., & STAGE CONST. JT.**

Location	Station	Offset	Theoretical Grade Elevations
W. End of East Appr. Slab	17+01.41	0.00	599.69
A3	17+11.41	0.00	599.88
A4	17+21.41	0.00	600.07
E. End of East Appr. Slab	17+31.41	0.00	600.25

**SOUTH EDGE OF PAVEMENT**

Location	Station	Offset	Theoretical Grade Elevations
W. End of East Appr. Slab	17+01.41	24.00 Rt.	599.32
A3	17+11.41	24.00 Rt.	599.51
A4	17+21.41	24.00 Rt.	599.70
E. End of East Appr. Slab	17+31.41	24.00 Rt.	599.88

**SOUTH EDGE OF SHOULDER**

Location	Station	Offset	Theoretical Grade Elevations
W. End of East Appr. Slab	17+01.41	28.00 Rt.	599.23
A3	17+11.41	28.00 Rt.	599.42
A4	17+21.41	28.00 Rt.	599.61
E. End of East Appr. Slab	17+31.41	28.00 Rt.	599.79

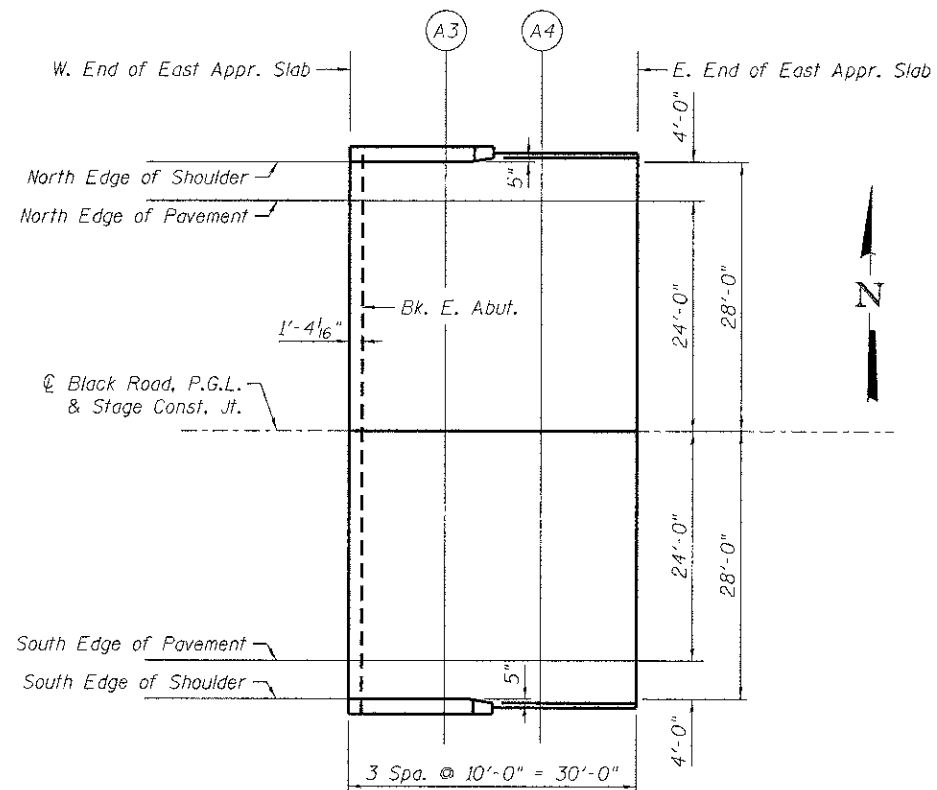

**PLAN**

N:\PROJ\0203408\00\Design\Structural\CAD\099-3031\_0002408\_10\_Top of East Appr Slab Elev.dgn



USER NAME = rdenley	DESIGNED - MHT	REVISED -
	CHECKED - SMY	REVISED -
PLOT SCALE = 10:0.0000 1" = 10'	DRAWN - SRG	REVISED -
PLOT DATE = 1/28/2013	CHECKED - BWS	REVISED -

**STATE OF ILLINOIS  
DEPARTMENT OF TRANSPORTATION**

**TOP OF EAST APPROACH SLAB ELEVATIONS  
STRUCTURE NO. 099-3031**

SHEET NO. 5-10 OF 5-24 SHEETS

F.A.U. RTE.	SECTION	COUNTY	TOTAL SHEETS	SHEET NO.
298	04-00069-18-BR	WILL	51	31
CONTRACT NO. 63803			ILLINOIS FED. AID PROJECT	