

F.A.U. ROUTE	SECTION	COUNTY	TOTAL SHEETS	SHEET NO.
120	11-00115-00-R5	MCHENRY	62	42
TRAFFIC SIGNALS				
F.H.W.A. REG. 5 ILLINOIS PROJECT NO. F-0306(023)				

STATION EQUATIONS
 STA. 79+95.00 U.S. RTE. 14 =
 STA. 60+00.00 AHEAD MCHENRY AVE.
 STA. 79+94.86 U.S. RTE. 14 =
 STA. 50+00.00 BACK MCHENRY AVE.
 STA. 50+00.00 BACK MCHENRY AVE. =
 STA. 60+01.23 AHEAD MCHENRY AVE.

U.S. ROUTE 14 (VIRGINIA STREET)

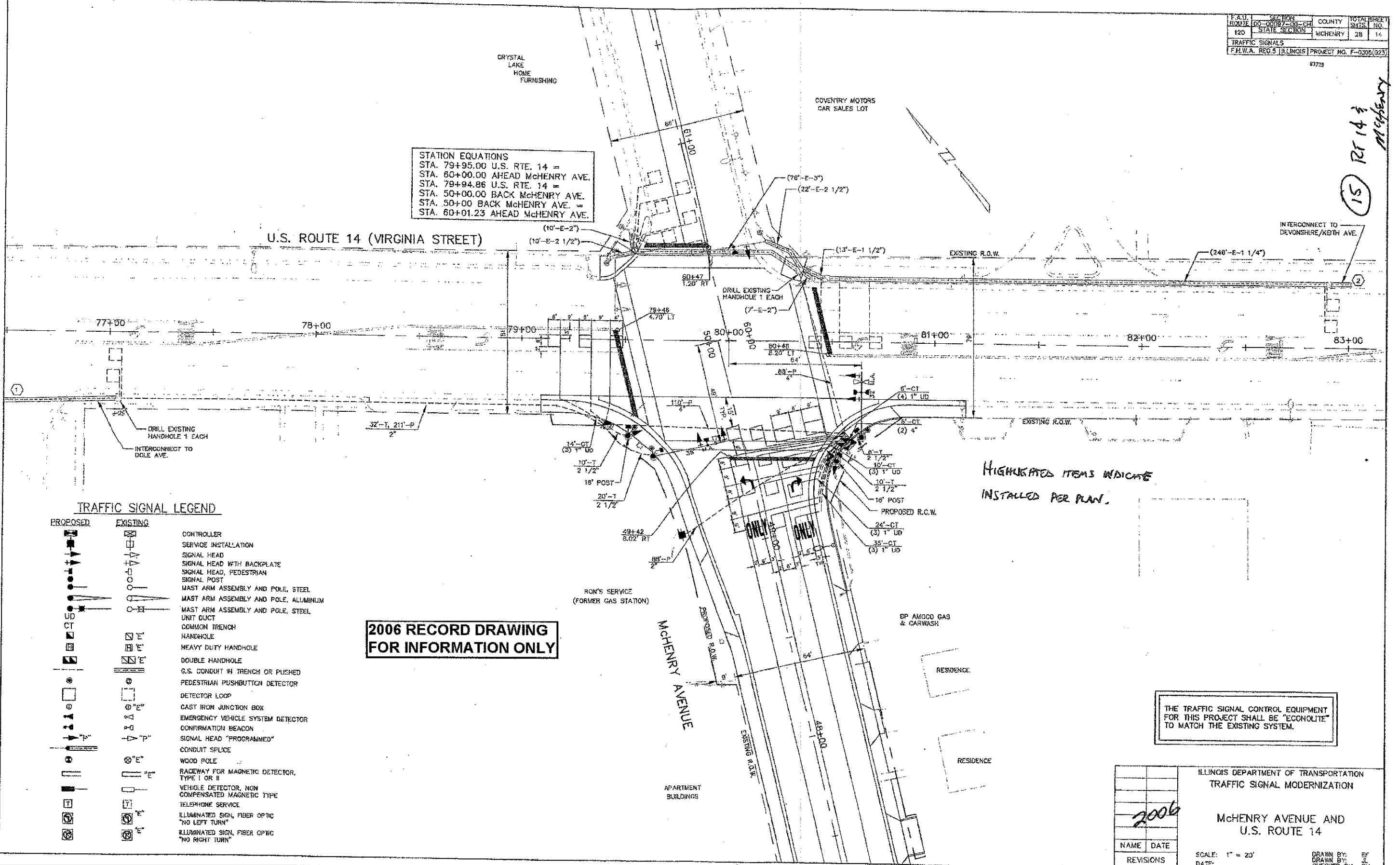

TRAFFIC SIGNAL LEGEND

PROPOSED	EXISTING	DESCRIPTION
[Symbol]	[Symbol]	CONTROLLER
[Symbol]	[Symbol]	SERVICE INSTALLATION
[Symbol]	[Symbol]	SIGNAL HEAD
[Symbol]	[Symbol]	SIGNAL HEAD WITH BACKPLATE
[Symbol]	[Symbol]	SIGNAL HEAD, PEDESTRIAN
[Symbol]	[Symbol]	SIGNAL POST
[Symbol]	[Symbol]	MAST ARM ASSEMBLY AND POLE, STEEL
[Symbol]	[Symbol]	MAST ARM ASSEMBLY AND POLE, ALUMINUM
[Symbol]	[Symbol]	MAST ARM ASSEMBLY AND POLE, STEEL
[Symbol]	[Symbol]	UNIT DUCT
[Symbol]	[Symbol]	COMMON TRENCH
[Symbol]	[Symbol]	HANDHOLE
[Symbol]	[Symbol]	HEAVY DUTY HANDHOLE
[Symbol]	[Symbol]	DOUBLE HANDHOLE
[Symbol]	[Symbol]	G.S. CONDUIT IN TRENCH OR PUSHED
[Symbol]	[Symbol]	PEDESTRIAN PUSHBUTTON DETECTOR
[Symbol]	[Symbol]	DETECTOR LOOP
[Symbol]	[Symbol]	CAST IRON JUNCTION BOX
[Symbol]	[Symbol]	EMERGENCY VEHICLE SYSTEM DETECTOR
[Symbol]	[Symbol]	CONFIRMATION BEACON
[Symbol]	[Symbol]	SIGNAL HEAD "PROGRAMMED"
[Symbol]	[Symbol]	CONDUIT SPLICE
[Symbol]	[Symbol]	WOOD POLE
[Symbol]	[Symbol]	RACEWAY FOR MAGNETIC DETECTOR, TYPE I OR II
[Symbol]	[Symbol]	VEHICLE DETECTOR, NON COMPENSATED MAGNETIC TYPE
[Symbol]	[Symbol]	TELEPHONE SERVICE
[Symbol]	[Symbol]	ILLUMINATED SIGN, FIBER OPTIC "NO LEFT TURN"
[Symbol]	[Symbol]	ILLUMINATED SIGN, FIBER OPTIC "NO RIGHT TURN"

2006 RECORD DRAWING FOR INFORMATION ONLY

HIGHLIGHTED ITEMS INDICATE INSTALLED PER PLAN.

THE TRAFFIC SIGNAL CONTROL EQUIPMENT FOR THIS PROJECT SHALL BE "ECONOLITE" TO MATCH THE EXISTING SYSTEM.

ILLINOIS DEPARTMENT OF TRANSPORTATION		TRAFFIC SIGNAL MODERNIZATION	
MCHENRY AVENUE AND U.S. ROUTE 14			
NAME	DATE	SCALE: 1" = 20'	DRAWN BY: EF
REVISIONS		DATE:	CHECKED BY: JK

ENGINEERING CONSULTANT
Clorba Group, Inc.
 CONSULTING ENGINEERS
 5607 North Cumberland Avenue, Suite 402
 Chicago, Illinois 60630
 Tel: 773.776.8000 Fax: 773.776.4014
 Email: cgroup@clorba.com

USER NAME = ehern	DESIGNED - RJR	REVISED -
PLOT SCALE = 1:8000 / 1"	DRAWN - AMH	REVISED -
PLOT DATE = 2/22/2013	CHECKED - MRJ	REVISED -
	DATE - FEBRUARY 4, 2013	REVISED -

STATE OF ILLINOIS DEPARTMENT OF TRANSPORTATION

MCHENRY AVENUE OLD DETECTOR LOOP REPLACEMENT US ROUTE 14 AND MCHENRY AVE

SCALE:	SHEET NO. OF SHEETS	STA. TO STA.
--------	---------------------	--------------

F.A.U. ROUTE	SECTION	COUNTY	TOTAL SHEETS	SHEET NO.
120	11-00115-00-R5	MCHENRY	62	42
CONTRACT NO. 63806				
ILLINOIS FED. AID PROJECT				

NA\FR03\022207\01\Readme_V01d_Planes\US14-detector-1.dwg

15 Ref 14 3 MCHENRY