

PLANTING AND SEEDING NOTES:

INSTALL SHRUBS PER AN21 STANDARDS AS SHOWN ON THE PLANS. SHRUBS SHALL BE WATERED IMMEDIATELY AND THEN AS OFTEN AS NECESSARY DURING THE GROWING SEASON TO ENSURE SURVIVAL.

SHRUBS SHALL BE 3-4 FEET TALL, BALLED AND BURLAPPED OR CONTAINER GROWN.

ALL DISTURBED AREAS SHALL BE RESTORED W/6" OF TOPSOIL, SEEDED AND BLANKETED ACCORDING TO THE RATES AND TYPE SPECIFIED ON THE PLANS.

CONTRACTOR SHALL PROVIDE MONITORING AND MAINTENANCE OF THE LANDSCAPING FOR A MINIMUM OF 1 YEAR OR AS NECESSARY AT NO ADDITIONAL COST UNTIL THE PROJECT MEETS PERFORMANCE STANDARDS.

PERFORMANCE STANDARDS (1-YEAR MONITORING PERIOD): AT THE END OF THE FIRST GROWING SEASON AND ONE FULL YEAR AFTER PLANTING, 100% OF THE SHRUBS WILL BE PRESENT AND THRIVING, AND NO MORE THAN 0.5 SQUARE METERS IN SIZE SHALL BE DEVOID OF VEGETATION.

DEWATERING AND CREEK ISOLATION:

CONSTRUCTION IN THE CREEK SHALL ONLY BE CONDUCTED DURING NO OR LOW FLOW CONDITIONS.

ALL DISTURBED AREAS AND WORK AREAS SHALL BE ISOLATED FROM CREEK FLOWS AT ALL TIMES.

IT SHALL BE THE RESPONSIBILITY OF THE CONTRACTOR TO DIVERT THE CREEK FLOW DURING CONSTRUCTION IN ORDER TO KEEP THE CONSTRUCTION AREA FREE OF WATER. THE CONSTRUCTION AREA SHALL BE ISOLATED FROM CREEK FLOWS USING A NON-FLOODABLE COFFERDAM (STEEL, CONCRETE, AGGREGATE OR AQUA DAM, ETC) OR STEEL SHEET PILES IN COMPLIANCE WITH ILLINOIS URBA-N/RURAL PRACTICE STANDARD "COFFERDAM (NO.) CODE 303, THE EXACT MEANS AND METHODS FOR CREEK ISOLATION SHALL BE DETERMINED BY THE CONTRACTOR. THE COST SHALL BE INCLUDED WITH "DEWATERING".

PRIOR TO ANY CONSTRUCTION ACTIVITIES, CONTRACTOR SHALL SUBMIT A DEWATERING AND CREEK BYPASS SYSTEM PLAN TO THE COUNTY FOR REVIEW. THE METHOD OF WATER DIVERSION SHALL BE SUBJECT TO THE APPROVAL OF THE ENGINEER AND DUPAGE COUNTY DIVISION OF ENVIRONMENTAL CONCERNS. THE COST SHALL BE INCLUDED WITH "DEWATERING".

DURING DEWATERING OPERATIONS, WATERS WILL BE PUMPED AND FILTERED WITH SEDIMENT BASINS OR SILT TRAPS IN A VEGETATED AREA WITH SECONDARY CONTAINMENT PRIOR TO DISCHARGE. DEWATERING DIRECTLY INTO FIELD TILES, STORM UTILITIES OR OPEN WATER IS PROHIBITED. THE COST SHALL BE INCLUDED WITH "DEWATERING".

CONTRACTOR SHALL BE SOLELY RESPONSIBLE FOR CONSTRUCTION METHODS, TECHNIQUES, INSPECTION AND MAINTENANCE.

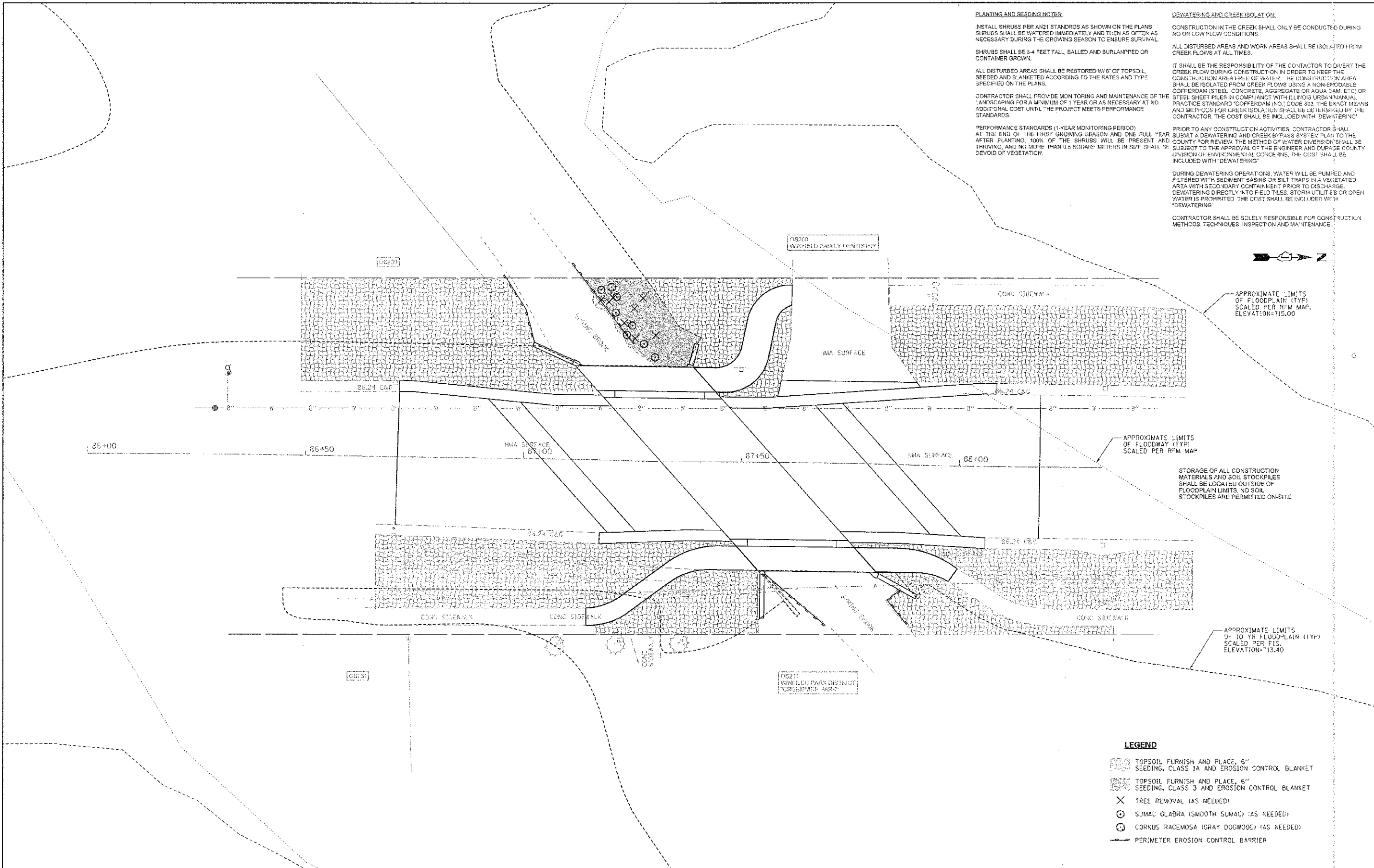
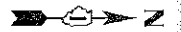

LEGEND

- TOPSOIL FURNISH AND PLACE, 6" SEEDING, CLASS 1A AND EROSION CONTROL BLANKET
- TOPSOIL FURNISH AND PLACE, 6" SEEDING, CLASS 3 AND EROSION CONTROL BLANKET
- TREE REMOVAL (AS NEEDED)
- SUMAC GLABRA (SMOOTH SUMAC) (AS NEEDED)
- CORNUS RACEMOSA (GRAY DOGWOOD) (AS NEEDED)
- PERIMETER EROSION CONTROL BARRIER

FILE NAME =	USER NAME = #USER#	DESIGNED - D.R.	REVISED -
#FILE#		DRAWN - G.R.	REVISED -
	PLT SCALE = #SCALE#	CHECKED - J.3	REVISED -
	PLT DATE = #DATE#	DATE -	REVISED -

**STATE OF ILLINOIS
DEPARTMENT OF TRANSPORTATION**

**PLANTING PLAN
EROSION AND SEDIMENTATION
CONTROL PLAN**

SCALE: 1"=10'

STA. 86+71.54 TO STA. 88+18.46

F.A.U. RTE.	SECTION	COUNTY	TOTAL SHEETS	SHEET NO.
2543	10-00045-00-BR	DUPAGE	16	9
FED. ROAD DIST. NO. 1 ILLINOIS FED. AID PROJECT			CONTRACT NO. 63812	