

NOTE:  
SEE ALIGNMENT TIES AND BENCHMARKS  
SHEET FOR BENCHMARK INFORMATION.

**BILL OF MATERIAL**

ITEM	UNIT	TOTAL
POROUS GRANULAR EMBANKMENT	CU YD	15
STONE RIPRAP, CLASS A4	50 YD	50
FILTER FABRIC	50 YD	50
REMOVAL OF EXISTING STRUCTURES	EACH	1
REMOVAL AND DISPOSAL OF UNSUITABLE MATERIAL FOR STRUCTURES	CU YD	15
REINFORCEMENT BARS EPOXY COATED	POUND	83,288
NAME PLATES	EACH	1
CONCRETE BOX CULVERTS	CU YD	152

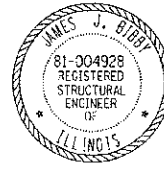

"I certify that to the best of my knowledge, information and belief, this bridge is structurally adequate for the design loading shown on the plans. The design is an economical one for the style of structure and complies with requirements of the current AASHTO Standard Specifications for Highway Bridges."

JAMES J. BIBBY  
ILLINOIS REGISTERED STRUCTURAL ENGINEER  
NO. 81-004928 EXPIRES 11-30-14

**WATERWAY INFORMATION**

Drainage Area = 8.65 Sq. Mi.

Flood	Frq.	0	Opening	Sq. Ft.	Nat.	Head - Ft.	Headwater El.	
yr.	C.F.S.	Exist.	Prop.	H.W.E.	Exist.	Prop.	Exist.	
Design	50	655	74	74	714.39	0.53	0.53	714.92
Base	100	755	74	74	714.52	0.44	0.44	715.06
Overtopping	50	655	74	74	714.39	0.53	0.53	714.92
Max. Calc.	500	1065	74	74	715.11	0.29	0.29	715.40

**EXISTING STRUCTURE**

S.N. 022-0067 - First constructed in the 1920's, this bridge consists of a one span (26'-0") reinforced concrete slab on slab abutments over Winfield Creek. Entire existing structure shall be removed and replaced requiring a full road closure.

Road will be closed. Traffic will be detoured around site.

Salvage: None

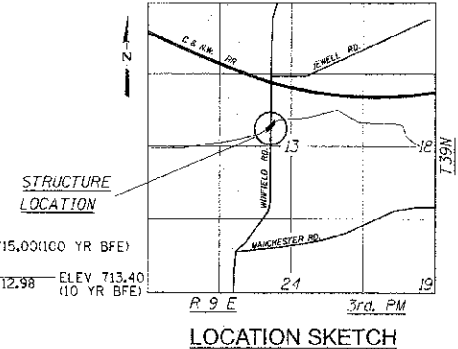
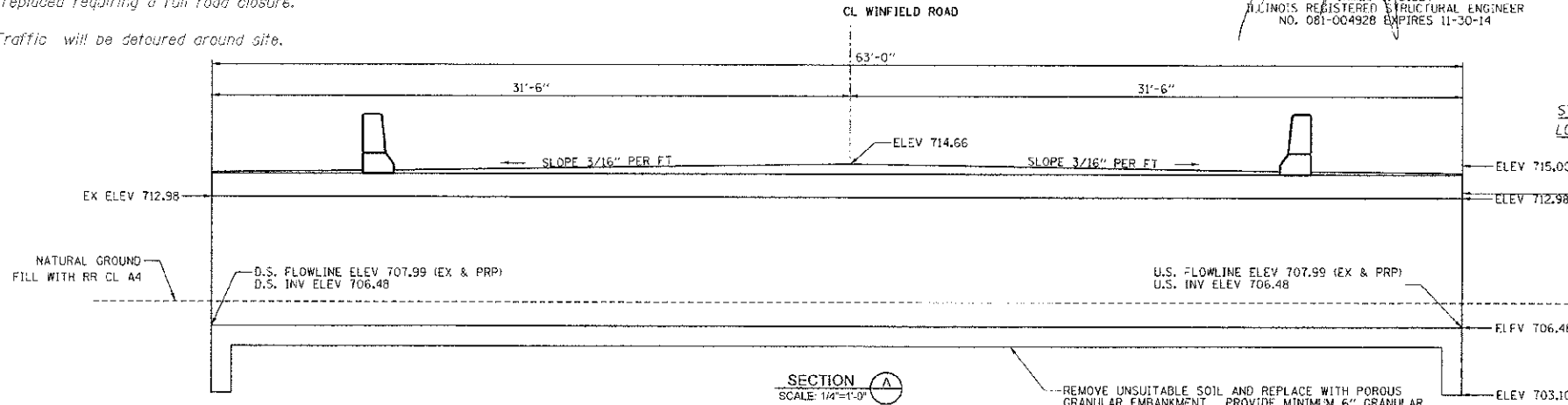

**LOADING HL-93**  
Allow 50#<sup>2</sup>/sq. ft. for future wearing surface.  
**DESIGN SPECIFICATIONS**  
2007 AASHTO LRFD Bridge Design Specifications with 2008 & 2009 Interims  
**DESIGN STRESSES**  
FIELD UNITS  
f<sub>c</sub> = 5,000 psi  
f<sub>y</sub> = 60,000 psi (reinforcement)

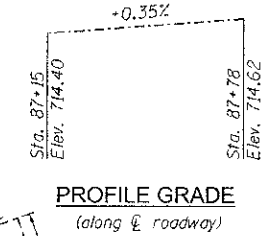
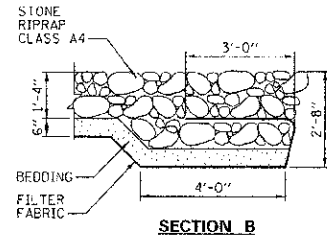

**WINFIELD CREEK**  
BUILT 2013 BY  
VILLAGE OF WINFIELD  
F.A.S. RT. 3549  
SEC. 10-00045-00-BR  
LOADING HL-93  
STR. NO. 022-6007  
**NAME PLATE**  
See Std. 515001

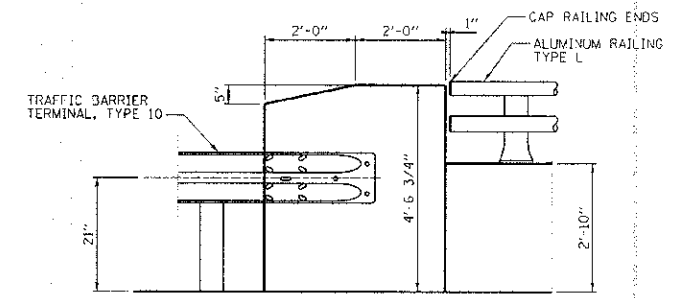
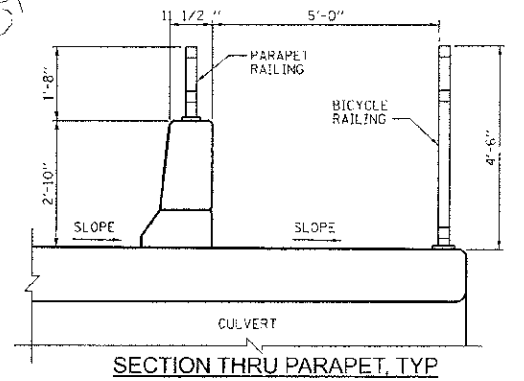
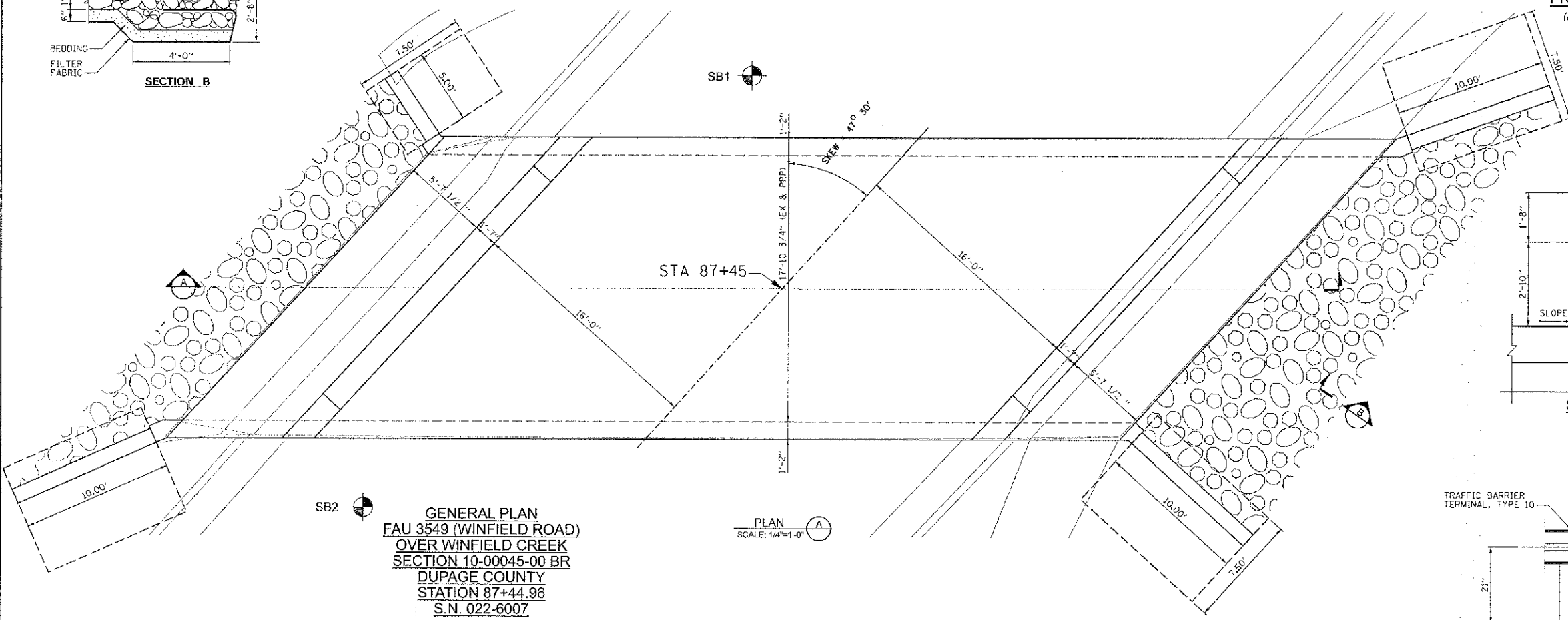

**GENERAL PLAN**  
FAU 3549 (WINFIELD ROAD)  
OVER WINFIELD CREEK  
SECTION 10-00045-00 BR  
DUPAGE COUNTY  
STATION 87+44.96  
S.N. 022-6007

FILE NAME =	USER NAME = #USER#	DESIGNED - D.R.	REVISED -	STATE OF ILLINOIS DEPARTMENT OF TRANSPORTATION	GENERAL PLAN AND ELEVATION STRUCTURE NO. 022-6007	SECTION 10-00045-00-BR	COUNTY DUPAGE	TOTAL SHEETS 15	SHEET NO. 10
BPFILE#	PLOT SCALE = #SCALE#	DRAWN - G.R.	REVISED -						
	PLOT DATE = #DATE#	CHECKED - J.B.	REVISED -						
		DATE -	REVISED -						
SCALE:					STA. 86+71.54 TO STA. 88+18.46	FED. ROAD DIST. NO. 1 ILLINOIS FED. AID PROJECT			