

FILE NAME: PLAN
 USER: BURKE
 DATE: 2/25/2013
 PROJECT: WOLF ROAD AND WINTERS DRIVE
 DRAWN: EAJ / FPB
 CHECKED: GMZ
 DATE: 2/25/2013

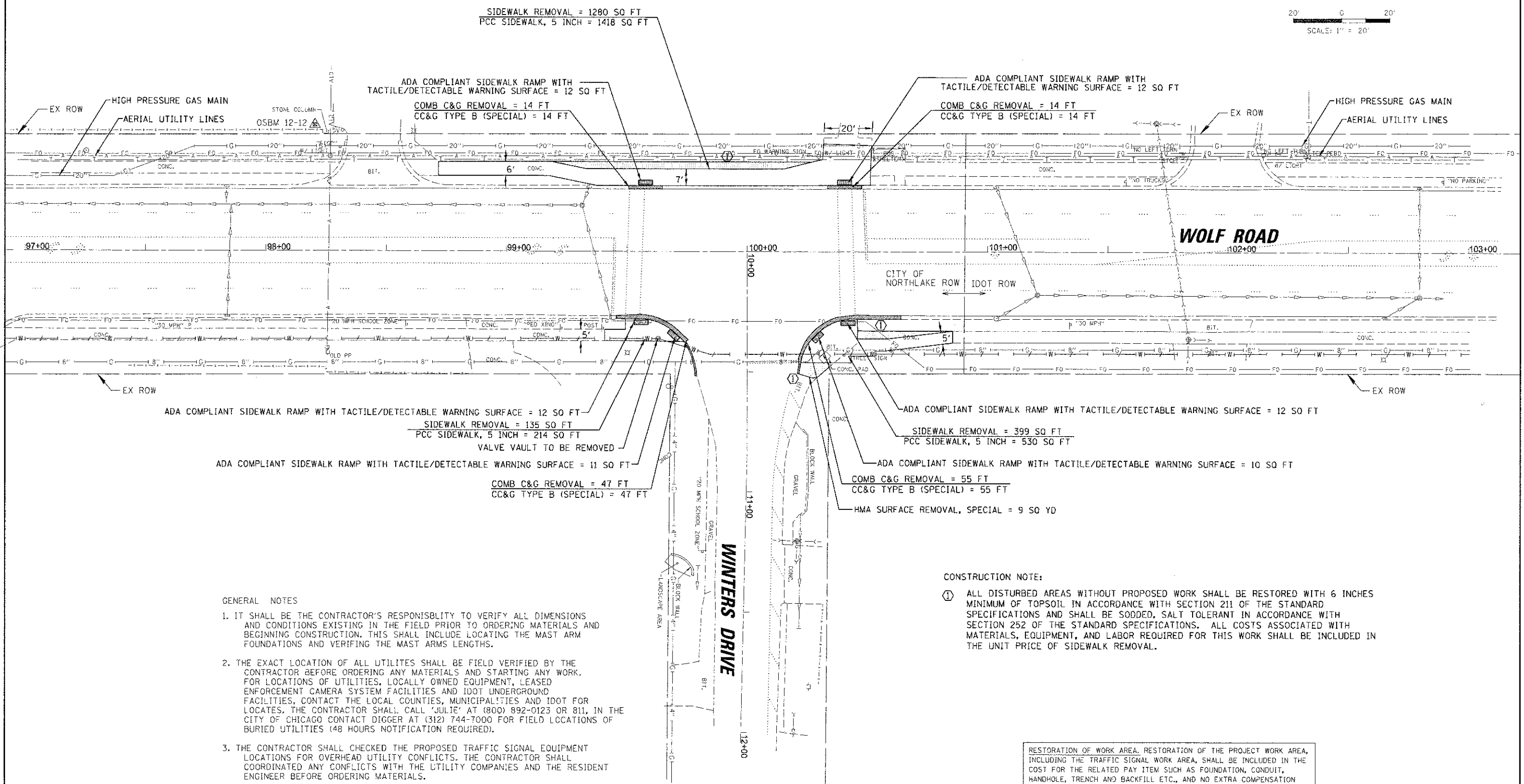

GENERAL NOTES

- IT SHALL BE THE CONTRACTOR'S RESPONSIBILITY TO VERIFY ALL DIMENSIONS AND CONDITIONS EXISTING IN THE FIELD PRIOR TO ORDERING MATERIALS AND BEGINNING CONSTRUCTION. THIS SHALL INCLUDE LOCATING THE MAST ARM FOUNDATIONS AND VERIFYING THE MAST ARMS LENGTHS.
- THE EXACT LOCATION OF ALL UTILITIES SHALL BE FIELD VERIFIED BY THE CONTRACTOR BEFORE ORDERING ANY MATERIALS AND STARTING ANY WORK. FOR LOCATIONS OF UTILITIES, LOCALLY OWNED EQUIPMENT, LEASED ENFORCEMENT CAMERA SYSTEM FACILITIES AND IDOT UNDERGROUND FACILITIES, CONTACT THE LOCAL COUNTIES, MUNICIPALITIES AND IDOT FOR LOCATES. THE CONTRACTOR SHALL CALL 'JULIE' AT (800) 892-0123 OR 811, IN THE CITY OF CHICAGO CONTACT DIGGER AT (312) 744-7000 FOR FIELD LOCATIONS OF BURIED UTILITIES (48 HOURS NOTIFICATION REQUIRED).
- THE CONTRACTOR SHALL CHECKED THE PROPOSED TRAFFIC SIGNAL EQUIPMENT LOCATIONS FOR OVERHEAD UTILITY CONFLICTS. THE CONTRACTOR SHALL COORDINATED ANY CONFLICTS WITH THE UTILITY COMPANIES AND THE RESIDENT ENGINEER BEFORE ORDERING MATERIALS.
- THE CONTRACTOR SHALL COORDINATE CONSTRUCTION ACTIVITIES WITH UTILITY COMPANIES, LOCAL GOVERNMENT AGENCIES AND IDOT.

CONSTRUCTION NOTE:

- ALL DISTURBED AREAS WITHOUT PROPOSED WORK SHALL BE RESTORED WITH 6 INCHES MINIMUM OF TOPSOIL IN ACCORDANCE WITH SECTION 211 OF THE STANDARD SPECIFICATIONS AND SHALL BE SODDED, SALT TOLERANT IN ACCORDANCE WITH SECTION 252 OF THE STANDARD SPECIFICATIONS. ALL COSTS ASSOCIATED WITH MATERIALS, EQUIPMENT, AND LABOR REQUIRED FOR THIS WORK SHALL BE INCLUDED IN THE UNIT PRICE OF SIDEWALK REMOVAL.

RESTORATION OF WORK AREA. RESTORATION OF THE PROJECT WORK AREA, INCLUDING THE TRAFFIC SIGNAL WORK AREA, SHALL BE INCLUDED IN THE COST FOR THE RELATED PAY ITEM SUCH AS FOUNDATION, CONDUIT, HANDHOLE, TRENCH AND BACKFILL ETC., AND NO EXTRA COMPENSATION SHALL BE ALLOWED. ALL ROADWAY SURFACES SUCH AS SHOULDERS, MEDIANS, SIDEWALKS, CURB, PAVEMENT, ETC. SHALL BE REPLACED IN KIND. ALL DAMAGE TO MOWED LAWNS SHALL BE REPLACED WITH AN APPROVED SOD, AND ALL DAMAGE TO UNMOWED FIELDS SHALL BE SEEDING IN ACCORDANCE WITH STANDARD SPECIFICATIONS 252 AND 250 RESPECTIVELY.

FILE NAME: PLAN	USER: BURKE	DESIGNED: EAJ	REVISED: -	STATE OF ILLINOIS DEPARTMENT OF TRANSPORTATION	SIDEWALK MODIFICATION PLAN WOLF ROAD AND WINTERS DRIVE NORTHLAKE, ILLINOIS	F.A.U. RTE.:	SECTION:	COUNTY:	TOTAL SHEETS:	SHEET NO.:	
PLAN NORTHLAKE\14\22\32\2012\NT-eff\plan\SW	PLAN: WOLF-WINTERS.dgn	DRAWN: EAJ / FPB	REVISED: -			2590	12-00081-00-TL	COOK	19	7	
NOTE BOOK:	PILOT SCALE: 2"	CHECKED: GMZ	REVISED: -			CONTRACT NO. 63815					
NO.:	PILOT DATE: 2/25/2013	DATE: -	REVISED: -			FED. ROAD DIST. NO. ILLINOIS FED. AID PROJECT					