

THE FOLLOWING ITEMS SHALL BE REMOVED BY THE CONTRACTOR AND SHALL BE DISPOSED OF BY HIM OUTSIDE THE RIGHT-OF-WAY AT HIS EXPENSE. THE SALVAGE VALUE OF THE REMOVED EQUIPMENT SHALL BE REFLECTED IN THE CONTRACT BID PRICE. THIS WORK SHALL BE PAID FOR AT THE CONTRACT UNIT PRICE EACH FOR REMOVE EXISTING TRAFFIC SIGNAL EQUIPMENT (SEE SCHEDULE OF QUANTITIES FOR REMOVAL ITEMS TO BE PAID FOR SEPERATELY).

- 2 EACH PEDESTRIAN SIGNAL HEADS
- 2 EACH PEDESTRIAN PUSH BUTTONS
- 1 EACH SERVICE INSTALLATION
- 1 EACH TRAFFIC SIGNAL CABINET (COMPLETE)
- 1 EACH TRAFFIC SIGNAL CONTROLLER

EXISTING INTERCONNECT TO 75TH STREET

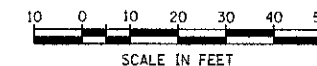

* A 4" LAYER OF MECHANICALLY COMPACTED CRUSHED STONE (CA-6) SHALL BE PROVIDED BENEATH THE PROPOSED SIDEWALK. THE COST OF THIS WORK WILL NOT BE PAID FOR SEPARATELY BUT SHALL BE INCLUDED IN THE UNIT BID PRICE FOR PORTLAND CEMENT CONCRETE SIDEWALK.

PLAN	DATE
REVISION	BY
DATE	
DATE	
DATE	

PROFILE	DATE
REVISION	BY
DATE	
DATE	
DATE	

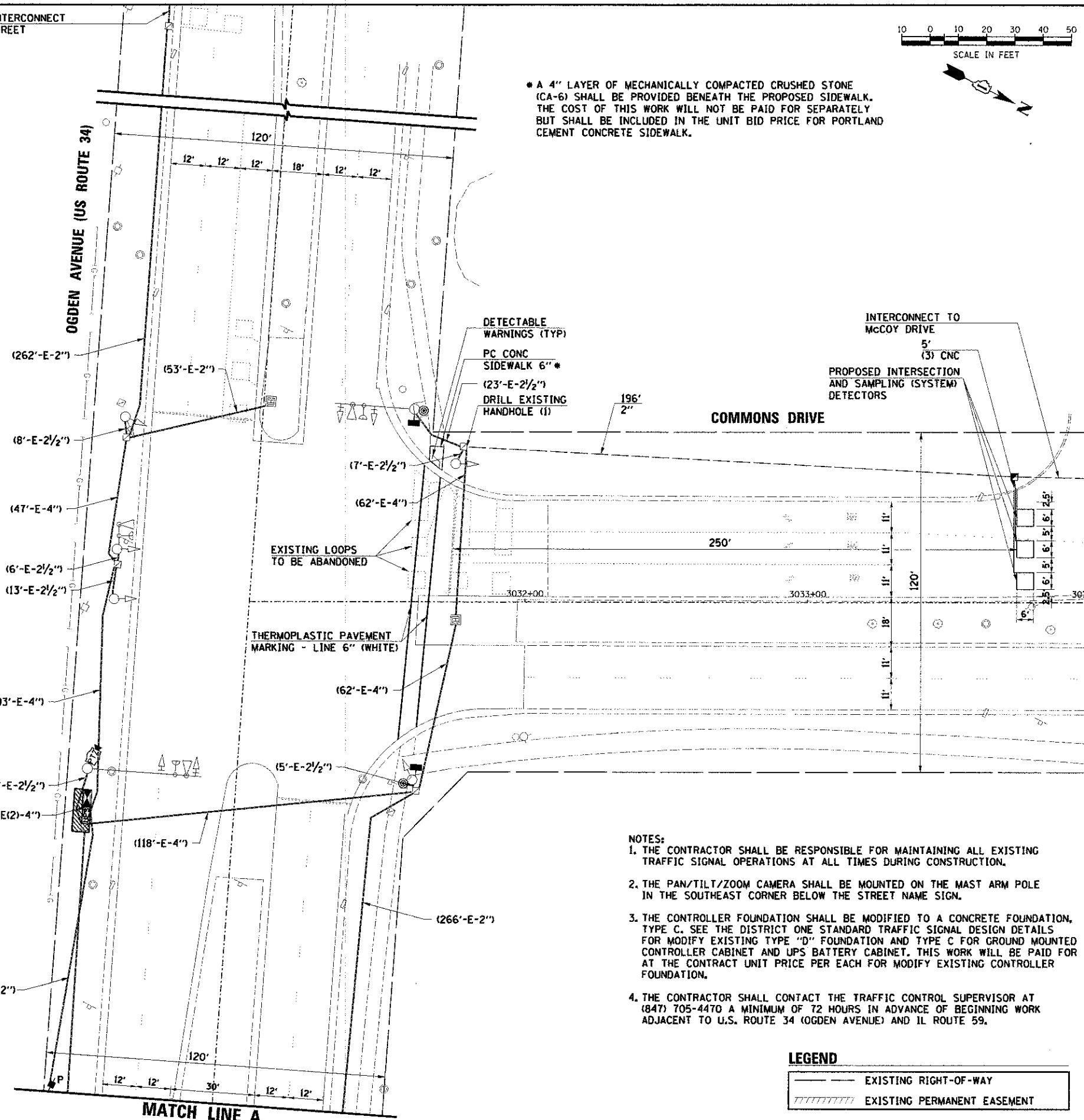
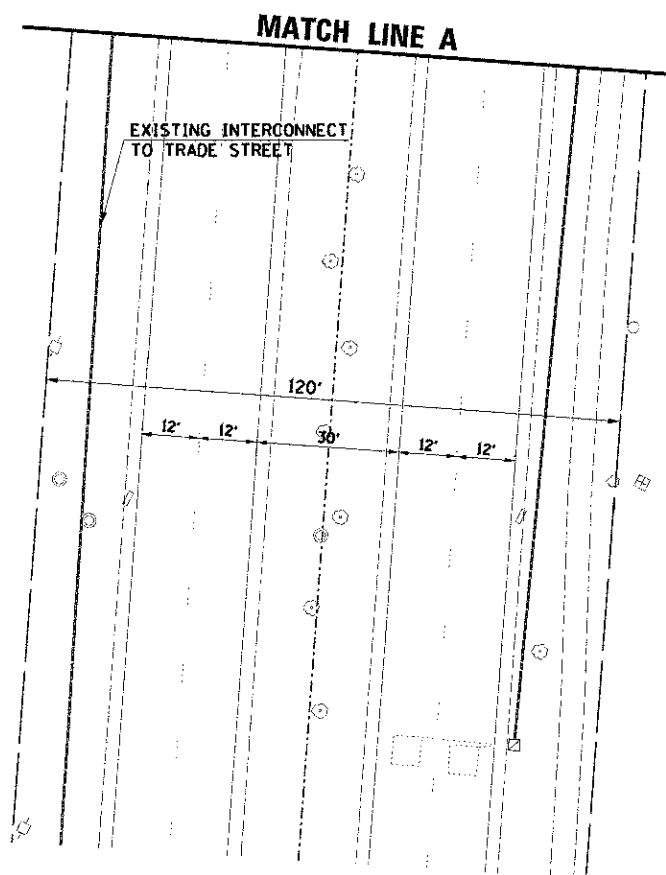

- NOTES:
1. THE CONTRACTOR SHALL BE RESPONSIBLE FOR MAINTAINING ALL EXISTING TRAFFIC SIGNAL OPERATIONS AT ALL TIMES DURING CONSTRUCTION.
 2. THE PAN/TILT/ZOOM CAMERA SHALL BE MOUNTED ON THE MAST ARM POLE IN THE SOUTHEAST CORNER BELOW THE STREET NAME SIGN.
 3. THE CONTROLLER FOUNDATION SHALL BE MODIFIED TO A CONCRETE FOUNDATION, TYPE C. SEE THE DISTRICT ONE STANDARD TRAFFIC SIGNAL DESIGN DETAILS FOR MODIFY EXISTING TYPE "D" FOUNDATION AND TYPE C FOR GROUND MOUNTED CONTROLLER CABINET AND UPS BATTERY CABINET. THIS WORK WILL BE PAID FOR AT THE CONTRACT UNIT PRICE PER EACH FOR MODIFY EXISTING CONTROLLER FOUNDATION.
 4. THE CONTRACTOR SHALL CONTACT THE TRAFFIC CONTROL SUPERVISOR AT (847) 705-4470 A MINIMUM OF 72 HOURS IN ADVANCE OF BEGINNING WORK ADJACENT TO U.S. ROUTE 34 (OGDEN AVENUE) AND IL ROUTE 59.

LEGEND

———	EXISTING RIGHT-OF-WAY
///////	EXISTING PERMANENT EASEMENT

THE TRAFFIC SIGNAL CONTROL EQUIPMENT FOR THIS PROJECT SHALL BE "ECONOLITE" TO MATCH THE EXISTING ADJACENT SYSTEM.

THE EMERGENCY VEHICLE PREEMPTION EQUIPMENT FOR THIS PROJECT SHALL BE OPTICOM AS REQUIRED BY THE CITY OF AURORA. LIGHT DETECTOR AMPLIFIERS SHALL BE OPTICOM MODEL 764 MULTIMODE PHASE SELECTORS.

RESTORATION OF WORK AREA: RESTORATION OF THE TRAFFIC SIGNAL WORK AREA SHALL BE INCIDENTAL TO THE RELATED PAY ITEM SUCH AS FOUNDATION, CONDUIT, HANDHOLE, TRENCH AND BACKFILL, ETC., AND NO EXTRA COMPENSATION SHALL BE ALLOWED. ALL ROADWAY SURFACES SUCH AS SHOULDERS, MEDIANS, SIDEWALKS, PAVEMENT, ETC. SHALL BE REPLACED IN KIND. ALL DAMAGE TO MOWED LAWNS SHALL BE REPLACED WITH AN APPROVED SOD, AND ALL DAMAGE TO UNMOWED FIELDS SHALL BE SEEDED IN ACCORDANCE WITH STANDARD SPECIFICATIONS 252 AND 250 RESPECTIVELY.



USER NAME = Mfeller	DESIGNED = MJF	REVISED =
PLOT SCALE =	CHECKED = APS	REVISED =
PLOT DATE = 2/22/2013	DATE = 02/21/2013	REVISED =
FILE NAME = 690_10_sig@tbl.ogden.dgn		REVISED =

STATE OF ILLINOIS
DEPARTMENT OF TRANSPORTATION

TRAFFIC SIGNAL MODIFICATION PLAN
COMMONS DRIVE AT OGDEN AVENUE (US ROUTE 34)

F.A.U. RTE. 153/2932	SECTION 11-00297-00-TL	COUNTY DUPAGE	TOTAL SHEETS 38	SHEET NO. 10
CONTRACT NO. 63816			FED. ROAD DIST. NO. [ILLINOIS] FED. AID PROJECT	

SCALE:	SHEET NO.	OF SHEETS	STA.	TO STA.
--------	-----------	-----------	------	---------