

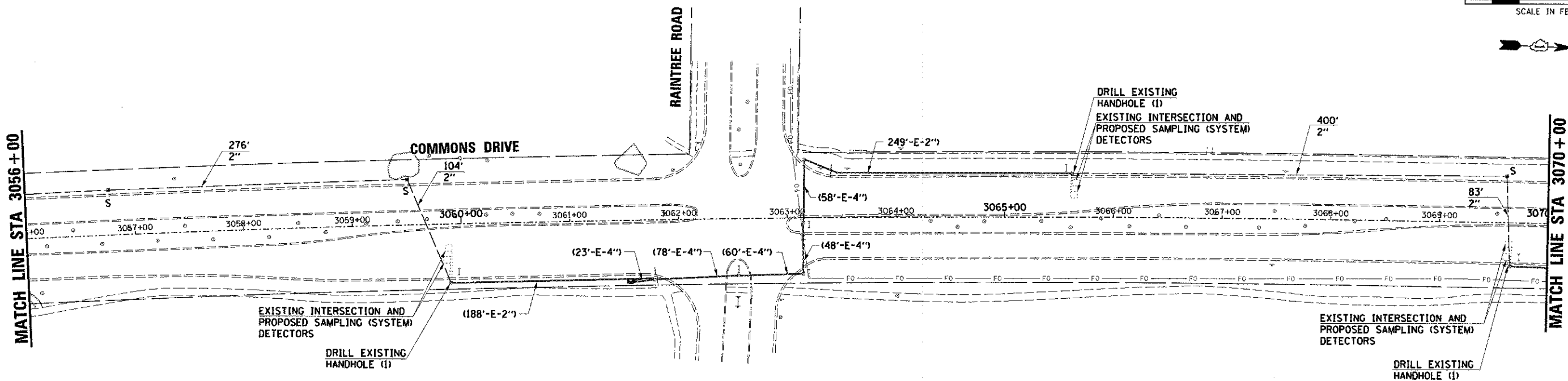

PLAN	DATE
BY	
CHECKED	
DESIGNED	
IN CHARGE	
PROJECT	
NO.	

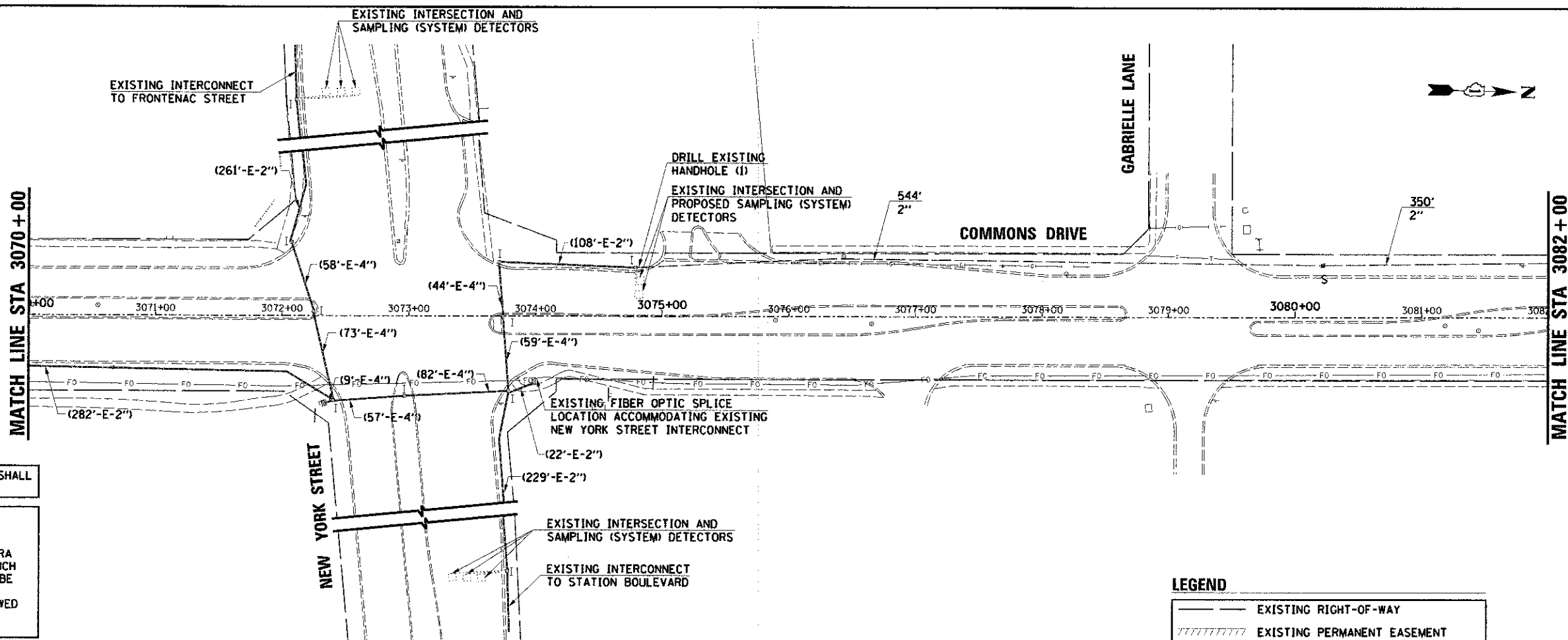

PROFILE	DATE
BY	
CHECKED	
DESIGNED	
IN CHARGE	
PROJECT	
NO.	



THE TRAFFIC SIGNAL CONTROL EQUIPMENT FOR THIS PROJECT SHALL BE "ECONOLITE" TO MATCH THE EXISTING ADJACENT SYSTEM.

RESTORATION OF WORK AREA:
 RESTORATION OF THE TRAFFIC SIGNAL WORK AREA SHALL BE INCIDENTAL TO THE RELATED PAY ITEM SUCH AS FOUNDATION, CONDUIT, HANDHOLE, TRENCH AND BACKFILL, ETC., AND NO EXTRA COMPENSATION SHALL BE ALLOWED. ALL ROADWAY SURFACES SUCH AS SHOULDERS, MEDIANS, SIDEWALKS, PAVEMENT, ETC. SHALL BE REPLACED IN KIND. ALL DAMAGE TO MOWED LAWNS SHALL BE REPLACED WITH AN APPROVED SOD, AND ALL DAMAGE TO UNMOWED FIELDS SHALL BE SEEDED IN ACCORDANCE WITH STANDARD SPECIFICATIONS 252 AND 250 RESPECTIVELY.

LEGEND	
	EXISTING RIGHT-OF-WAY
	EXISTING PERMANENT EASEMENT

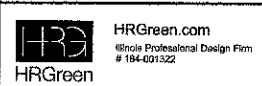

USER NAME = M.Feller	DESIGNED - MJF	REVISED -
PLT SCALE =	CHECKED - APS	REVISED -
PLT DATE = 2/22/2013	DATE - 02/21/2013	REVISED -
FILE NAME = 690_10_sigt102.dgn		REVISED -

STATE OF ILLINOIS
 DEPARTMENT OF TRANSPORTATION

INTERCONNECT PLAN
 (SHEET 2 OF 5)

SCALE:	SHEET NO.	OF SHEETS	STA.	TO STA.
--------	-----------	-----------	------	---------

F.A.I. RTE.	SECTION	COUNTY	TOTAL SHEETS	SHEET NO.
153/2532	11-00297-00-TL	DUPAGE	38	29
CONTRACT NO. 63816				
FED. ROAD DIST. NO. ILLINOIS FED. AID PROJECT				