

PLAN	DATE
BY	
CHECKED	
DESIGNED	
NOTED	
NO.	

PROFILE	DATE
BY	
CHECKED	
DESIGNED	
NOTED	
NO.	

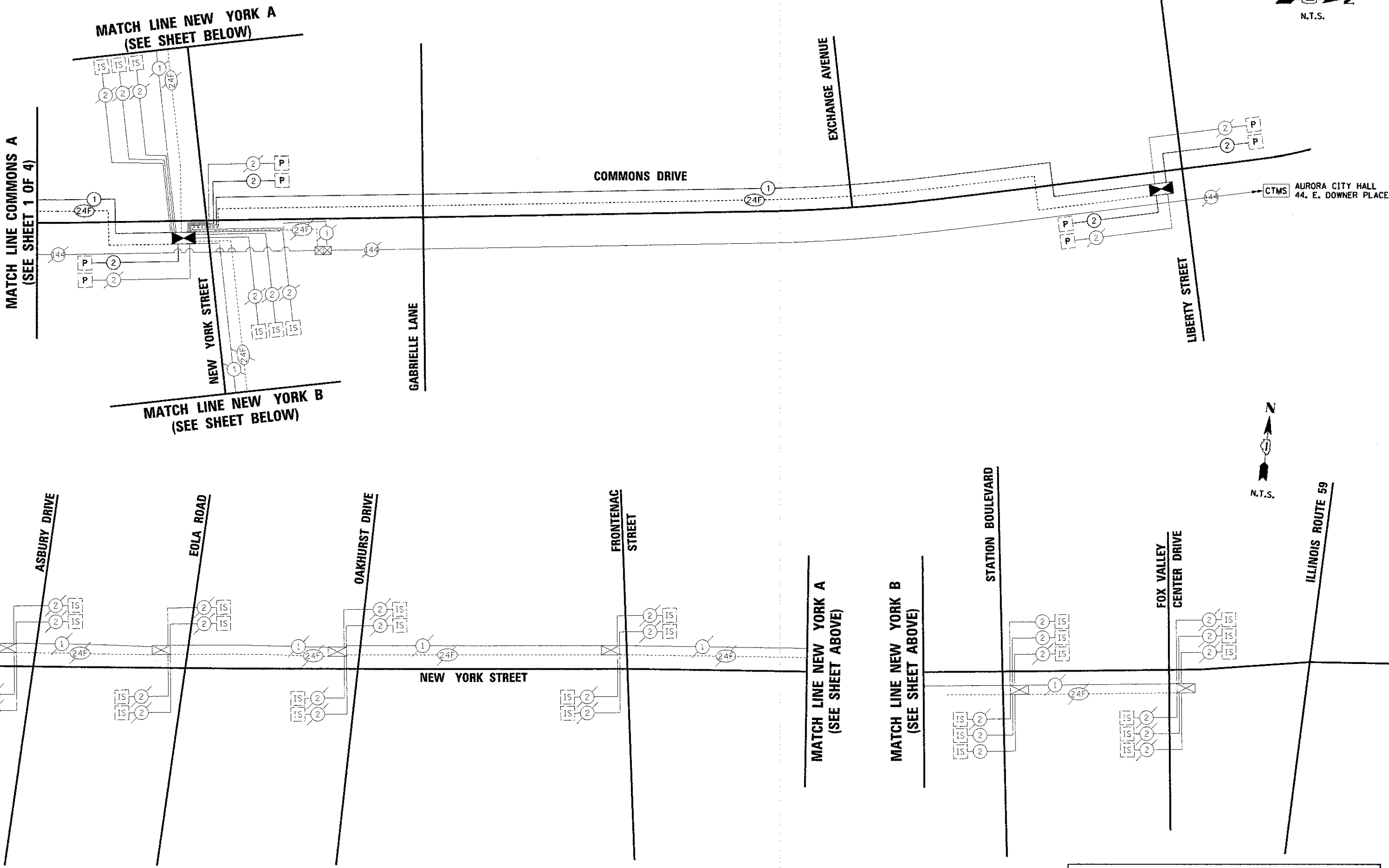

THE TRAFFIC SIGNAL CONTROL EQUIPMENT FOR THIS PROJECT SHALL BE "ECONOLITE" TO MATCH THE EXISTING ADJACENT SYSTEM.

	HRGreen.com Illinois Professional Design Firm #184-001322	USER NAME = M.Feller DESIGNED - M.J.F. CHECKED - APS DATE - 02/21/2013	REVISED - REVISED - REVISED - REVISED -	<b>STATE OF ILLINOIS</b> <b>DEPARTMENT OF TRANSPORTATION</b>	<b>INTERCONNECT SCHEMATIC</b> <b>(SHEET 2 OF 4)</b>	F.A.U. RTE. 1531/2532	SECTION 11-00297-00-TL	COUNTY DUPAGE	TOTAL SHEETS 38	SHEET NO. 34
	PLOT DATE = 2/22/2013 FILE NAME = 698_10_schem_02.dgn	SCALE:	SHEET NO. OF SHEETS			STA. TO STA.	CONTRACT NO. 63816	ILLINOIS FED. AID PROJECT		