

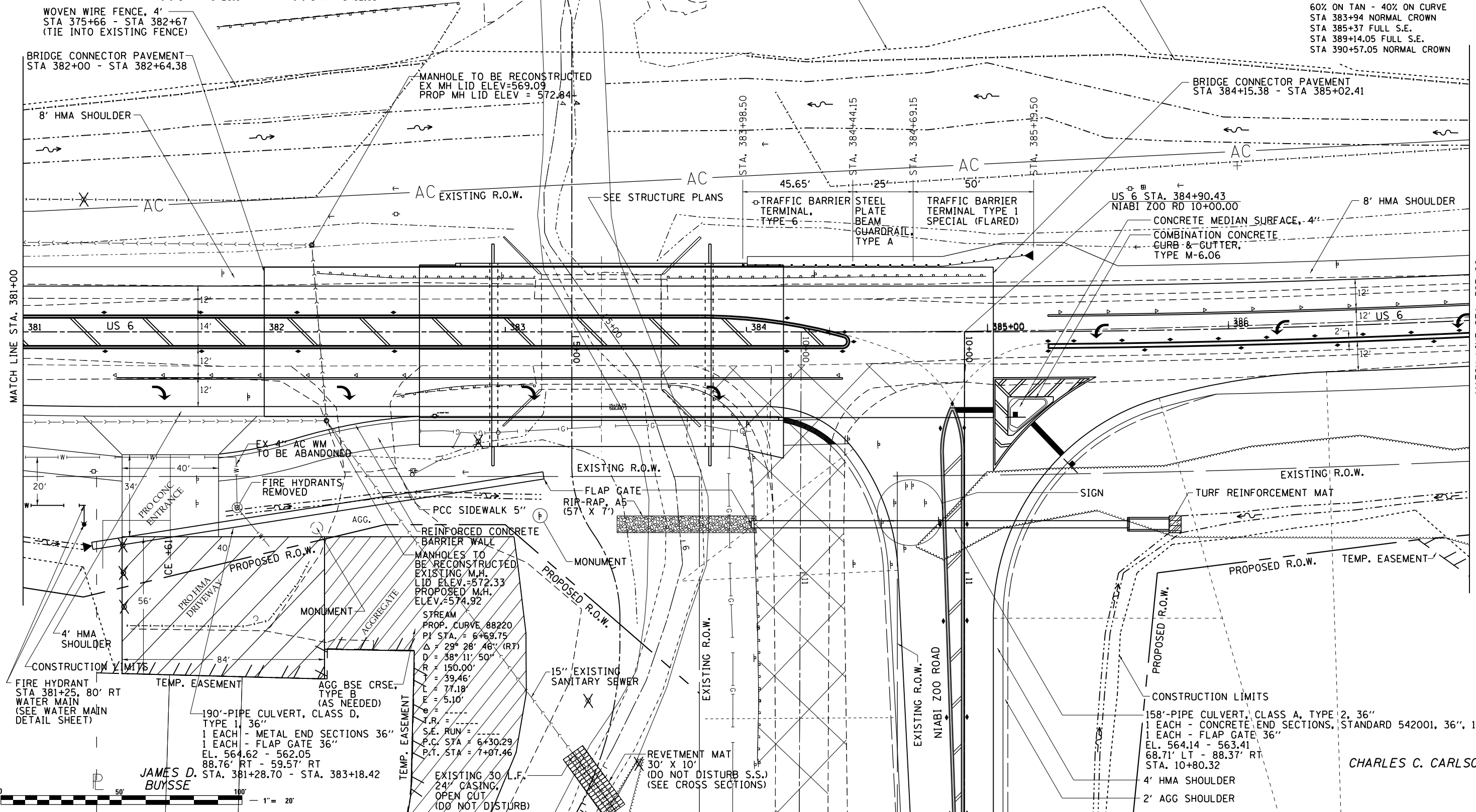

STREAM  
 PROP. CURVE 88210  
 PI STA. = 6+03.55  
 $\Delta = 33^\circ 39' 14''$  (RT)  
 D = 95° 29' 35"  
 R = 60.00'  
 T = 18.15'  
 L = 35.24'  
 E = 2.68'  
 e = -----  
 T.R. = -----  
 S.E. RUN = -----  
 P.C. STA = 5+85.40  
 P.T. STA = 6+20.64

STREAM  
 PROP. CURVE 88200  
 PI STA. = 5+68.40  
 $\Delta = 33^\circ 39' 14''$  (LT)  
 D = 114° 35' 30"  
 R = 50.00'  
 T = 15.12'  
 L = 29.37'  
 E = 2.24'  
 e = -----  
 T.R. = -----  
 S.E. RUN = -----  
 P.C. STA = 5+53.28  
 P.T. STA = 5+82.65

PROP. CURVE DATA  
 PI STA. = 387+25.73  
 $\Delta = 5^\circ 55' 16''$  (LT)  
 D = 1° 16' 24"  
 R = 4,500.00'  
 T = 232.73'  
 L = 465.05'  
 E = 6.01'  
 S.E. = 3.3%  
 T.R. = 33°  
 S.E. RUN = 110'  
 P.C. STA. = 384+93.00  
 P.T. STA. = 389+58.05  
 DISTRIBUTE S.E. :  
 60% ON TAN - 40% ON CURVE  
 STA 383+94 NORMAL CROWN  
 STA 385+37 FULL S.E.  
 STA 389+14.05 FULL S.E.  
 STA 390+57.05 NORMAL CROWN



FILE NAME =  
 USER NAME = duncanfa  
 DESIGNED -  
 DRAWN -  
 PLOT SCALE = 40.0000' / in.  
 CHECKED -  
 PLOT DATE = Mon Mar 25 17:10:17 2013  
 DATE -

REVISED -  
 REVISED -  
 REVISED -  
 REVISED -

STATE OF ILLINOIS  
 DEPARTMENT OF TRANSPORTATION

US 6  
 PLAN & PROFILE  
 SCALE: SHEET OF SHEETS STA. TO STA.

F.A.U. RTE.	SECTION	COUNTY	TOTAL SHEETS	SHEET NO.
5789	40BR	ROCK ISLAND	225	46
				CONTRACT NO. 64341
ILLINOIS FED. AID PROJECT				

JAMES D. BUISSE

CHARLES C. CARLSON