

PROP. CURVE STAGE1X01-1
 PI STA. = 1+11.71
 N: 1,854,108.9141
 E: 2,426,805.7765
 $\Delta = 12^\circ 19' 58''$ (LT)
 $D = 5^\circ 32' 28''$
 $R = 1,034.00'$
 $T = 111.71'$
 $L = 222.56'$
 $E = 6.02'$
 P.C. STA = 0+00.00
 N: 1,853,997.2026
 E: 2,426,805.1181
 P.T. STA = 2+22.56
 N: 1,854,218.1884
 E: 2,426,782.5596

PROP. CURVE STAGE1X01-2
 PI STA. = 3+35.58
 N: 1,854,328.7400
 E: 2,426,759.0714
 $\Delta = 12^\circ 19' 58''$ (RT)
 $D = 5^\circ 28' 38''$
 $R = 1,046.09'$
 $T = 113.02'$
 $L = 225.17'$
 $E = 6.09'$
 P.C. STA = 2+22.56
 N: 1,854,218.1884
 E: 2,426,782.5596
 P.T. STA = 4+47.73
 N: 1,854,441.7573
 E: 2,426,759.7375

STAGE 1

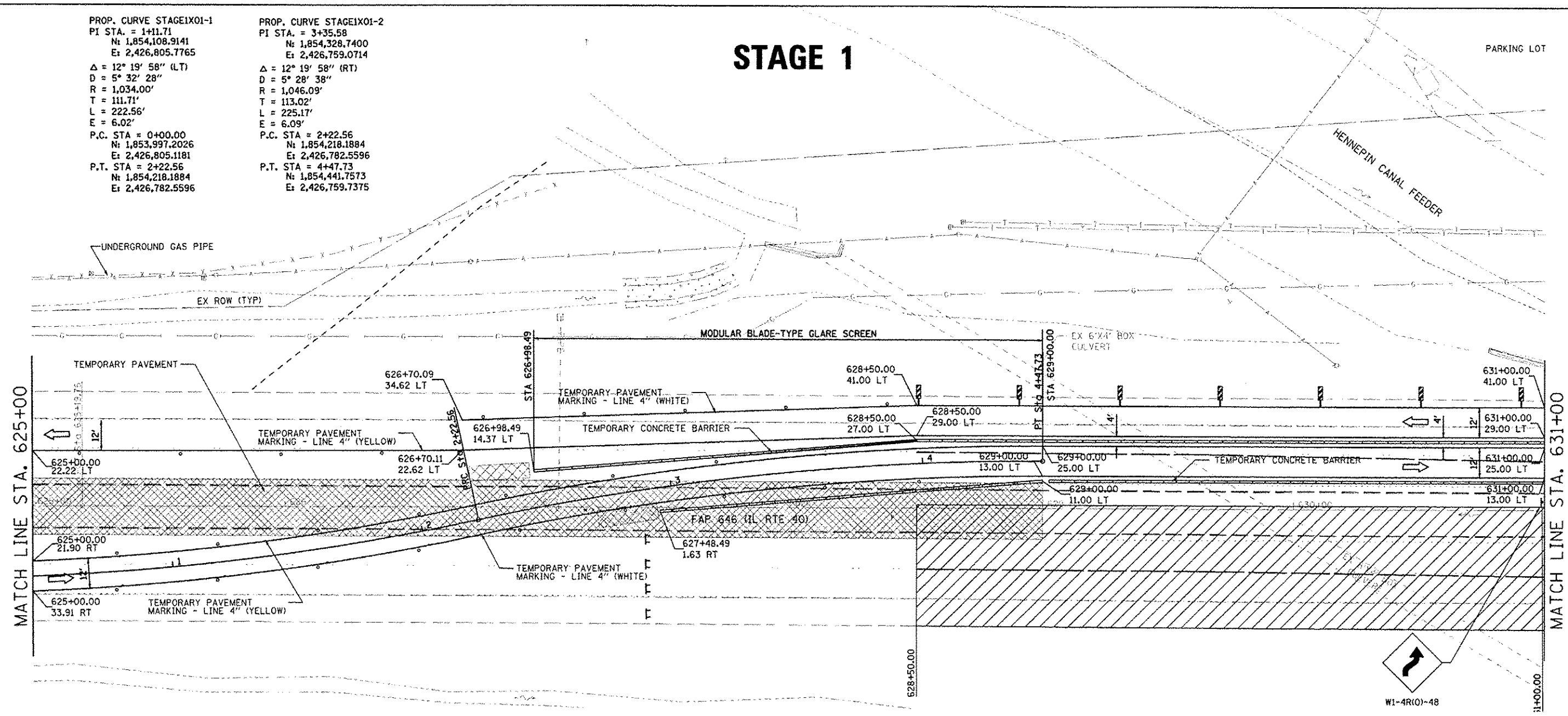

STAGE 1 NOTES:

1. CONSTRUCT THE EAST SIDE OF THE BRIDGE AND ROADWAY INCLUDING SHOULDERS AND GUARDRAIL.
2. INSTALL TEMPORARY CONCRETE BARRIER ACCORDING TO STANDARD 704001.
3. REFER TO STANDARD 701416 AND DISTRIC STANDARDS FOR ADDITIONAL SIGNS AND DEVICES NOT SHOWN.
4. BARRIER WALL OFFSETS ARE TO THE TRAFFIC SIDE OF THE WALL.
5. A CHECK BARRICADE SHALL BE PLACED IN THE MIDDLE OF THE CLOSED LANE AT THE SHOULDER AT 1000' CENTERS.
6. AT THE COMPLETION OF STAGE 1 CONSTRUCTION, ALL STAGE 1 TEMPORARY PAVEMENT MARKINGS SHALL BE REMOVED AND TEMPORARY PAVEMENT MARKINGS FOR THE WINTER SHUT DOWN STAGE SHALL BE INSTALLED.

LEGEND

- DRUM WITH STEADY BURNING MONODIRECTIONAL LIGHT AT 40' C-C SPACING
- ⊥ BARRICADE TYPE III WITH FLASHING LIGHTS, QUANTITY AS REQUIRED FOR PROPER CLOSURE TO SATISFACTION OF THE ENGINEER
- TEMPORARY PAVEMENT MARKING
- ▨ IMPACT ATTENUATORS, TEMPORARY (NON-REDIRECTIVE), TEST LEVEL 3
- ⊥ TRAFFIC SIGN
- ➔ DIRECTION OF TRAFFIC
- ▨ WORK ZONE

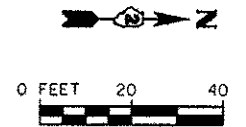

Rev. Sheet 2-20-13

FILE NAME = s:\p1\16308-6799\6246\025\microm\h1\028-1017-m1\stage1.dgn

| | | | | | | | | | | | | |
|--|---|----------------------|----------------|-----------|---|-----------------------------------|----------------------|----------------------------|---|------------------|--------------------|--------------|
| | 1170 SOUTH HOUBOLT ROAD JOLIET, ILLINOIS 60431 (815) 744-4200 | USER NAME = vaneesam | DESIGNED - VLF | REVISED - | STATE OF ILLINOIS DEPARTMENT OF TRANSPORTATION | MAINTENANCE OF TRAFFIC STAGE 1 | | F.A.P. RTE. 646 | SECTION 101 BR-3 | COUNTY WHITESIDE | TOTAL SHEETS 113 | SHEET NO. 36 |
| | PLOT SCALE = 40.0000' / IN. PLOT DATE = 2/18/2013 | | CHECKED - MAG | REVISED - | | SCALE: 1" = 20' | SHEET 7 OF 21 SHEETS | STA. 625+00 TO STA. 631+00 | FED. ROAD DIST. NO. 2 ILLINOIS FED. AID PROJECT | | CONTRACT NO. 64C17 | |