

STAGE 2

PROP. CURVE STAGE2X01-1
 PI STA. = 1+03.61
 N: 1,854,087.0619
 E: 2,426,759.6403
 $\Delta = 11^\circ 26' 38''$ (RT)
 $D = 5^\circ 32' 28''$
 $R = 1,034.00'$
 $T = 103.61'$
 $L = 206.52'$
 $E = 5.18'$
 P.C. STA = 0+00.00
 N: 1,853,983.4561
 E: 2,426,759.4847
 P.T. STA = 2+06.52
 N: 1,854,188.5771
 E: 2,426,780.3488

PROP. CURVE STAGE2X01-2
 PI STA. = 3+09.03
 N: 1,854,289.0165
 E: 2,426,800.8379
 $\Delta = 11^\circ 11' 32''$ (LT)
 $D = 5^\circ 28' 36''$
 $R = 1,046.20'$
 $T = 102.51'$
 $L = 204.36'$
 $E = 5.01'$
 P.C. STA = 2+06.52
 N: 1,854,188.5771
 E: 2,426,801.4421
 P.T. STA = 4+10.89
 N: 1,854,391.5226
 E: 2,426,801.4421

PARKING LOT

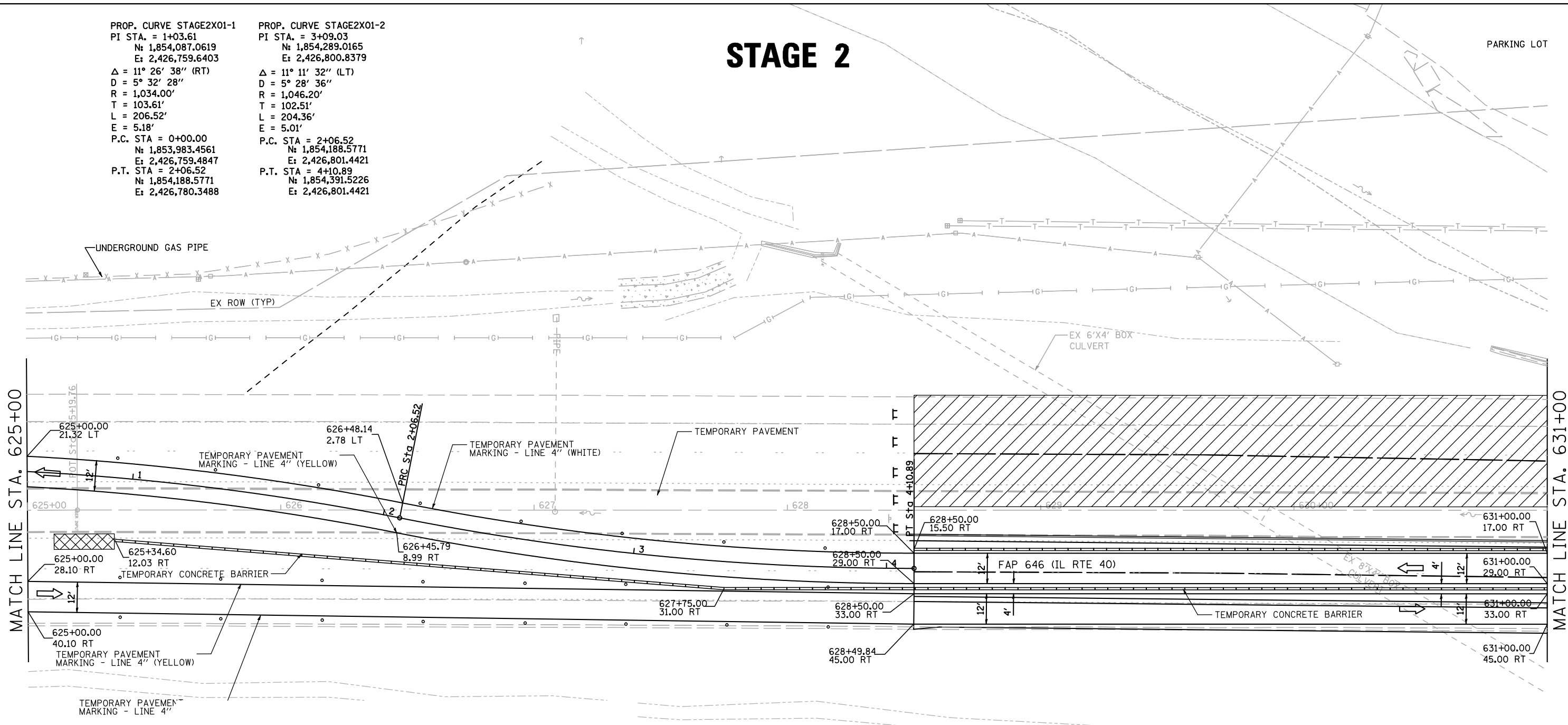

LEGEND

- DRUM WITH STEADY BURNING MONODIRECTIONAL LIGHT AT 40' C-C SPACING
- BARRICADE TYPE III WITH FLASHING LIGHTS, QUANTITY AS REQUIRED FOR PROPER CLOSURE TO SATISFACTION OF THE ENGINEER
- TEMPORARY PAVEMENT MARKING
- IMPACT ATTENUATORS, TEMPORARY (NON-REDIRECTIVE), TEST LEVEL 3
- TRAFFIC SIGN
- DIRECTION OF TRAFFIC
- WORK ZONE

STAGE 2 NOTES:

1. REFER TO STANDARD 701416 FOR ADDITIONAL SIGNS AND DEVICES NOT SHOWN.
2. RELOCATE TEMPORARY CONCRETE BARRIER ACCORDING TO STANDARD 704001.
3. CONSTRUCT WEST SIDE OF BRIDGE AND ROADWAY INCLUDING SHOULDERS AND GUARDRAIL.
4. INSTALL PERMANENT PAVEMENT MARKINGS USING STANDARD 701426.



FILE NAME = s:\p1\6380--6395\6346\025\macro\st\0264C17-sht-stageing18.dgn

1170 SOUTH HOUBOLT ROAD
 JOLIET, ILLINOIS 60431
 (815) 744-4200
STRAND ASSOCIATES

USER NAME = vanessam	DESIGNED - VLF	REVISED -
PLOT SCALE = 40.0000' / IN.	DRAWN - DJW	REVISED -
PLOT DATE = 10/15/2012	CHECKED - MAG	REVISED -
	DATE - 10-12-12	REVISED -

STATE OF ILLINOIS
DEPARTMENT OF TRANSPORTATION

MAINTENANCE OF TRAFFIC STAGE 2			
SCALE: 1" = 20'	SHEET 17	OF 21 SHEETS	STA. 625+00 TO STA. 631+00

F.A.P. RTE. 646	SECTION 101 BR-3	COUNTY WHITESIDE	TOTAL SHEETS 113	SHEET NO. 47
FED. ROAD DIST. NO. 2 ILLINOIS FED. AID PROJECT				CONTRACT NO. 64C17