

STAGE 2

PROP. CURVE STAGE2X02-1
 PI STA. = 0+95.82
 N: 1,855,237.3109
 E: 2,426,806.4273
 $\Delta = 10^\circ 35' 21''$ (LT)
 D = 5° 32' 28"
 R = 1,034.00'
 T = 95.82'
 L = 191.10'
 E = 4.43'
 P.C. STA = 0+00.00
 N: 1,855,141.4902
 E: 2,426,805.8625
 P.T. STA = 1+91.10
 N: 1,855,331.6036
 E: 2,426,789.3740

PROP. CURVE STAGE2X02-2
 PI STA. = 2+84.15
 N: 1,855,423.1683
 E: 2,426,772.8141
 $\Delta = 10^\circ 10' 01''$ (RT)
 D = 5° 28' 39"
 R = 1,046.00'
 T = 93.05'
 L = 185.61'
 E = 4.13'
 P.C. STA = 1+91.10
 N: 1,855,331.6036
 E: 2,426,789.3740
 P.T. STA = 3+76.71
 N: 1,855,516.2183
 E: 2,426,772.6771

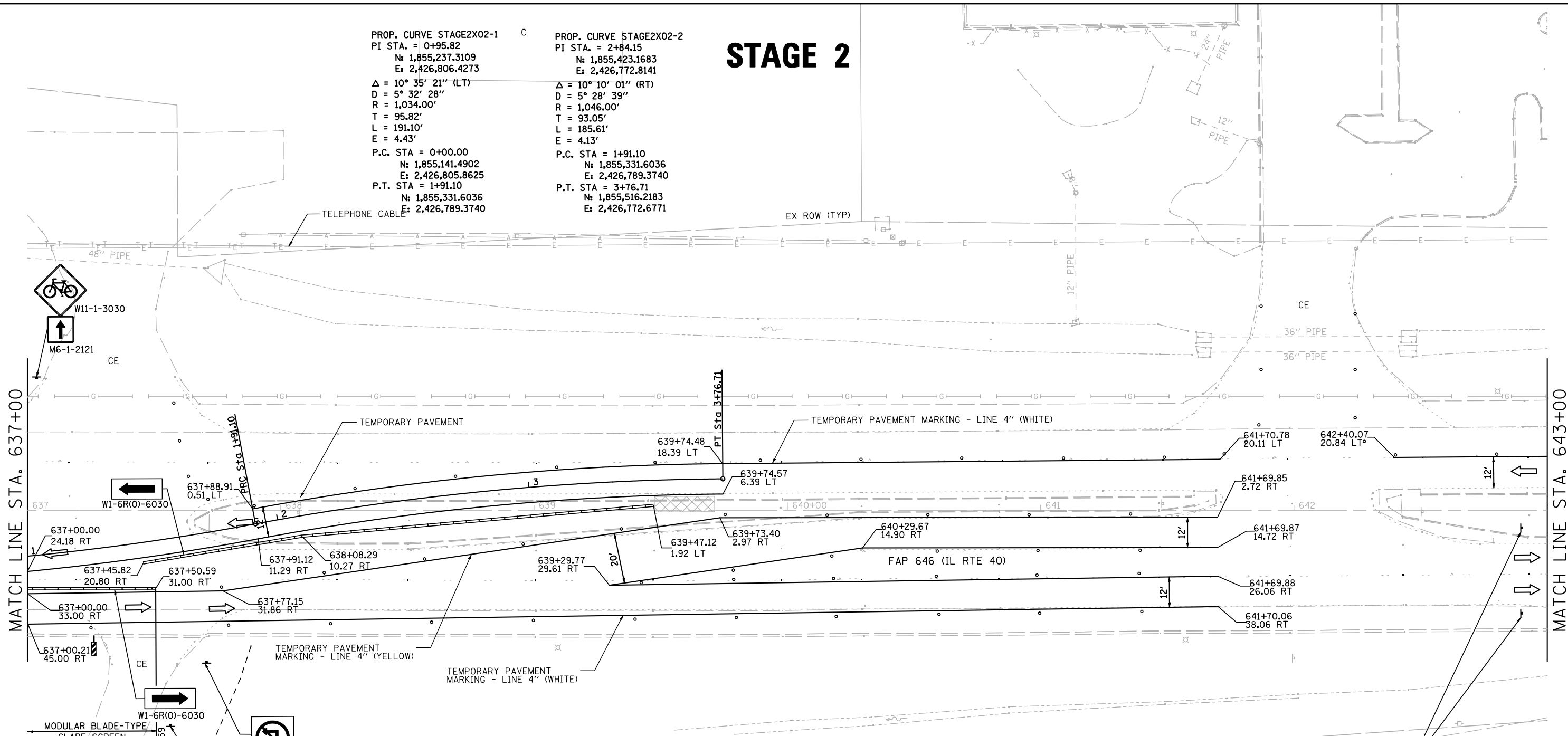

- LEGEND**
- DRUM WITH STEADY BURNING MONODIRECTIONAL LIGHT AT 40' C-C SPACING
 - BARRICADE TYPE III WITH FLASHING LIGHTS, QUANTITY AS REQUIRED FOR PROPER CLOSURE TO SATISFACTION OF THE ENGINEER
 - TEMPORARY PAVEMENT MARKING
 - IMPACT ATTENUATORS, TEMPORARY (NON-REDIRECTIVE), TEST LEVEL 3
 - TRAFFIC SIGN
 - DIRECTION OF TRAFFIC
 - WORK ZONE

- STAGE 2 NOTES:**
- REFER TO STANDARD 701416 FOR ADDITIONAL SIGNS AND DEVICES NOT SHOWN.
 - RELOCATE TEMPORARY CONCRETE BARRIER ACCORDING TO STANDARD 704001.
 - CONSTRUCT WEST SIDE OF BRIDGE AND ROADWAY INCLUDING SHOULDERS AND GUARDRAIL.
 - INSTALL PERMANENT PAVEMENT MARKINGS USING STANDARD 701426.



FILE NAME = S:\JUL6300-6399\6346\025\Microa\Sh\A\264C17-ahtr-segimg26.dgn



USER NAME = vanessam	DESIGNED - VLF	REVISED -
PLOT SCALE = 40.0000' / IN.	DRAWN - DJW	REVISED -
PLOT DATE = 10/16/2012	CHECKED - MAG	REVISED -
	DATE - 10-12-12	REVISED -

**STATE OF ILLINOIS
DEPARTMENT OF TRANSPORTATION**

**MAINTENANCE OF TRAFFIC
STAGE 2**

SCALE: 1" = 20' SHEET 19 OF 21 SHEETS STA. 637+00 TO STA. 643+00

F.A.P. RTE.	SECTION	COUNTY	TOTAL SHEETS	SHEET NO.
646	101 BR-3	WHITESIDE	113	49
CONTRACT NO. 64C17			FED. ROAD DIST. NO. 2 (ILLINOIS) FED. AID PROJECT	