

Notes:  
 See Sheet 22 of 35 for North Abutment details, Bill of Material, Plan-Pile Location and s(E) bar spacing.  
 Bars indicated thus 20 x 3-#5 etc. indicates 20 lines of bars with 3 lengths per line.  
 For details of Bar Splicers, See Sheet 32 of 35.  
 For details of piles and Concrete Encasement, See Sheet 30 of 35.  
 The back face of the MSE wall shall be flush against the side of the abutment. Adjust abutment length as required.

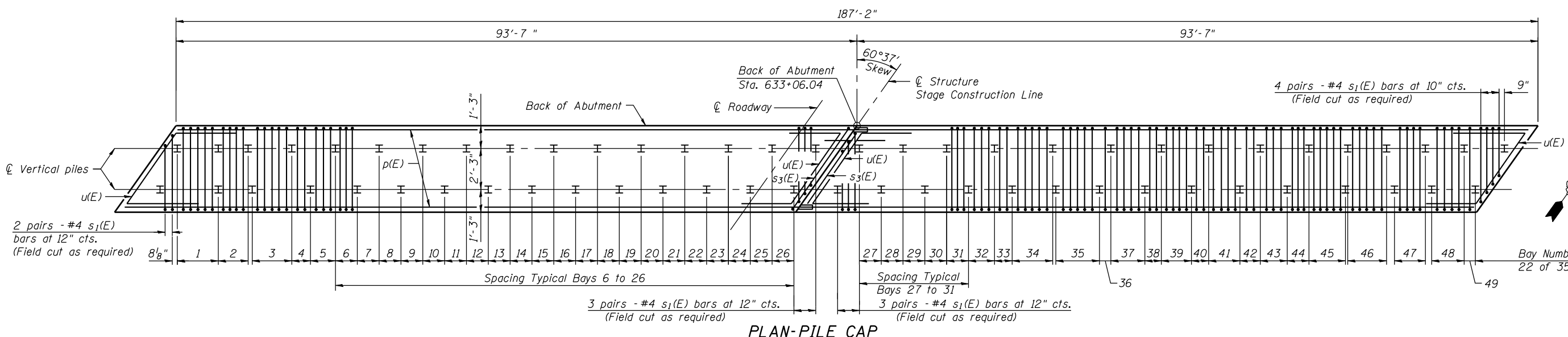
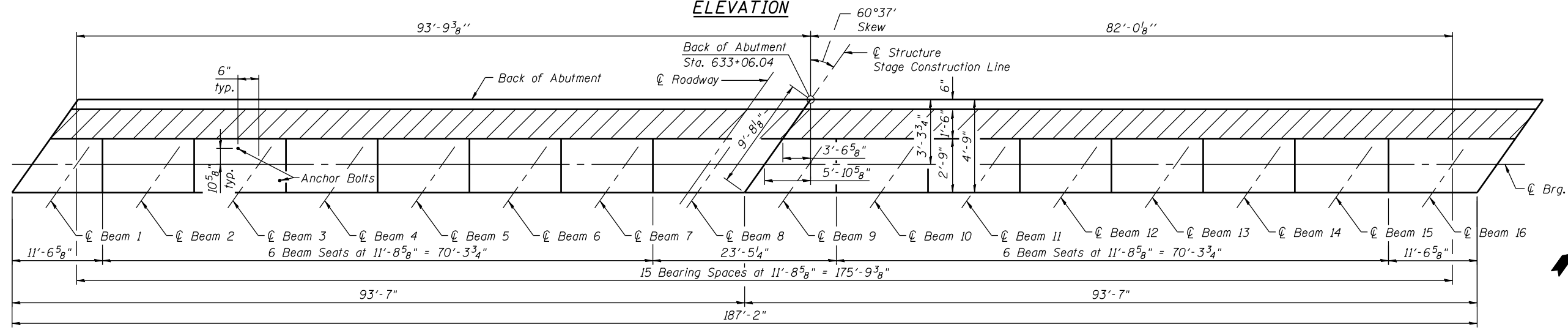
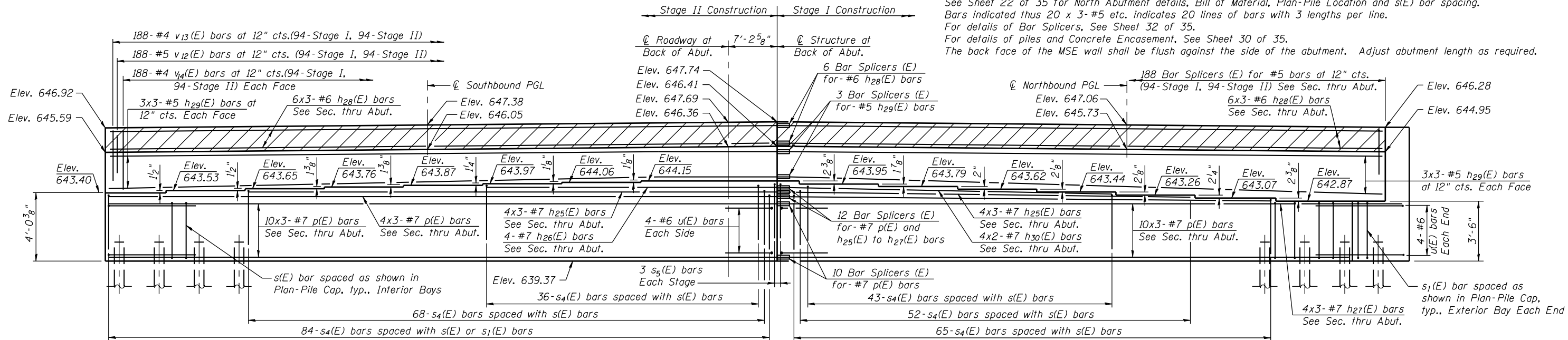

**MIN. BAR LAP**

- #4 bar=2'-0"
- #5 bar=3'-3"
- #6 bar=3'-10"
- #7 bar=5'-2"

FILE NAME = s:\p1\6380--6395\6346\025\Microa\Sh1\Structural\Plans\0980015-64C17-021-NABUT.dgn

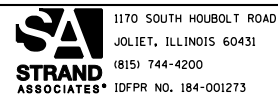

1170 SOUTH HOUBOLT ROAD  
 JOLIET, ILLINOIS 60431  
 (815) 744-4200  
 IDFPF NO. 184-001273

USER NAME = brianf  
 DESIGNED - RRD  
 CHECKED - AJS  
 PLOT SCALE =  
 PLOT DATE = 10/12/2012  
 DRAWN - BJF  
 CHECKED - RRD

REVISED  
 REVISED  
 REVISED  
 REVISED

**STATE OF ILLINOIS  
 DEPARTMENT OF TRANSPORTATION**

Note: Step Reinforcement Not Shown

**NORTH ABUTMENT DETAILS (1 OF 2)  
 STRUCTURE NO. 098-0015**

SHEET NO. 21 OF 35 SHEETS

F.A.P. RTE.	SECTION	COUNTY	TOTAL SHEETS	SHEET NO.
646	101 BR-3	WHITESIDE	113	77
CONTRACT NO. 64C17				
ILLINOIS FED. AID PROJECT				