

Existing Structure: Built as S.B.I. Rte. 68 Sec. 101 B-1 at Sta. 78+50 in 1961
 Existing spread P.P.C. Bms. with 7" concrete slab superstructure and R.C. piers. will be widened in kind. Traffic shall be maintained over the existing structure during construction.

STATE OF ILLINOIS
 DEPARTMENT OF TRANSPORTATION
 DIVISION OF HIGHWAYS

SHEET NO.	SECTION	COUNTY	TOTAL SHEETS	SHEET NO.
403	101 BR	WHITESIDE	589	270
SHEETS				

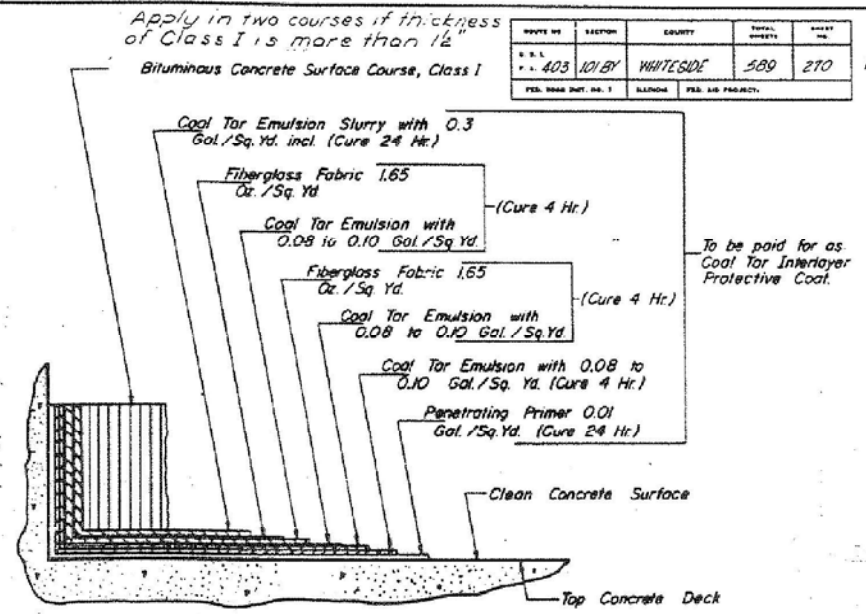
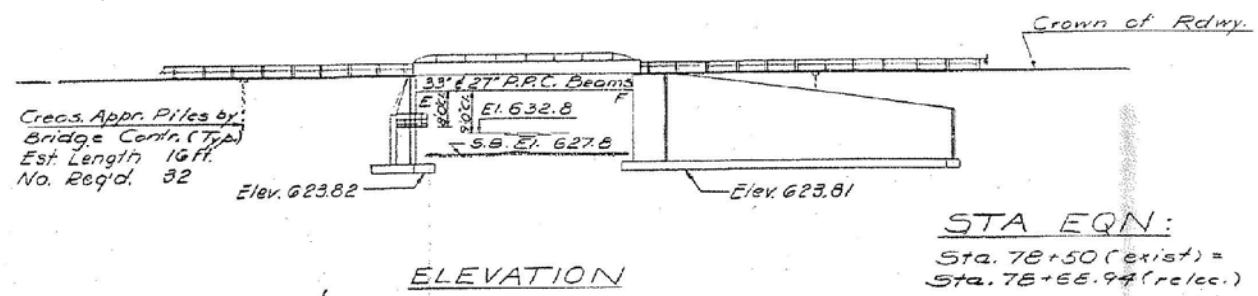

GENERAL NOTES

All reinforcement bars shall be lapped 24 diameters unless otherwise shown.

It shall be the responsibility of the Contractor to verify all dimensions and conditions existing in the field prior to construction and ordering of materials.

An alternate strand pattern using Extra High Strength Prestressing strand (270 ksi) is permitted.

Expansion bolts shall consist of self drilling expansion anchors and 3/4" hooked bolts. Hooked bolts shall extend a minimum of 12" into new concrete unless otherwise shown.

The concrete rail section above the mandatory construction joint of the top of the slab top of P.P.C. Bms. shall be constructed of Class X Concrete, except the aggregates shall conform to the requirements of Handrail Concrete.

The Basic Lead Silica Chromate paint system shall be used for shop painting of structural steel.

Expansion guards which are not cast in the precast unit shall be fabricated and erected in accordance with Article 503.07(c) of the Standard Specifications and are included in quantity of structural steel.

Protective Coat shall not be applied to surfaces to which Cool Tar Interlayer Protective Coat is applied.

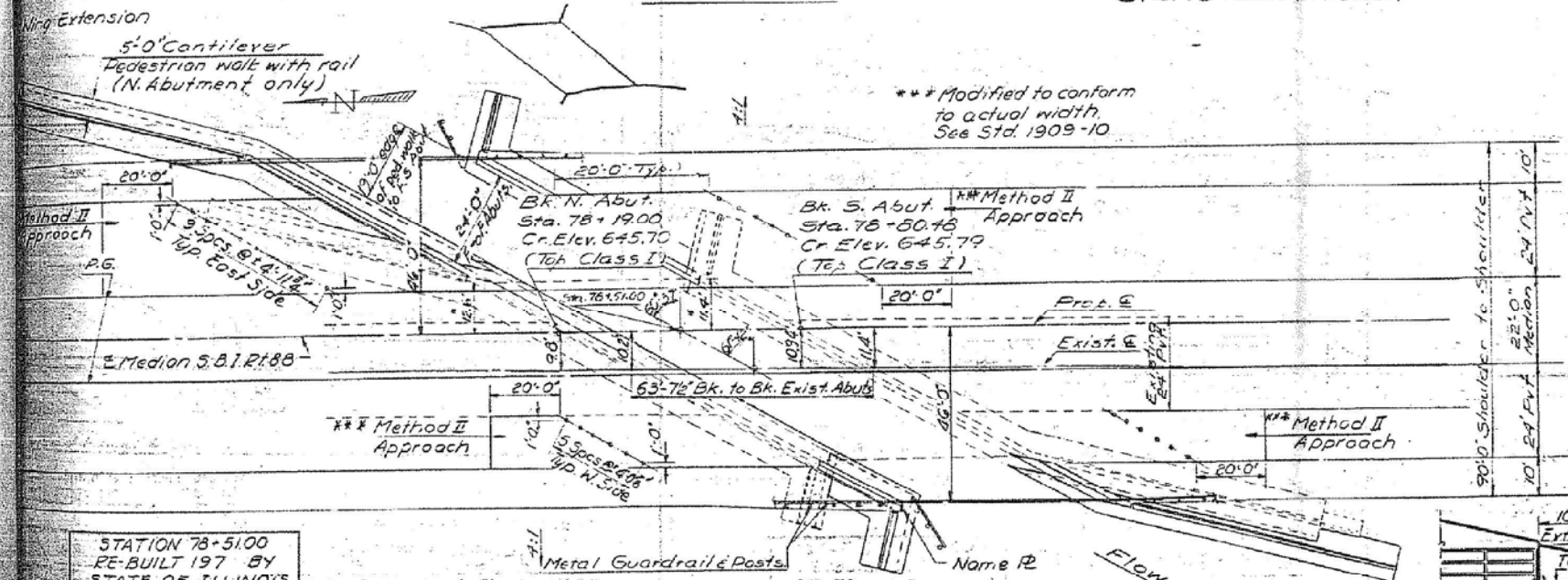

STATION 78+51.00
 RE-BUILT 197 BY
 STATE OF ILLINOIS
 S.B.I. RT-88 SEC. 101 BY
 LOADING HS 20

NAME PLATE
 See Std. 2113

RAILWAY INFORMATION

Not controlled and W.W. opening has been determined by navigation and recreational requirements.

DESIGNED	APR 11 1974
CHECKED	APR 11 1974
DRAWN	F. Mercado
APPROVED	APR 11 1974

* Field Measurements (E prop. Rdwy to Face Exist. Curbs at Back of Abutments)

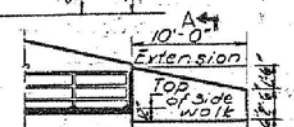

2.9 Cu. Yds. Class X Concrete included in Substructure Quantities.

PRECAST PRESTRESSED UNITS

- f'c = 5000 psi
- f'ci = 4000 psi
- f's = 248,000 psi (7 strands)
- f'si = 173,500 psi (7 strands)
- n = 10

FIELD UNITS

- f'c = 1200 psi (super)
- f'c = 1000 psi (sub)
- f's = 20000 psi (Reinf.)
- n = 10

New Constr. Loading HS 20-44

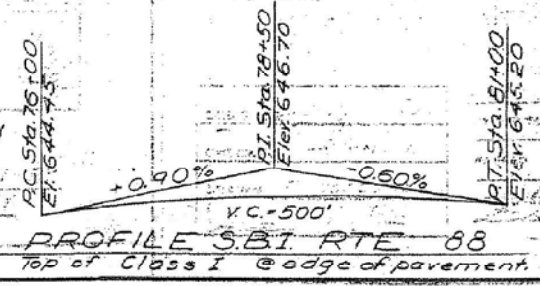

Weld wire fabric 6" x 6" mesh weighing 58#/100 Sq. Ft. Cost Incidental

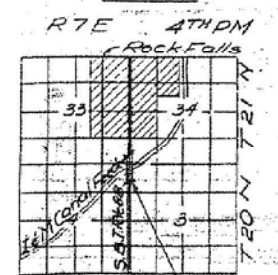
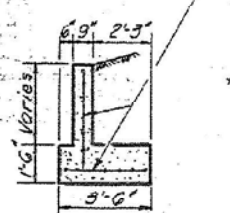

BILL OF MATERIALS

Item	Unit	Super	Sub	Total
Timber Buffers Complete	L. Sum.			L. Sum.
Structure Excavation	Cu. Yds.			760
Bituminous Concrete Surf. Cse. Class I	Tons	45		45
Concrete Removal	Cu. Yds.	11	344	454
Expansion Bolts (3/4")	Each	111	511	622
Class X Concrete	Cu. Yds.	642	6576	7218
P.P.C. Deck Bms. (27")	Sq. Ft.	1483		1483
P.P.C. Deck Bms. (33")	Sq. Ft.	494		494
Aluminum Fencing	Lin. Ft.	112		112
Reinforcement Bars	Lbs.	8540	71670	80210
Cool Tar Interlayer Protect Coat	Sq. Yds.	448		448
Name Plates	Each	1		1
Preformed Joint Sealer	Lin. Ft.	184		184
Structural Steel	Lbs.	3580		3580
Untreated Piles (Up to 30')	Lin. Ft.		5628	5628
Test Piles (Timber)	Each		4	4
Protective Coat	Sq. Yds.	42		42
Crested Piles (Up to 20')	Lin. Ft.		512	512

** Includes 2.9 Cu. Yds. Wing Extension.

GENERAL PLAN & ELEVATION
 S.B.I. RT-88 OVER I:M CANAL
 S.B.I. RT-88 (EA. 40) SEC. 101 BY
 WHITESIDE COUNTY
 STA. 78+51.00

FILE NAME = s:\p1\6380-6395\6346\025\Micro\Shr\Structure\Plans\0980015-64C17-033-EPPE.dgn

For Information only