

BOX CULVERT PLAN
IL RTE 84
F.A.P. RTE 570 SECTION 101T
JO DAVIESS COUNTY
STA. 1494 + 03
STR. NO. 043-1100

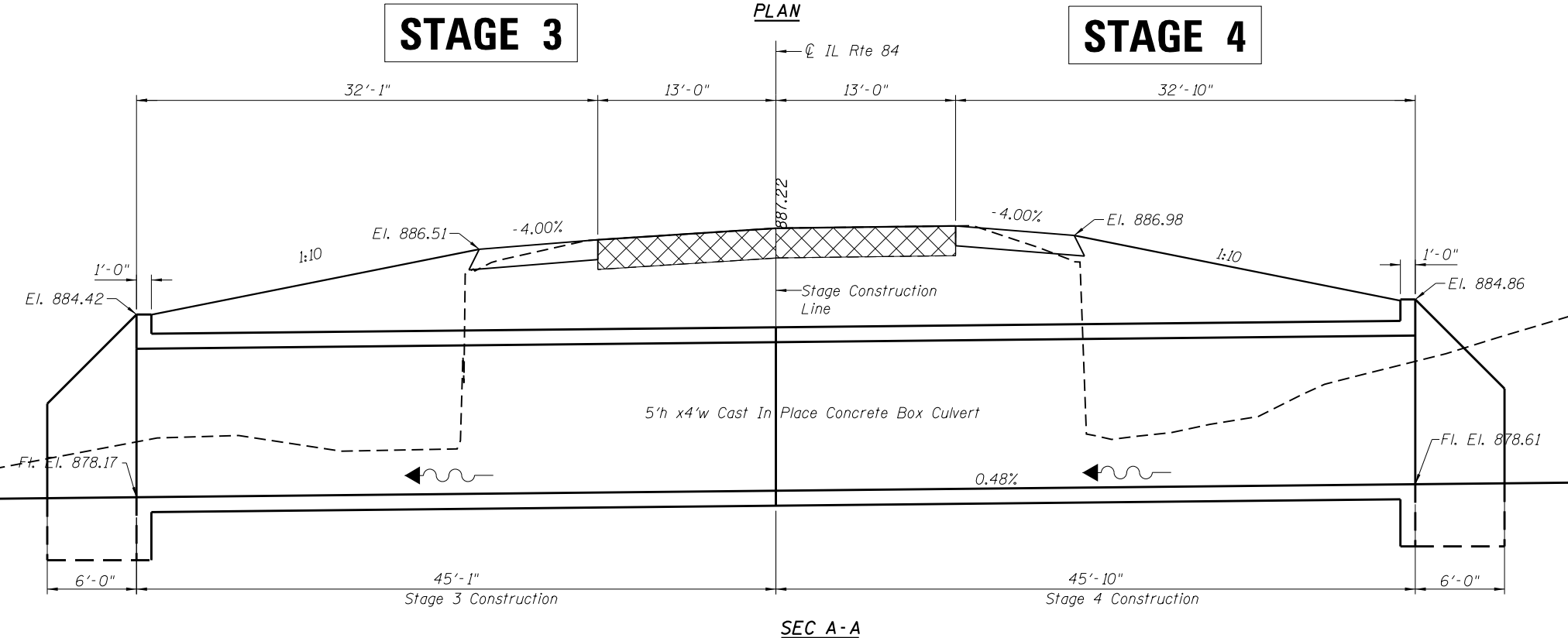
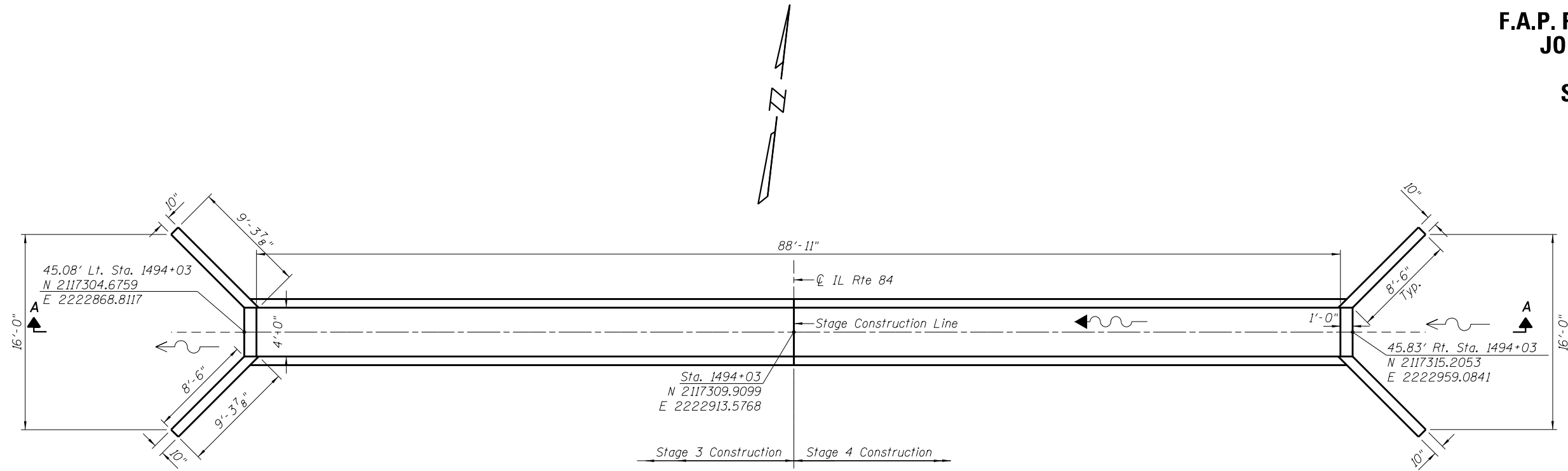

TOTAL BILL OF MATERIAL - STA. 1494+03

Item	Unit	Quantity
Concrete Box Culverts	Cu.Yd.	46.1
Reinforcement Bars, Epoxy Coated	Pound	6460
Bar Splicers	Each	27

DESIGN STRESSES
 $f_y = 60,000 \text{ psi}$
 $f'_c = 4,000 \text{ psi}$

LOADING HL-93

WENDLER ENGINEERING SERVICES, INC.
 Illinois Professional Design
 Firm No. 184-000848
 Sheets 1, 2, & 3 Only
 For Structural Adequacy Only

DATE
 SCOTT A. BROWN
 DIXON, ILLINOIS
 ILLINOIS LICENSED STRUCTURAL
 ENGINEER NO. 081-005981
 EXPIRES 11-30-2014