

NOTES:

- EXISTING SHOULDER INLETS AND FRAMES SHALL REMAIN IN PLACE AND INCORPORATED INTO THE NEW CONSTRUCTION. IF THE CONTRACTOR'S CONSTRUCTION OPERATIONS CAUSE DAMAGE TO THE INLET OR FRAME, THE DAMAGED ITEM SHALL BE REMOVED AND REPLACED AT THE CONTRACTOR'S EXPENSE. EXISTING SHOULDER GRATES SHALL BE REMOVED, STORED AND REPLACED WHEN ALL TEMPORARY TRAFFIC CONTROL DEVICES HAVE BEEN REMOVED.
- THE EXISTING SHOULDER INLETS SHALL BE COVERED WITH STEEL PLATE(S) AT THE DIRECTION OF THE ENGINEER WHENEVER TEMPORARY TRAFFIC CONTROL DEVICES ARE IN PLACE. THE STEEL PLATES SHALL BE RECESSED WITHIN THE LIMITS OF THE INLET. THE CONTRACTOR SHALL MONITOR THE MOVEMENT OF THE PLATED INLETS SO THAT THEY DO NOT INTERFERE WITH MOVING TRAFFIC. IF THE PLATES SHOW SIGNS OF MOVEMENT UNDER TRAFFIC, THE CONTRACTOR SHALL PROVIDE POSITIVE MEANS OF ANCHORING THE STEEL PLATES TO EXISTING FRAME. METHOD OF ANCHORING THE STEEL PLATES SHALL BE SUBJECT TO THE APPROVAL OF THE ENGINEER. COST OF FURNISHING AND PLACING THE STEEL PLATES SHALL NOT BE PAID FOR SEPARATELY BUT SHALL BE INCLUDED IN THE COST OF THE SHOULDER REMOVAL AND REPLACEMENT ITEMS.

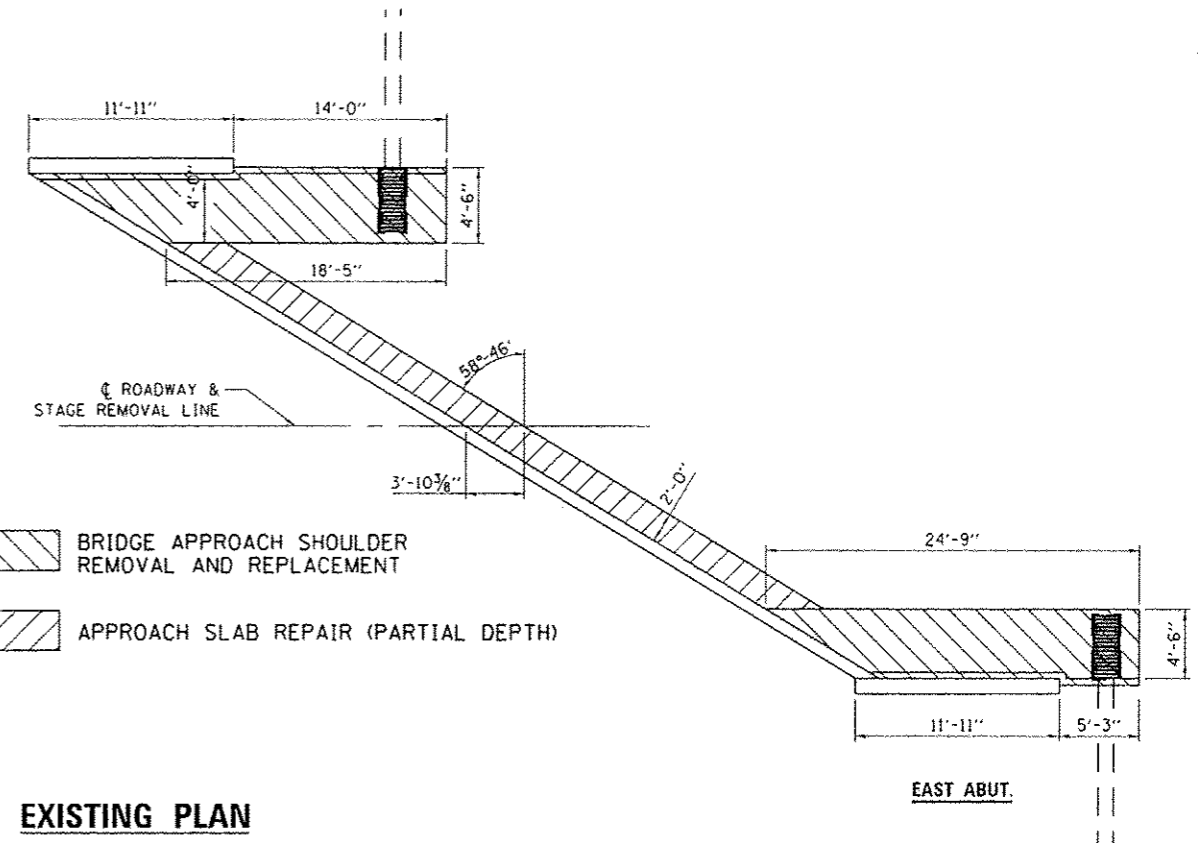
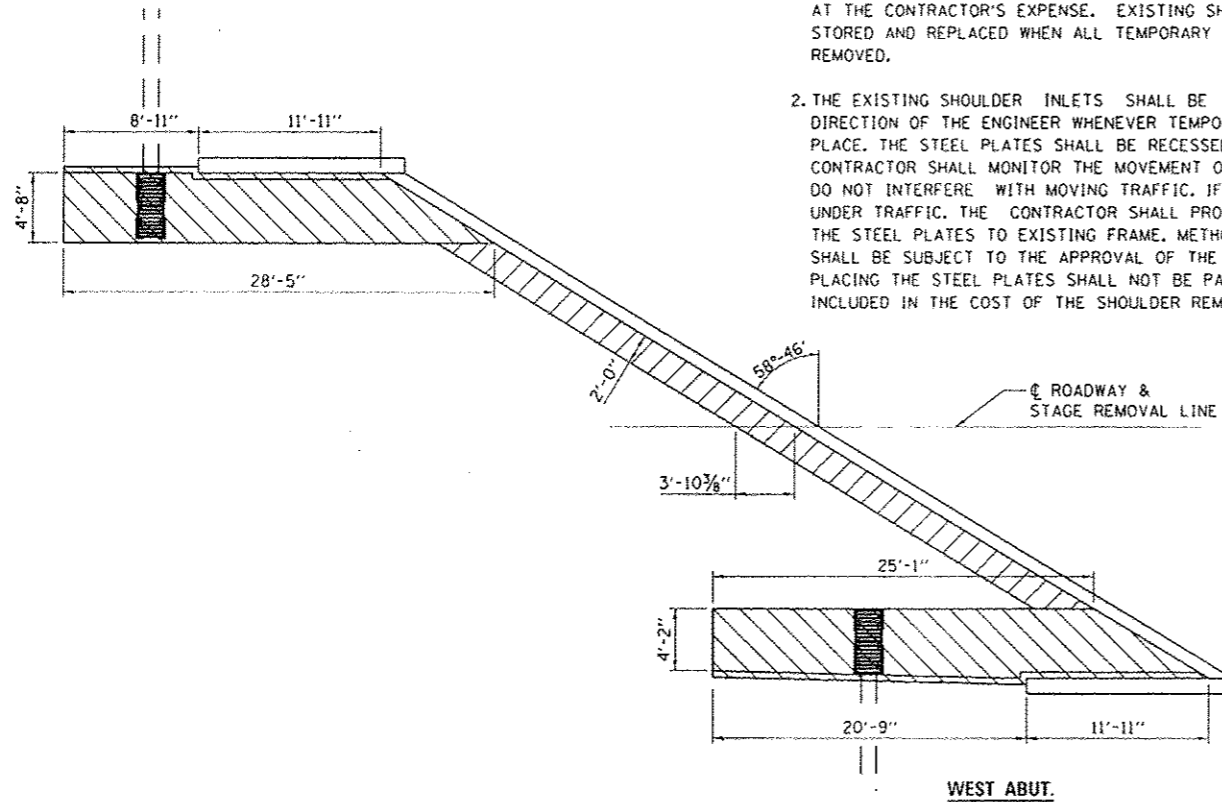

BRIDGE APPROACH SHOULDER REMOVAL AND REPLACEMENT

APPROACH SLAB REPAIR (PARTIAL DEPTH)

EXISTING PLAN

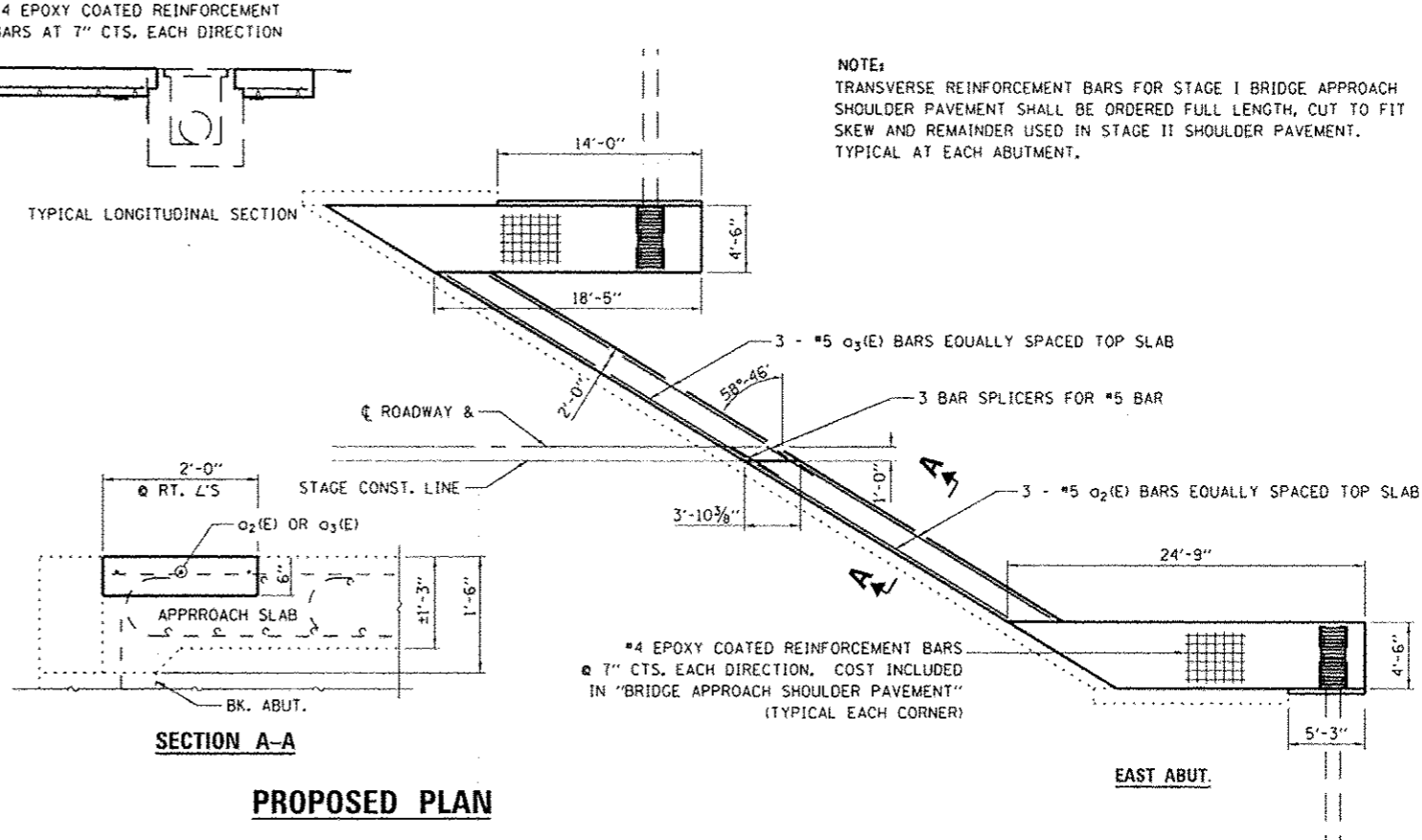
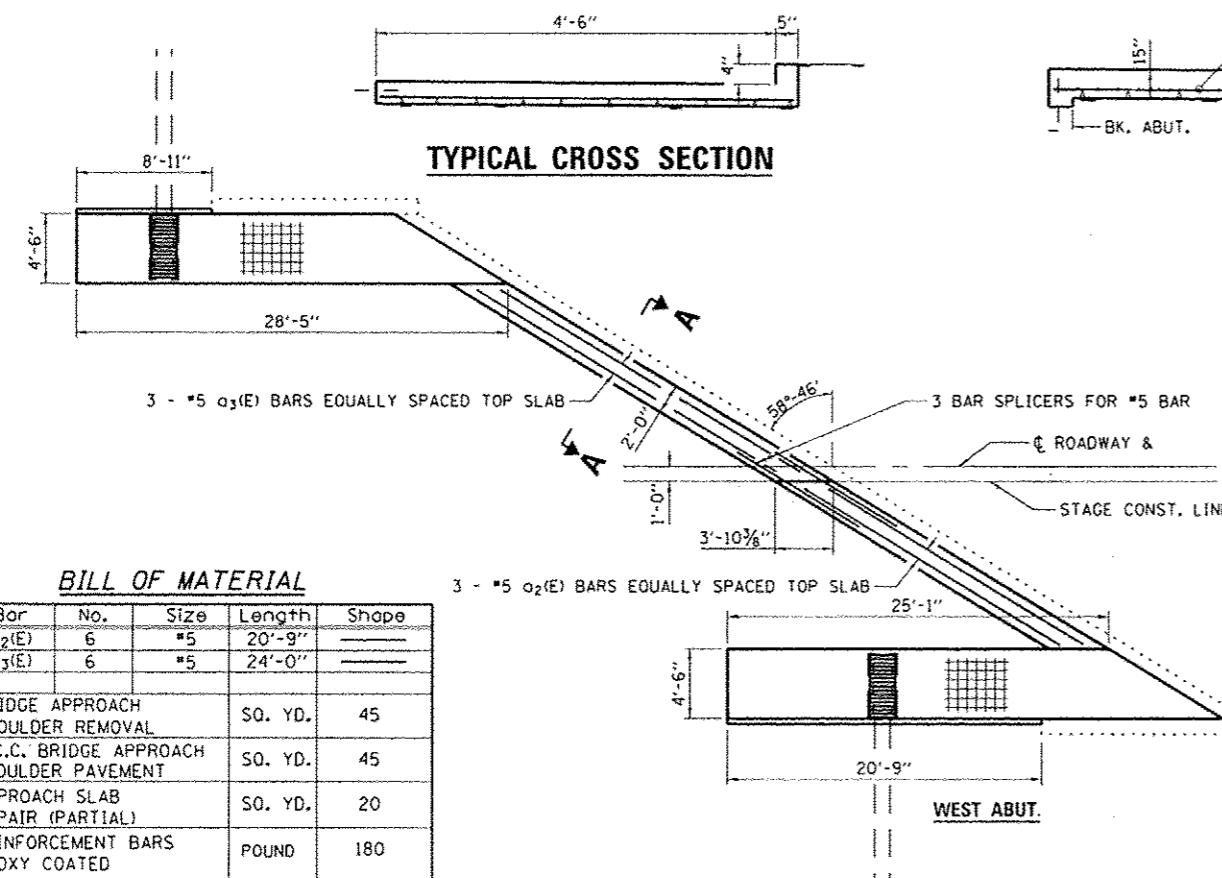

NOTE:
TRANSVERSE REINFORCEMENT BARS FOR STAGE I BRIDGE APPROACH SHOULDER PAVEMENT SHALL BE ORDERED FULL LENGTH, CUT TO FIT SKEW AND REMAINDER USED IN STAGE II SHOULDER PAVEMENT. TYPICAL AT EACH ABUTMENT.

TYPICAL CROSS SECTION

TYPICAL LONGITUDINAL SECTION

SECTION A-A

PROPOSED PLAN

BILL OF MATERIAL

Bar	No.	Size	Length	Shape
a ₂ (E)	6	#5	20'-9"	
a ₃ (E)	6	#5	24'-0"	
BRIDGE APPROACH SHOULDER REMOVAL			SQ. YD.	45
P.C.C. BRIDGE APPROACH SHOULDER PAVEMENT			SQ. YD.	45
APPROACH SLAB REPAIR (PARTIAL)			SQ. YD.	20
REINFORCEMENT BARS EPOXY COATED			POUND	180

FILE NAME: c:\pwwork\pwwork\woodshankr\1\0320292\36665-shr\details.dgn
 USER NAME: woodshankr
 PLOT SCALE: 1/8"=1'-0"
 PLOT DATE: 3/22/2013

DESIGNED - RW
 DRAWN - RW
 CHECKED - ARS
 DATE -

STATE OF ILLINOIS
 DEPARTMENT OF TRANSPORTATION

APPROACH SLAB DETAILS
 FOR STRUCTURE NO. 019-0032

SCALE: SHEET NO. 3 OF 15 SHEETS STA. 356+13.85 TO STA. 359+13.60

F.A.P. RTE. 573	SECTION (116VB-1-1BR)	COUNTY DEKALB	TOTAL SHEETS 21	SHEET NO. 9
CONTRACT NO. 66C65			ILLINOISIFIED A10 PROJECT	