

F.A.P. RTE.	SECTION	COUNTY	TOTAL SHEETS	SHEET NO.
665	(144-B-1)BR	FULTON	48	1
		ILLINOIS	CONTRACT NO. 68778	

SEE SHEET 2 FOR INDEX OF SHEETS,
GENERAL NOTES, AND STANDARDS

STATE OF ILLINOIS
DEPARTMENT OF TRANSPORTATION
DIVISION OF HIGHWAYS

**PROPOSED
HIGHWAY PLANS**
FAP ROUTE 665 (IL 116)
SECTION (144-B-1)BR
BRIDGE REPLACEMENT & ROADWAY IMPROVEMENTS
FULTON COUNTY
C-94-017-08
PROJECT ACF-0665(015)

D-94-016-08

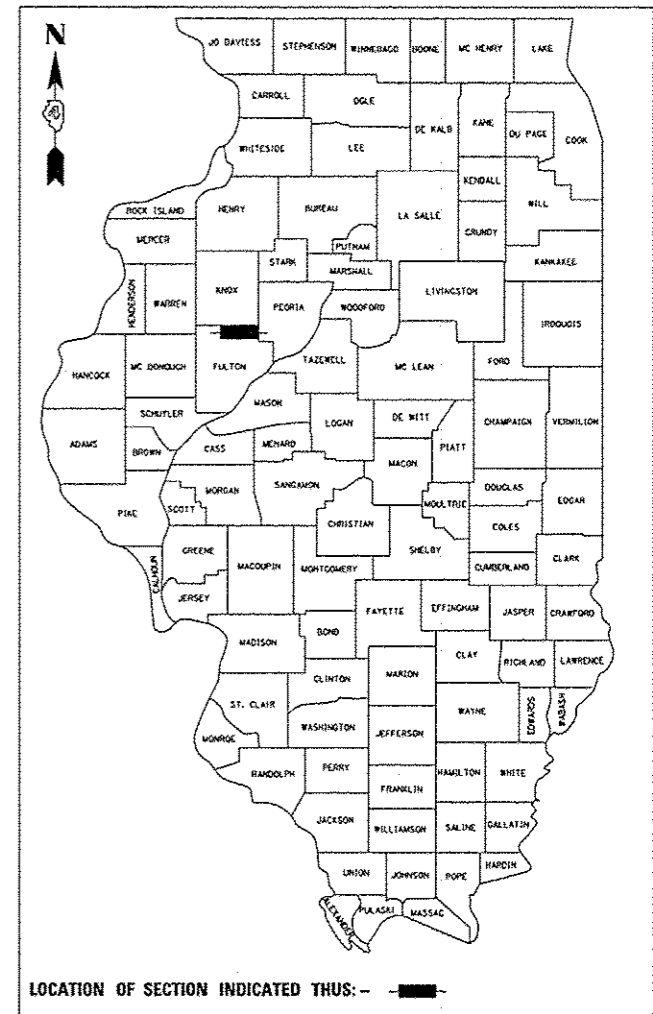

**IMPROVEMENTS LOCATED IN
FAIRVIEW TOWNSHIP**

ADT: 1,500(2007)
POSTED SPEED: 55 MPH

ALIGNMENT, TIES, BENCHMARKS	HORIZONTAL	0 50' 100'
PLAN & PROFILE	HORIZONTAL	0 20' 40'
	VERTICAL	0 5' 10'
MAINTENANCE OF TRAFFIC	HORIZONTAL	0 50' 100'
EROSION CONTROL PLAN	HORIZONTAL	0 20' 40'
	VERTICAL	0 5' 10'
CROSS SECTIONS	HORIZONTAL	0 2.5' 5'
	VERTICAL	0 2.5' 5'

FULL SIZE PLANS HAVE BEEN PREPARED USING STANDARD
ENGINEERING SCALES. REDUCED SIZED PLANS WILL NOT
CONFORM TO STANDARD SCALES. IN MAKING MEASUREMENTS
ON REDUCED PLANS, THE ABOVE SCALES MAY BE USED.

J.U.L.I.E.
JOINT UTILITY LOCATION INFORMATION FOR EXCAVATION
1-800-892-0123
OR 811

PROJECT MANAGER: MICHAEL MOHAMMED (309)671-3462
PROJECT ENGINEER: CHRISTOPHER MAUSHARD (309)671-3453
CONTRACT NO. 68778
CATALOG NO. 033710-00D

R 3E - 4th P.M.

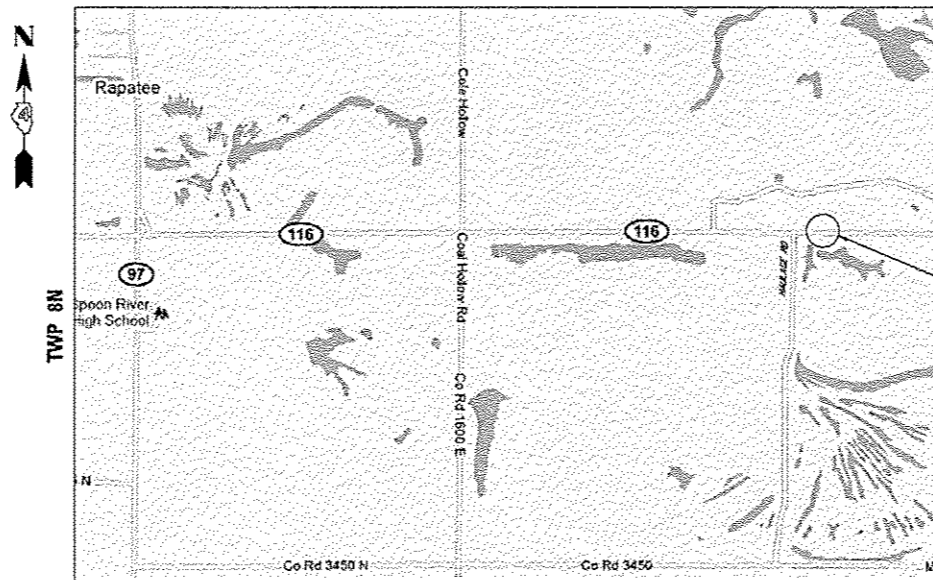

FAIRVIEW TOWNSHIP



LOCATION MAP

GROSS AND NET LENGTH = 440.64 FT = 0.083 MILE

IMPROVEMENT LOCATION

IL ROUTE 116 OVER AN
UNNAMED DRAINAGE AREA
EXISTING STRUCTURE: 029-0041
PROPOSED STRUCTURE: 029-0075
BEGIN PROJECT: STA. 396+13.48
END PROJECT: STA. 400+54.12



PREPARED BY:
LIN ENGINEERING, LTD.
WESTMONT, IL 60559
(630) 323-5168

STATE OF ILLINOIS
DEPARTMENT OF TRANSPORTATION
DIVISION OF HIGHWAYS

SUBMITTED Jan 30, 20 13
Joseph Phocopus
DEPUTY DIRECTOR OF HIGHWAYS, REGION ENGINEER
March 22, 20 13
John D. Baranzoli, P.E.
ENGINEER OF DESIGN AND ENVIRONMENT
March 22, 20 13
Ona Osman, P.E.
DIRECTOR OF HIGHWAYS, CHIEF ENGINEER



Fred M. Lin

FRED M. LIN, P.E.
ILLINOIS REGISTERED ENGINEER NO. 062-056704
REGISTRATION EXPIRES NOV. 30, 2013

**PRINTED BY THE AUTHORITY
OF THE STATE OF ILLINOIS**