

# LOCATION 6 S.N. 072-0134 INFORMATION ONLY

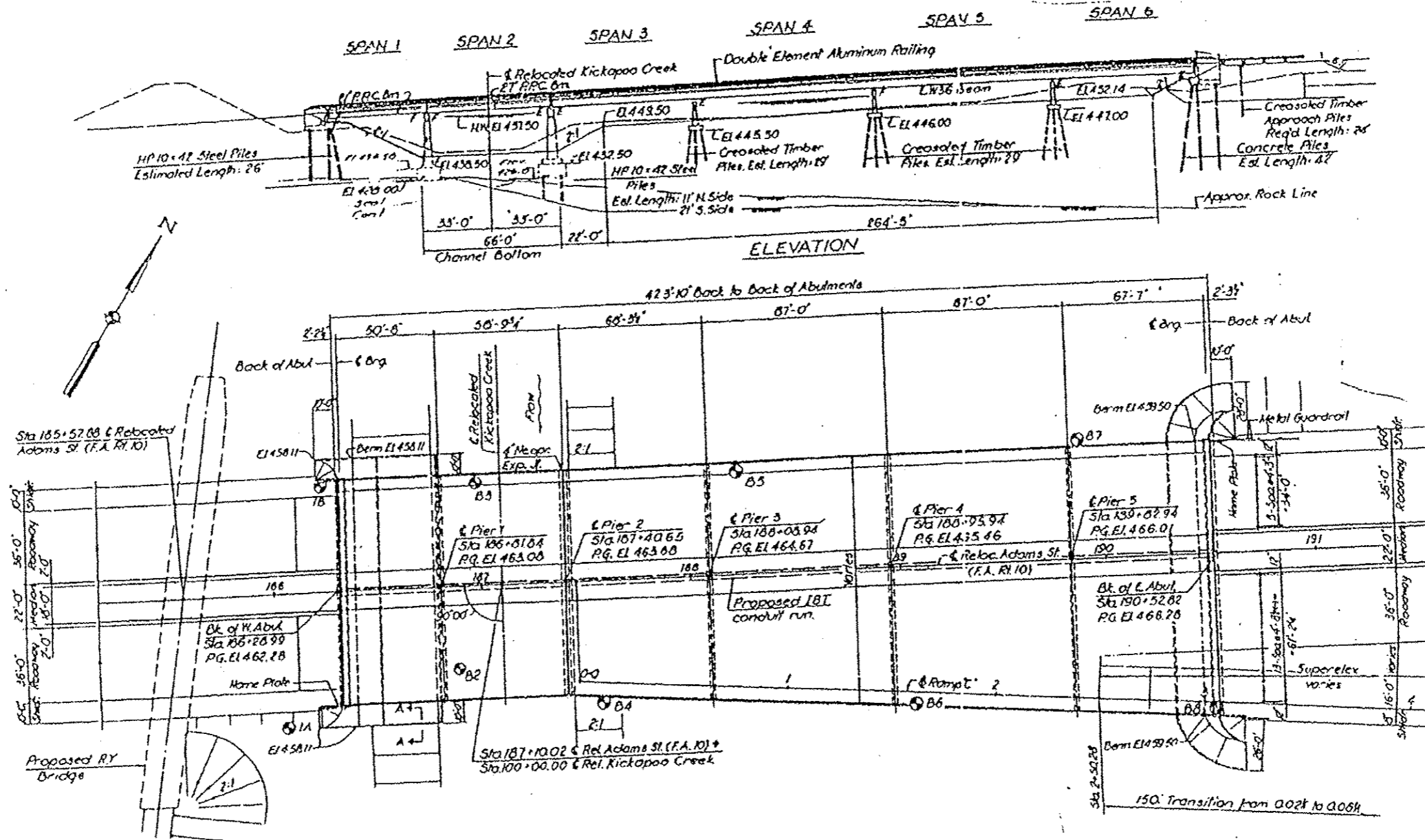

FILE NAME April 2013 bridge painting.dgn	USER NAME TOM INGLIS	DESIGNED TOM INGLIS	REVISED -	<b>STATE OF ILLINOIS DEPARTMENT OF TRANSPORTATION</b>	<b>LOCATION 5 TRUSS DETAILS</b>	F.A. RTE. VAR	SECTION D4 BRIDGE PAINTING 2012	COUNTY VARIOUS	TOTAL SHEETS 21	SHEET NO. 18		
Default	PLOT SCALE 48.0000' / in.	CHECKED NICK JACK	REVISED -			SCALE: N/A	SHEET OF SHEETS	STA.	TO STA.	CONTRACT NO. 68B26		
	PLOT DATE 2/22/2013	DATE 2/6/13	REVISED -			ILLINOIS FED. AID PROJECT						