

STATE OF ILLINOIS
DEPARTMENT OF TRANSPORTATION
DIVISION OF HIGHWAYS

**PROPOSED
HIGHWAY PLANS**

FAP ROUTE 63 (US 24 & IL 96), FAP 506 (IL 96)
SECTION (1)N,TS-2,RS-5&(78)RS-3
PROJECT F-HSIP-0008(915)
RESURFACING (SMART), INTERSECTION
IMPROVEMENT, & TRAFFIC SIGNALS
ADAMS COUNTY
C-96-059-11

F.A.P. RTE.	SECTION	COUNTY	TOTAL SHEETS	SHEET NO.
63	(1)N,TS-2,RS-5&(78)RS-3	ADAMS	194	1
		ILLINOIS	CONTRACT NO. 72E31	

D-96-059-11

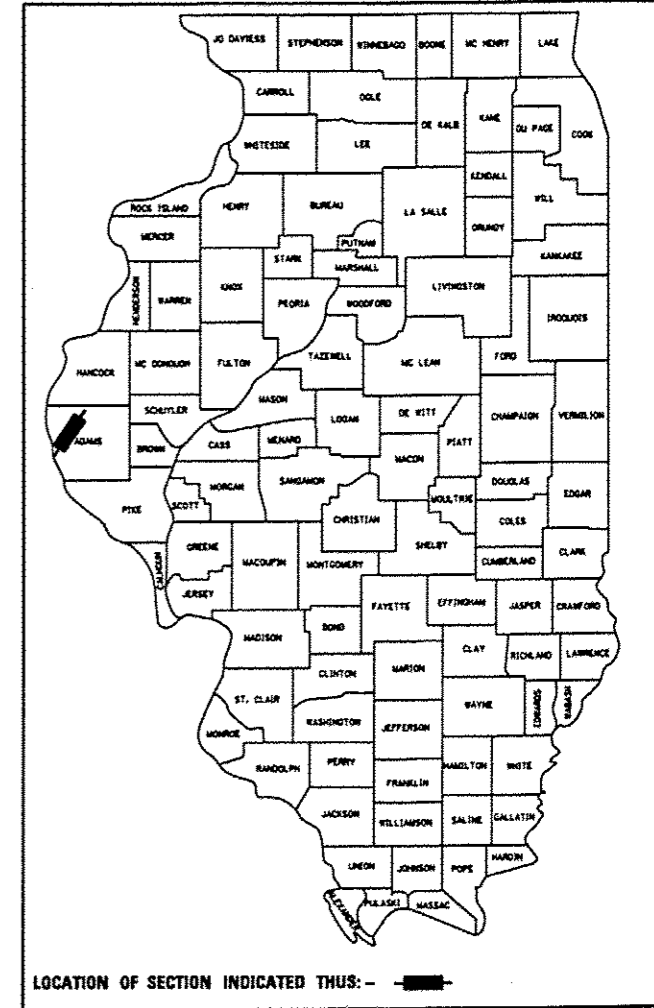

FOR INDEX OF SHEETS, SEE SHEET NO. 2

HIGHWAY CLASSIFICATION

F.A.P. ROUTE 63 (US 24) & (IL 96)

0.3 MI. S. OF IL 96 (S) TO 0.4 MI. N. OF US 24/IL 96 (N)

CLASSIFICATION: MINOR ARTERIAL

ADT: 5,424 (2011) PV = 92.0%

ADT: 8,060 (2031) SU = 2.5%

DESIGN SPEED: 60 MPH MU = 5.5%

POSTED SPEED: 55 MPH

LIMITS OF IMPROVEMENT
SECTION (1)N,TS-2,RS-5&(78)RS-3
ENDS AT STA. 20+20.41

STATION EQUATION
STA. 353+82.07 BK. =
STA. 15+64.80 AH.

STATION EQUATION
STA. 298+01.63 BK. =
STA. 298+20.65 AH.

LIMITS OF IMPROVEMENT
SECTION (1)N,TS-2,RS-5&(78)RS-3
BEGINS AT STA. 285+50.00

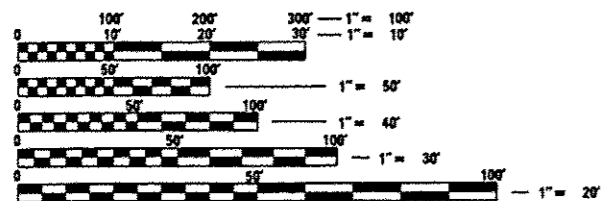
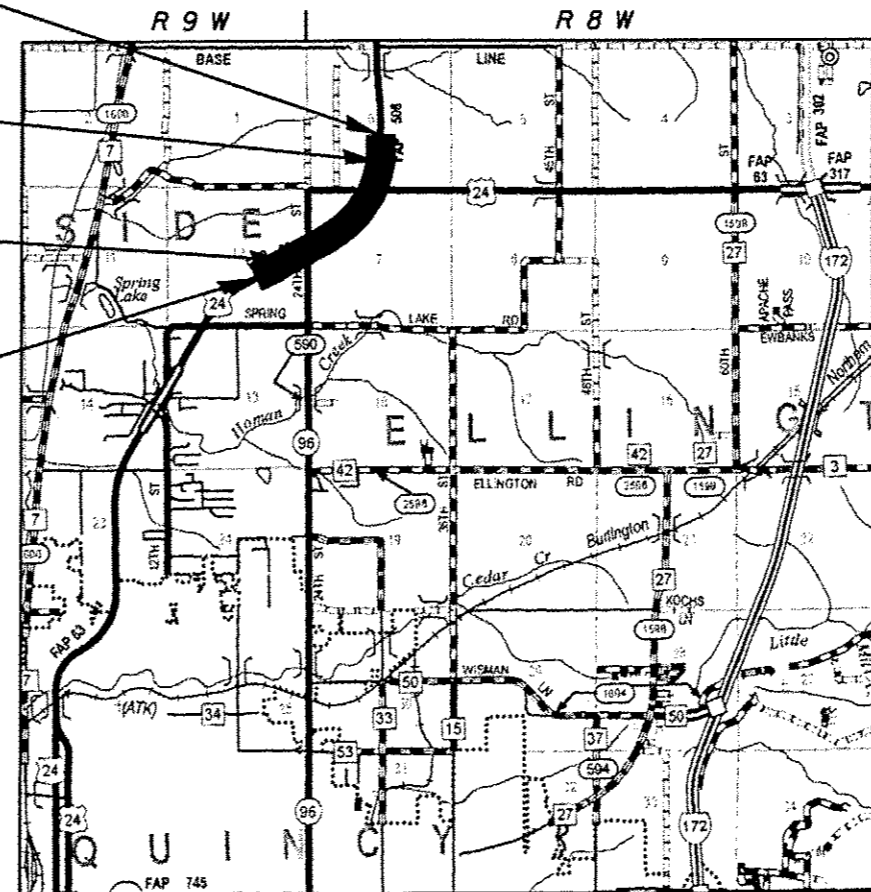

FULL SIZE PLANS HAVE BEEN PREPARED USING STANDARD ENGINEERING SCALES. REDUCED SIZED PLANS WILL NOT CONFORM TO STANDARD SCALES. IN MAKING MEASUREMENTS ON REDUCED PLANS, THE ABOVE SCALES MAY BE USED.

J.U.L.I.E.
JOINT UTILITY LOCATION INFORMATION FOR EXCAVATION
1-800-892-0123
OR 811

SENIOR TEAM ENGINEER: MARK DUST 785-0597
TEAM ENGINEER: RENE CABRERA 557-9062

CONTRACT NO. 72E31

GROSS LENGTH = 7268.66 FT. = 1.377 MILE
NET LENGTH = 7268.66 FT. = 1.377 MILE

STATE OF ILLINOIS
DEPARTMENT OF TRANSPORTATION
DIVISION OF HIGHWAYS

SUBMITTED December 11, 2012
Rep. Z. D. ...
DEPUTY DIRECTOR OF HIGHWAYS, REGION ENGINEER

Feb 1, 2013
John D. Baranzoni P.E.
active ENGINEER OF DESIGN AND ENVIRONMENT

Feb 1, 2013
Omer Osman P.E.
DIRECTOR OF HIGHWAYS, CHIEF ENGINEER

PRINTED BY THE AUTHORITY
OF THE STATE OF ILLINOIS