

(14)

(15)

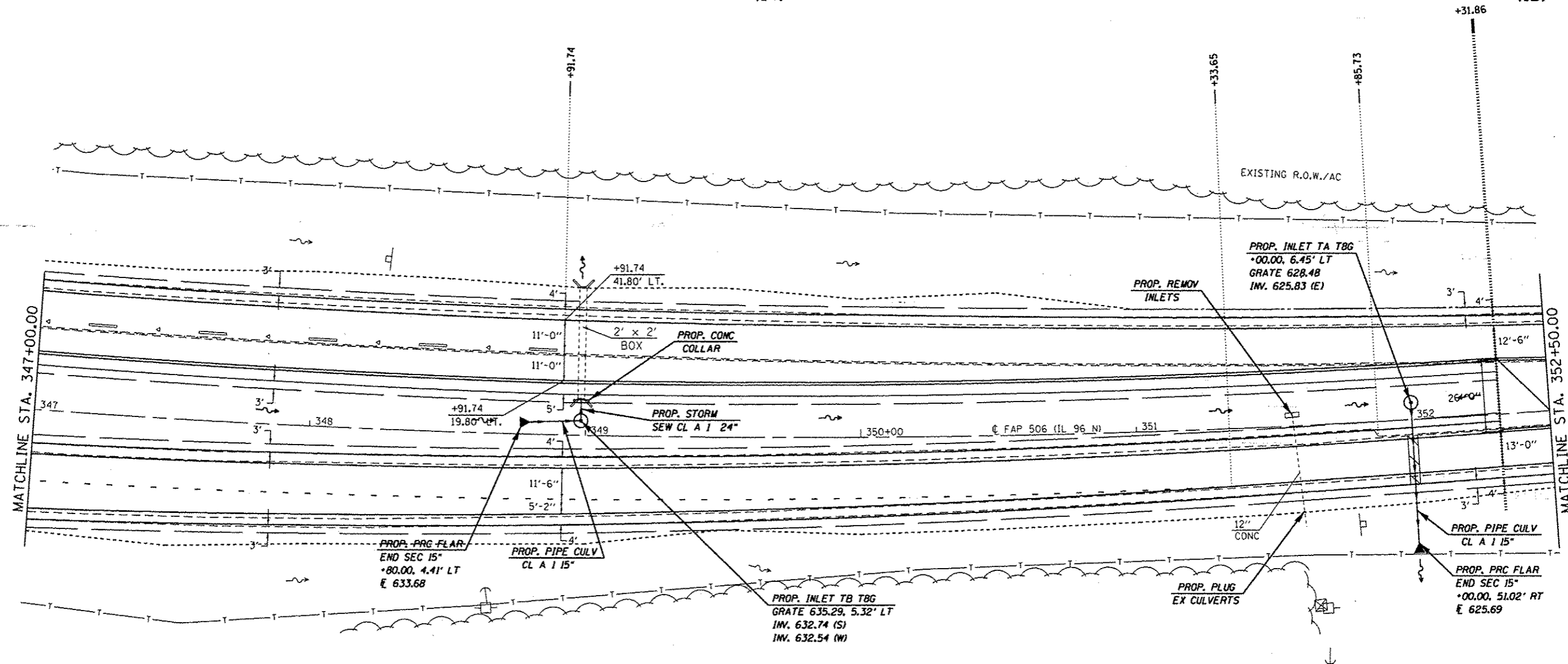

EXIST. CURVE 637  
 P.I. STA. = 345+97.36  
 $\Delta = 23^\circ 54' 24''$  (LT)  
 $D = 1^\circ 30' 03''$   
 $R = 3,817.71'$   
 $T = 808.23'$   
 $L = 1,592.94'$   
 $E = 84.62'$   
 $e = 3.7\%$   
 $T.R. = 42'$   
 $S.E. RUN = 103'$   
 $P.C. STA. = 337+89.13$   
 $P.T. STA. = 353+82.07$

\* FAP 63 (US 24); FAP 64 (US 24/IL 96); FAP 506 (IL 96)

FILE NAME : c:\pwwork\pwwork\sporkagw\0259630\067E31-ahc-drainplan_1201.dgn	USER NAME : sporkagw	DESIGNED -	REVISED -
	PLOT SCALE : 48.0000 1" = 48.0000'	DRAWN -	REVISED -
	PLOT DATE : 06-14-2012 03:45:37PM	CHECKED -	REVISED -
		DATE -	REVISED -

STATE OF ILLINOIS  
 DEPARTMENT OF TRANSPORTATION

DRAINAGE DETAIL SHEET

SCALE: 20 SHEET 6 OF 6 SHEETS STA. 347+00.00 TO STA. 352+50.00

F.A.P. RTE.	SECTION	COUNTY	TOTAL SHEETS	SHEET NO.
	(11N,TS-2RS-5&(7)RS-3	ADAMS	194	107
			CONTRACT NO. 72E31	
ILLINOIS FED. AID PROJECT				