



2 CENTERED CURVE
 RADIUS 1 = 50.0'
 RADIUS 2 = 150.0'
 OFFSET = 2.0'

2 CENTERED CURVE
 RADIUS 3 = 36.0'
 RADIUS 4 = 150.0'
 OFFSET = 2.0'

2 CENTERED CURVE
 RADIUS 7 = 40.0'
 RADIUS 8 = 120.0'
 OFFSET = 2.0'

2 CENTERED CURVE
 RADIUS 5 = 40.0'
 RADIUS 6 = 140.0'
 OFFSET = 2.0'

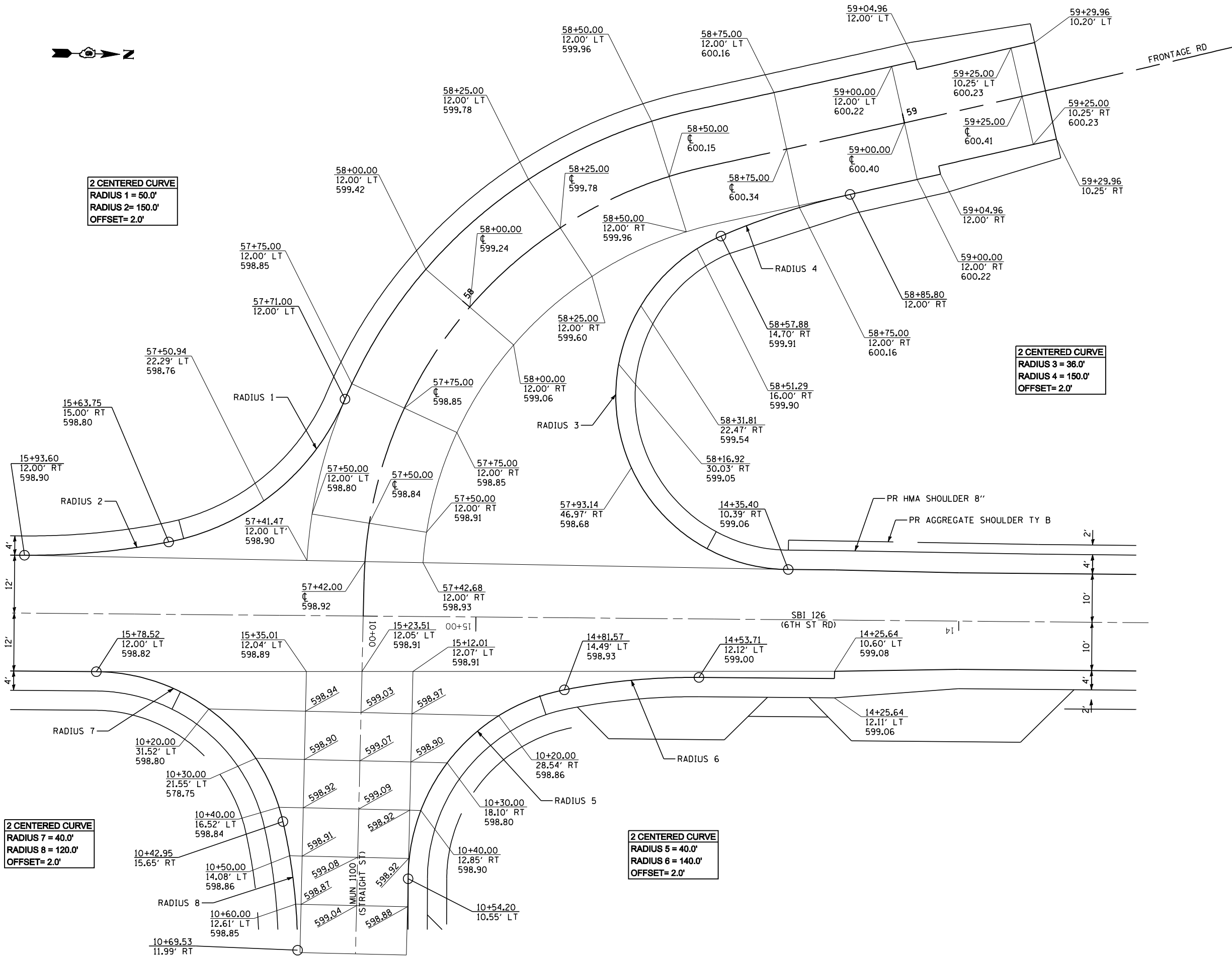

JOB = 2265.11
 FILE NAME = 0672F74-sht-elev.dgn
 PLOT SCALE = 20.0000' / IN.
 PLOT DATE = 2/4/2013

DESIGNED - NAK
 DRAWN - SJS
 CHECKED - NAK
 DATE - 10/8/2012

REVISED -
 REVISED -
 REVISED -
 REVISED -

**STATE OF ILLINOIS
 DEPARTMENT OF TRANSPORTATION**

**PAVEMENT ELEVATIONS
 SBI 126 (6TH ST RD)**

SCALE: SHEET NO. OF SHEETS STA. TO STA.

S.B.I. RTE.	SECTION	COUNTY	TOTAL SHEETS	SHEET NO.
126	(110) I-2	SANGAMON	93	51
FED. ROAD DIST. NO. ILLINOIS FED. AID PROJECT			CONTRACT NO. 72F74	