

DATE	
BY	
DESIGNED	
DRAWN	
CHECKED	
DATE	

DATE	
BY	
DESIGNED	
DRAWN	
CHECKED	
DATE	

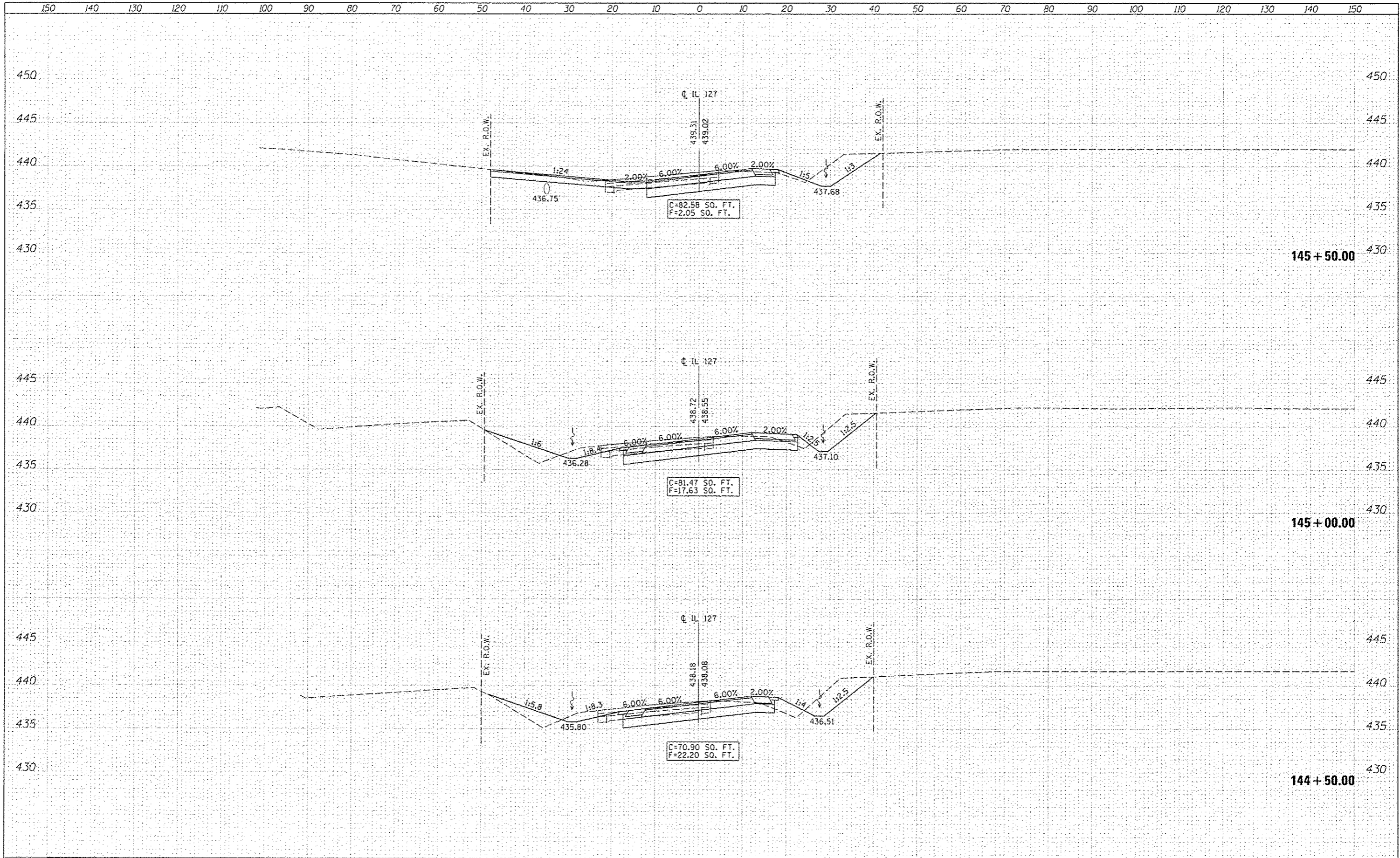

LIN ENGINEERING LTD. Consulting Engineers Westmont, Illinois	USER NAME : Plotted by Scott	DESIGNED - RK	REVISED SHEET 4-2-2013 SEW	STATE OF ILLINOIS DEPARTMENT OF TRANSPORTATION	CROSS SECTIONS IL 127 OVER KASKASKIA RIVER				F.A.P. RTE.	SECTION	COUNTY	TOTAL SHEETS	SHEET NO.
	PLOT SCALE : 20,0000' / in.	CHECKED - SEW	REVISED -						42	1-1BR-2	CLINTON	159	140
	PLOT DATE :	DATE - 2-1-2013	REVISED -			SCALE: 1"=10'H, 5'V SHEET NO. 6 OF 25 SHEETS STA. 144+50.00 TO STA. 145+50.00				CONTRACT NO. 76479			
	ILLINOIS FED. AID PROJECT												