

NUMBER	ALI.	STATION	OFFSET	ELEVATION
1	PR REL SLANT RD	2+41.97	13.80' LT	460.64
2	PR REL SLANT RD	2+41.97	0.00' LT	460.85
3	PR REL SLANT RD	2+41.97	11.00' RT	460.68
4	PR REL SLANT RD	2+25.00	15.83' LT	460.46
5	PR REL SLANT RD	2+25.00	0.00' RT	460.70
6	PR REL SLANT RD	2+25.00	11.00' RT	460.53
7	PR REL SLANT RD	2+12.16	17.21' LT	460.31
8	PR REL SLANT RD	2+12.16	0.00' LT	460.57
9	PR REL SLANT RD	2+12.16	11.00' RT	460.41
10	PR REL SLANT RD	2+00.00	18.38' LT	460.16
11	PR REL SLANT RD	2+00.00	0.00' RT	460.44
12	PR REL SLANT RD	2+00.00	11.10' RT	460.23
13	PR REL SLANT RD	1+75.93	20.34' LT	459.85
14	PR REL SLANT RD	1+75.93	0.00' LT	460.16
15	PR REL SLANT RD	1+75.93	11.90' RT	459.98
16	PR PARK-N-RIDE	12+20.00	10.00' LT	459.94
17	PR PARK-N-RIDE	12+00.00	10.00' LT	459.86
18	PR PARK-N-RIDE	12+00.00	0.00' LT	460.06
19	PR PARK-N-RIDE	12+00.00	15.65' RT	459.75
20	PR PARK-N-RIDE	11+88.27	10.00' LT	459.81
21	PR PARK-N-RIDE	11+88.27	0.00' LT	460.01
22	PR PARK-N-RIDE	11+88.27	10.00' RT	459.81
23	PR PARK-N-RIDE	11+32.19	10.00' LT	459.60
24	PR PARK-N-RIDE	11+41.13	27.64' LT	459.23
25	PR PARK-N-RIDE	10+49.66	28.50' LT	458.90
26	PR PARK-N-RIDE	10+49.66	10.00' LT	459.27
27	PR PARK-N-RIDE	10+43.49	10.00' LT	459.25
28	PR PARK-N-RIDE	10+33.20	12.21' LT	459.17
29	PR PARK-N-RIDE	10+33.20	0.00' LT	459.41
30	PR PARK-N-RIDE	10+33.20	10.00' RT	459.21
31	PR PARK-N-RIDE	10+24.62	18.60' LT	458.99
32	PR PARK-N-RIDE	10+20.48	0.00' LT	459.36
33	PR PARK-N-RIDE	10+16.92	16.03' RT	459.04
34	EX IL 161	1634+41.92	13.00' LT	459.30
35	EX IL 161	1633+71.63	13.00' LT	459.62
36	PR REL SLANT RD	0+83.94	23.00' LT	458.94
37	PR REL SLANT RD	0+83.94	0.00' LT	459.28
38	PR REL SLANT RD	0+83.94	21.96' RT	458.95
39	PR REL SLANT RD	0+53.28	23.00' LT	459.03
40	PR REL SLANT RD	0+53.28	0.00' LT	459.37
41	PR REL SLANT RD	0+53.28	34.90' RT	458.85
42	PR REL SLANT RD	0+33.38	28.75' LT	459.12
43	PR REL SLANT RD	0+36.55	0.00' LT	459.52
44	PR REL SLANT RD	0+42.87	44.36' RT	458.79
45	PR REL SLANT RD	0+19.05	44.36' LT	459.49
46	PR REL SLANT RD	0+06.30	77.13' LT	459.55
47	EX IL 161	1631+21.94	13.00' LT	459.64
48	EX IL 161	1631+96.69	13.00' LT	459.81
49	EX IL 161	1632+19.33	13.00' LT	459.81
50	EX IL 161	1632+30.42	13.00' LT	459.81
51	EX IL 161	1633+17.50	13.00' LT	459.80
52	EX IL 161	1634+10.45	13.00' LT	459.33

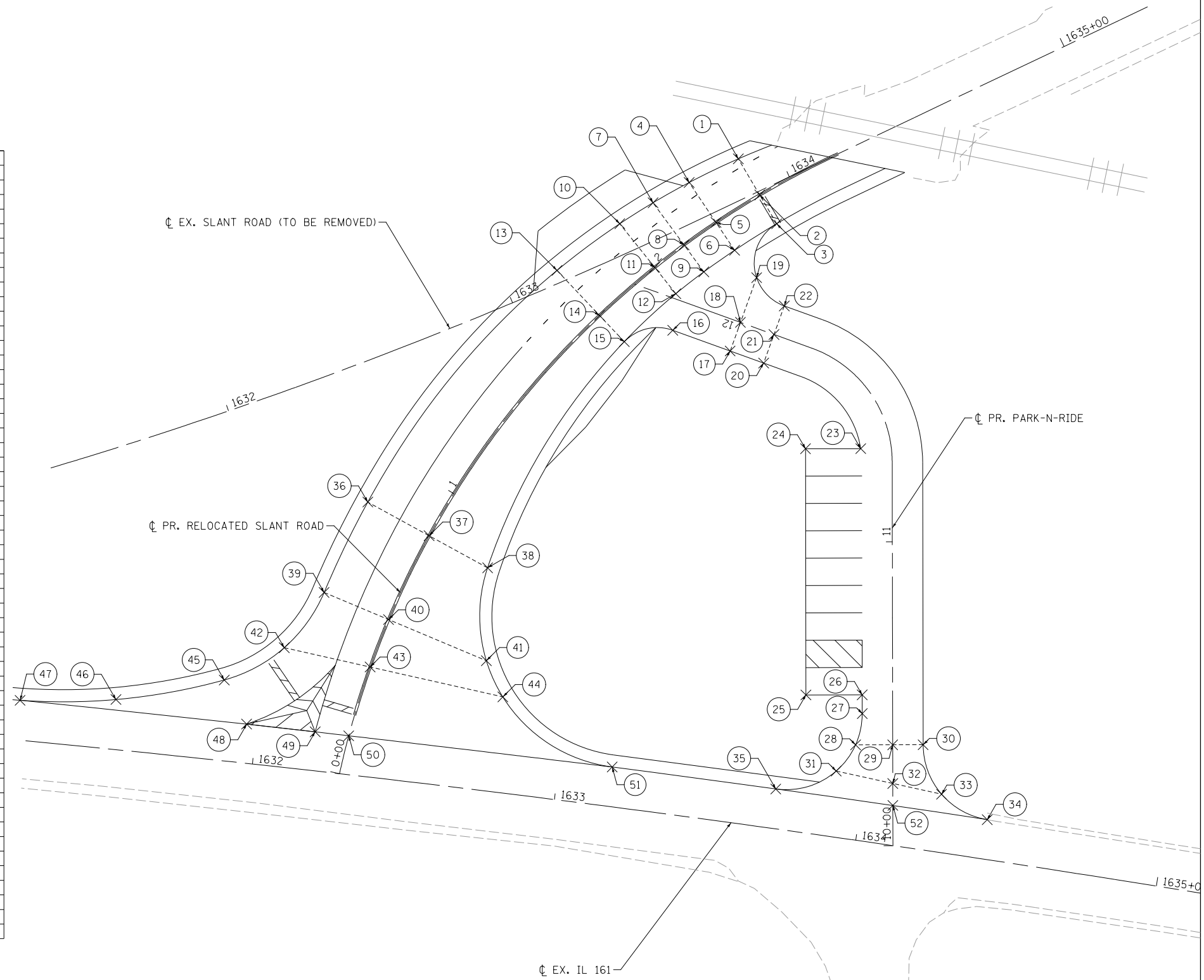

E:\1024\Plan_Sheets\0876479-ht-intersec2.dgn



USER NAME = Plotted by Scott	DESIGNED - RK	REVISED -
	DRAWN - RK	REVISED -
PLOT SCALE = 48.0000' / in.	CHECKED - SEW	REVISED -
PLOT DATE =	DATE - 2-1-2013	REVISED -

**STATE OF ILLINOIS
DEPARTMENT OF TRANSPORTATION**

**INTERSECTION DETAILS
RELOCATED SLANT ROAD & PARK-N-RIDE**

SCALE: 1"=20' SHEET NO. 2 OF 2 SHEETS STA. N/A TO STA. N/A

F.A.P. RTE.	SECTION	COUNTY	TOTAL SHEETS	SHEET NO.
42	1-1BR-2	CLINTON	159	65
CONTRACT NO. 76479				
ILLINOIS FED. AID PROJECT				