

* Tilt #9 b₈(E) bars as required to maintain clearance.

*** Cost included with Concrete Superstructure.

SECTION A-A

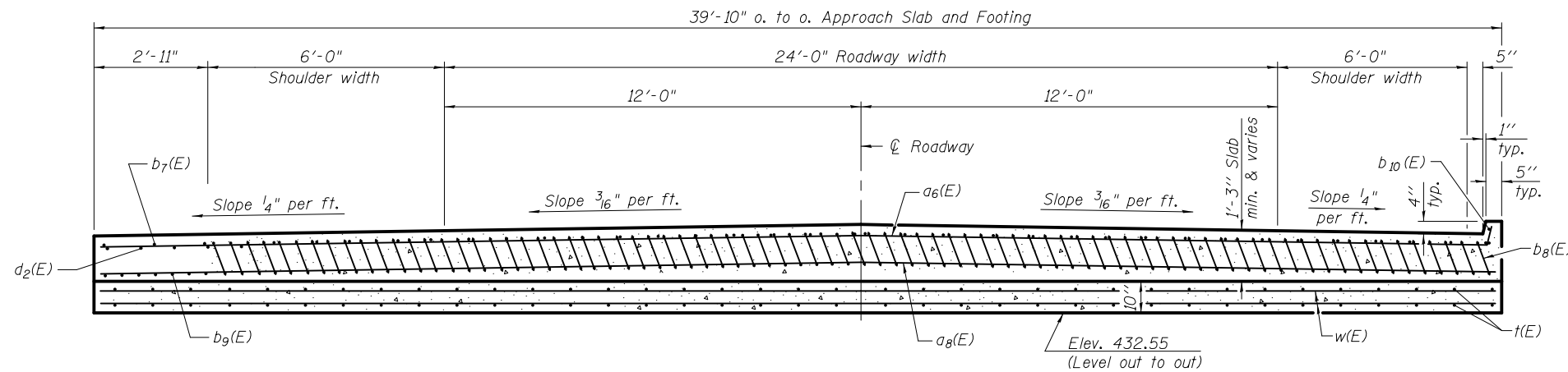

SECTION B-B

(See Plan for dimensions not shown)

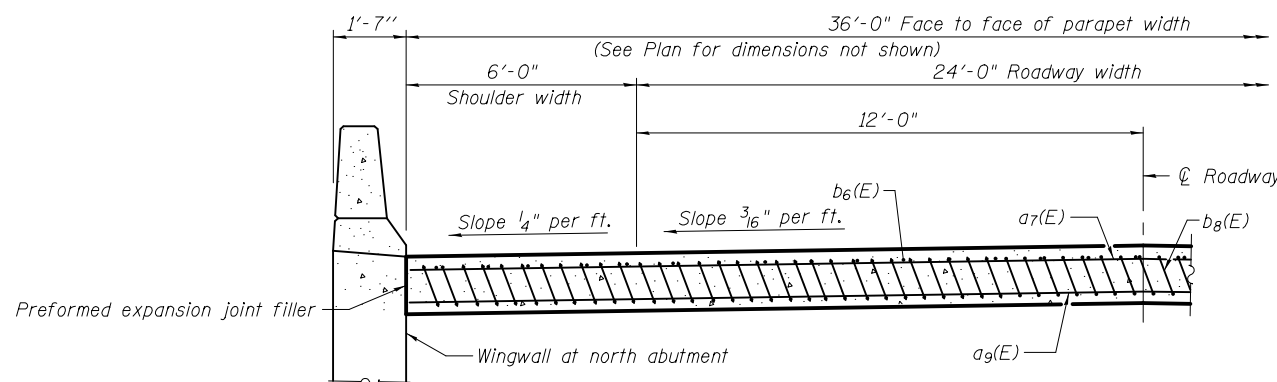

SECTION C-C

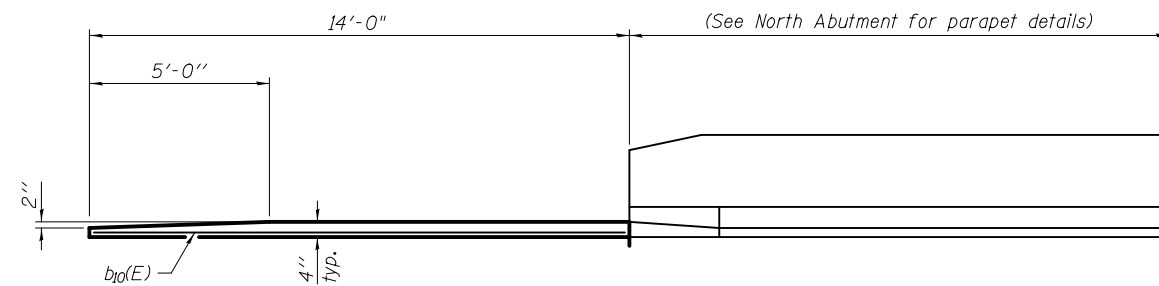

VIEW D-D

Notes:
 Approach slab concrete shall be paid for as Concrete Superstructure.
 Approach footing concrete shall be paid for as Concrete Structures.
 Reinforcement shall be paid for as Reinforcement Bars, Epoxy Coated.
 For v(E) bar details, see sheets 37 and 38 of 61.
 The approach footing maximum applied service bearing pressure (Q_{max}) = 2.0 ksf.
 For bar splicer details, see sheet 50 of 61.
 Cost of excavation for approach footing included with Concrete Structures.
 For Granular Backfill for Structures and drainage treatment details, see sheet 2 of 61.
 Concrete Superstructure quantity includes concrete of the end post and upper portion of the backwall from the north abutment. See sheets 37 and 38 of 61.

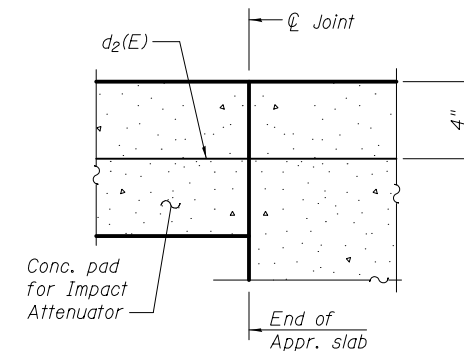

DETAIL E

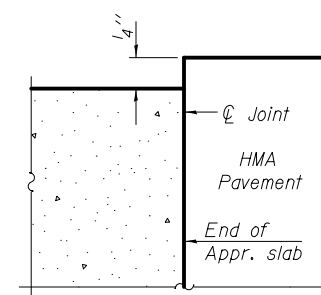

FLEXIBLE PAVEMENT

DETAIL F

**NORTH APPROACH
BILL OF MATERIAL**

Bar	No.	Size	Length	Shape
a ₆ (E)	12	#4	39'-9"	—
a ₇ (E)	13	#4	35'-8"	—
a ₈ (E)	26	#5	39'-6"	—
a ₉ (E)	20	#5	35'-8"	—
b ₆ (E)	30	#4	29'-8"	—
b ₇ (E)	3	#4	13'-8"	—
b ₈ (E)	86	#9	29'-9"	—
b ₉ (E)	7	#9	13'-8"	—
b ₁₀ (E)	1	#4	13'-8"	—
d ₂ (E)	5	#5	6'-6"	—
t(E)	80	#4	9'-8"	—
w(E)	40	#5	39'-6"	—
Concrete Superstructure		Cu. Yd.	61.6	
Concrete Structures		Cu. Yd.	12.3	
Bridge Deck Grooving		Sq. Yd.	127	
Protective Coat		Sq. Yd.	142	
Reinforcement Bars, Epoxy Coated		Pound	14,300	

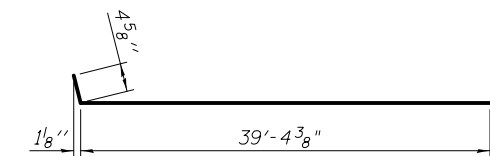

BAR a₆(E)

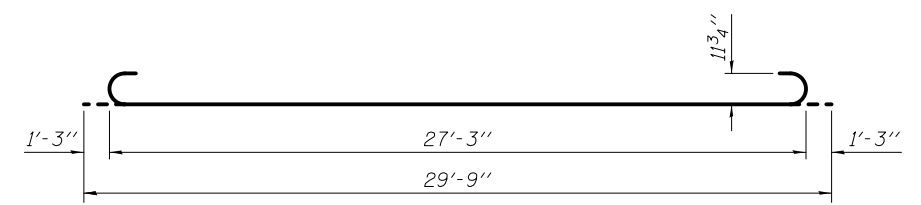

BAR b₈(E)



USER NAME =	DESIGNED - RLM	REVISED
	CHECKED - JTH	REVISED
PLOT SCALE =	DRAWN - PRC	REVISED
PLOT DATE = 2/1/2013	CHECKED - RLM	REVISED

STATE OF ILLINOIS
DEPARTMENT OF TRANSPORTATION

BRIDGE APPROACH SLAB DETAILS AT NORTH ABUTMENT - 2
STRUCTURE NO. 014-0033

SHEET NO. 21 OF 61 SHEETS

F.A.P. RTE.	SECTION	COUNTY	TOTAL SHEETS	SHEET NO.
42	1-1BR-2	CLINTON	159	90
CONTRACT NO. 76479				
ILLINOIS FED. AID PROJECT				