

**BAR h2(E)**

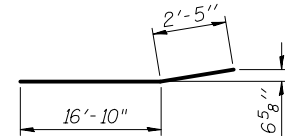

**BAR h6(E)**

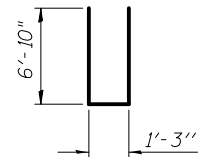

**BAR n(E)**

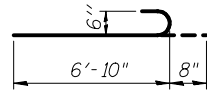

**BAR n1(E)**

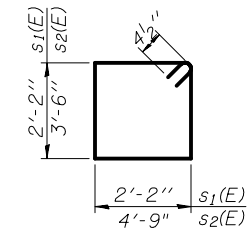

**BARS s1(E) & s2(E)**

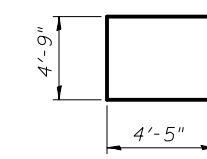

**BAR u1(E)**

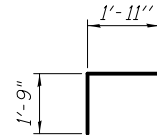

**BAR v(E)**

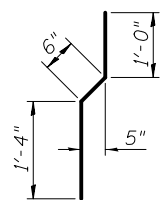

**BAR v1(E)**

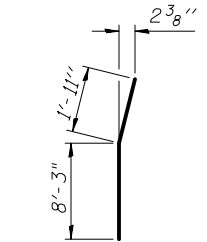

**BAR v8(E)**

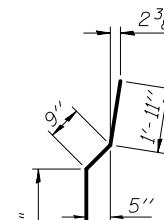

**BAR v9(E)**

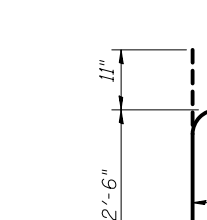

**BAR v12(E)**

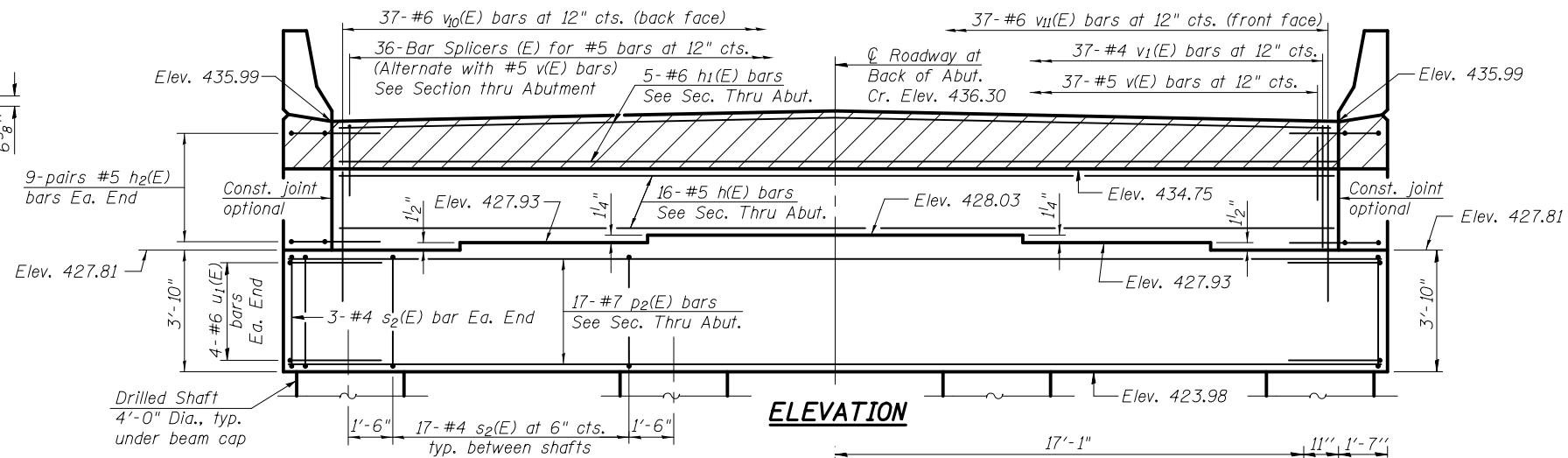

**ELEVATION**

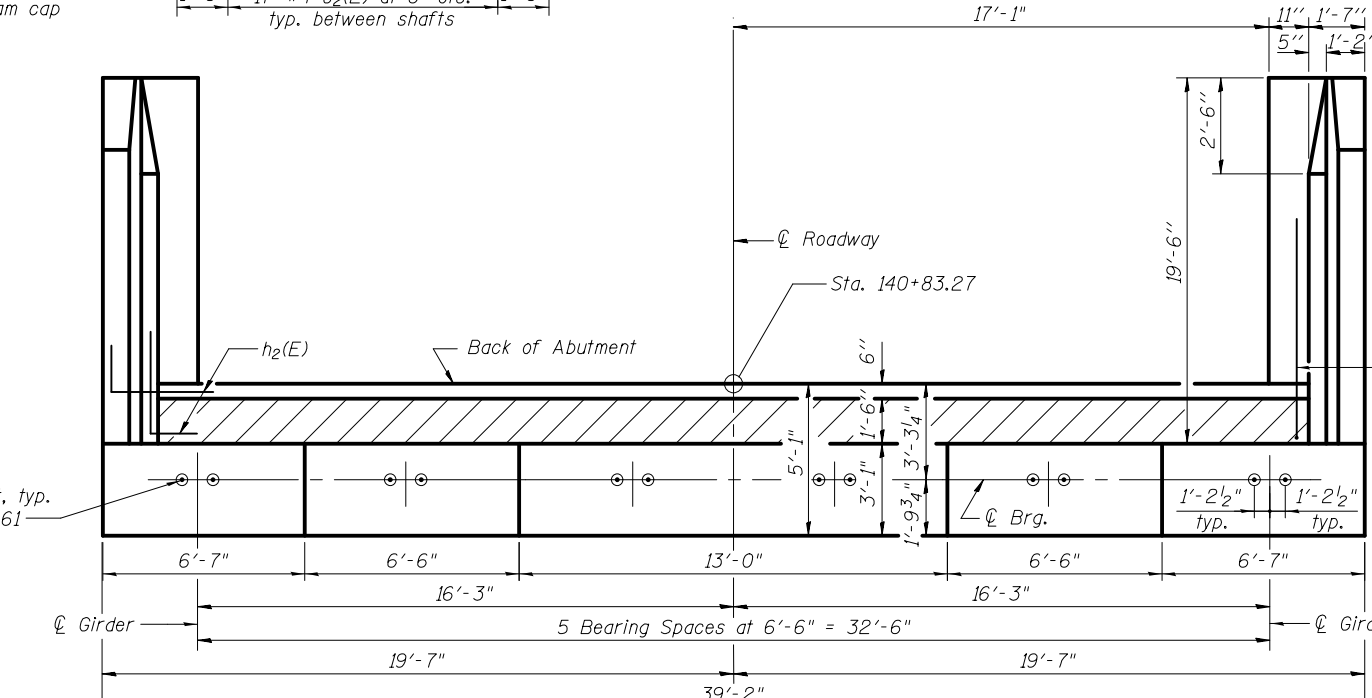

**TOP VIEW**

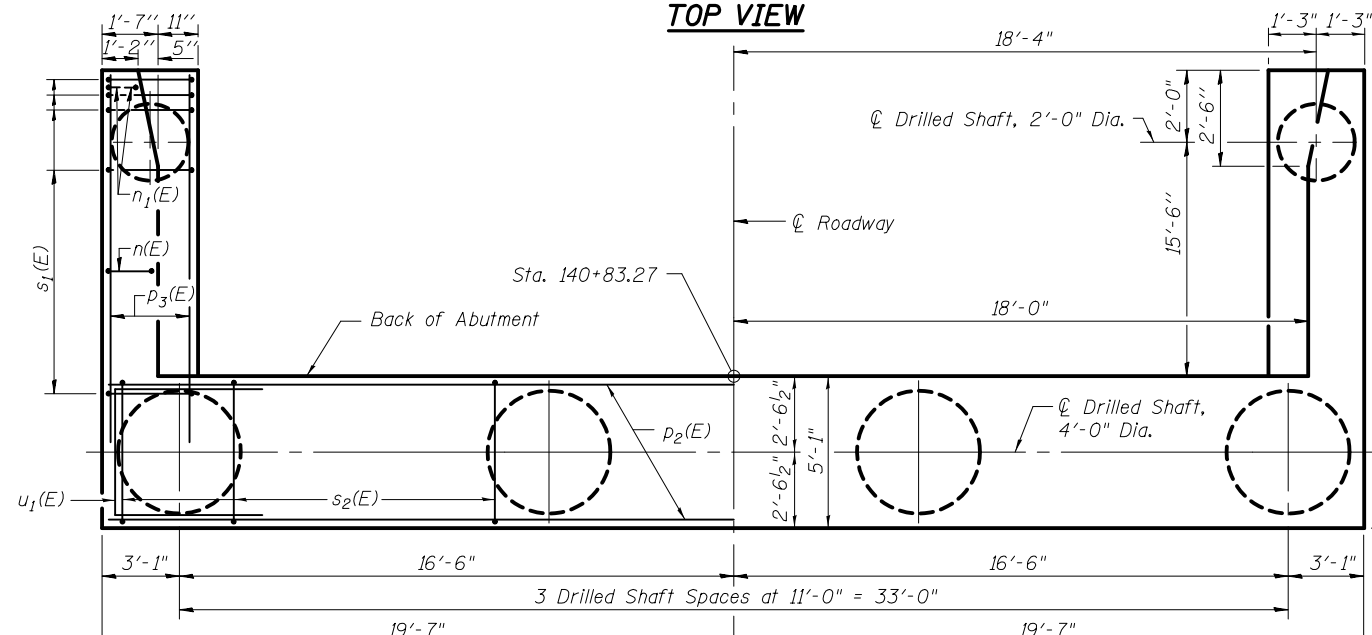

**PLAN-PILE CAP**

**SOUTH ABUTMENT  
BILL OF MATERIAL**

Bar	No.	Size	Length	Shape
h(E)	16	#5	35'-8"	—
h1(E)	5	#6	35'-8"	—
h2(E)	36	#5	8'-6"	└
h5(E)	30	#4	19'-2"	—
h6(E)	22	#4	19'-3"	—
n(E)	34	#6	14'-11"	—
n1(E)	12	#6	7'-6"	—
p2(E)	17	#7	38'-10"	—
p3(E)	20	#7	21'-4"	—
s1(E)	40	#4	9'-5"	┐
s2(E)	57	#4	17'-3"	┐
sp(E)	4	#3	14'-0"	~
sp1(E)	4	#3	17'-4"	~
sp2(E)	2	#3	25'-1"	~
u1(E)	8	#6	13'-7"	—
v(E)	37	#5	3'-8"	└
v1(E)	37	#4	2'-10"	—
v7(E)	40	#6	10'-8"	—
v8(E)	6	#6	10'-2"	—
v9(E)	34	#6	10'-11"	—
v10(E)	37	#6	9'-1"	—
v11(E)	37	#6	10'-5"	—
v12(E)	76	#8	33'-5"	—
v13(E)	12	#6	26'-1"	—
Structure Excavation		Cu. Yd.	331	
Concrete Structures		Cu. Yd.	74.7	
Reinforcement Bars, Epoxy Coated		Pound	17,470	
Drilled Shaft in Soil		Cu. Yd.	41.9	
Drilled Shaft in Rock		Cu. Yd.	10.7	
Concrete Sealer		Sq. Ft.	489	

\* Length is height of spiral.

Note:  
For details of Bar Splicers, see Sheet 50 of 61.



USER NAME =	DESIGNED - JTH	REVISED
	CHECKED - RLM	REVISED
PLOT SCALE =	DRAWN - PRC	REVISED
PLOT DATE = 2/1/2013	CHECKED - JTH	REVISED

STATE OF ILLINOIS  
DEPARTMENT OF TRANSPORTATION

SOUTH ABUTMENT  
STRUCTURE NO. 014-0033

SHEET NO. 39 OF 61 SHEETS

F.A.P. RT.E.	SECTION	COUNTY	TOTAL SHEETS	SHEET NO.
42	1-1BR-2	CLINTON	159	108
CONTRACT NO. 76479				
ILLINOIS FED. AID PROJECT				