

STATE OF ILLINOIS
DEPARTMENT OF TRANSPORTATION
DIVISION OF HIGHWAYS

**PROPOSED
HIGHWAY PLANS**

FAP ROUTE 310 (IL 255)
SECTION 60-(9,10,11)RS-1
MICROSURFACING

PROJECT F-0310(151)
MADISON COUNTY

C-98-080-12

F.A.S. RTE.	SECTION	COUNTY	TOTAL SHEETS	SHEET NO.
310	60-(9,10,11)RS-1	MADISON	21	1
		ILLINOIS	CONTRACT NO. 76F87	

D-98-072-12

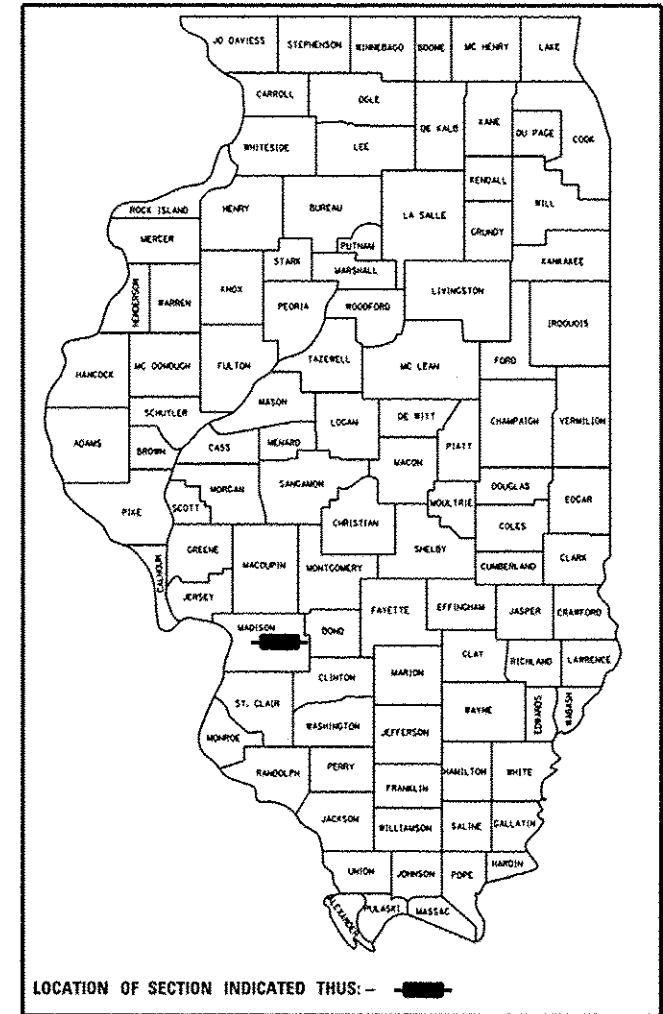

INDEX OF SHEETS

- 1 COVER SHEET
- 2 GENERAL NOTES
- 3 SUMMARY OF QUANTITIES
- 4 TYPICAL SECTIONS
- 5 - 6 SCHEDULE OF QUANTITIES
- 7 - 20 PLAN SHEETS
- 21 DETAILS

HIGHWAY STANDARDS

- 000001-06
- 001006
- 701400-06
- 701401-07
- 701411-08
- 701456-02
- 701901-02

COMMITMENTS

NONE

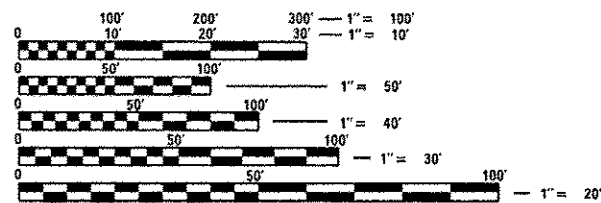

FULL SIZE PLANS HAVE BEEN PREPARED USING STANDARD ENGINEERING SCALES. REDUCED SIZED PLANS WILL NOT CONFORM TO STANDARD SCALES. IN MAKING MEASUREMENTS ON REDUCED PLANS, THE ABOVE SCALES MAY BE USED.

J.U.L.I.E.
JOINT UTILITY LOCATION INFORMATION FOR EXCAVATION
1-800-892-0123
OR 811

PROJECT ENGINEER: TIM PADGETT (618)346-3325
PROJECT MANAGER: LIZ BURNSIDE (618)346-3196

CONTRACT NO. 76F87

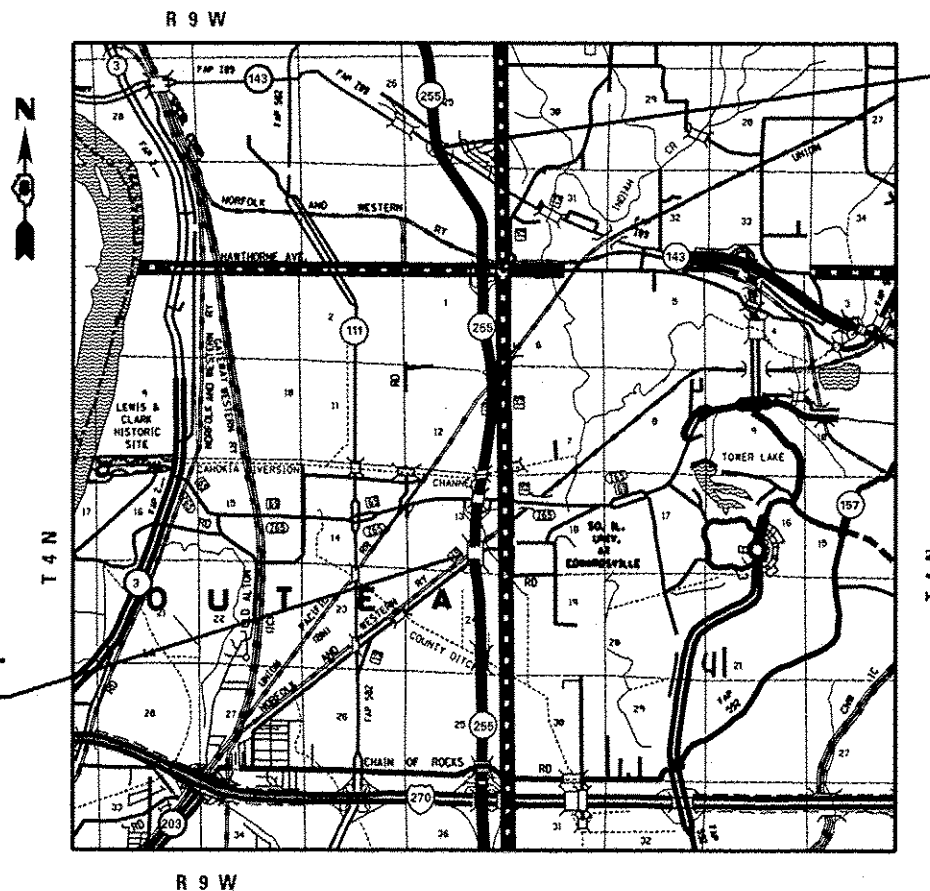

**BEGIN PROJECT
STA. 1748 + 87**

**END PROJECT
STA. 1964 + 37**

GROSS LENGTH = 21,550 FT. = 4.08 MILE
NET LENGTH = 20,156 FT. = 3.82 MILE

STATE OF ILLINOIS
DEPARTMENT OF TRANSPORTATION
DIVISION OF HIGHWAYS

SUBMITTED *December 13 20 12*

[Signature]
DEPUTY DIRECTOR OF HIGHWAYS, REGION ENGINEER

March 22 20 13
John D. Baranzelli, P.E.
ENGINEER OF DESIGN AND ENVIRONMENT

March 22 20 13
Onor Osman, P.E.
DIRECTOR OF HIGHWAYS, CHIEF ENGINEER

**PRINTED BY THE AUTHORITY
OF THE STATE OF ILLINOIS**

GENERAL NOTES

- ① SINCE THE ADT > 5,000 THEN THE AGGREGATE FOR THE SURFACE LIFT OF MICRO-SURFACING SHALL MEET THE FRICTION AGGREGATE REQUIREMENTS FOR MIXTURE "D" IN ARTICLE 1004.03(A).
- ② UTILITIES INTERFERENCES ARE NOT ANTICIPATED ON THIS CONTRACT. IT SHALL BE THE CONTRACTOR'S RESPONSIBILITY TO COORDINATE HIS CONSTRUCTION ACTIVITIES WITH THE VARIOUS UTILITY OWNERS. ALL POTENTIAL CONFLICTS SHALL BE INVESTIGATED AND REMEDIAL ACTION TAKEN PRIOR TO INTERRUPTION OF THE CONTRACTOR'S PROGRESS. NO ADDITIONAL COST SHALL BE ADDED TO THE CONTRACT RESULTING FROM UTILITY CONFLICTS.
- ③ ILLINOIS STATE LAW REQUIRES A 48-HOUR NOTICE TO BE GIVEN TO UTILITIES BEFORE DIGGING. FIELD MARKING OF FACILITIES MAY BE OBTAINED BY CONTACTING J.U.L.I.E. (1-800-892-0123 OR 811) OR FOR NON-MEMBERS THE UTILITY COMPANY DIRECTLY.
- ④ "ROAD CONSTRUCTION AHEAD" SIGNS SHALL BE PLACED AT THE BEGINNING AND END OF THE PROJECT PLUS THE INTERSECTING SIDE ROADS AND REQUIRED RAMPS, AND WILL BE INCLUDED IN THE TRAFFIC CONTROL PAY ITEMS. ALL CONSTRUCTION SIGNS SHALL BE FLUORESCENT ORANGE. (48"X48")
- ⑤ FLAGMEN SHALL BE PRESENT DURING ALL CLOSURE HOURS, INCLUDING LUNCH HOUR, AND NO ADDITIONAL COMPENSATION SHALL BE APPLIED.
- ⑥ THE CONTRACTOR SHALL VERIFY ALL DIMENSIONS AND CONDITIONS IN THE FIELD PRIOR TO CONSTRUCTION AND ORDERING OF MATERIALS.
- ⑦ NO OVERNIGHT LANE CLOSURES SHALL BE ALLOWED.
- ⑧ THE PROPOSED PAVEMENT MARKINGS SHALL BE PLACED IN THE SAME LOCATION AS EXISTING OR AS DIRECTED BY THE RESIDENT ENGINEER.
- ⑨ THE CONTRACTOR SHALL BE AWARE THAT IT MAY BE NECESSARY TO DO SOME CRACK SEALING ACCORDING TO THE PREVENTATIVE MAINTENANCE MICRO-SURFACING SPECIAL PROVISION OR AS DIRECTED BY THE ENGINEER. 1000 FT OF CRACK ROUTING (PAVEMENT) AND 284 POUNDS OF CRACK FILLING HAVE BEEN ADDED TO THE QUANTITIES FOR THIS WORK.
- ⑩ THE CONTRACTOR SHALL DEVISE AND SUBMIT A JOINT PLAN THAT MEETS THE APPROVAL OF THE RESIDENT ENGINEER AS REQUIRED BY THE SPECIAL PROVISION "MICRO-SURFACING".
- ⑪ SHORT-TERM PAVEMENT MARKING SHALL BE APPLIED TO EACH PASS. ONLY THE REMOVAL OF THE FINAL SURFACE APPLICATION WILL BE PAID FOR (WORK ZONE PAVEMENT MARKING REMOVAL - SQ FT). A QUANTITY FOR TEMPORARY PAVEMENT MARKING EQUAL TO THE AMOUNT OF PERMANENT PAVEMENT MARKINGS HAS BEEN ADDED TO THE PLANS.
- ⑫ THE ILLINOIS DEPARTMENT OF TRANSPORTATION STRONGLY ENCOURAGES THE PRIME CONTRACTOR AND THEIR APPROVED SUB-CONTRACTORS TO HIRE MINORITY, WOMEN AND DISADVANTAGED INDIVIDUALS FROM ITS FEDERALLY FUNDED HIGHWAY CONSTRUCTION CAREERS TRAINING PROGRAM (HCCTP) TO HELP MEET WORKFORCE AND TRAINEE GOALS. THIS PROGRAM IS TRAINING MINORITIES, WOMEN AND DISADVANTAGED INDIVIDUALS IN HIGHWAY CONSTRUCTION-RELATED SKILLS, E.G., MATH FOR THE TRADES, JOB READINESS, TECHNICAL SKILLS COURSEWORK (CARPENTRY, CONCRETE FLATWORK, BLUEPRINT READING, SITE PLANS, SITE WORK, TOOLS USE, ETC.) AND OSHA 10 HOUR CERTIFICATION, TO PREPARE THEM FOR A CAREER IN THE HIGHWAY CONSTRUCTION TRADES. GRADUATES ARE WELL-TRAINED AND READY TO BECOME PRODUCTIVE ENTRY-LEVEL CONSTRUCTION WORKERS. PLEASE CONTACT THE DISTRICT 8 EEO OFFICE AT 618-346-3360 AND/OR THE HCCTP COORDINATOR AT 618-874-6528 TO LEARN MORE ABOUT THE PROGRAM AND FOR ASSISTANCE IN MEETING WORKFORCE AND TRAINEE GOALS.
- ⑬ MICRO-SURFACING SHALL NOT COVER EXISTING RUMBLE STRIP IN THE SHOULDER.

- ⑭ THE FOLLOWING MIXTURE REQUIREMENTS ARE APPLICABLE FOR THIS PROJECT:

MIXTURE REQUIREMENTS - MICRO SURFACING PROJECT		
ROUTE	FAP 310 (IL 255)	
SECTION	60-(9,10,11)RS-1	
COUNTY	MADISON	
CONTRACT	76F87	
DESCRIPTION:	MICRO-SURFACING IL 255 FROM NSRR 0.5 MI. S. OF POAG ROAD TO IL 143.	
ADT (Construction Yr)	24700	
MU%:	4.4	
SU%:	2.9	
20 YR. ESAL'S:	6.75	
MIXTURE USE	PARTIAL DEPTH PATCHING	MICRO SURFACING
AC/PG	PG64-22	
RAP % (MAX)	SEE SPECS.	
DESIGN AIR VOIDS	4.0% @ N90	
MIX COMPOSITION (GRADATION MIXTURE)	IL 9.5	
FRICTION AGG	MIXTURE "D"	MIXTURE "D"

FILE NAME =	USER NAME = burnsideam	DESIGNED -	REVISED -	STATE OF ILLINOIS DEPARTMENT OF TRANSPORTATION	INDEX OF SHEETS, GENERAL NOTES, COMMITMENTS, STANDARDS & SCHEDULES				F.A.P. RTE.	SECTION	COUNTY	TOTAL SHEETS	SHEET NO.
of:\pvc\work\p\w\d\ot\burnsideam\0298743\0276F87-ehf-plan.dgn		DRAWN -	REVISED -		310	60-(8,9,10,11)-1	MADISON	21	2				
PLOT SCALE = 100.0000' / 1" =		CHECKED -	REVISED -		SCALE: SHEET NO. OF SHEETS STA. TO STA.				FED. ROAD DIST. NO.	ILLINOIS FED. AID PROJECT			
PLOT DATE = 12/5/2012		DATE -	REVISED -		CONTRACT NO. 76F16								

SUMMARY OF QUANTITIES

SUMMARY OF QUANTITIES			TOTAL QUANTITIES	URBAN CONSTRUCTION TYPE CODE		
CODE NO	ITEM	UNIT		0005 80% FED. 20% STATE		
40600200	BITUMINOUS MATERIALS (PRIME COAT)	TON	0.03	0.03		
44022025	PARTIAL DEPTH REMOVAL 2"	SQ YD	92	92		
45100100	CRACK ROUTING (PAVEMENT)	FOOT	1000	1000		
45100200	CRACK FILLING	POUND	284	284		
48100500	AGGREGATE SHOULDERS, TYPE A 6"	SQ YD	278	278		
67100100	MOBILIZATION	L SUM	1	1		
70100800	TRAFFIC CONTROL AND PROTECTION, STANDARD 701401	L SUM	1	1		
70100825	TRAFFIC CONTROL AND PROTECTION, STANDARD 701456	L SUM	1	1		
70300100	SHORT TERM PAVEMENT MARKING	FOOT	10208	10208		
* 70300210	TEMPORARY PAVEMENT MARKING LETTERS AND SYMBOLS	SQ FT	93.6	93.6		
* 70300220	TEMPORARY PAVEMENT MARKING - LINE 4"	FOOT	118327	118327		
* 70300250	TEMPORARY PAVEMENT MARKING - LINE 8"	FOOT	7720	7720		

SUMMARY OF QUANTITIES			TOTAL QUANTITIES	CONSTRUCTION TYPE CODE		
CODE NO	ITEM	UNIT		0005 80% FED. 20% STATE		
70301000	WORK ZONE PAVEMENT MARKING REMOVAL	SQ FT	1701	1701		
* 78000100	THERMOPLASTIC PAVEMENT MARKING - LETTERS AND SYMBOLS	SQ FT	93.6	93.6		
* 78000200	THERMOPLASTIC PAVEMENT MARKING - LINE 4"	FOOT	118327	118327		
* 78000500	THERMOPLASTIC PAVEMENT MARKING - LINE 8"	FOOT	7720	7720		
* 78100100	RAISED REFLECTIVE PAVEMENT MARKER	EACH	1285	1285		
78300100	PAVEMENT MARKING REMOVAL	SQ FT	44313	44313		
78300200	RAISED REFLECTIVE PAVEMENT MARKER REMOVAL	EACH	1285	1285		
X0326219	BUMP REMOVAL	EACH	1	1		
X4421000	PARTIAL DEPTH PATCHING	TON	10.3	10.3		
Z0063804	MICRO-SURFACING, SINGLE PASS, TYPE II, MIXTURE D	SQ YD	173612	173612		
+Z0076600	TRAINEES	HOUR	500	500		
+Z0076604	TRAINEES, TRAINING PROGRAM GRADUATE	HOUR	500	500		

*SPECIALTY ITEM +0042

FILE NAME :	USER NAME : burnsideam	DESIGNED -	REVISED -	STATE OF ILLINOIS DEPARTMENT OF TRANSPORTATION	SUMMARY OF QUANTITIES	F.A.P. RTE.	SECTION	COUNTY	TOTAL SHEETS	SHEET NO.	
oi\pwwork\pwwork\burnsideam\d298743\d298743.dwg	076787-shit-plen.dgn	DRAWN -	REVISED -			310	60-09,10,11RS-1	MADISON	21	3	
PLOT SCALE : 1/8" = 1'-0"		CHECKED -	REVISED -			CONTRACT NO. 76F87					
PLOT DATE : 12/5/2012		DATE -	REVISED -			FED. ROAD DIST. NO. ILLINOIS FED. AID PROJECT					

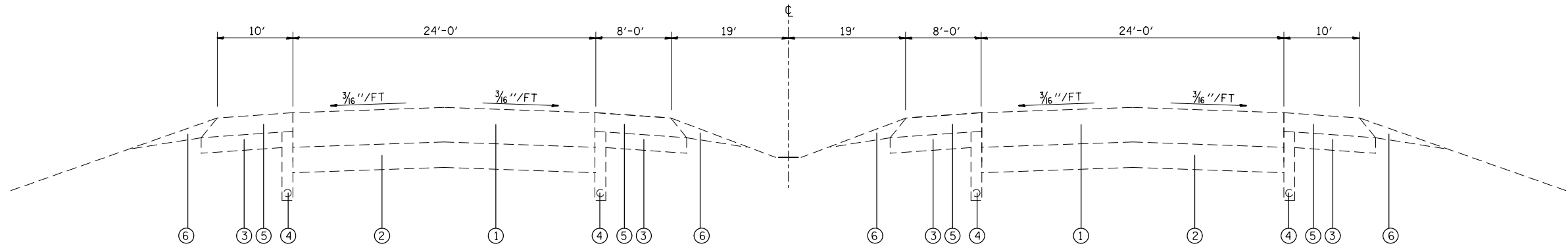

IL 255 - EXISTING TYPICAL SECTION
 STA. 1748+73 TO STA. 1964+37

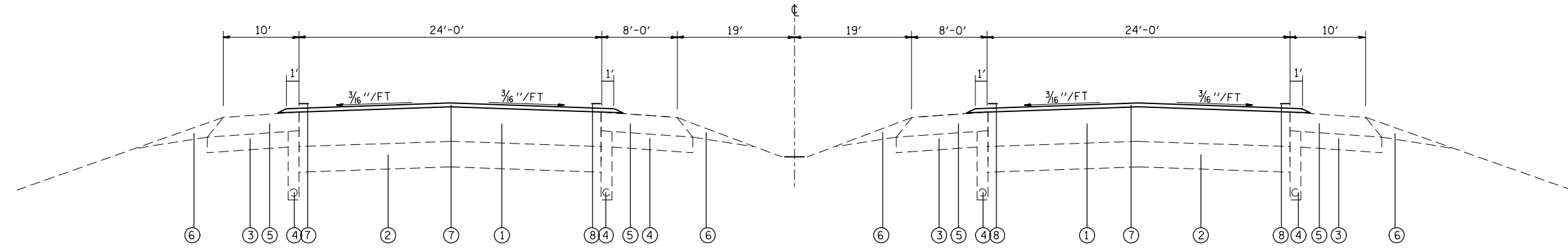

IL 255 - PROPOSED TYPICAL SECTION
 STA. 1748+73 TO STA. 1964+37

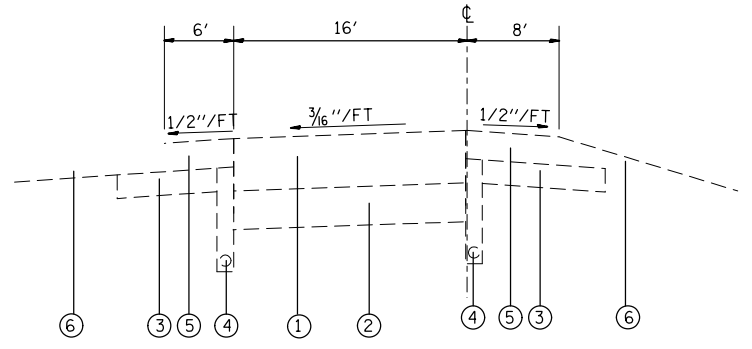

RAMP - EXISTING TYPICAL SECTION
 POAG RD (RAMP 1) - STA. 196+25 TO STA. 216+84
 (RAMP 2) - STA. 300+43 TO STA. 382+02
 (RAMP 3) - STA. 309+37 TO STA. 324+80
 (RAMP 4) - STA. 455+70 TO STA. 476+53
 MADISON AVE (RAMP 1) - STA. 11+40 TO STA. 32+00
 (RAMP 2) - STA. 14+03 TO STA. 33+06
 (RAMP 3) - STA. 11+36 TO STA. 25+28
 (RAMP 4) - STA. 13+30 TO STA. 32+91
 IL 143 (RAMP 1) - STA. 11+67 TO STA. 28+90
 (RAMP 2) - STA. 3+40 TO STA. 20+67

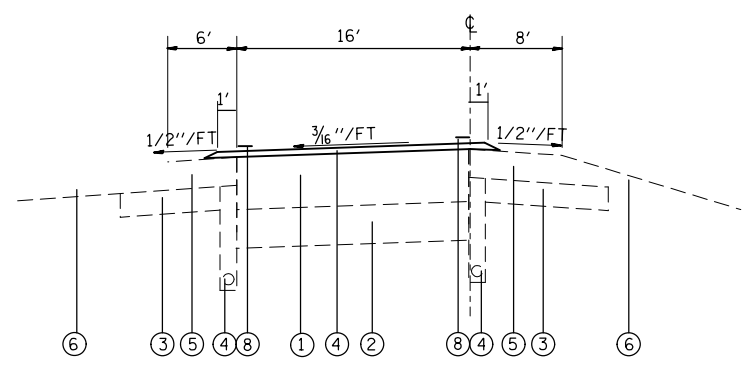

RAMP - PROPOSED TYPICAL SECTION
 POAG RD (RAMP 1) - STA. 196+25 TO STA. 216+84
 (RAMP 2) - STA. 300+43 TO STA. 382+02
 (RAMP 3) - STA. 309+37 TO STA. 324+80
 (RAMP 4) - STA. 455+70 TO STA. 476+53
 MADISON AVE (RAMP 1) - STA. 11+40 TO STA. 32+00
 (RAMP 2) - STA. 14+03 TO STA. 33+06
 (RAMP 3) - STA. 11+36 TO STA. 25+28
 (RAMP 4) - STA. 13+30 TO STA. 32+91
 IL 143 (RAMP 1) - STA. 11+67 TO STA. 28+90
 (RAMP 2) - STA. 13+40 TO STA. 20+67

LEGEND

- ① EXISTING HMA FULL-DEPTH PAVEMENT, 16 1/2"
- ② EXISTING LIME MODIFIED SOIL, 12"
- ③ EXISTING STABILIZED SUB-BASE, 4"
- ④ EXISTING PIPE UNDERDRAIN, 4"
- ⑤ EXISTING HMA SHOULDERS
- ⑥ EXISTING AGG. SHOULDERS
- ⑦ PROPOSED MICRO-SURFACING SINGLE PASS, TYPE II, MIX D
- ⑧ PROPOSED THERMOPLASTIC PAVEMENT MARKING

FILE NAME = c:\pwwork\pwwork\burnsideem\d0298743\876f87-sht-plan.dgn	USER NAME = burnsideem	DESIGNED -	REVISED -	STATE OF ILLINOIS DEPARTMENT OF TRANSPORTATION	TYPICAL SECTIONS			F.A.P. RTE.	SECTION	COUNTY	TOTAL SHEETS	SHEET NO.
	PLOT SCALE = 100.0000' / 1in.	CHECKED -	REVISED -					310	60-(9,10,11)RS-1	MADISON	21	4
PLOT DATE = 12/5/2012	DATE -	REVISED -	REVISED -	SCALE:	SHEET NO.	OF SHEETS	STA.	TO STA.	FED. ROAD DIST. NO.	ILLINOIS FED. AID PROJECT	CONTRACT NO. 76F87	

MICRO-SURFACING SCHEDULE											
STATION		MICRO-SURFACING SINGLE PASS TYPE II	STATION		MICRO-SURFACING SINGLE PASS TYPE II	STATION		MICRO-SURFACING SINGLE PASS TYPE II			
IL 255 - NORTHBOUND		(SQ YD)	IL 255 - SOUTHBOUND		(SQ YD)	POAG RAMP 1		(SQ YD)			
1749+52	TO	1751+68	625	1748+87	TO	1756+03	3103	196+25	TO	216+84	4118
1751+68	TO	1755+69	1671	1756+03	TO	1774+18	5243	POAG RAMP 2			
1755+69	TO	1774+25	5362	1774+18	TO	1775+19	488	300+43	TO	382+02	16318
1774+25	TO	1775+26	511	1775+19	TO	1777+41	BRIDGE OMISSION	POAG RAMP 3			
1775+26	TO	1777+48	BRIDGE OMISSION	1777+41	TO	1778+20	250	309+37	TO	324+80	3086
1777+48	TO	1783+76	2303	1778+20	TO	1785+49	2106	POAG RAMP 4			
1783+76	TO	1785+76	578	1785+49	TO	1789+75	BRIDGE OMISSION	455+70	TO	474+64	3788
1785+76	TO	1790+02	BRIDGE OMISSION	1789+75	TO	1815+75	7511	474+64	TO	476+53	462
1790+02	TO	1815+80	7448	1815+75	TO	1816+94	BRIDGE OMISSION	MADISON AVE RAMP 1			
1815+80	TO	1816+99	BRIDGE OMISSION	1816+94	TO	1834+83	5168	11+40	TO	32+00	4120
1816+99	TO	1835+87	5454	1834+83	TO	1838+17	BRIDGE OMISSION	MADISON AVE RAMP 2			
1835+87	TO	1839+21	BRIDGE OMISSION	1838+17	TO	1847+85	2796	14+03	TO	30+24	3242
1839+21	TO	1847+85	2496	1847+85	TO	1848+73	BRIDGE OMISSION	30+24	TO	33+06	689
1847+85	TO	1848+73	BRIDGE OMISSION	1848+73	TO	1865+01	4703	MADISON AVE RAMP 3			
1848+73	TO	1872+71	6928	1865+01	TO	1875+21	4023	11+36	TO	25+28	2784
1872+71	TO	1876+90	1723	1875+21	TO	1893+83	5379	MADISON AVE RAMP 4			
1876+90	TO	1894+90	5200	1893+83	TO	1895+10	642	13+30	TO	30+00	3340
1894+90	TO	1895+10	101	1895+10	TO	1897+15	BRIDGE OMISSION	30+00	TO	32+91	711
1895+10	TO	1897+15	BRIDGE OMISSION	1897+15	TO	1898+04	282	IL 143 RAMP 1			
1897+15	TO	1904+90	2885	1898+04	TO	1929+27	9022	11+67	TO	28+90	1723
1904+90	TO	1928+06	6691	1929+27	TO	1936+28	2492	IL 143 RAMP 2			
1928+06	TO	1931+05	1063	1936+28	TO	1950+28	5911	13+40	TO	19+00	1618
1931+05	TO	1946+05	6333	1950+28	TO	1954+30	1854	19+00	TO	20+67	594
1946+05	TO	1949+46	1781	1954+30	TO	1964+37	2909				
1949+46	TO	1963+25	3984								
SUBTOTAL		63137				63882					46593
TOTAL						173612					

AGGREGATE SHOULDERS					
LOCATION		LENGTH	WIDTH	TYPE A, 6"	
STA	TO	STA	(FT)	(FT)	(SQ YD)
POAG RD RAMP 1 - RIGHT					
14+30	TO	17+30	300.0	3.0	100
MADISON AVE RAMP 1 - RIGHT					
196+25	TO	201+60	535.0	3.0	178
TOTAL:					278

PARTIAL DEPTH PATCHING						
LOCATION	LANE	LENGTH	WIDTH	BITUMINOUS MATERIALS (PRIME COAT)	PARTIAL DEPTH REM 2 INCH	HMA PART. DEPTH PATCHING
		(FT)	(FT)	(TON)	(SQ. YD.)	(TON)
IL 255 NB						
1941+75	OUTSIDE	20.0	2.0	0.001	4	0.5
1950+00	OUTSIDE	200.0	2.0	0.014	44	5.0
IL 255 SB						
1748+87	OUTSIDE	2.0	22.0	0.002	5	0.5
1777+41	OUTSIDE	2.0	17.0	0.001	4	0.4
1785+39	OUTSIDE	10.0	12.0	0.004	13	1.5
1815+73	OUTSIDE	2.0	12.0	0.001	3	0.3
1816+94	OUTSIDE	2.0	12.0	0.001	3	0.3
POAG RD RAMP 1						
210+50	OUTSIDE	12.0	2.0	0.001	3	0.3
211+00	OUTSIDE	4.0	2.0	0.000	1	0.1
SUBTOTAL:				0.025	80	8.9
ANTICIPATED FAILURES (15%):				0.004	12	1.3
TOTAL:				0.03	92	10.3

RAISED REFLECTIVE PAVEMENT MARKERS				
LOCATION		ONE WAY CRYSTAL	REMOVAL	
STA	TO	(EACH)	(EACH)	
IL 255 - NORTHBOUND				
1749+52	TO	1775+26	66	66
1777+48	TO	1785+76	24	24
1790+02	TO	1815+80	64	64
1816+99	TO	1835+87	48	48
1839+21	TO	1847+85	22	22
1848+73	TO	1895+10	116	116
1897+15	TO	1963+25	166	166
IL 255 - SOUTHBOUND				
1748+87	TO	1775+19	74	74
1777+41	TO	1785+49	20	20
1789+75	TO	1815+75	66	66
1816+94	TO	1834+83	44	44
1838+17	TO	1847+85	24	24
1848+73	TO	1895+10	130	130
1897+15	TO	1964+37	212	212
POAG RAMP 2				
282+02	TO	285+50	26	26
POAG RAMP 4				
455+70	TO	459+00	43	43
MADISON AVE RAMP 2				
14+03	TO	17+20	38	38
MADISON AVE RAMP 4				
13+30	TO	16+50	53	53
IL 143 RAMP 2				
13+40	TO	16+60	49	49
TOTAL			1285	1285

PAVEMENT MARKING SCHEDULE

LOCATION			TEMPORARY PAVEMENT MARKING					THERMOPLASTIC PAVEMENT MARKING					PAVEMENT MARKING REMOVAL	SHORT-TERM PAVE MARKING WHITE (2 LIFTS)	SHORT-TERM PAVE MARKING YELLOW (2 LIFTS)	WORKZONE PAVE MARKING REMOVAL		
			4"- SOLID (WHITE)	4" - SOLID (YELLOW)	4" - SKIP DASH (WHITE)	8" - SOLID (WHITE)	8" - SKIP DASH (WHITE)	LETTERS/SYMBOLS (WHITE)	4"- SOLID (WHITE)	4" - SOLID (YELLOW)	4" - SKIP DASH (WHITE)	8" - SOLID (WHITE)					8" - SKIP DASH (WHITE)	LETTERS/SYMBOLS (WHITE)
STA	TO	STA	FOOT	FOOT	FOOT	FOOT	FOOT	SQ FT	FOOT	FOOT	FOOT	FOOT	FOOT	SQ FT	SQ FT	FOOT	FOOT	SQ FT
IL 255 - NORTHBOUND																		
1749+52	TO	1754+69	517	517	129		75		517	517	129		75		434	63	40	17
1754+69	TO	1775+26	1178	2057	539		779		1178	2057	539		779		1767	189	158	58
1777+48	TO	1785+76	828	828	234				828	828	234				624	106	64	28
1790+02	TO	1815+80	2578	2578	645				2578	2578	645				1914	315	198	86
1816+99	TO	1835+87	1888	1888	472				1888	1888	472				1402	231	145	63
1839+21	TO	1847+85	864	864	216				864	864	216				642	106	66	29
1848+73	TO	1876+89	2816	2816	704		105		2816	2816	704		105		2161	345	217	94
1876+89	TO	1895+10	1166	1821	460		655		1166	1821	460		655		1576	173	140	52
1897+15	TO	1928+05	3090	3090	817				3090	3090	817				2309	386	238	104
1928+05	TO	1949+45	2140	2140	535		535		2140	2140	535		535		1947	262	165	71
1949+45	TO	1963+25	1064	1380	345		316		1064	1380	345		316		1132	145	106	42
IL 255 - SOUTHBOUND																		
1748+87	TO	1755+04	617	617	234				617	617	234				484	90	47	23
1755+04	TO	1775+19	1153	2015	504		769		1153	2015	504		769		1742	180	155	56
1777+41	TO	1785+49	808	808	202		20		808	808	202		20		613	99	62	27
1789+75	TO	1815+75	2600	2600	650				2600	2600	650				1931	318	200	86
1816+94	TO	1834+83	1789	1789	447				1789	1789	447				1328	219	138	59
1838+17	TO	1847+85	968	968	242				968	968	242				719	118	74	32
1848+73	TO	1875+21	2648	2648	793				2648	2648	793				2009	348	204	92
1875+21	TO	1895+10	1325	1989	497		664		1325	1989	497		664		1724	192	153	58
1897+15	TO	1936+28	3913	3913	978		22		3913	3913	978		22		2920	479	301	130
1936+28	TO	1954+29	1801	1801	901				1801	1801	901				1486	302	139	73
1954+29	TO	1964+37	648	1008			360		648	1008			360		788	50	78	21
POAG RAMP 1																		
196+25	TO	216+84	2059	1700			359		2059	1700			359		1481	158	131	48
POAG RAMP 2																		
282+02	TO	300+43	1841	1530			311		1841	1530			311		1336	142	118	43
POAG RAMP 3																		
309+37	TO	324+80	1543	1200			343		1543	1200			343		1135	119	92	35
POAG RAMP 4																		
455+70	TO	474+64	1894	1474			420		1894	1474			420		1393	146	113	43
474+64	TO	476+53	189	189					189	189					140	15	15	5
MADISON AVE RAMP 1																		
11+40	TO	32+00	2060	1791			269		2060	1791			269		1451	158	138	49
MADISON AVE RAMP 2																		
14+03	TO	33+06	1903	1595			308		1903	1595			308		1376	146	123	45
MADISON AVE RAMP 3																		
11+36	TO	25+28	1392	1047			345		1392	1047			345		1036	107	81	31
MADISON AVE RAMP 4																		
13+30	TO	30+00	1670	1363			307		1670	1363			307		1207	128	105	39
30+00	TO	32+91	291	291					291	291					208	22	22	7
IL 143 RAMP 1																		
11+67	TO	28+90	1723	1367			356		1723	1367			356		1258	133	105	40
IL 143 RAMP 2																		
13+40	TO	19+00	560	243			317		560	243			317		477	43	19	10
19+00	TO	20+67	167	167			30		167	167			30		162	13	13	4
SUBTOTAL			53691	54092	10544	6908	812		53691	54092	10544	6908	812		44313	6047	4161	1701
TOTAL			118327		7720		93.6	118327		7720		93.6	44313	10208		1701		

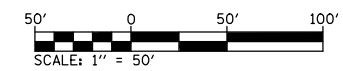
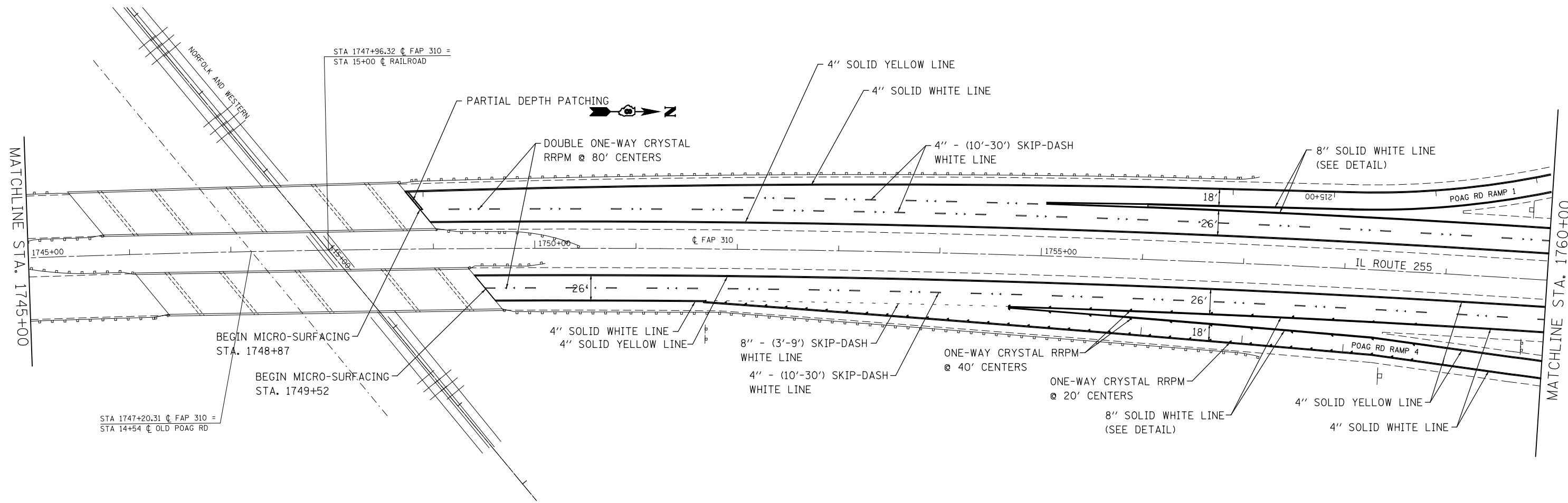

FILE NAME =	USER NAME = burnsideem	DESIGNED -	REVISED -
c:\pw\work\p1dot\burnsideem\d0298743\0876f87-sht-plan.dgn		DRAWN -	REVISED -
	PLOT SCALE = 100.0000' / in.	CHECKED -	REVISED -
	PLOT DATE = 12/5/2012	DATE -	REVISED -

**STATE OF ILLINOIS
DEPARTMENT OF TRANSPORTATION**

PLAN SHEET			
SCALE:	SHEET NO.	OF	SHEETS
			STA. 1730+00 TO STA. 1760+00

F.A.P. RTE.	SECTION	COUNTY	TOTAL SHEETS	SHEET NO.
310	60-(9,10,11)RS-1	MADISON	21	7
CONTRACT NO. 76F87				
FED. ROAD DIST. NO.		ILLINOIS FED. AID PROJECT		

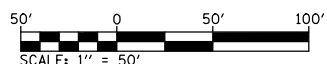
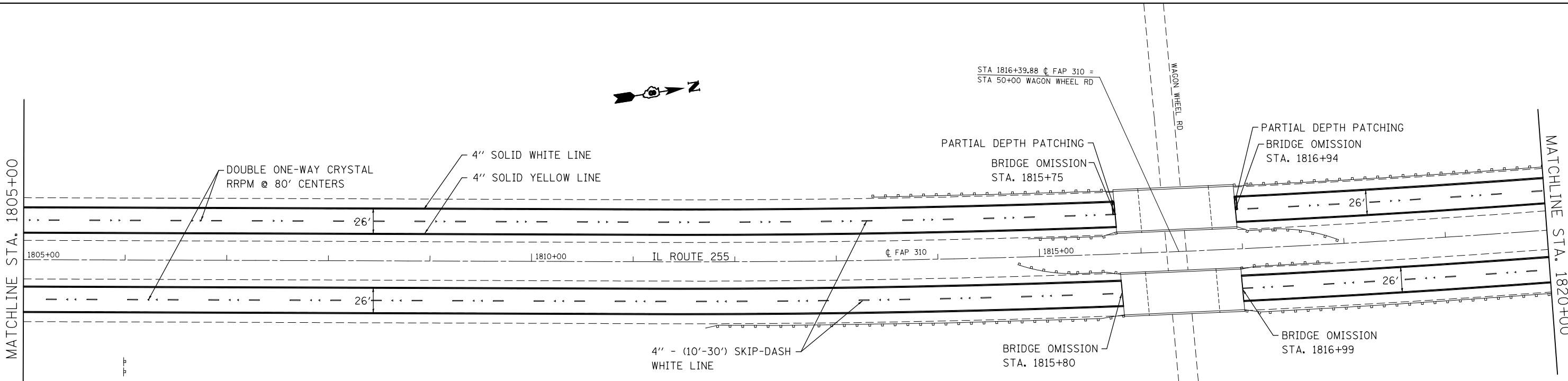
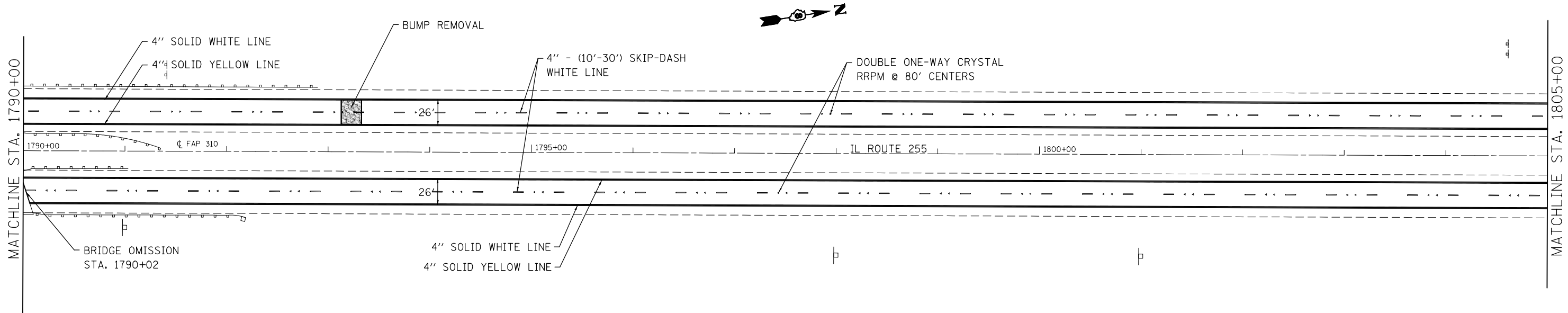

FILE NAME =	USER NAME = burnsideem	DESIGNED -	REVISED -
et:\pw\work\p\dot\burnsideem\d0298743\876f87-sht-plan.dgn		DRAWN -	REVISED -
	PLOT SCALE = 100.0000' / in.	CHECKED -	REVISED -
	PLOT DATE = 12/5/2012	DATE -	REVISED -

**STATE OF ILLINOIS
DEPARTMENT OF TRANSPORTATION**

PLAN SHEET

SCALE: SHEET NO. OF SHEETS STA. 1790+00 TO STA. 1820+00

F.A.P. RTE.	SECTION	COUNTY	TOTAL SHEETS	SHEET NO.
310	60-(9,10,11)RS-1	MADISON	21	9
CONTRACT NO. 76F87				
FED. ROAD DIST. NO. ILLINOIS FED. AID PROJECT				

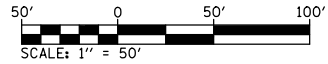
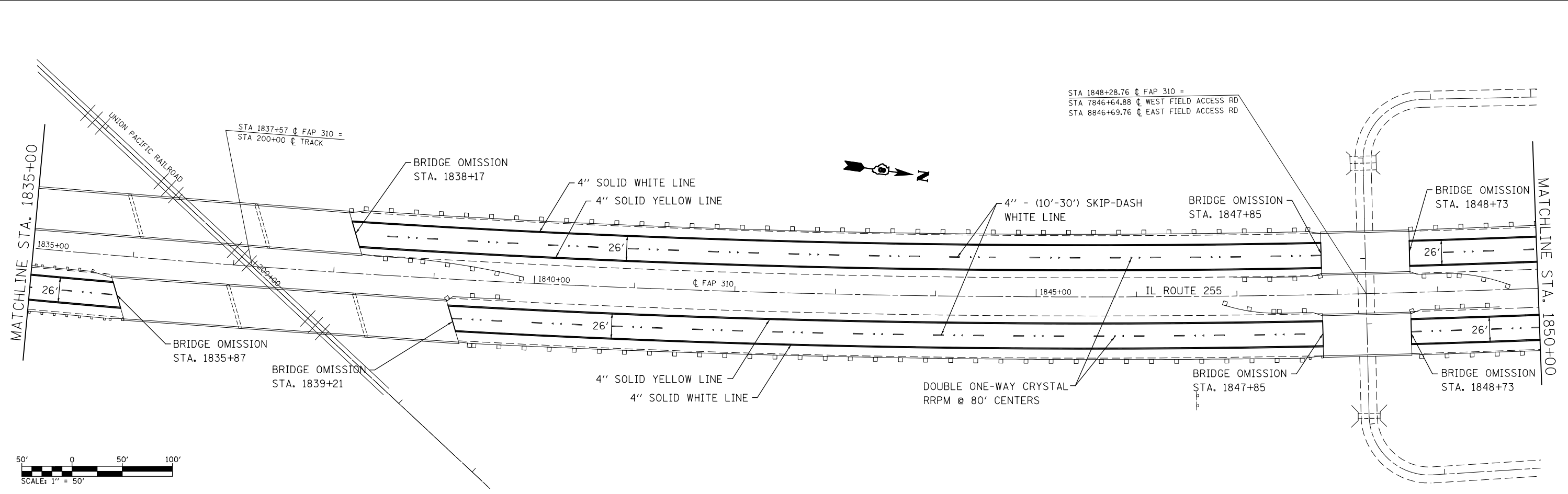
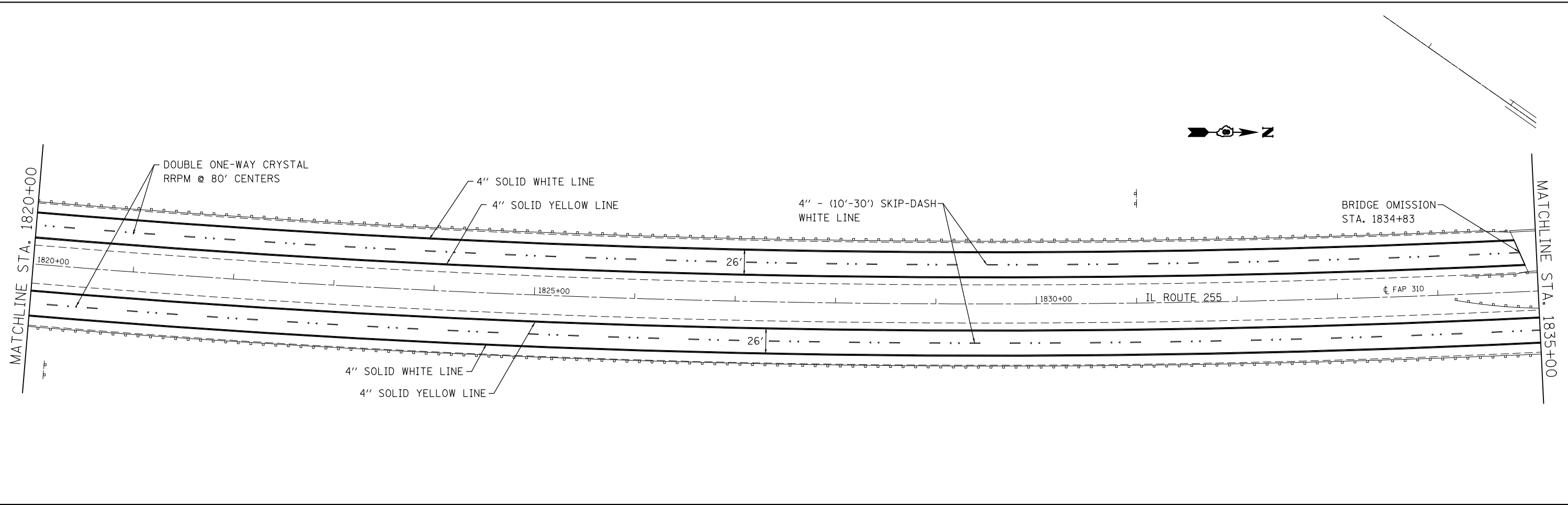

FILE NAME =	USER NAME = burnsideem	DESIGNED -	REVISED -
et:\pw\work\p\id\dot\burnsideem\d0298743\876f87-sht-plan.dgn		DRAWN -	REVISED -
	PLOT SCALE = 100.0000' / in.	CHECKED -	REVISED -
	PLOT DATE = 12/5/2012	DATE -	REVISED -

**STATE OF ILLINOIS
DEPARTMENT OF TRANSPORTATION**

PLAN SHEET

SCALE: SHEET NO. OF SHEETS STA. 1820+00 TO STA. 1850+00

F.A.P. RTE.	SECTION	COUNTY	TOTAL SHEETS	SHEET NO.
310	60-(9,10,11)RS-1	MADISON	21	10
CONTRACT NO. 76F87				
FED. ROAD DIST. NO.		ILLINOIS FED. AID PROJECT		

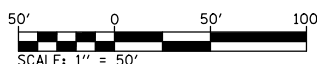
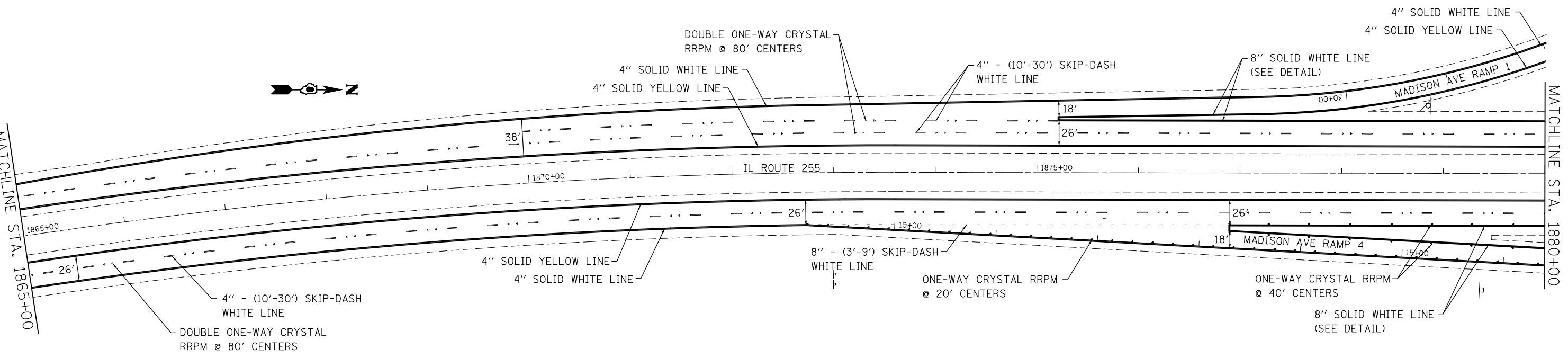
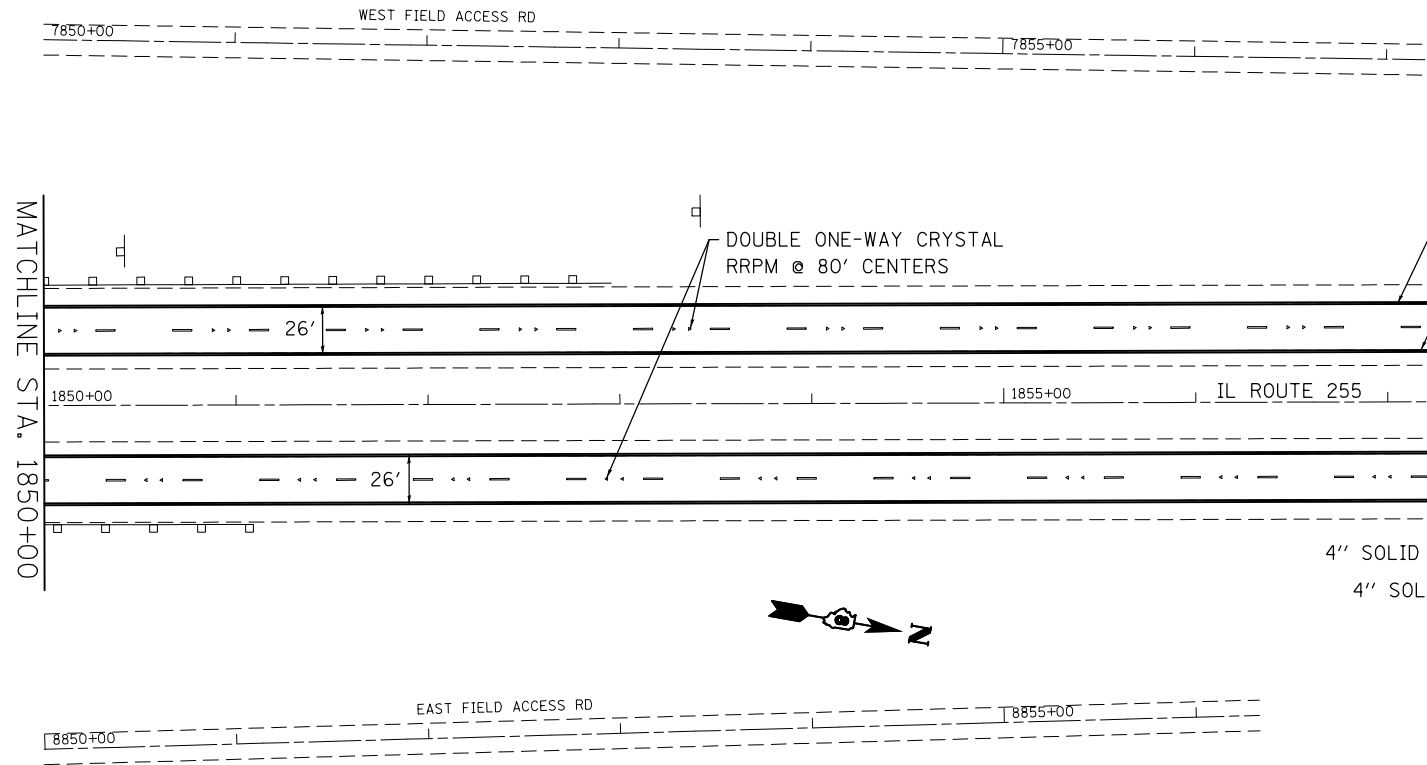

FILE NAME =	USER NAME = burnsideem	DESIGNED -	REVISED -
et:\pwwork\pwwork\burnsideem\d0298743\0876f87-sht-plan.dgn		DRAWN -	REVISED -
	PLOT SCALE = 100.0000' / 1in.	CHECKED -	REVISED -
	PLOT DATE = 12/5/2012	DATE -	REVISED -

**STATE OF ILLINOIS
DEPARTMENT OF TRANSPORTATION**

PLAN SHEET

SCALE: SHEET NO. OF SHEETS STA. 1850+00 TO STA. 1880+00

F.A.P. RTE.	SECTION	COUNTY	TOTAL SHEETS	SHEET NO.
310	60-(9,10,11)RS-1	MADISON	21	11
CONTRACT NO. 76F87				
FED. ROAD DIST. NO.		ILLINOIS FED. AID PROJECT		

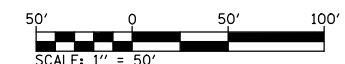
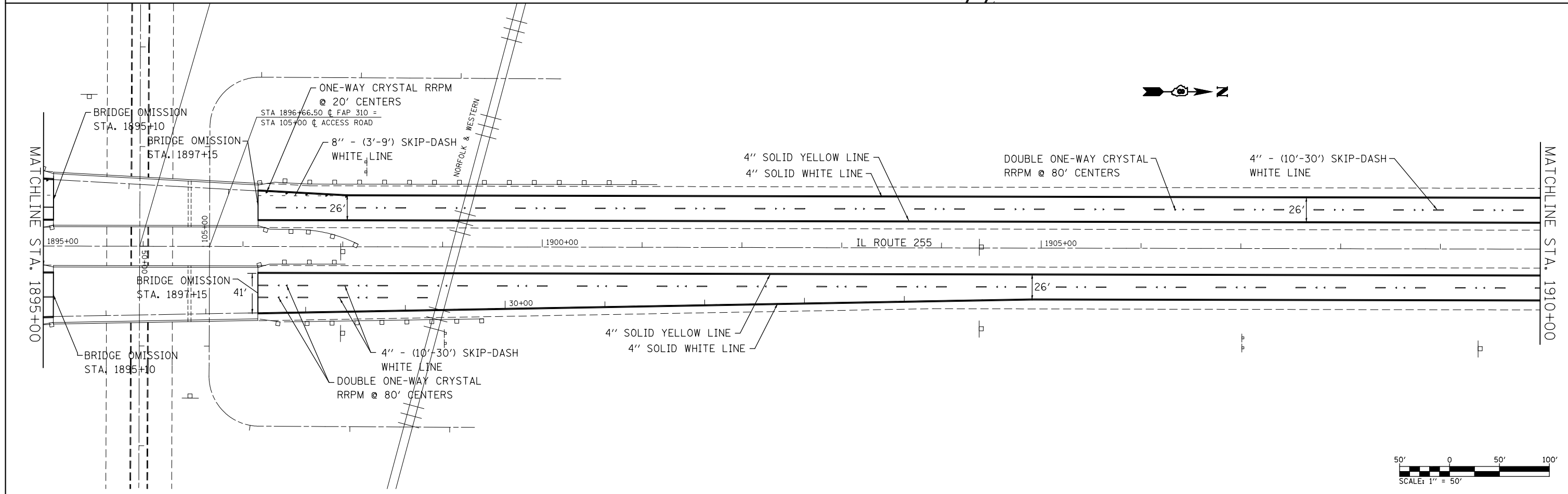
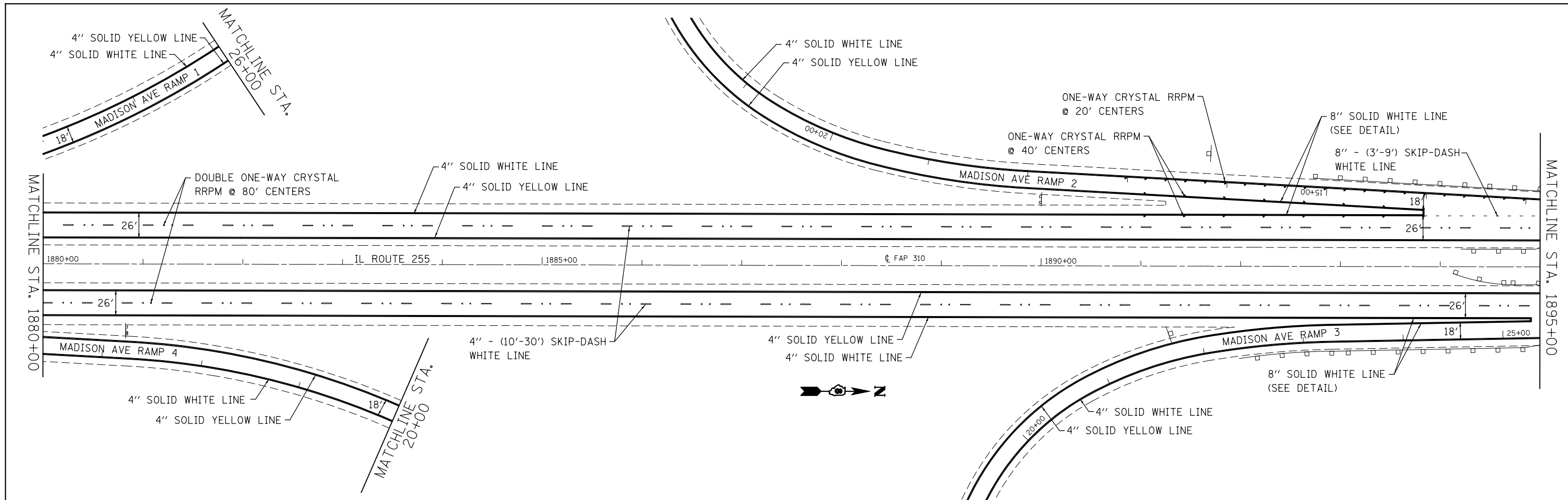

FILE NAME =	USER NAME = burnsideem	DESIGNED -	REVISED -
et:\pwork\pwork\burnsideem\d0298743\d0298743.dwg		DRAWN -	REVISED -
	PLOT SCALE = 100.0000' / 1"	CHECKED -	REVISED -
	PLOT DATE = 12/5/2012	DATE -	REVISED -

**STATE OF ILLINOIS
DEPARTMENT OF TRANSPORTATION**

PLAN SHEET

SCALE: SHEET NO. OF SHEETS STA. 1880+00 TO STA. 1910+00

F.A.P. RTE.	SECTION	COUNTY	TOTAL SHEETS	SHEET NO.
310	60-(9,10,11)RS-1	MADISON	21	12
CONTRACT NO. 76F87				
FED. ROAD DIST. NO. ILLINOIS FED. AID PROJECT				

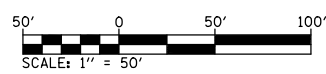
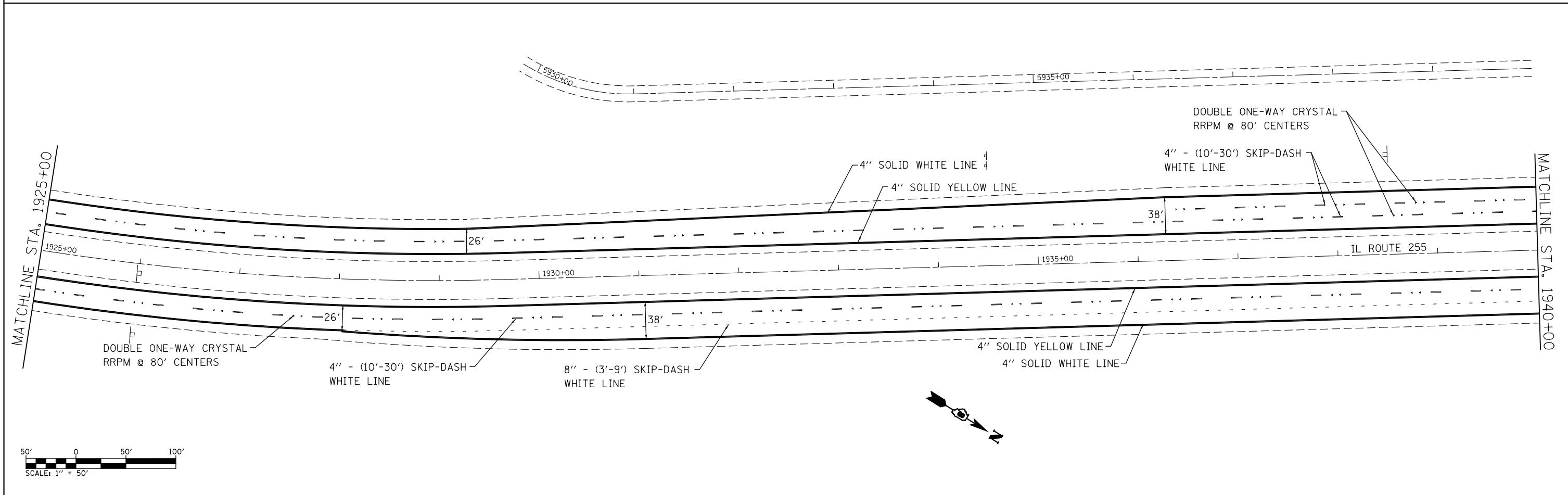
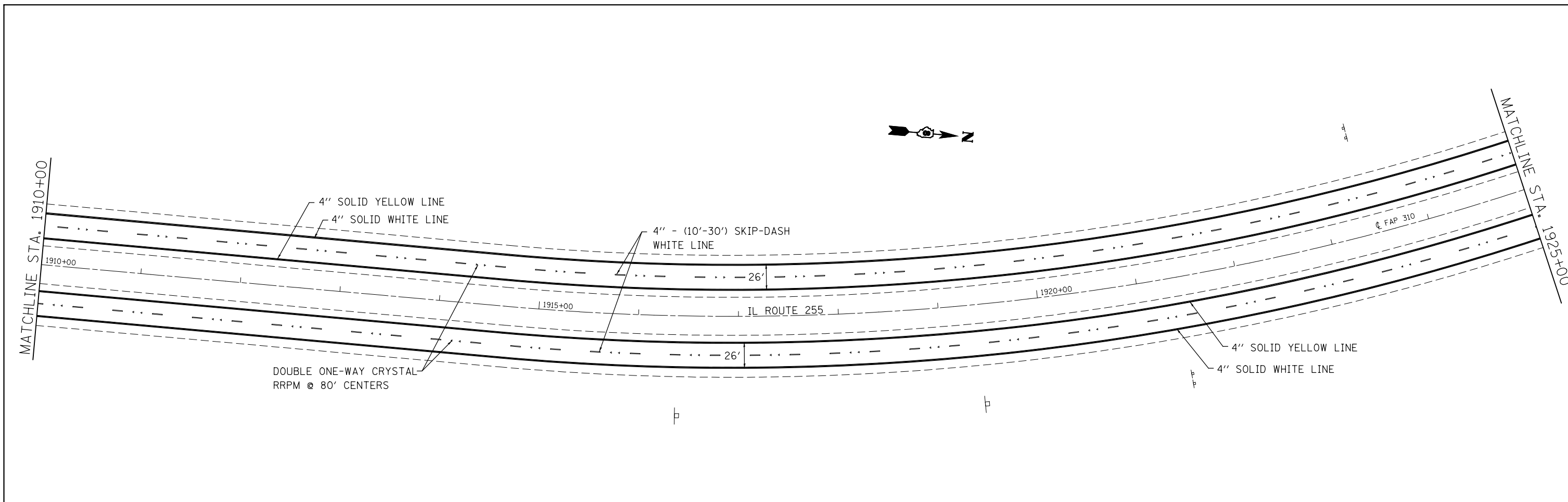

FILE NAME =	USER NAME = burnsideem	DESIGNED -	REVISED -
et:\pw\work\p1dot\burnsideem\d0298743\0876f87-sht-plan.dgn		DRAWN -	REVISED -
	PLOT SCALE = 100.0000' / in.	CHECKED -	REVISED -
	PLOT DATE = 12/5/2012	DATE -	REVISED -

**STATE OF ILLINOIS
DEPARTMENT OF TRANSPORTATION**

PLAN SHEET

SCALE: SHEET NO. OF SHEETS STA. 1910+00 TO STA. 1940+00

F.A.P. RTE.	SECTION	COUNTY	TOTAL SHEETS	SHEET NO.
310	60-(9,10,11)RS-1	MADISON	21	13
CONTRACT NO. 76F87				
FED. ROAD DIST. NO.		ILLINOIS FED. AID PROJECT		

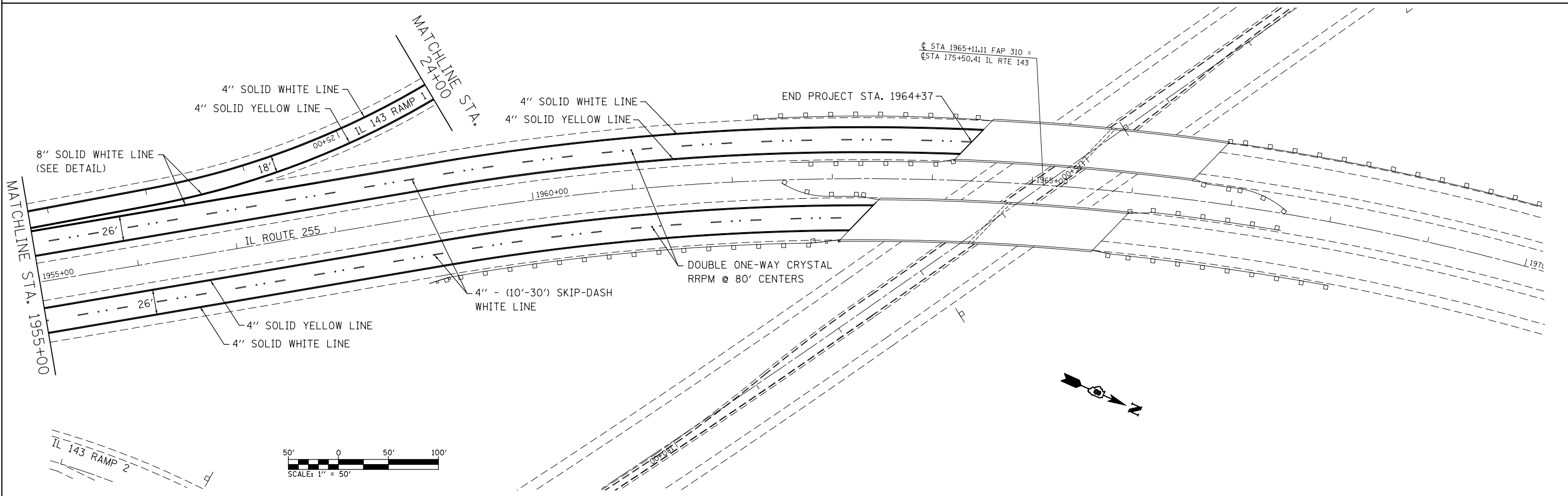
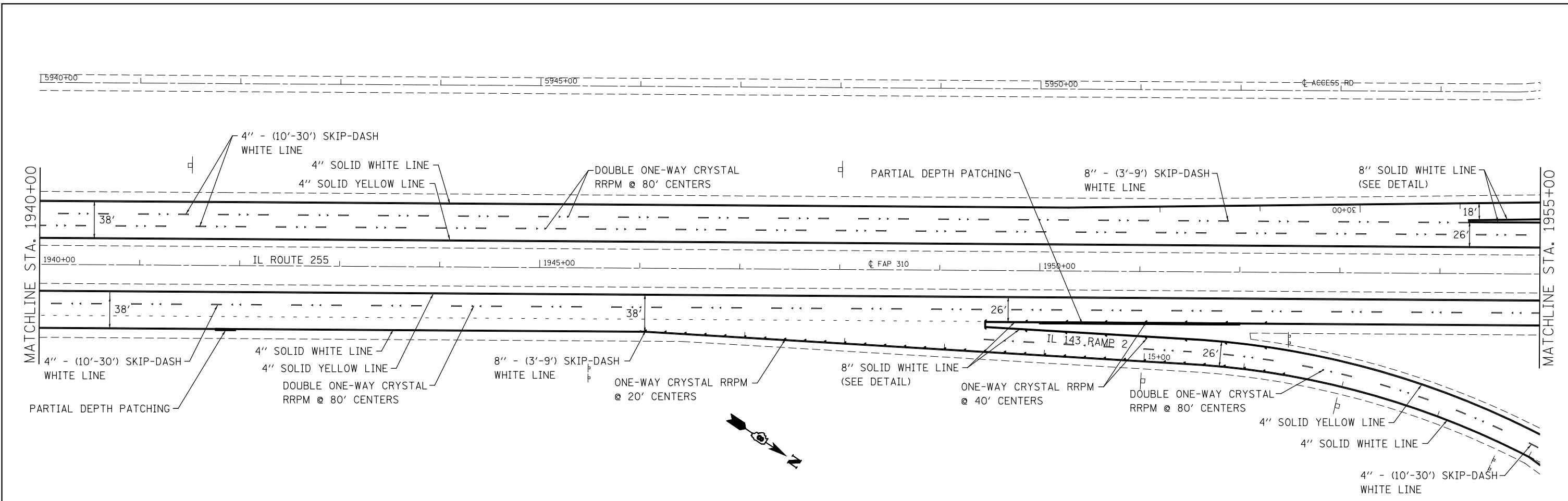

FILE NAME =	USER NAME = burnsideem	DESIGNED -	REVISED -	STATE OF ILLINOIS DEPARTMENT OF TRANSPORTATION	PLAN SHEET			F.A.P. RTE.	SECTION	COUNTY	TOTAL SHEETS	SHEET NO.		
et:\pwork\pwork\burnsideem\d0298743\0876f87-sht-plan.dgn		DRAWN -	REVISED -		SCALE:	SHEET NO.	OF	SHEETS	STA. 1940+00 TO STA. 1958+00	310	60-(9,10,11)RS-1	MADISON	21	14
		CHECKED -	REVISED -							CONTRACT NO. 76F87				
		DATE -	REVISED -							FED. ROAD DIST. NO.	ILLINOIS	FED. AID PROJECT		

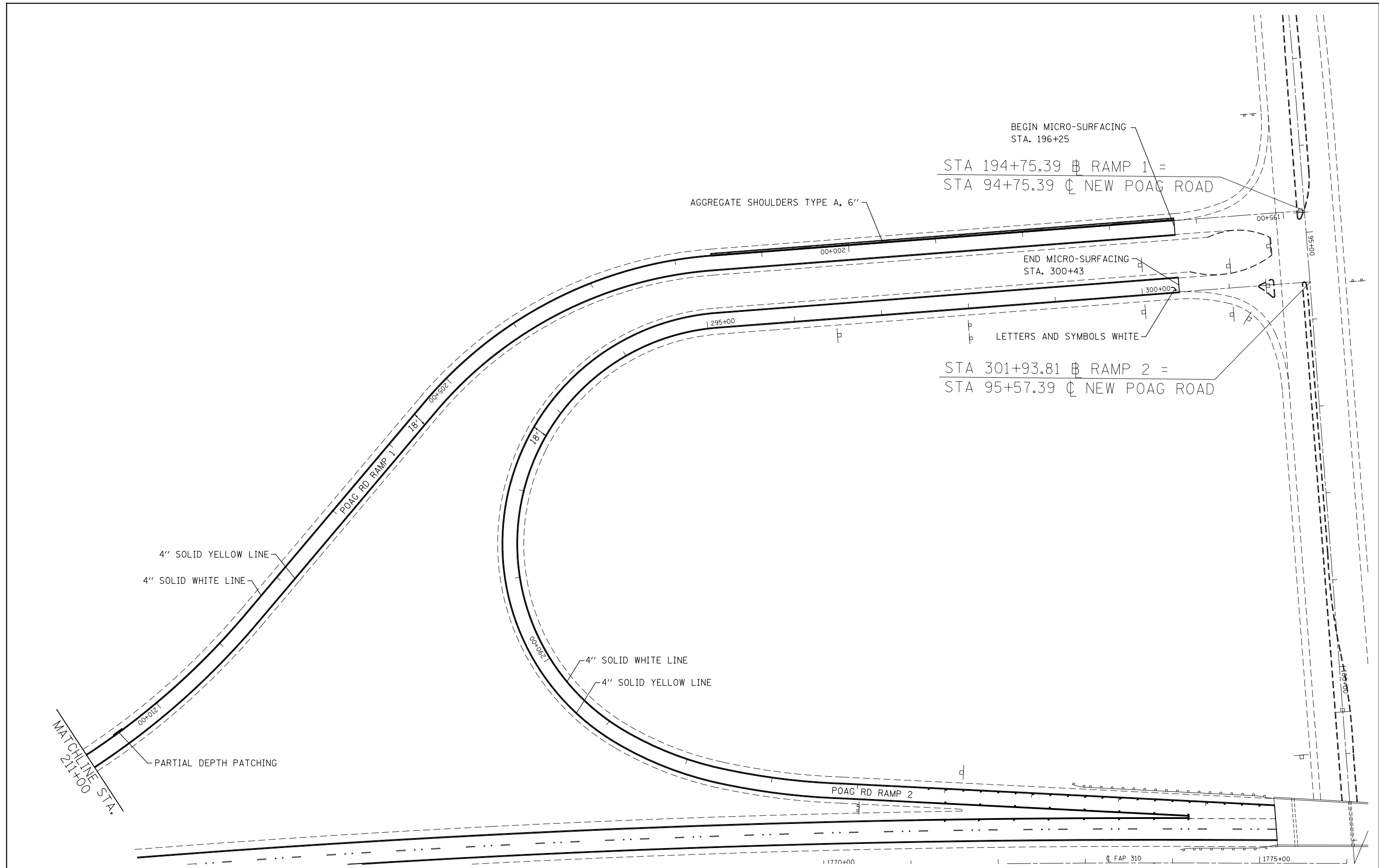

FILE NAME = c:\pw\work\p1\dot\burnsideem\d0298743\876f87-sht-plan.dgn	USER NAME = burnsideem	DESIGNED -	REVISED -	STATE OF ILLINOIS DEPARTMENT OF TRANSPORTATION	PLAN SHEET			F.A.P. RTE.	SECTION	COUNTY	TOTAL SHEETS	SHEET NO.
	PLOT SCALE = 100.0000' / in.	CHECKED -	REVISED -					310	60-(9,10,11)RS-1	MADISON	21	15
PLOT DATE = 12/5/2012	DATE -	REVISED -	SCALE:		SHEET NO.	OF SHEETS	STA. 1730+00 TO STA. 1760+00	CONTRACT NO. 76F87				
							FED. ROAD DIST. NO.	ILLINOIS	FED. AID PROJECT			

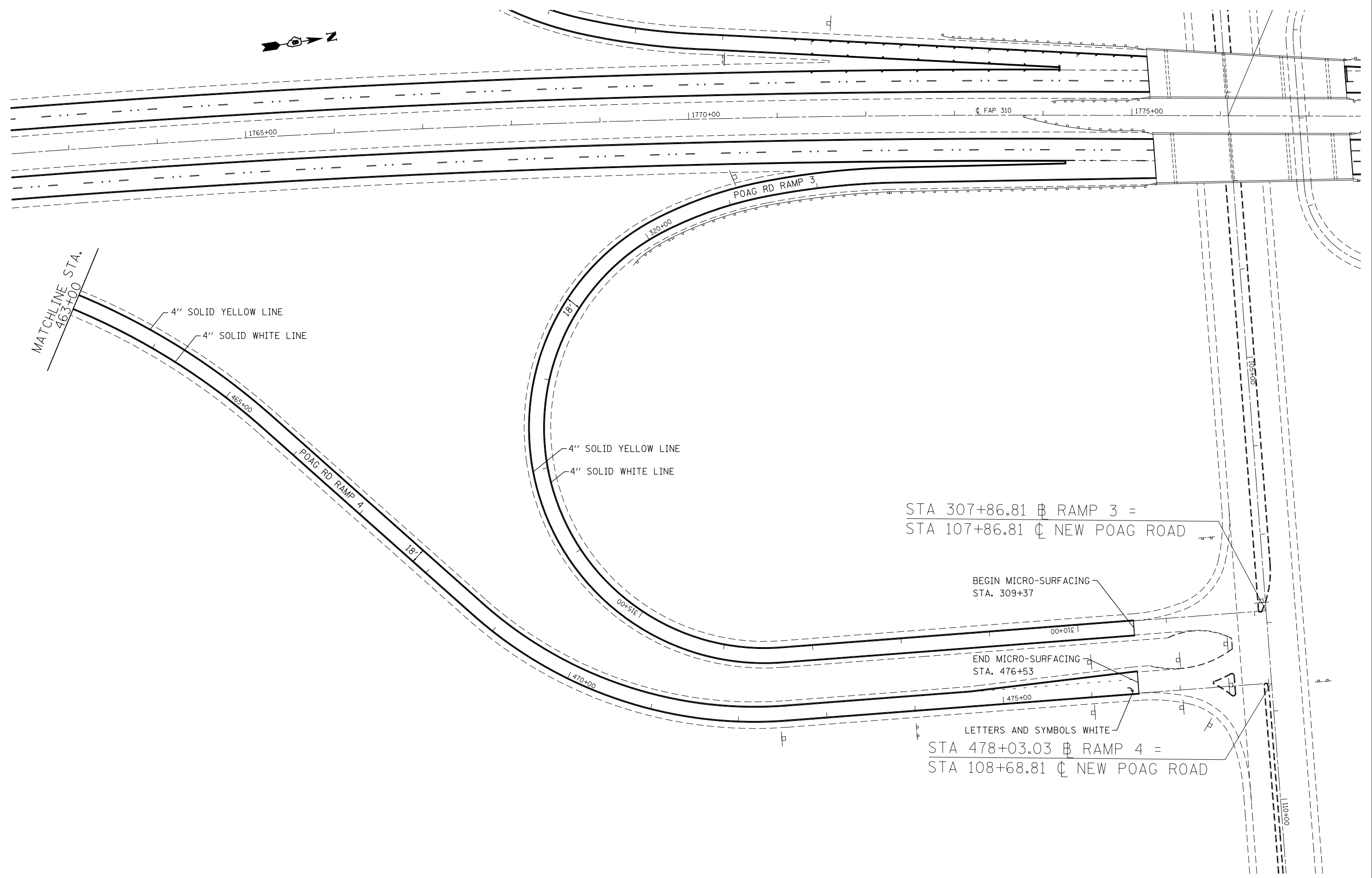

STA 307+86.81 @ RAMP 3 =
 STA 107+86.81 @ NEW POAG ROAD

BEGIN MICRO-SURFACING
 STA. 309+37

END MICRO-SURFACING
 STA. 476+53

LETTERS AND SYMBOLS WHITE
 STA 478+03.03 @ RAMP 4 =
 STA 108+68.81 @ NEW POAG ROAD

FILE NAME =	USER NAME = burnsideem	DESIGNED -	REVISED -
et:\pw\work\p\dot\burnsideem\d0298743\876f87-sht-plan.dgn		DRAWN -	REVISED -
	PLOT SCALE = 100.0000' / in.	CHECKED -	REVISED -
	PLOT DATE = 12/5/2012	DATE -	REVISED -

**STATE OF ILLINOIS
 DEPARTMENT OF TRANSPORTATION**

PLAN SHEET			
SCALE:	SHEET NO.	OF SHEETS	STA. 1730+00 TO STA. 1760+00

F.A.P. RTE.	SECTION	COUNTY	TOTAL SHEETS	SHEET NO.
310	60-(9,10,11)RS-1	MADISON	21	16
CONTRACT NO. 76F87				
FED. ROAD DIST. NO. ILLINOIS FED. AID PROJECT				

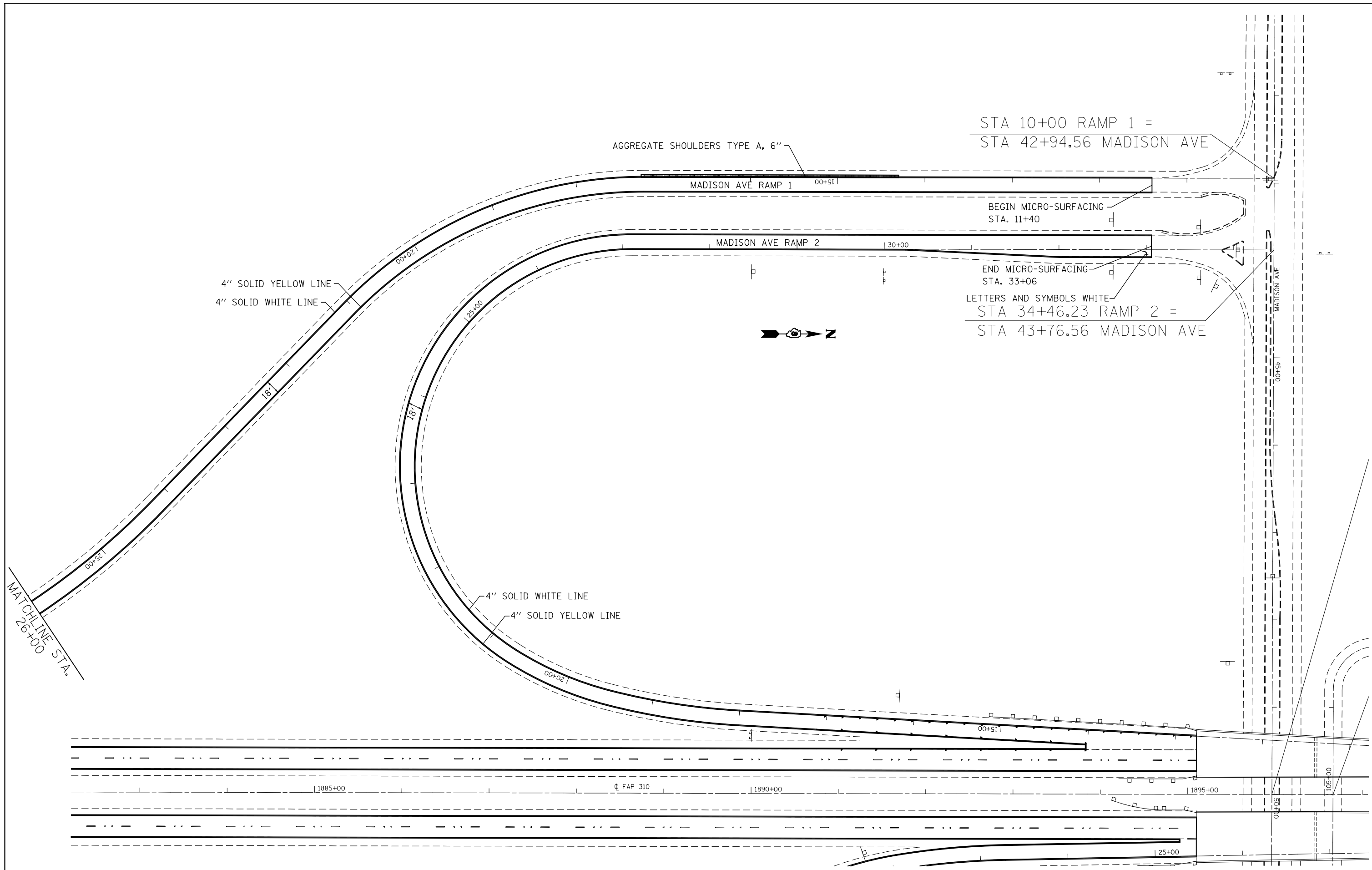

FILE NAME =	USER NAME = burnsideem	DESIGNED -	REVISED -
et:\pwork\pwork\burnsideem\d0298743\876f87-sht-plan.dgn		DRAWN -	REVISED -
	PLOT SCALE = 100.0000' / in.	CHECKED -	REVISED -
	PLOT DATE = 12/5/2012	DATE -	REVISED -

**STATE OF ILLINOIS
DEPARTMENT OF TRANSPORTATION**

PLAN SHEET			
SCALE:	SHEET NO.	OF SHEETS	STA. 1730+00 TO STA. 1760+00

F.A.P. RTE.	SECTION	COUNTY	TOTAL SHEETS	SHEET NO.
310	60-(9,10,11)RS-1	MADISON	21	17
CONTRACT NO. 76F87				
FED. ROAD DIST. NO. ILLINOIS FED. AID PROJECT				

MATCHLINE STA. 20+00

MADISON AVE RAMP 4

4" SOLID WHITE LINE
4" SOLID YELLOW LINE



4" SOLID WHITE LINE
4" SOLID YELLOW LINE

STA 10+00 RAMP 3 =
STA 55+96.08 MADISON AVE

BEGIN MICRO-SURFACING
STA. 11+36

MADISON AVE RAMP 3

END MICRO-SURFACING
STA. 32+91

LETTERS AND SYMBOLS WHITE
STA 34+21.30 RAMP 4 =
STA 56+78.30 MADISON AVE

FILE NAME =	USER NAME = burnsideem	DESIGNED -	REVISED -
et:\pw\work\p\dot\burnsideem\d0298743\876f87-sht-plan.dgn		DRAWN -	REVISED -
	PLOT SCALE = 100.0000' / in.	CHECKED -	REVISED -
	PLOT DATE = 12/5/2012	DATE -	REVISED -

**STATE OF ILLINOIS
DEPARTMENT OF TRANSPORTATION**

PLAN SHEET

SCALE: SHEET NO. OF SHEETS STA. 1730+00 TO STA. 1760+00

F.A.P. RTE.	SECTION	COUNTY	TOTAL SHEETS	SHEET NO.
310	60-(9,10,11)RS-1	MADISON	21	18
CONTRACT NO. 76F87				
FED. ROAD DIST. NO. ILLINOIS FED. AID PROJECT				

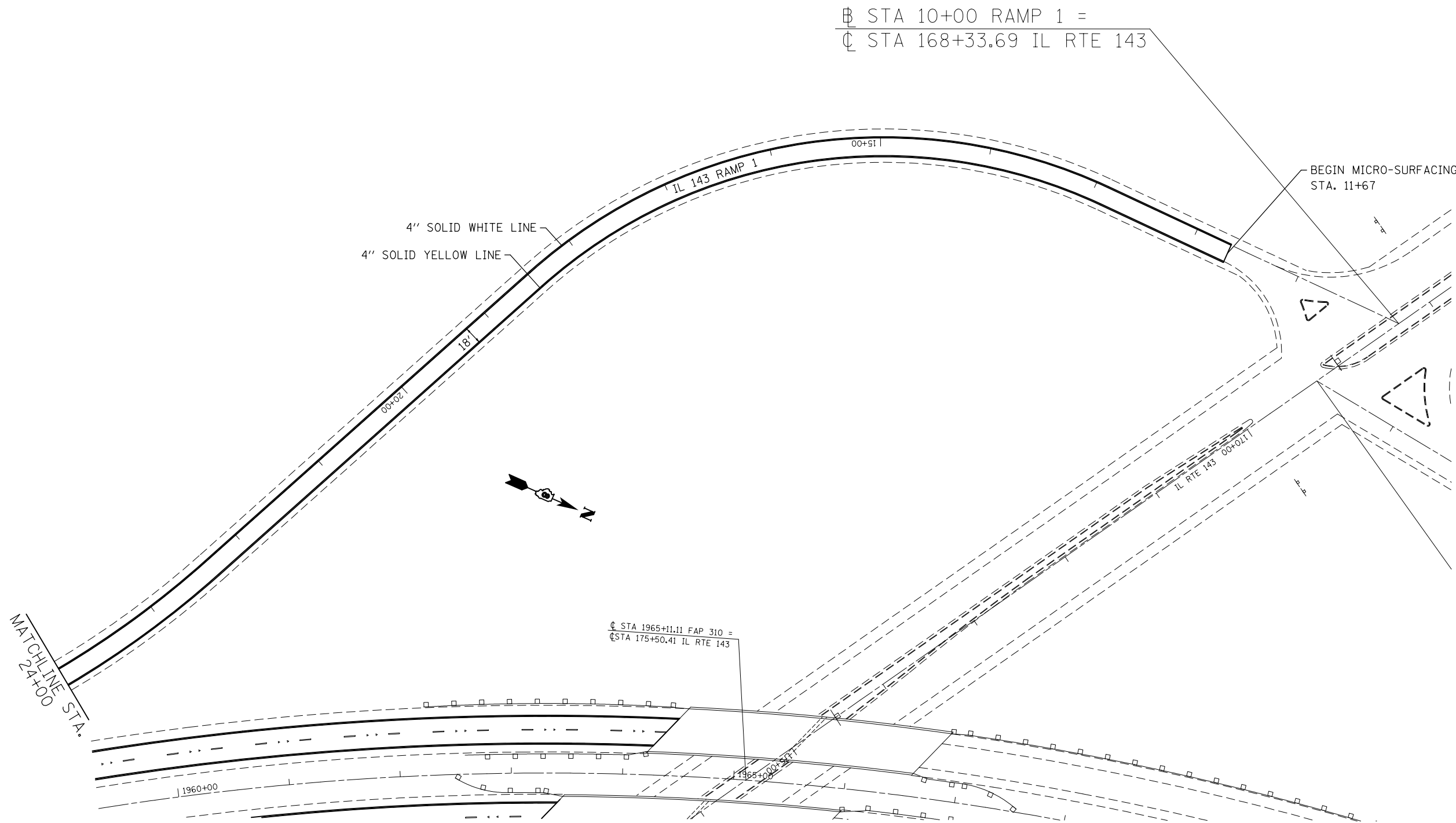

B STA 10+00 RAMP 1 =
 C STA 168+33.69 IL RTE 143

BEGIN MICRO-SURFACING
 STA. 11+67

4" SOLID WHITE LINE
 4" SOLID YELLOW LINE

MATCHLINE STA.
 24+00

C STA 1965+11.11 FAP 310 =
 C STA 175+50.41 IL RTE 143

FILE NAME = c:\pw\work\p1dot\burnsideem\d0298743\0876f87-sht-plan.dgn	USER NAME = burnsideem	DESIGNED -	REVISED -	STATE OF ILLINOIS DEPARTMENT OF TRANSPORTATION	PLAN SHEET			F.A.P. RTE. 310	SECTION 60-(9,10,11)RS-1	COUNTY MADISON	TOTAL SHEETS 21	SHEET NO. 19
	PLOT SCALE = 100.0000' / in.	CHECKED -	REVISED -		SCALE:	SHEET NO.	OF SHEETS	STA. 1730+00 TO STA. 1760+00	CONTRACT NO. 76F87			
PLOT DATE = 12/5/2012	DATE -	REVISED -	REVISED -		FED. ROAD DIST. NO. ILLINOIS FED. AID PROJECT							

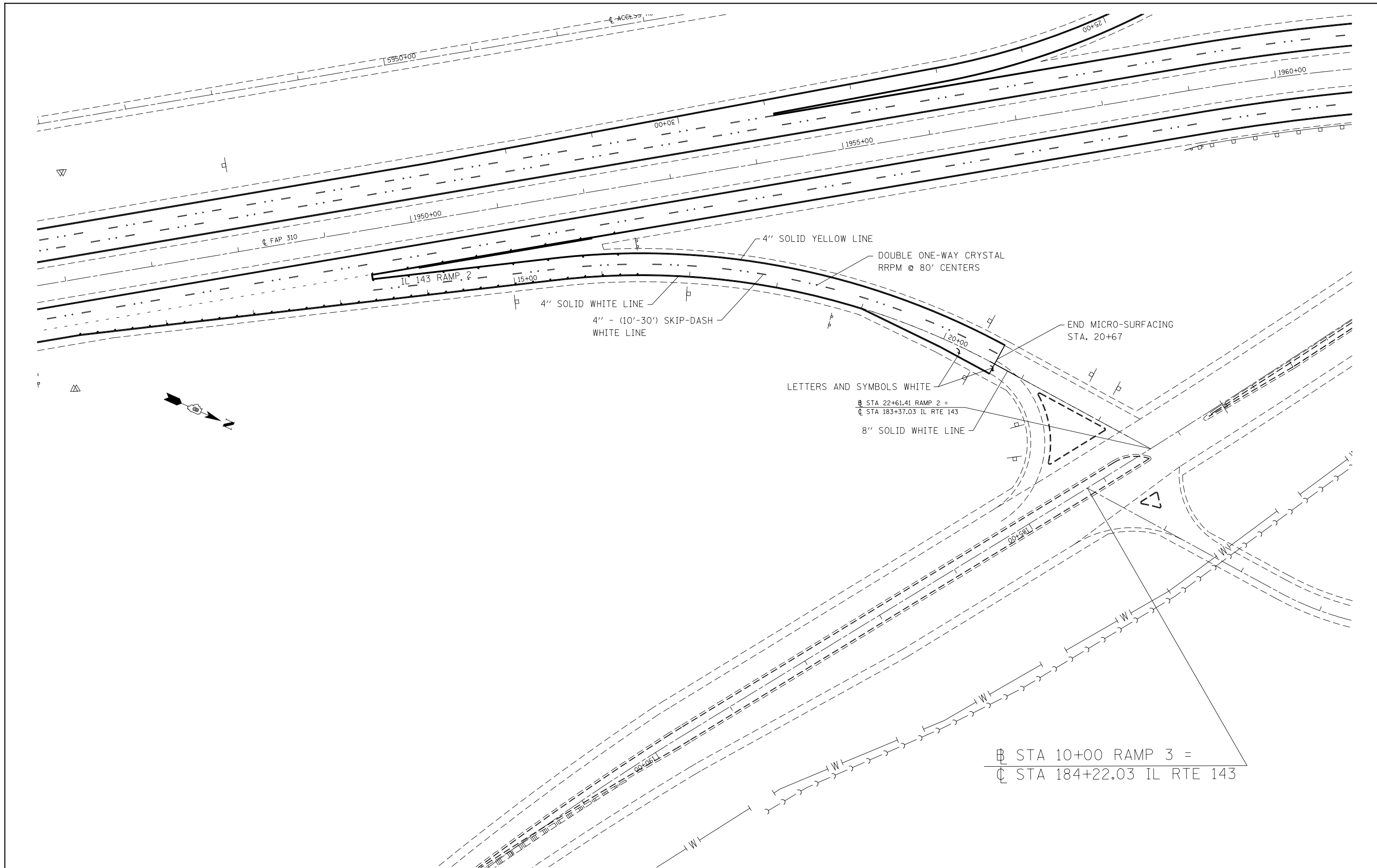

FILE NAME =	USER NAME = burnsideem	DESIGNED -	REVISED -
et:\pw\work\p1dot\burnsideem\d0298743\876f87-sht-plan.dgn		DRAWN -	REVISED -
	PLOT SCALE = 100.0000' / in.	CHECKED -	REVISED -
	PLOT DATE = 12/5/2012	DATE -	REVISED -

STATE OF ILLINOIS
DEPARTMENT OF TRANSPORTATION

PLAN SHEET			
SCALE:	SHEET NO.	OF SHEETS	STA. 1730+00 TO STA. 1760+00

F.A.P. RTE.	SECTION	COUNTY	TOTAL SHEETS	SHEET NO.
310	60-(9,10,11)RS-1	MADISON	21	20
CONTRACT NO. 76F87				
FED. ROAD DIST. NO. ILLINOIS FED. AID PROJECT				

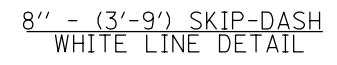
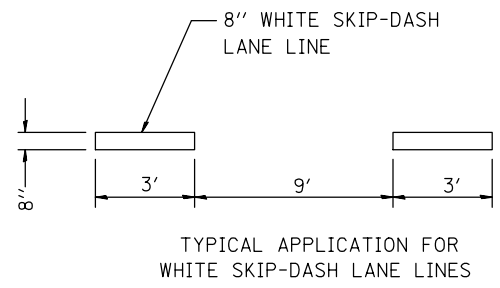
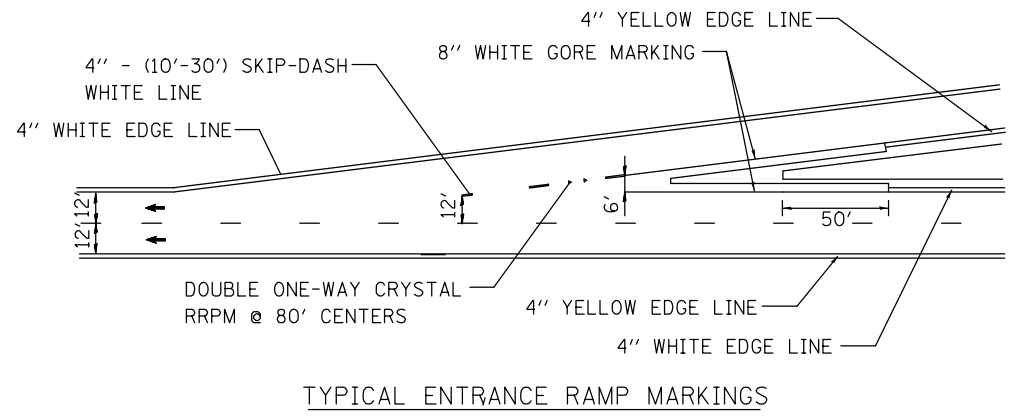
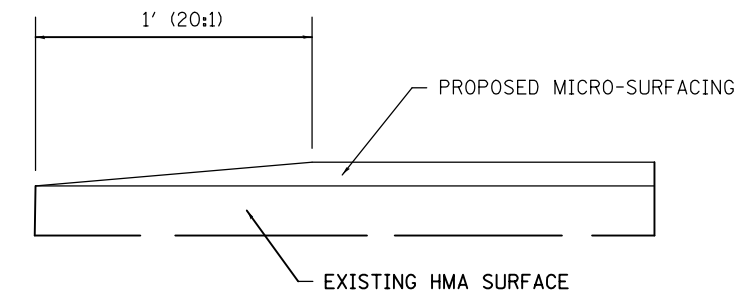
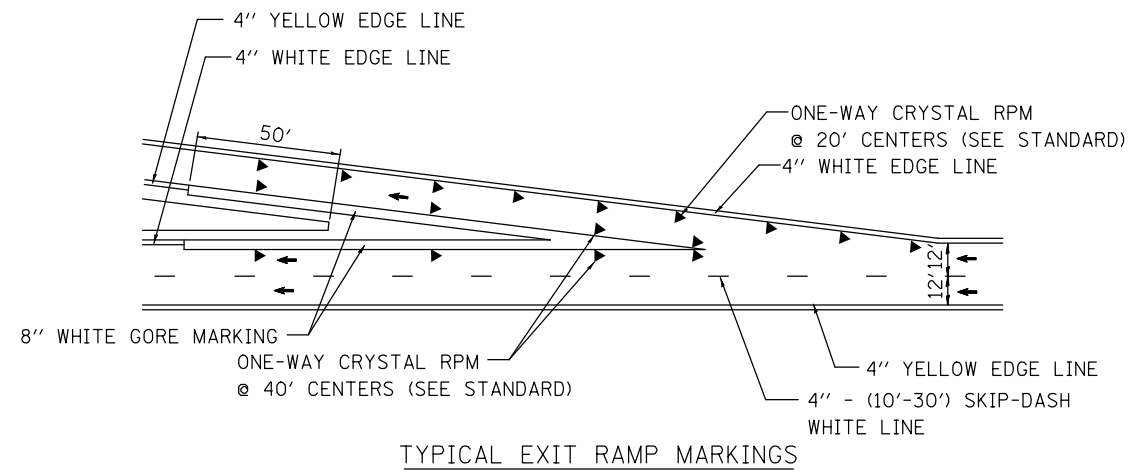

FILE NAME =	USER NAME = burnsideem	DESIGNED -	REVISED -
et:\pw\work\p1\dot\burnsideem\d0298743\876f87-sht-plan.dgn		DRAWN -	REVISED -
	PLOT SCALE = 100.0000' / in.	CHECKED -	REVISED -
	PLOT DATE = 12/5/2012	DATE -	REVISED -

**STATE OF ILLINOIS
 DEPARTMENT OF TRANSPORTATION**

TYPICAL SECTIONS				
SCALE:	SHEET NO.	OF SHEETS	STA.	TO STA.

F.A.P. RTE.	SECTION	COUNTY	TOTAL SHEETS	SHEET NO.
310	60-(9,10,11)RS-1	MADISON	21	21
CONTRACT NO. 76F87				
FED. ROAD DIST. NO. ILLINOIS FED. AID PROJECT				