

STATE OF ILLINOIS  
DEPARTMENT OF TRANSPORTATION

When cantilever forming brackets are used, the work shall be done according to Article 503.06(b) of the Standard Specifications, except as modified below and in the details shown on this sheet.  
The finishing machine rails shall be placed on the top flange of the exterior beams.  
The beams or girders, supporting cantilever forming brackets, shall be tied together at 4 foot intervals.  
For Standard construction, or Stage Construction the Hardwood bracing materials shall be placed as shown between webs of beams in each bay.

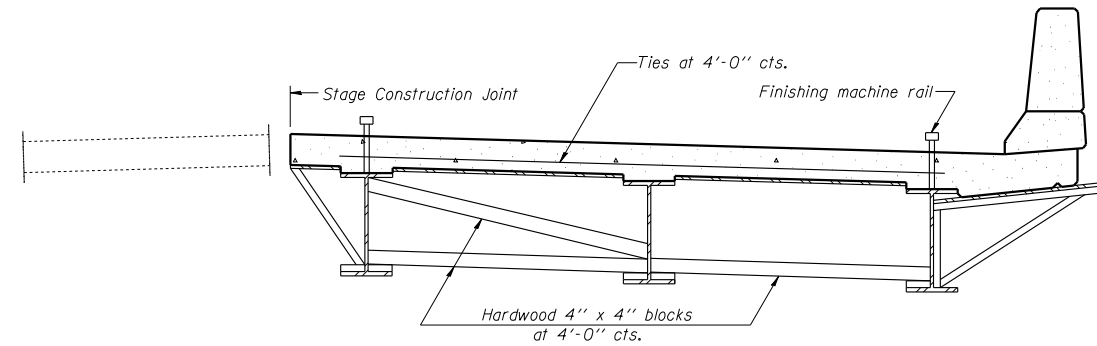

FORM BRACES FOR  
STAGE CONSTRUCTION

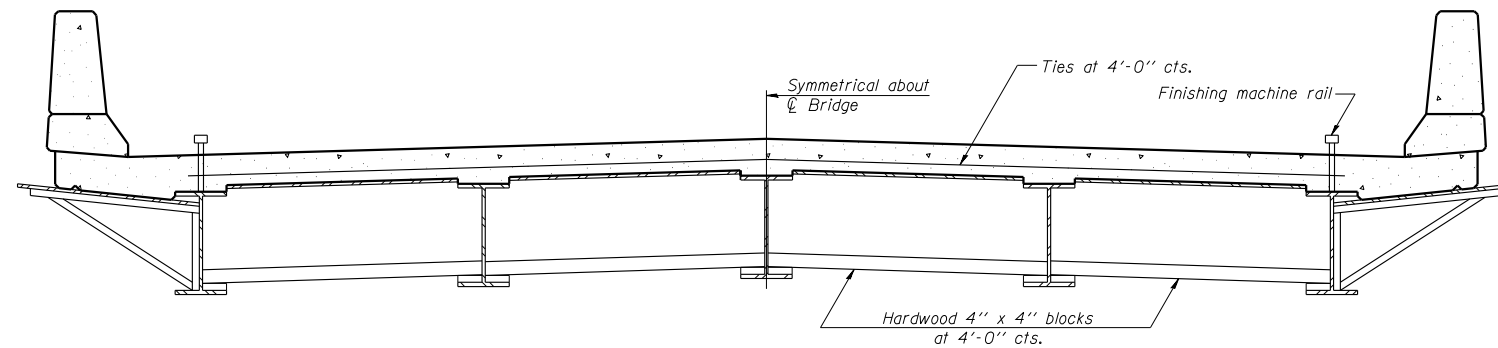

FORM BRACES FOR  
STANDARD CONSTRUCTION

CANTILEVER FORMING BRACKETS  
F.A.I. RTE. 57 OVER  
LAKE CREEK BRANCH  
STATION 228+25.00  
STRUCTURE NO. 100-0010 (N.B.)  
STRUCTURE NO. 100-0011 (S.B.)

**CMT**  
CRAWFORD MURPHY & TILLY, INC.  
CONSULTING ENGINEERS  
SPRINGFIELD, IL ■ AURORA, IL ■ ST. LOUIS, MO  
ROCKFORD, IL ■ PEORIA, IL ■ CHICAGO, IL  
DESIGNED BY: KEH DRAWN BY: GLD  
CHECKED BY: WLB DATE: 4/12/10

SHEET NO. 28  29 SHEETS	F.A.S. RTE.	SECTION	COUNTY	TOTAL SHEETS	SHEET NO.
	I-57	(X1-4-1) BR -1	WILLIAMSON	202	111
			CONTRACT NO. 78334		
FED. ROAD DIST. NO. 9 ILLINOIS FED. AID PROJECT					