

NOTE: BOLLARDS SHALL BE INSTALLED
6' CENTER TO CENTER

BOLLARD DETAIL

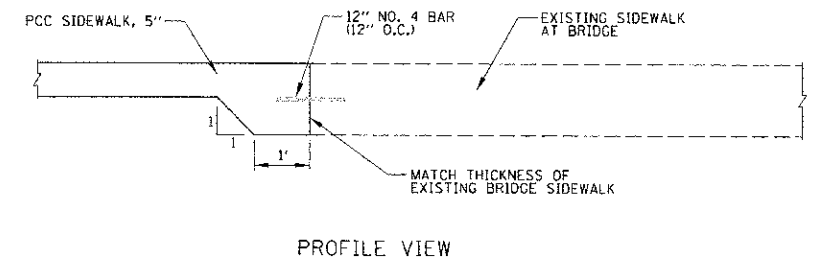
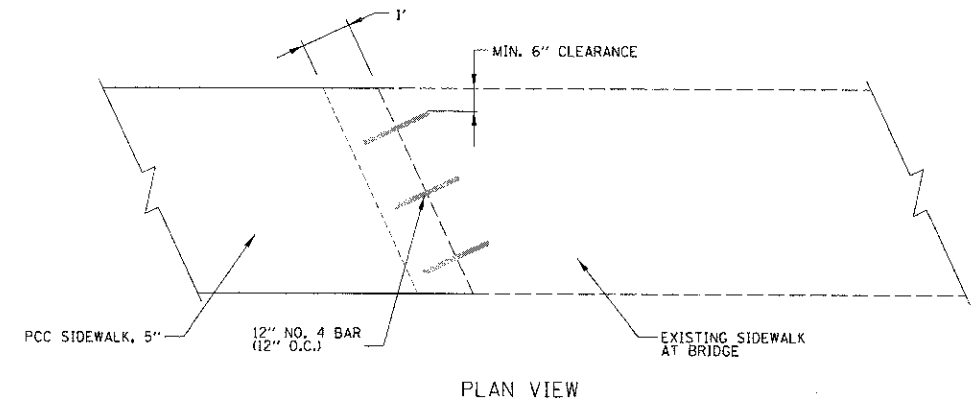

NOTE: ALL REINFORCING BAR AND ADDITIONAL
CONCRETE THICKNESS WILL NOT BE PAID SEPERATE
BUT SHALL BE INCLUDED IN THE COST OF
PCC SIDEWALK, 5'

SIDEWALK/BRIDGE CONNECTION DETAIL

FILE NAME =	USER NAME = C:\C001\COM	DESIGNED - CJM	REVISED -	STATE OF ILLINOIS DEPARTMENT OF TRANSPORTATION	CONSTRUCTION DETAILS		F.A. RTE.	SECTION	COUNTY	TOTAL SHEETS	SHEET NO.
X:\Dwg\12-00051-00-SW\12-00051-00-SW-DET-1-R32.DWG		DRAWN - CJM	REVISED -				12-00051-00-SW	LIVINGSTON	40	4	
PLST SCALE = 1"		CHECKED - REH	REVISED -		SCALE: N.T.S.		SHEET NO. 1 OF 1 SHEETS	STA. TO STA.	CONTRACT NO. 87547		
PLST DATE = 2/7/2013		DATE - 02/08/13	REVISED -		ILLINOIS FED. AID PROJECT						