

ROUTE NO.	SECTION	COUNTY	TOTAL SHEETS	SHEET NO.
MULTIPLE	12-00177-02-SP	PEORIA	66	41
FED. ROAD DIST. NO.	--	ILLINOIS	PROJECT: HSIP 0143 (052)	
CONTRACT NO. 89627				

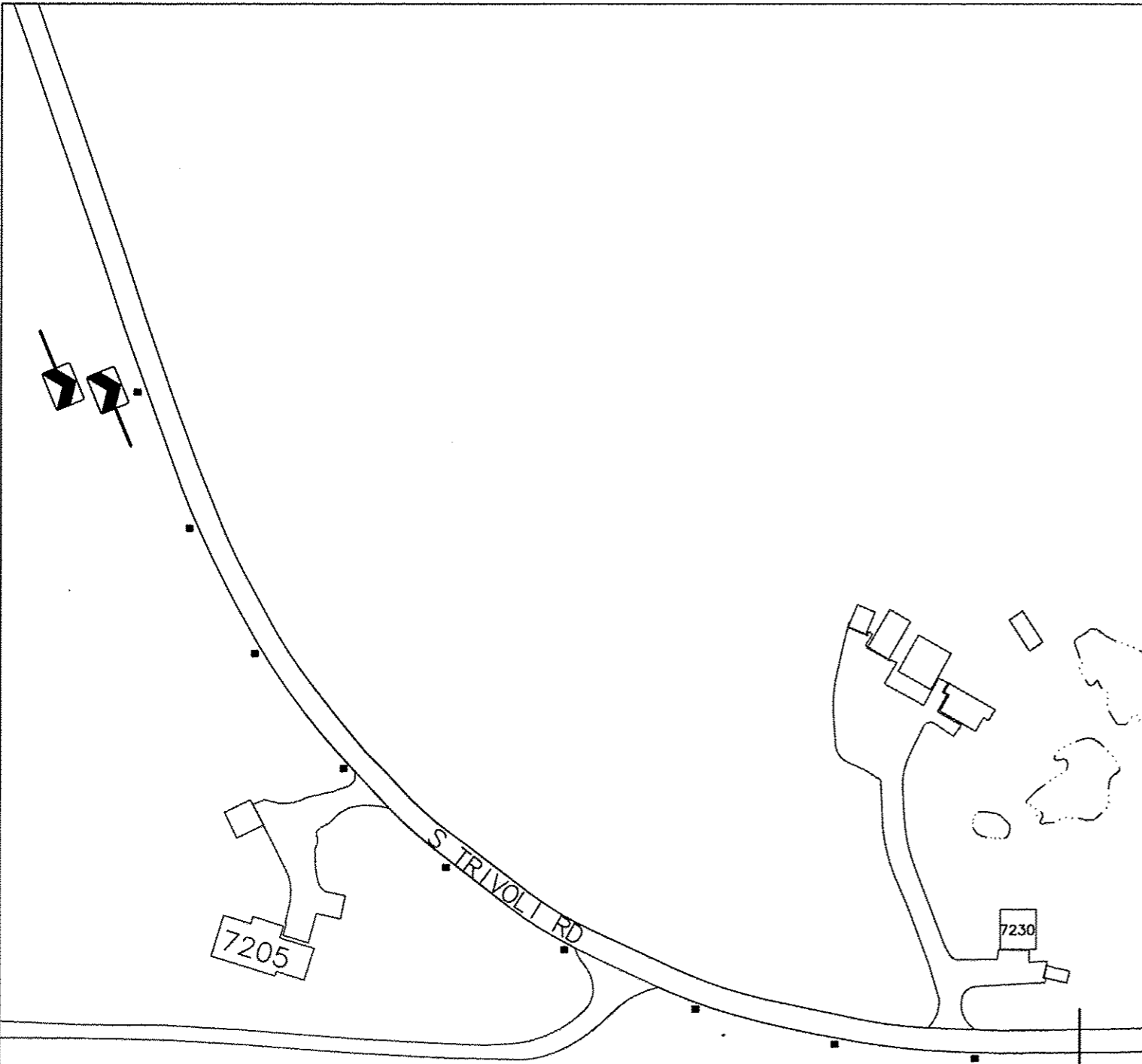

PLACE 9 CHEVRONS (W1-8)
 EACH DIRECTION THROUGH CURVE
 SPACED ON 120' CENTERS
 BEGIN DIRECTLY ACROSS FROM EAST
 EDGE OF DRIVEWAY AT 7230 TRIVOLI RD

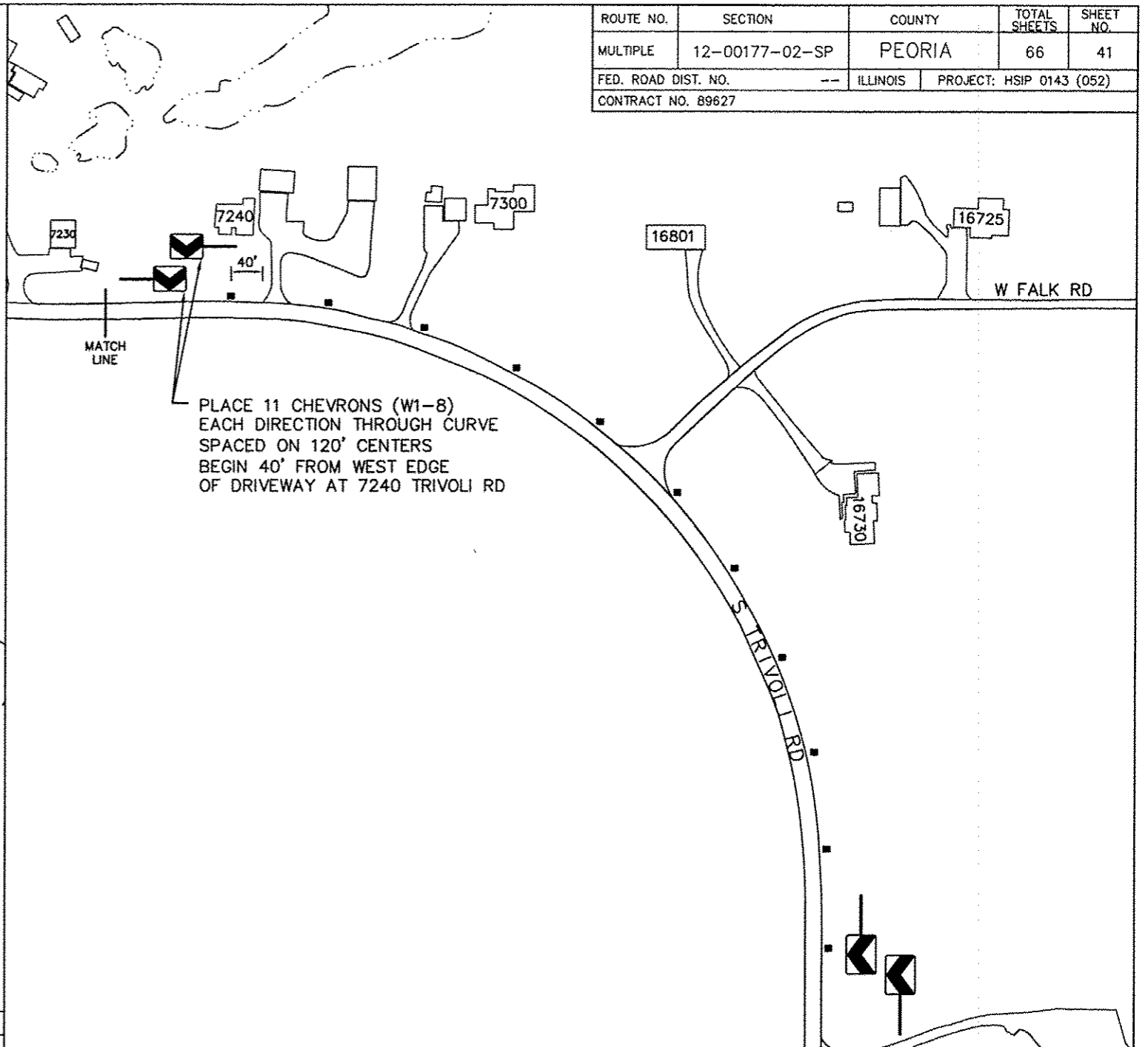
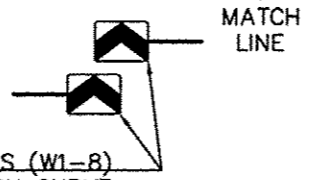

PLACE 11 CHEVRONS (W1-8)
 EACH DIRECTION THROUGH CURVE
 SPACED ON 120' CENTERS
 BEGIN 40' FROM WEST EDGE
 OF DRIVEWAY AT 7240 TRIVOLI RD



LOCATION P-L

