

ROUTE NO.	SECTION	COUNTY	TOTAL SHEETS	SHEET NO.
MULTIPLE	12-00177-02-SP	PEORIA	66	43
FED. ROAD DIST. NO.	--	ILLINOIS	PROJECT: HSIP 0143 (052)	
CONTRACT NO. 89627				

REMOVE EXISTING W1-6R SIGN AND POST
 REPLACE WITH NEW W1-6R SIGN AND POST
 SIZE: 48"x24"
 IN SAME LOCATION



40'

W MALGREM RD

W GLASFORD-CANTON RD

105'



PLACE 7 CHEVRONS (W1-8)
 EACH DIRECTION THROUGH CURVE
 SPACED ON 40' CENTERS
 BEGIN 40' WEST OF WEST EDGE OF DRIVEWAY
 AT 17102 GLASFORD-CANTON RD
 NEW SIGN LOCATIONS SHOWN



17214

17102

17026

17020

PLACE 1 TWO-DIRECTION LARGE ARROW SIGN
 SIGN CODE: W1-7
 SIZE: 48"x24"
 LOCATED 105' WEST OF NEW CHEVRON SIGN AS SHOWN
 SIGN PANEL SHALL FACE NORTH

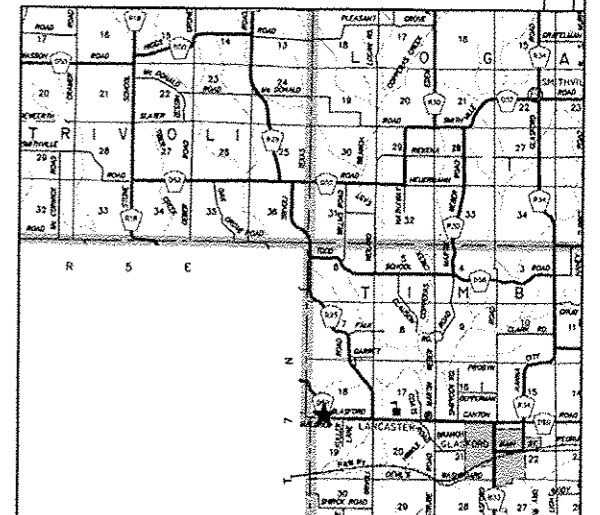

LOCATION P-N