

REMOVAL NOTES

- BRICK PAVERS THAT ARE REMOVED FOR THE REMOVAL OR INSTALLATION OF TRAFFIC SIGNAL EQUIPMENT SHALL BE CUT AS NECESSARY AND REINSTALLED AT THEIR ORIGINAL LOCATIONS UNLESS OTHERWISE DIRECTED BY THE ENGINEER. THIS WORK WILL BE INCLUDED IN THE COST OF REMOVE AND RESET BRICK PAVERS, AND NO ADDITIONAL COMPENSATION WILL BE ALLOWED.
- THE CONTRACTOR SHALL MAKE FULL DEPTH SAW CUTS AT ALL SIDEWALK REMOVAL LIMITS.
- THE REMOVAL LIMITS MAY BE ADJUSTED AS DIRECTED BY THE ENGINEER.
- THE CONTRACTOR SHALL BE RESPONSIBLE FOR REMOVING, STORING, AND RESETTING ALL SIGNS AFFECTED BY THE CONSTRUCTION, EXCEPT FOR THE MAST ARM MOUNTED STREET NAME SIGNS. THIS INCLUDES SIGNS MOUNTED ON EXISTING SIGNAL EQUIPMENT OR AT OTHER LOCATIONS SHOWN IN THE PLANS. THIS WORK WILL NOT BE PAID FOR SEPARATELY BUT SHALL BE INCLUDED IN THE COST OF THE VARIOUS REMOVAL PAY ITEMS, AND NO ADDITIONAL COMPENSATION WILL BE ALLOWED. THE MAST ARM MOUNTED STREET NAME SIGNS WILL BE REMOVED AND RESET BY OTHERS.
- EARTH EXCAVATION WILL NOT BE MEASURED FOR PAYMENT BUT SHALL BE INCLUDED IN THE COST OF THE SPECIFIC CONSTRUCTION PAY ITEM REQUIRING THE EXCAVATION, AND NO ADDITIONAL COMPENSATION WILL BE ALLOWED.
- EXISTING TREES AND OTHER LANDSCAPING SHALL NOT BE DISTURBED UNLESS OTHERWISE DIRECTED BY THE ENGINEER.
- EXISTING LIGHT POLES SHALL NOT BE DISTURBED EXCEPT AS SHOWN ON THE PLANS OR AS OTHERWISE DIRECTED BY THE ENGINEER.

THE ROADWAY AND SIDEWALK IMPROVEMENTS AT THE MAIN STREET AND RACE STREET INTERSECTION WILL BE PERFORMED UNDER A SEPARATE PROJECT ALONG MAIN STREET. THE CONTRACTOR SHALL COORDINATE THE SIDEWALK REMOVAL REQUIRED FOR THE TRAFFIC SIGNAL MODERNIZATION AT RACE STREET WITH THE SIDEWALK REMOVAL REQUIRED FOR THE MAIN STREET IMPROVEMENTS PERFORMED UNDER THE SEPARATE PROJECT AS DIRECTED BY THE ENGINEER. NO ADDITIONAL COMPENSATION WILL BE ALLOWED FOR THE COORDINATION OF REMOVAL ITEMS.

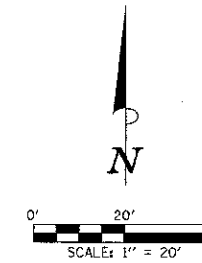

LEGEND
 X EXISTING TRAFFIC SIGNAL EQUIPMENT TO BE REMOVED

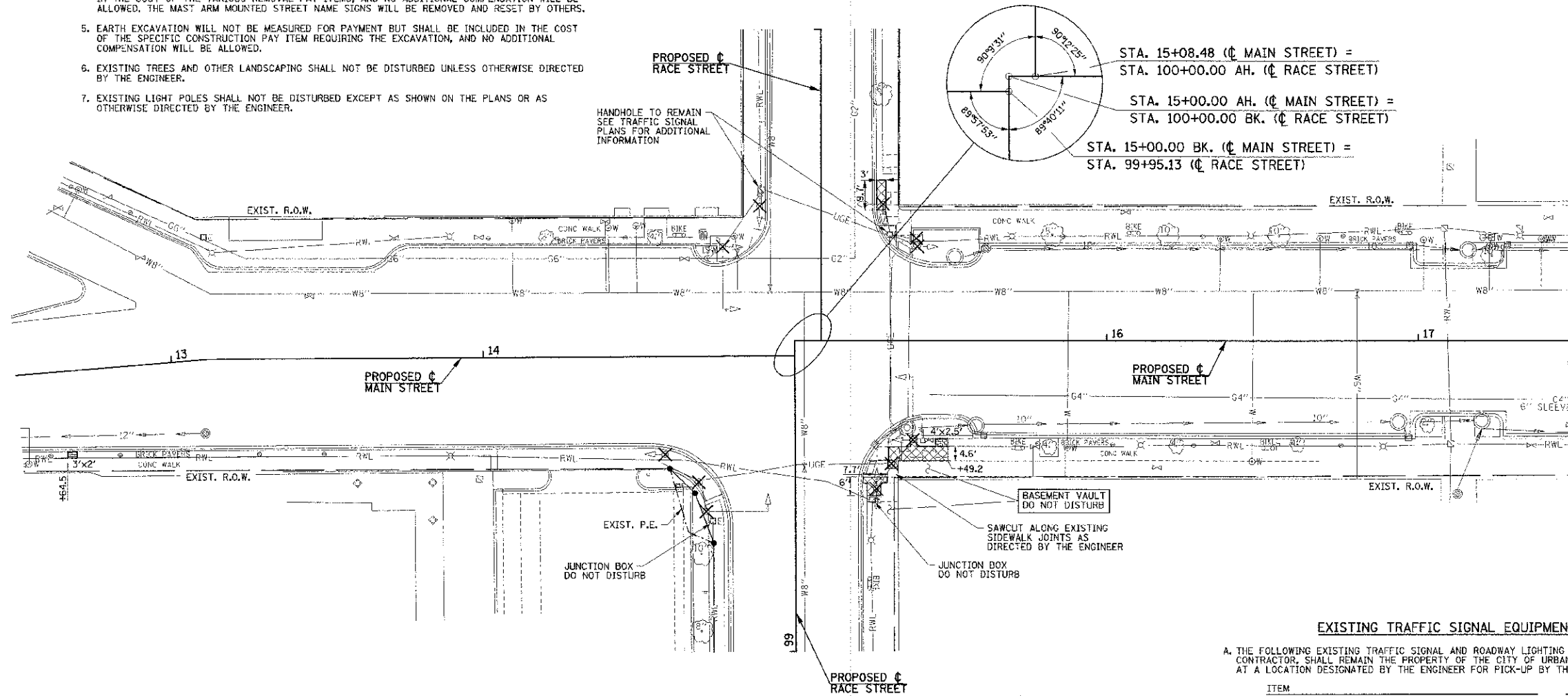

SIDEWALK REMOVAL 44000600	
LOCATION	SQ. FT.
NE CORNER MAIN AND RACE	29
SE CORNER MAIN AND RACE	135
TOTAL	164

REMOVE AND RESET BRICK PAVERS XX005565	
LOCATION	SQ. FT.
MAIN WEST OF RACE	6
SE CORNER MAIN AND RACE	10
TOTAL	16

EXISTING TRAFFIC SIGNAL EQUIPMENT TO BE REMOVED

A. THE FOLLOWING EXISTING TRAFFIC SIGNAL AND ROADWAY LIGHTING EQUIPMENT SHALL BE REMOVED BY THE CONTRACTOR, SHALL REMAIN THE PROPERTY OF THE CITY OF URBANA, AND SHALL BE MOVED TO AND STORED AT A LOCATION DESIGNATED BY THE ENGINEER FOR PICK-UP BY THE CITY'S FORCES:

ITEM	UNIT	QUANTITY
CONTROLLER IN CABINET (COMPLETED)	EACH	1
TRAFFIC SIGNAL POST	EACH	4
COMBINATION MAST ARM ASSEMBLY AND POLE	EACH	3
LIGHT POLE WITH DAVIT ARM	EACH	1
TRAFFIC SIGNAL BACKPLATE	EACH	3
SIGNAL HEAD	EACH	12
PEDESTRIAN SIGNAL HEAD	EACH	8

THIS WORK SHALL BE INCLUDED IN THE CONTRACT LUMP SUM PRICE FOR REMOVE EXISTING TRAFFIC SIGNAL EQUIPMENT, SPECIAL REMOVAL OF INDIVIDUAL ITEMS WILL NOT BE PAID FOR SEPARATELY.

B. THE CONTRACTOR SHALL REMOVE THE FOLLOWING EXISTING TRAFFIC SIGNAL AND ROADWAY LIGHTING ITEMS AND DISPOSE OF THEM IN ACCORDANCE WITH THE CONTRACT DOCUMENTS:

ITEM	UNIT	QUANTITY
HANDHOLE	EACH	2
CONCRETE FOUNDATION	EACH	9

THIS WORK WILL BE PAID FOR AT THE CONTRACT UNIT PRICE EACH FOR REMOVE EXISTING HANDHOLE AND REMOVE EXISTING CONCRETE FOUNDATION.

C. THE CONTRACTOR SHALL REMOVE THE EXISTING ELECTRIC CABLES AS SHOWN ON THE TRAFFIC SIGNAL PLANS AND AS DIRECTED BY THE ENGINEER. THE CONTRACTOR SHALL DISPOSE OF THE ELECTRIC CABLES IN ACCORDANCE WITH THE CONTRACT DOCUMENTS. CABLES THAT ARE REMOVED SHALL NOT BE REUSED; THE REMAINING CABLES AT THE INTERSECTION SHALL BE ABANDONED IN PLACE UNLESS OTHERWISE DIRECTED BY THE ENGINEER. THIS WORK SHALL BE INCLUDED IN THE CONTRACT LUMP SUM PRICE FOR REMOVE EXISTING TRAFFIC SIGNAL EQUIPMENT, SPECIAL, AND NO ADDITIONAL COMPENSATION WILL BE ALLOWED. REMOVAL OF INDIVIDUAL CABLES WILL NOT BE PAID FOR SEPARATELY.

D. REFER TO THE TRAFFIC SIGNAL PLANS FOR ADDITIONAL INFORMATION.

FILE NAME = p:\00970061_Urbana - Main Street HSIP\Plans\sheet\06 removal.dgn PLOT DATE = 1/15/2013 9:08:18 PM	DESIGNED - JAJ DRAWN - KLR CHECKED - SMW DATE - 01/2013 REVISED - REVISED - REVISED - REVISED -	STATE OF ILLINOIS DEPARTMENT OF TRANSPORTATION	REMOVAL PLANS SCALE: 1"=20' SHEET NO. 6 OF 12 SHEETS STA. TO STA.	COUNTY: CHAMPAIGN SECTION: 11-00510-00-TL MAIN STREET CONTRACT NO. 91481 ILLINOIS FED. AID PROJECT
--	--	---	---	--