

SCALE: 1"=40'-0"

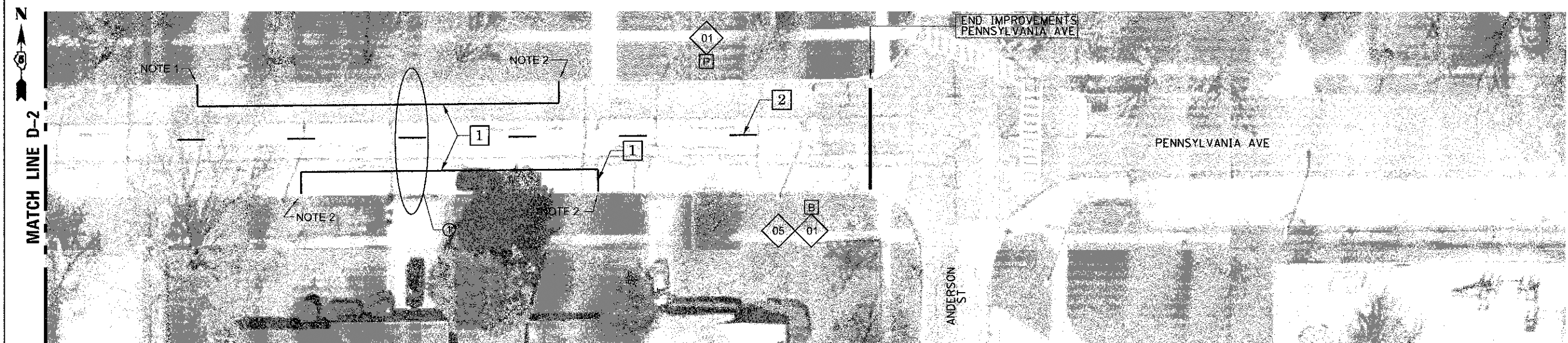

NOTE 1: THE 4" WHITE PAVEMENT MARKING LINE TERMINATES AT THE LIMIT OF THE YELLOW PAINTED CURB.
 NOTE 2: THE 4" WHITE PAVEMENT MARKING LINE TERMINATES AT THE "NO PARKING HERE TO CORNER" SIGNS

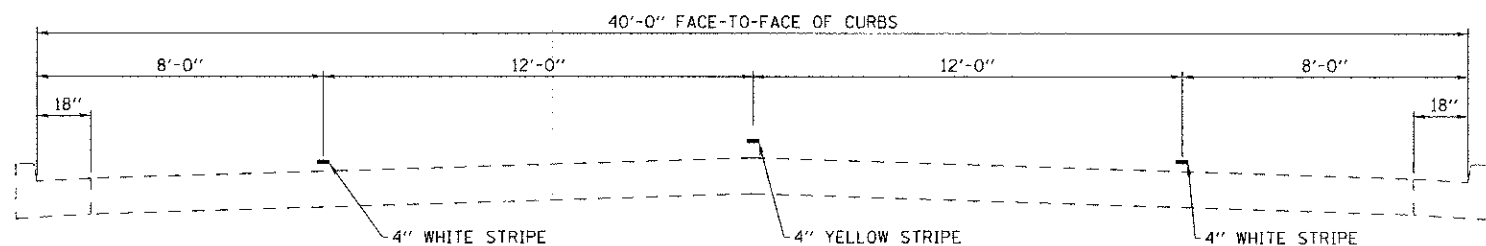

① TYPICAL FOR PAVEMENT MARKING PENNSYLVANIA AVENUE
 VINE STREET TO ANDERSON STREET

SIGN LEGEND					
01	BIKE ROUTE (D11-1)		06	BIKE ROUTE ARROW RIGHT (M6-1)	
02	BIKE LANE (R3-17)		07	BIKE ROUTE ARROW LEFT (M6-1)	
03	MAY USE FULL LANE (R4-11)		08	BIKE ROUTE ARROW AHEAD (M6-3)	
04	NO PARKING THIS SIDE OF STREET		09	AHEAD (R3-17aP)	
05	BIKE ROUTE ARROW LEFT AND RIGHT (M6-4)		10	ENDS (R3-17bP)	

② 4" SKIP-DASH YELLOW
 ⑥ 4" DOUBLE YELLOW

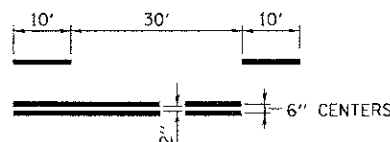

PAVEMENT MARKING LEGEND	
①	4" WHITE
②	4" YELLOW
③	6" WHITE
④	12" YELLOW
⑤	12" WHITE
⑥	4" DOUBLE YELLOW

PRINT NUMBER: 1100 F.D. 84-A
 PENNSYLVANIA DEPARTMENT OF TRANSPORTATION
 FILE NAME: 12-00517-00-S1-20-01-01.DWG



USER NAME	has	DESIGNED	JMS	REVISED	-
ESCA PROJECT NO.	1020.04	DRAWN	RJT/HAS	REVISED	-
PLOT SCALE	0.0833 1/12 IN.	CHECKED	JMS	REVISED	-
PLOT DATE	1/30/2013 2:15:05 PM	DATE	01/29/13	REVISED	-

STATE OF ILLINOIS
 DEPARTMENT OF TRANSPORTATION

PENNSYLVANIA AVENUE PAVEMENT MARKING

SCALE AS SHOWN SHEET NO. 2 OF 2 SHEETS STA. TO STA.

F.A. RTE.	SECTION	COUNTY	TOTAL SHEETS	SHEET NO.
VAR	12-00517-00-S1	CHAMPAIGN	22	20
CONTRACT NO. 91482				
FED. ROAD DIST. NO. ILLINOIS FED. AID PROJECT AID				