

Ex ROW 55.52'R

Ex ROW 55.46'R

Ex ROW 55.42'R

Ex ROW 55.42'R

Ex ROW 55.37'R

Ex ROW 55.33'R

Ex ROW 55.29'R

PROJECT NO. RS-1600(120)

COUNTY	ROUTE	SECTION	SHT. NO.
ADAMS	RS 1600	11-0007B-02-BR	5
STA. 343+75 TO STA. 345+00			93598

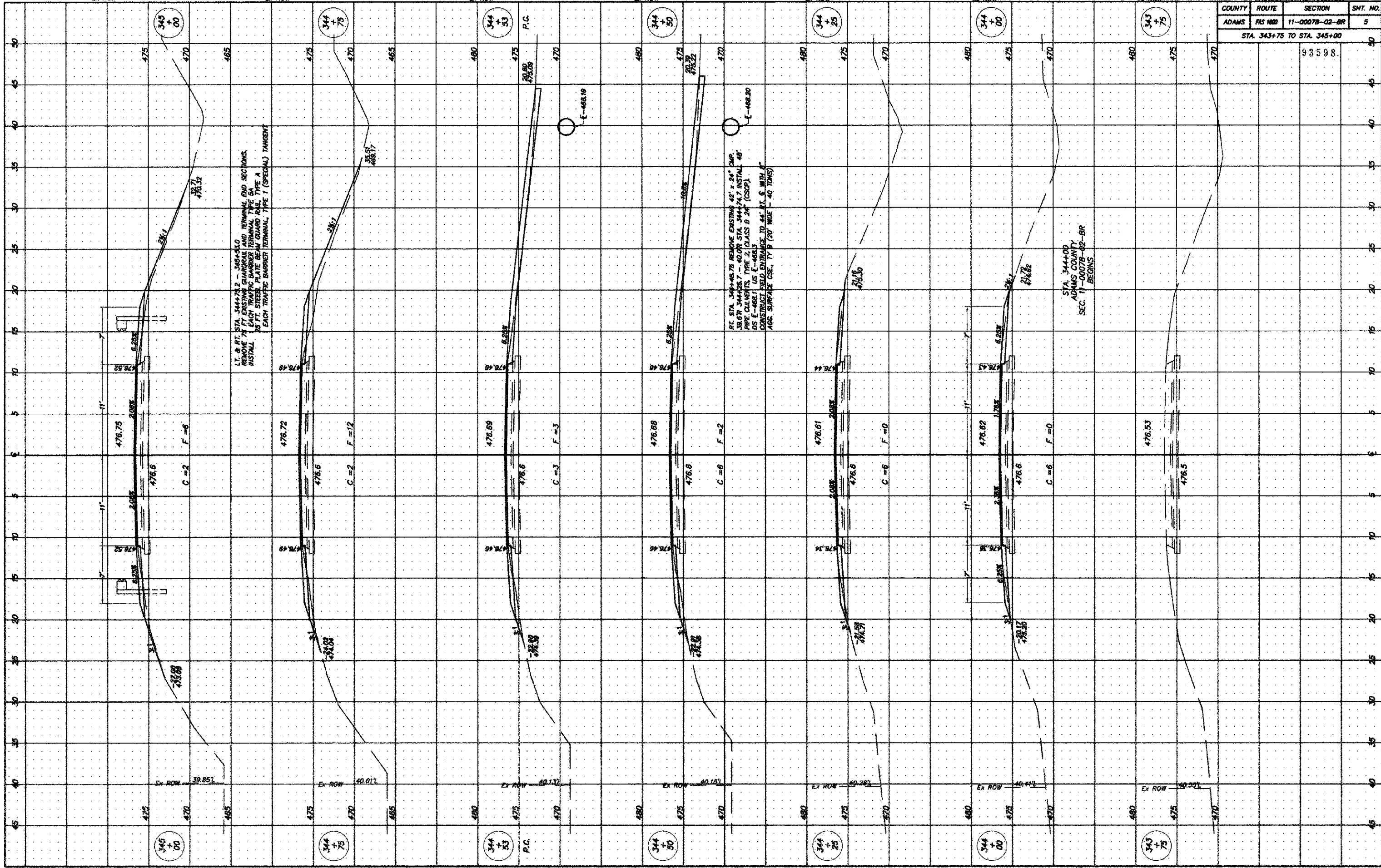

L.L. & R.T. STA. 344+75.2 - 349+31.0
 REMOVE 78 FT EXISTING GUARDRAIL AND TERMINAL END SECTIONS
 EACH TRAFFIC BARRIER TERMINAL TYPE SA
 INSTALL 2 FT. TRAFFIC BARRIER TERMINAL TYPE A
 EACH TRAFFIC BARRIER TERMINAL TYPE T (SPECIAL) TANGENT

AT STA. 344+88.75 REMOVE EXISTING 42" x 24" CMP
 36" OR 34" DIA. 40' OR STA. 344+77.77 INSTALL 48"
 PIPE CULVERTS, TYPE 2, CLASS D 24" (CSOP).
 OS E-4661 US. C-4661
 CONSTRUCT FIELD ENTRANCES TO 44' BT. 6' WITH 2"
 AGG. SURFACE CSE, 17' B (20' WIDE - 40 TONS)

STA. 344+00
 ADAMS COUNTY
 SEC. 11-0007B-02-BR
 BEGINS

345 + 00

344 + 75

344 + 53 P.C.

344 + 50

344 + 25

344 + 00

343 + 75

Ex ROW 59.85'

Ex ROW 60.01'

Ex ROW 60.17'

Ex ROW 60.13'

Ex ROW 59.38'

Ex ROW 59.44'

Ex ROW 59.30'

