

|           |               |           |              |           |
|-----------|---------------|-----------|--------------|-----------|
| ROUTE NO. | SECTION       | COUNTY    | TOTAL SHEETS | SHEET NO. |
| F.A.U. 45 | 10-00014-00-B | JOHNSON   | 13           | 03        |
| ILLINOIS  |               | BIKE PATH |              |           |

CONTRACT NO. 99482

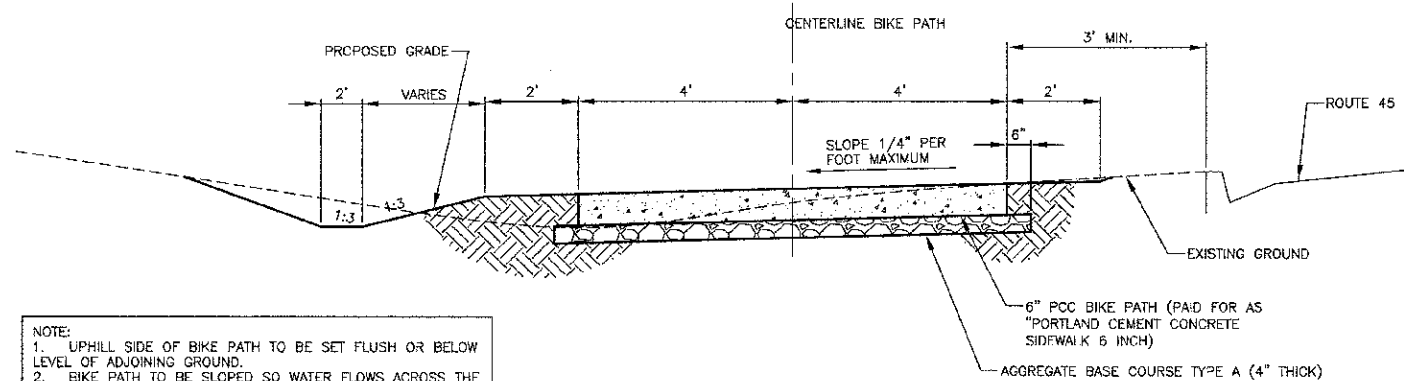

NOTE:  
 1. UPHILL SIDE OF BIKE PATH TO BE SET FLUSH OR BELOW LEVEL OF ADJOINING GROUND.  
 2. BIKE PATH TO BE SLOPED SO WATER FLOWS ACROSS THE PATH IN THE NATURAL DIRECTION OF FLOW.  
 3. DITCH, IF REQUIRED, TO BE ON DOWNHILL SIDE OF BIKE PATH, EXCEPT AS SHOWN ON CROSS SECTIONS.  
 4. BIKE PATH TO BE CONSTRUCTED ACCORDING TO THE PROVISIONS OF ARTICLE 424 OF THE STANDARD SPECIFICATIONS, EXCEPT THE CONCRETE SHALL BE GROOVED TO PRODUCE SLABS NO MORE THAN 8 FEET ON ANY SIDE.

**TYPICAL SECTION OF BIKE PATH**  
 NOT TO SCALE

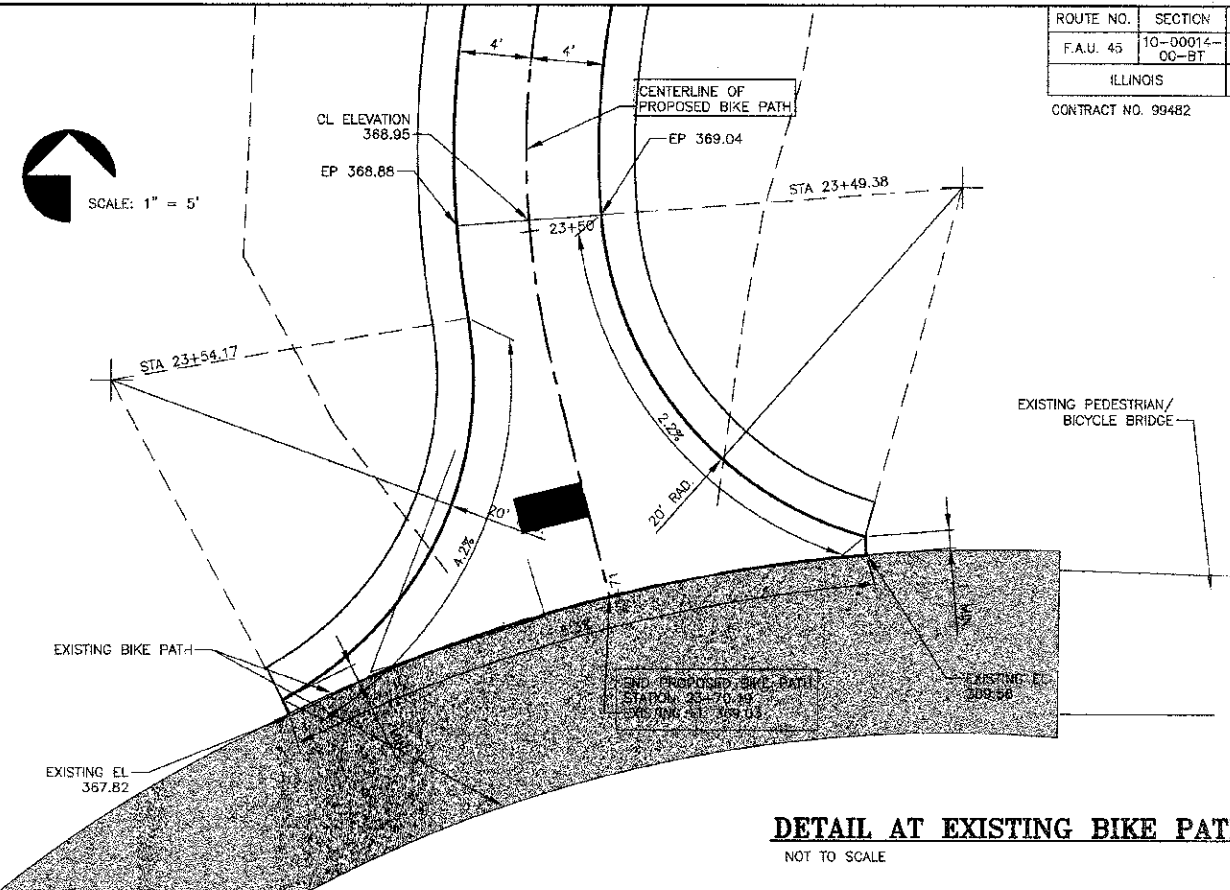

**DETAIL AT EXISTING BIKE PATH**  
 NOT TO SCALE

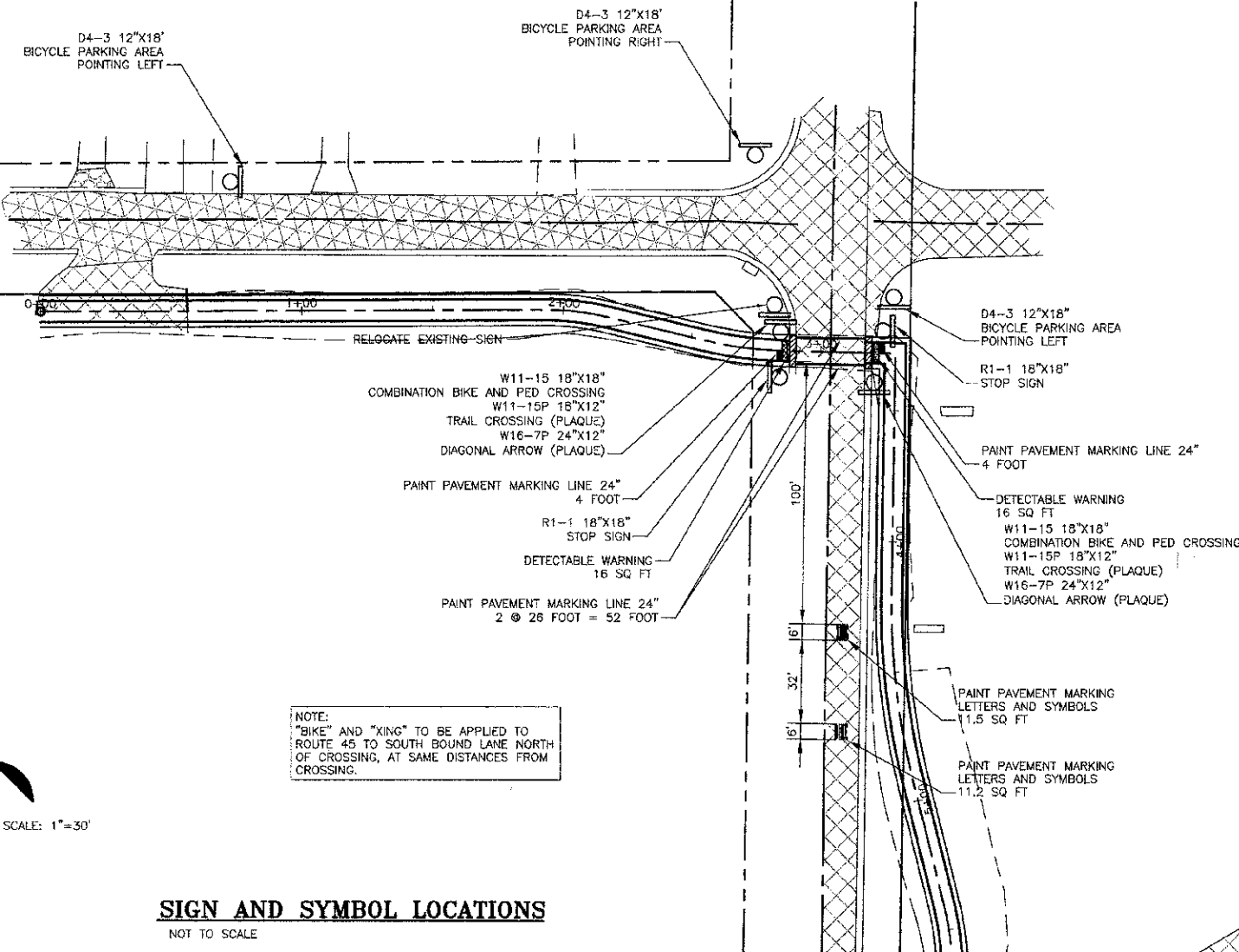

NOTE:  
 "BIKE" AND "KING" TO BE APPLIED TO ROUTE 45 TO SOUTH BOUND LANE NORTH OF CROSSING, AT SAME DISTANCES FROM CROSSING.



**SIGN AND SYMBOL LOCATIONS**  
 NOT TO SCALE

**SCHEDULE OF PROPOSED SIGNS**

| LOCATION | DESCRIPTION                     | SIGN PANEL TYPE 1 | SQ. FT. | METAL POST TYPE B |
|----------|---------------------------------|-------------------|---------|-------------------|
| 0+73 LT  | BIKE PARKING AREA 12'X18"       | D4-3              | 1.5     | 12'               |
| 1+85 LT  | COMB. BIKE & PED XING - 18'X18" | W11-15            | 2.25    | 14'               |
|          | TRAIL CROSSING (PLAQUE) 18'X12" | W11-15P           | 1.5     |                   |
|          | DIAGONAL ARROW (PLAQUE) 24'X12" | W16-7P            | 2.0     |                   |
| 1+85 RT  | STOP SIGN 30" X 30"             | R1-1              | 6.25    | 12'               |
| 2+62 LT  | BIKE PARKING AREA 12'X18"       | D4-3              | 1.5     | 12'               |
| 2+62 LT  | STOP SIGN 30" X 30"             | R1-1              | 6.25    | 12'               |
| 3+20 LT  | BIKE PARKING AREA 12'X18"       | D4-3              | 1.5     | 12'               |
| 3+40 RT  | COMB. BIKE & PED XING - 18'X18" | W11-15            | 2.25    | 14'               |
|          | TRAIL CROSSING (PLAQUE) 18'X12" | W11-15P           | 1.5     |                   |
|          | DIAGONAL ARROW (PLAQUE) 24'X12" | W16-7P            | 2.0     |                   |
| 3+73 RT  | BIKE WARNING SIGN 30" X 30"     | W11-1             | 6.25    | 12'               |
| 6+31 LT  | BIKE WARNING SIGN 30" X 30"     | W11-1             | 6.25    | 12'               |
| 6+43 LT  | COMB. BIKE & PED XING - 18'X18" | W11-15            | 2.25    | 14'               |
|          | TRAIL CROSSING (PLAQUE) 18'X12" | W11-15P           | 1.5     |                   |
|          | DIAGONAL ARROW (PLAQUE) 24'X12" | W16-7P            | 2.0     |                   |
| 6+51 RT  | STOP SIGN 30" X 30"             | R1-1              | 6.25    | 12'               |
| 6+77 RT  | BIKE WARNING SIGN 30" X 30"     | W11-1             | 6.25    | 12'               |
| 6+79 RT  | COMB. BIKE & PED XING - 18'X18" | W11-15            | 2.25    | 14'               |
|          | TRAIL CROSSING (PLAQUE) 18'X12" | W11-15P           | 1.5     |                   |
|          | DIAGONAL ARROW (PLAQUE) 24'X12" | W16-7P            | 2.0     |                   |
| 6+81 LT  | STOP SIGN 30" X 30"             | R1-1              | 6.25    | 12'               |
| 12+33 RT | STOP SIGN 30" X 30"             | R1-1              | 6.25    | 12'               |
| 12+69 LT | COMB. BIKE & PED XING - 18'X18" | W11-15            | 2.25    | 14'               |
|          | TRAIL CROSSING (PLAQUE) 18'X12" | W11-15P           | 1.5     |                   |
|          | DIAGONAL ARROW (PLAQUE) 24'X12" | W16-7P            | 2.0     |                   |
| 13+00 LT | COMB. BIKE & PED XING - 18'X18" | W11-15            | 2.25    | 14'               |
|          | TRAIL CROSSING (PLAQUE) 18'X12" | W11-15P           | 1.5     |                   |
|          | DIAGONAL ARROW (PLAQUE) 24'X12" | W16-7P            | 2.0     |                   |
| 13+00 RT | COMB. BIKE & PED XING - 18'X18" | W11-15            | 2.25    | 14'               |
|          | TRAIL CROSSING (PLAQUE) 18'X12" | W11-15P           | 1.5     |                   |
|          | DIAGONAL ARROW (PLAQUE) 24'X12" | W16-7P            | 2.0     |                   |
| 13+43 LT | STOP SIGN 30" X 30"             | R1-1              | 6.25    | 12'               |
| 23+66 RT | STOP SIGN 30" X 30"             | R1-1              | 6.25    | 12'               |

**SCHEDULE OF SYMBOLS AND LETTERS**

| LOCATION | DESCRIPTION | PAINT SQ. FT. |
|----------|-------------|---------------|
| 2+97 LT  | "BIKE"      | 11.2          |
| 2+97 LT  | "KING"      | 11.5          |
| 3+11 RT  | "BIKE"      | 11.2          |
| 3+11 RT  | "KING"      | 11.5          |
| 6+65 LT  | "BIKE"      | 11.2          |
| 6+65 LT  | "KING"      | 11.5          |

STATE OF ILLINOIS PROFESSIONAL DESIGN FIRM LICENSE NO. 184-004515

© 2012 ALL RIGHTS RESERVED.

**CLARIDA & ZIEGLER ENGINEERING CO.**  
 410 North Court St, P.O. Box 357  
 Marion, Illinois 62959  
 Phone - (618)993-6411, Fax - (618)993-6750

TYPICAL SECTIONS AND DETAILS  
 VIENNA BICYCLE/PEDESTRIAN PATH  
 VIENNA, ILLINOIS

| REVISIONS | DATE | NO. |
|-----------|------|-----|
|           |      |     |
|           |      |     |
|           |      |     |
|           |      |     |

Date: 3/30/12 DR. By: TW CK'D By: WGBZ  
 Scale: NONE Job No. 10095 Sheet No. 3 of 13