

VE048

REVISIONS		
NUMBER	BY	DATE

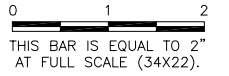

VERMILION REGIONAL AIRPORT
VERMILION REGIONAL AIRPORT AUTHORITY
DANVILLE, ILLINOIS
RELOCATE TAXIWAY C AND WIDEN FILLETS & CONSTRUCTION ACTIVITY PLAN NOTES & DETAILS

© Copyright CMT, Inc.
CMT
 CRAWFORD, MURPHY & TILLY, INC.
 CONSULTING ENGINEERS
 License No. 184-000613

DESIGN BY:	AJB
DRAWN BY:	CMT
CHECKED BY:	CET
APPROVED BY:	CET
DATE:	MARCH 1, 2013
JOB No:	120420100
IL PROJ. NO.	DNV-4229
SBG PROJ. NO.	3-17-0032-B14
SHEET	5A OF 27 SHEETS

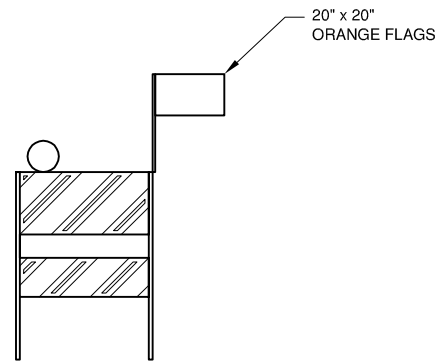

FLASHER BARRICADE DETAIL-IDOT TYPE 1
 N.T.S.

FLASHER BARRICADE NOTES

1. FLASHERS TO BE BATTERY OPERATED. LENS TO BE RED AND BE ABLE TO ROTATE 90 DEGREES.
2. SANDBAGS TO BE PLACED ON EACH SUPPORT BRACE AS REQUIRED TO PREVENT DISPLACEMENT BY WIND, JET OR PROP BLAST.
3. NO SEPARATE PAYMENT WILL BE MADE FOR THIS ITEM. COSTS SHALL BE CONSIDERED INCIDENTAL TO THE PROJECT.
4. PLACE AT 10' INTERVALS.

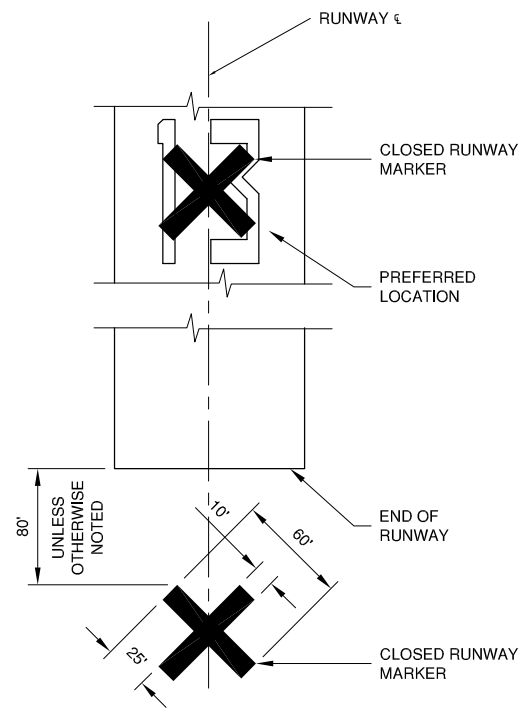

PORTABLE CLOSED RUNWAY MARKER DETAIL
 N.T.S.

PORTABLE CLOSED RUNWAY MARKER NOTES

1. THE AIRPORT WILL PROVIDE PORTABLE LIGHTED CLOSURE MARKERS FOR THE CONTRACTOR'S USE.
2. THE CONTRACTOR WILL BE REQUIRED TO TOW AND SET UP THE MARKERS AT THE ENDS OF THE RUNWAY WHEN RUNWAY CLOSURES ARE REQUIRED.
3. THE CONTRACTOR WILL BE REQUIRED TO PROVIDE REPLACEMENT BULBS, FUEL, LUBRICANTS, AND DAILY/PERIODIC MAINTENANCE INSPECTIONS AS REQUIRED BY THE AIRPORT.
4. THE AIRPORT WILL PERFORM PERIODIC MAINTENANCE, PROVIDE REPLACEMENT PARTS AND PERFORM REPAIRS AS REQUIRED TO KEEP THE EQUIPMENT OPERATIONAL.
5. THE COST OF SET-UP, FUELING, BULBS, INSPECTION, AND REMOVAL OF THE MARKERS SHALL BE INCIDENTAL TO THE CONTRACT.
6. MARKERS SHALL BE PLACED OVER EXISTING RUNWAY NUMERALS. HOWEVER, WHEN WORK IS NECESSARY FOR THAT AREA OR PAVEMENT IS OPEN TO TAXIING AIRCRAFT, THE MARKERS SHALL BE RELOCATED OFF THE PAVEMENT AS SHOWN ON THE DETAIL.
7. UPON COMPLETION OF THE RUNWAY CLOSURE, THE CONTRACTOR WILL BE REQUIRED TO TAKE DOWN & RETURN THE MARKERS TO THEIR STORAGE LOCATION.

GENERAL NOTES

1. ALL CONSTRUCTION BARRICADES SHALL BE IN PLACE PRIOR TO INITIATING EACH PHASE.
2. THE CONTRACTOR SHALL GIVE THE AIRPORT A MINIMUM 7 DAYS NOTIFICATION PRIOR TO THE INITIATION OF WORK IN EACH PHASE.
3. THE CONTRACTOR SHALL MAINTAIN ALL MINIMUM DISTANCES SHOWN IN THE CONSTRUCTION ACTIVITY PLANS OR AS REQUIRED FOR THE CRITICAL OPERATING AIRCRAFT THROUGH THESE AREAS.
4. ALL COSTS TO FURNISH, INSTALL, AND MAINTAIN THE CONSTRUCTION SET BACK LINE SHALL BE CONSIDERED INCIDENTAL TO THE PROJECT AND WILL NOT BE MEASURED FOR PAYMENT.
5. ALL PAVEMENTS OR TURF AREAS UTILIZED BY THE CONTRACTOR FOR AN ACCESS ROUTE, STAGING, OR STORAGE SHALL BE REPAIRED AND RESTORED TO THEIR ORIGINAL CONDITION TO THE SATISFACTION OF THE AIRPORT. NO ADDITIONAL COMPENSATION TO PROTECT, REPAIR, OR RESTORE THESE AREAS SHALL BE MADE.

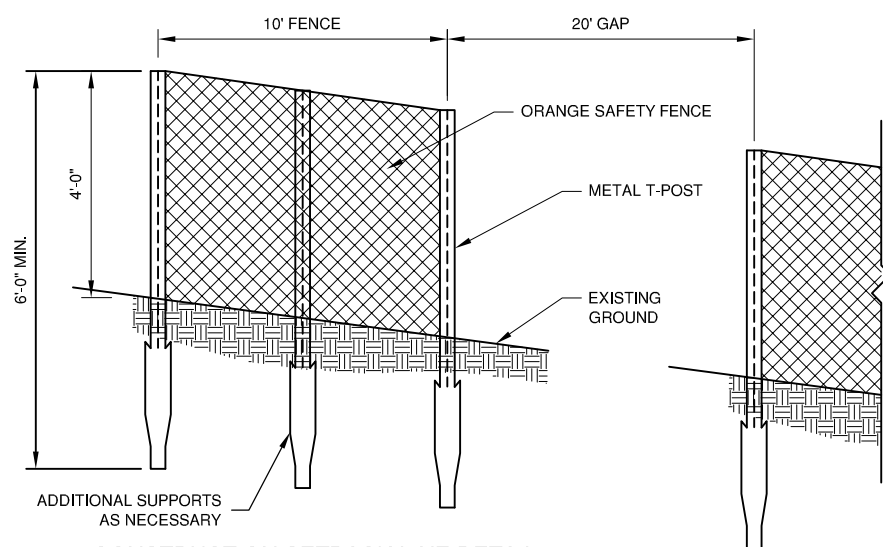

CONSTRUCTION SETBACK LINE DETAIL
 N.T.S.

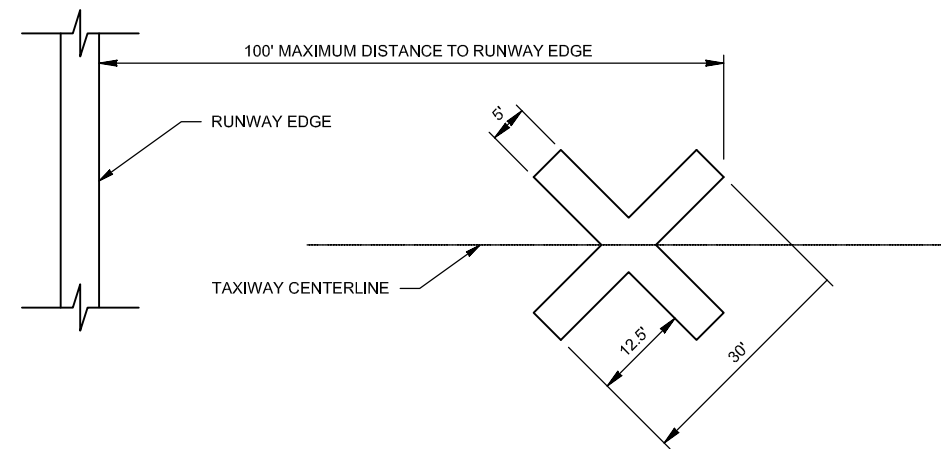

TYPICAL TAXIWAY CLOSURE MARKER DETAIL
 N.T.S.

NOTES

- 1.) THE MARKING SHALL BE PAINTED WITH TEMPORARY MARKING CAPABLE OF BEING REMOVED WITH LOW PRESSURE WATER BLASTING, OR OTHER MATERIAL THAT DOES NOT VIOLATE THE OFA CRITERIA AND ARE APPROVED BY THE AIRPORT
- 2.) PLACE OVER TAXIWAY CENTERLINE.
- 3.) YELLOW X SHALL BE ADEQUATELY SECURED TO WITHSTAND JET BLAST OF 100 MPH WINDS.