

GENERAL NOTES

1. THE CONTRACTOR SHALL TAKE NECESSARY PRECAUTIONS TO INSURE THAT NO DEBRIS WILL ENDANGER OR INTERFERE WITH TRAFFIC ON THE ROADWAY BENEATH THE BRIDGE ACCORDING TO ARTICLE 107.09 OF THE STANDARD SPECIFICATIONS. THIS WORK WILL NOT BE PAID FOR SEPARATELY, BUT SHALL BE INCLUDED IN THE CONTRACT UNIT PRICE FOR THE APPROPRIATE PAY ITEM INVOLVED AND NO ADDITIONAL COMPENSATION WILL BE ALLOWED.

2. CONCRETE SUPERSTRUCTURE SHALL HAVE A SEVEN DAY MINIMUM CURE.

3. EXISTING REINFORCEMENT BARS EXTENDING INTO THE REMOVAL AREA SHALL BE CLEANED, STRAIGHTENED AND INCORPORATED INTO THE NEW CONSTRUCTION. ANY REINFORCEMENT BARS THAT ARE DAMAGED DURING CONCRETE REMOVAL SHALL BE REPLACED WITH AN APPROVED BAR SPLICER OR ANCHORAGE SYSTEM. COST INCLUDED WITH CONCRETE REMOVAL.

4. PLAN DIMENTIONS AND DETAILS RELATIVE TO EXISTING PLANS ARE SUBJECT TO ROUTINE VARIATIONS. THE CONTRACTOR SHALL FIELD VERIFY EXISTING DIMENTIONS AND DETAILS AFFECTING NEW CONSTRUCTION AND MAKE NECESSARY APPROVED ADJUSTMENT PRIOR TO CONSTRUCTION OR ORDERING OF MATERIALS. SUCH VARIATIONS SHALL NOT BE CAUSE FOR ADDITIONAL COMPENSATION FOR A CHANGE IN SCOPE OF THE WORK, HOWEVER, THE CONTRACTOR WILL BE PAID FOR THE QUANTITY ACTUALLY FURNISHED BASED UPON THE UNIT PRICE BID FOR THE WORK.

5. REINFORCEMENT BARS DESIGNATED (E) SHALL BE EPOXY COATED.

6. JOINTS ARE TO BE INSTALLED TO MATCH EXISTING.

7. IF A GAP IN THE PARAPET IS TO OCCUR FOR ANY PERIOD OF TIME, A TEMPORARY RAILING MUST BE INSTALLED SO THAT AT NO TIME SHALL THERE BE AN OPENING IN ANY PORTION OF THE EXISTING SYSTEM. IF THE GAP IS IN A BARRIER WALL SECTION, TEMPORARY RAILING OR BARRELS SHALL BE USED AT THE DISCRETION OF THE ENGINEER.

8. THE CONTRACTOR SHALL SALVAGE AND RETURN THE EXISTING GUARDRAIL TO:
DISTRICT BRIDGE OFFICE
1101 BIESTERFIELD RD.
ELK GROVE VILLAGE, IL 60007
CONTACT 847-956-1444-1445

9. THIS WORK SHALL INCLUDE REMOVING, TRANSPORTING AND UNLOADING THE EXISTING CARRIER GUARDRAIL TO THE ABOVE YARD WHICH COST IS INCLUDED IN THE COST OF "CONCRETE REMOVAL".

10. THE CONTRACTOR SHALL SALVAGE AND RETURN THE EXISTING TEMPORARY BARRIER AND TEMPORARY IMPACT ATTENUATOR TO DAN RYAN MAINTENANCE YARD AT:
DAN RYAN MAINTENANCE YARD
6543 S WENTWORTH ST.
CHICAGO, IL 60621

11. PLEASE COORDINATE WITH KEN BRANTLEY, YARD TECHNICIAN AT 773-873-3466-3467 DELIVERY BETWEEN THE HOURS OF 8 AM AND 2 PM CONTACT; MR. KENNETH BRANTLEY AT 773-873-3466.

12. BEFORE STARTING ANY EXCAVATION, THE CONTRACTOR SHALL CALL "J.U.L.I.E." AT (800) 892-0123 OR 811 FOR FIELD LOCATIONS OF BURIED ELECTRIC, TELEPHONE AND GAS UTILITIES. 48 HOUR NOTIFICATION IS REQUIRED.

13. BEFORE STARTING ANY EXCAVATION, THE CONTRACTOR SHALL CALL "C.U.A.N." (CHICAGO UTILITY ALERT NETWORK) AT (312)744-7000 FOR FIELD LOCATIONS OF BURIED ELECTRIC, TELEPHONE AND GAS UTILITIES. (48 HOUR NOTIFICATION IS REQUIRED).

14. THE CONTRACTOR SHALL COORDINATE CONSTRUCTION ACTIVITIES WITH UTILITY COMPANIES, THE CITIES OF CHICAGO, ELMHURST, NORTHLAKE, WAUKEGAN, & ZION, AND THE VILLAGES OF LANSING, HILLSIDE, WILLOWBROOK, HINSDALE, VILLAPARK, ADDISON, & ELK GROVE.

15. THE CONTRACTOR WILL NOT BE ALLOWED TO SET UP A YARD OR FIELD OFFICE ON STATE PROPERTY WITHOUT WRITTEN PERMISSION FROM THE DEPARTMENT.

16. IT SHALL BE THE CONTRACTOR'S RESPONSIBILITY TO VERIFY ALL DIMENSIONS AND CONDITIONS EXISTING IN THE FIELD PRIOR TO CONSTRUCTION AND ORDERING OF MATERIALS.

17. THE CONTRACTOR SHALL CONTACT THE DISTRICT ONE TRAFFIC CONTROL SUPERVISOR AT: KALPANA.KANNAN-HOSADURGO@ILLINOIS.GOV (FOR ARTERIALS) AND (847)705-4151 (FOR EXPRESSWAYS) A MINIMUM OF 72 HOURS IN ADVANCE OF BEGINNING WORK.

18. THESE PLANS HAVE BEEN PREPARED FROM NOTES RECEIVED FROM THE BUREAU OF MAINTENANCE.

19. THE CONTRACTOR SHALL BE REQUIRED TO PROVIDE ACCESS TO ABUTTING PROPERTY AT ALL TIMES DURING THE CONSTRUCTION OF THIS PROJECT.

20. DO NOT SCALE PLANS FOR CONSTRUCTION DIMENSIONS.

21. THE CONTRACTOR SHALL REQUEST AND GAIN APPROVAL FROM THE ILLINOIS DEPARTMENT OF TRANSPORTATION'S EXPRESSWAY TRAFFIC OPERATIONS ENGINEER AT "WWW.IDOTLCS.COM" TWENTY-FOUR (24) HOURS IN ADVANCE OF ALL DAILY LANE, RAMP AND SHOULDER CLOSURES AND 7 DAYS IN ADVANCE OF ALL PERMANENT AND WEEKEND CLOSURES ON ALL FREEWAYS AND/OR EXPRESSWAYS IN DISTRICT ONE. THIS ADVANCE NOTIFICATION IS CALCULATED BASED ON WORKWEEK OF MONDAY THROUGH FRIDAY AND SHALL NOT INCLUDE WEEKENDS OR HOLIDAYS.

22. FOR LOCATION 16, 17 & 23: BEFORE ANY PROPOSED WORK COMMENCES THE CONTRACTOR SHALL CONTACT STATE ELECTRICAL MAINTENANCE CONTRACTOR MEADE ELECTRICAL COMPANY AT (773) 287-7672 TO COORDINATE THE EXISTING ELECTRICAL CONDUIT IN WALL. THE CONTRACTOR SHALL GIVE MEADE ELECTRICAL COMPANY AT LEAST 24-HOUR NOTICE BEFORE ANY WORK STARTS.

23. THE "ARTERIAL ROAD INFORMATION SIGN (TC-22)" IS APPLICABLE ONLY TO ARTERIAL ROADS AND SHALL NOT BE APPLIED TO EXPRESSWAYS/TOLLWAYS.

24. IT SHALL BE THE CONTRACTOR'S RESPONSIBILITY TO VERIFY ALL DIMENSIONS AND CONDITIONS EXISTING IN THE FIELD PRIOR TO CONSTRUCTION AND ORDERING OF MATERIALS.

INDEX OF SHEETS

STATE STANDARDS

SHEET NO.

DESCRIPTION

STANDARD NO.

DESCRIPTION

1.	COVER SHEET
2.	INDEX OF SHEET, STATE STANDARDS & GENERAL NOTES
3.	SUMMARY OF QUANTITIES
4.	SCHEDULE OF QUANTITIES
5.	TYPICAL REPAIR FOR FULL DEPTH BARRIER WALL
6.	TYPICAL REPAIR FOR HALF DEPTH BARRIER WALL
7.	TYPICAL BRIDGE PARAPET REPAIR DETAILS
8.	BAR SPLICER ASSEMBLY AND MECHANICAL SPLICER DETAILS
9 & 10	LOCATION 1: I-290 E.B. WEST OF MILLS RD.
11-12	LOCATION 2: I-290 W.B. 50' WEST OF WILLOW RD.
11-12	LOCATION 3: I-290 W.B. 150' WEST OF WILLOW RD.
11-12	LOCATION 4: I-290 W.B. AT INDIANA ST.
13-15	LOCATION 5: US-41 N.B. EXIT RAMP TO CLAVEY RD.
16-17	LOCATION 6: I-55 N.B. 0.25 MILES SOUTH OF CANTON FARM RD.
16-17	LOCATION 7: I-55 N.B. 0.50 MILES SOUTH OF CANTON FARM RD.
18-20	LOCATION 8: I-80 E.B. & W.B. AT WALTER ST.
18-20	LOCATION 9: 175TH ST NEAR TORRENCE AVE.
21-22	LOCATION 10: I-94 S.B. AT 166TH ST.
23	LOCATION 11: I-290 0.3 MILES EAST OF YORK ST.
24	LOCATION 12: I-55 270' NORTH OF IL-83
25	LOCATION 13: I-55 1100' SOUTH OF CLARENDON HILLS RD.
26	LOCATION 14: I-55 0.4 MILES WEST OF CASS AVE.
27	LOCATION 15: I-290 W.B. 175' EAST OF S. 9TH ST.
28	LOCATION 16: I-290 W.B. 0.25 MILES WEST OF S. KOSTNER AVE.
29	LOCATION 17: I-290 E.B. 100' WEST OF KILDARE AVE. (PED. BRIDGE)
29	LOCATION 18: I-290 E.B. APPX. 25' WEST OF KILDARE AVE. (PED. BRIDGE)
30	LOCATION 19: I-290 E.B. APPX. 225' WEST OF KEELER AVE.
31	LOCATION 20: I-290 E.B. APPX. 100' WEST OF KEELER AVE.
32	LOCATION 21: I-290 W.B. APPX. 50' EAST OF LEAVITT ST.
33	LOCATION 22: I-290 E.B. AT EXIT RAMP TO LOWER WACKER DR.
34	LOCATION 23: I-290 W.B. EXIT RAMP AT AUSTIN BLVD.
35	LOCATION 24: I-290 E.B. NEAR (US-45) MANNHEIM RD.
36	LOCATION 25: I-290 E.B. BUTTERFIELD ROAD
37	LOCATION 26: I-290 W.B. LEFT SHOULDER BEFORE I-294 ENTRANCE AFTER POLICE TURN AROUND
38	LOCATION 27: I-94 N.B. 0.1 MILES WEST OF M.L. KING DR. (I-94 W.B. RAMP TO S.B. I-57)
39	LOCATION 28: I-94 S.B. 0.1 MILES NORTH OF DOLTON AVE.
40-42	LOCATION 29 (SN 016-0836): I-90 W.B. ENTRANCE RAMP AT LAWRENCE AVE.
43-45	LOCATION 30 (SN 016-1067): I-90/94 S.B. AT 27TH STREET (EAST SIDE)
46-47	LOCATION 31 (SN 016-1114): I-90/94 N.B. LEFT SIDE 190' NORTH OF ARCHER AVE.
48-49	LOCATION 32 (SN 016-1117): I-90/94 N.B. RIGHT SIDE 315' SOUTH OF 27TH ST.
50-52	LOCATION 33 (SN 016-1118): I-90/94 N.B. LOCAL RAMP 215' SOUTH OF 27TH ST.
50-52	LOCATION 34 (SN 016-1118): I-90/94 N.B. LOCAL RAMP 260' SOUTH OF 27TH ST.
50-52	LOCATION 35 (SN 016-1118): I-90/94 N.B. LOCAL RAMP 30' NORTH OF 27TH ST.
53-55	LOCATION 36 (SN 016-1046): I-55 WB RAMP 155' EAST OF HALSTED ST.
56-58	LOCATION 37 (SN 022-0141): IL-83 S.B. OVER RAILROAD
58A-59	LOCATION 38 (SN 022-0142): IL-83 S.B. OVER IL-19
60-61	LOCATION 39 (SN 022-2006): I-55 N.B. RAMP TO N.B. I-355
62-65	LOCATION 40 (SN 049-0118): IL-137 N.B. ENTRANCE RAMP FROM MATHON DR.
66	FREEWAY ENTRANCE AND EXIT RAMP CLOSURE DETAILS (TC-08)
67	TRAFFIC CONTROL DETAILS FOR FREEWAY SINGLE AND MULTI-LANE WEAVE (TC-09)
68	TRAFFIC CONTROL AND PROTECTION FOR SIDE INTERSECTIONS AND DRIVEWAYS (TC-10)
69	TRAFFIC CONTROL DETAILS FOR FREEWAY SHOULDER CLOSURES AND PARTIAL RAMP CLOSURES (TC-17)
70	ARTERIAL ROAD INFORMATION SIGN (TC-22)

000001-07	STANDARD SYMBOLS, ABBREVIATIONS, AND PATTERNS
637006-04	CONCRETE BARRIER 42" HEIGHT
701006-05	OFF ROAD OPERATIONS, 2L, 2W, 15' to 24" FROM PAVEMENT EDGE
701011-04	OFF ROAD MOVING OPERATIONS, 2L, 2W, DAY ONLY
701106-02	OFF ROAD OPERATIONS, MULTILANE, MORE THAN 15 FT AWAY
701301-04	LANE CLOSURE, 2L, 2W, SHORT TIME OPERATIONS
701311-03	LANE CLOSURE 2L, 2W MOVING OPERATIONS - DAY ONLY
701400-09	APPROACH TO LANE CLOSURE, FREEWAY / EXPRESSWAY
701401-12	LANE CLOSURE, FREEWAY / EXPRESSWAY
701411-09	LANE CLOSURE, MULTILANE, AT ENTRANCE OR EXIT RAMP, FOR SPEEDS > 45 MPH
701421-08	LANE CLOSURE, MULTILANE, DAY OPERATIONS ONLY, FOR SPEED >45 MPH TO 55 MPH
701426-09	LANE CLOSURE, MULTILANE, INTERMITTENT OR MOVING OPERATIONS, FOR SPEEDS >45 MPH
701427-05	LANE CLOSURE, MULTILANE, INTERMITTENT OR MOVING OPERATIONS, FOR SPEEDS <40 MPH
701428-01	TRAFFIC CONTROL SETUP AND REMOVAL FREEWAY / EXPRESSWAY
701446-11	TWO LANE CLOSURE, FREEWAY/EXPRESSWAY
701501-06	URBAN LANE CLOSURE, 2L, 2W, UNDIVIDED
701601-09	URBAN LANE CLOSURE, MULTILANE, 1W OR 2W WITH NON-TRAVERSABLE MEDIAN
701606-10	URBAN LANE CLOSURE, MULTILANE, 2W WITH MOUNTABLE MEDIAN
701701-10	URBAN LANE CLOSURE MULTILANE INTERSECTION
701801-06	SIDEWALK, CORNER, OR CORSSWALK CLOSURE
701901-08	TRAFFIC CONTROL DEVICES

MODEL: Gen Notes (Sheet)
FILE NAME: c:\pwworking\hassan\116623-shr-gennote.dgn

1 REVISED SHEET 4/3/2024

USER NAME = naveed.hassan	DESIGNED -	REVISED - NH 04/01/2024
	DRAWN -	REVISED -
	CHECKED -	REVISED -
PLOT DATE = 4/1/2024	DATE -	REVISED -

STATE OF ILLINOIS
DEPARTMENT OF TRANSPORTATION

INDEX OF SHEETS, STATE STANDARDS AND GENERAL NOTES

SCALE: SHEET OF 1 SHEETS STA. TO STA.

F.A. RTE.	SECTION	COUNTY	TOTAL SHEETS	SHEET NO.
VAR	2023 VAR BARRIER/SOUND WA	VARIOUS	70	2
				CONTRACT NO. 62V18
ILLINOIS FED. AID PROJECT				

SUMMARY OF QUANTITIES			URBAN TOTAL QUANTITIES	100% STATE 0013		
Code No.	Item	Unit	Total Quantity	Quantity1	Quantity2	Quantity3
44213200	SAW CUTS	FOOT	177	177	0	0
44213202	TIE BARS 1"	EACH	256	256	0	0
50102400	CONCRETE REMOVAL	CU YD	55.44	55.44	0	0
50300225	CONCRETE STRUCTURES	CU YD	44.5	44.5	0	0
50300255	CONCRETE SUPERSTRUCTURE	CU YD	10.94	10.94	0	0
50300300	PROTECTIVE COAT	SQ YD	332	332	0	0
50800205	REINFORCEMENT BARS, EPOXY COATED	POUND	1370	1370	0	0
50800530	MECHANICAL SPLICERS	EACH	208	208	0	0
63302700	REMOVE AND REERECT TRAFFIC BARRIER TERMINALS, TYPE 6	EACH	1	1	0	0
67100100	MOBILIZATION	L SUM	1	1	0	0
70102620	TRAFFIC CONTROL AND PROTECTION, STANDARD 701501	L SUM	1	1	0	0
70102625	TRAFFIC CONTROL AND PROTECTION, STANDARD 701606	L SUM	1	1	0	0
70102630	TRAFFIC CONTROL AND PROTECTION, STANDARD 701601	L SUM	1	1	0	0
70102632	TRAFFIC CONTROL AND PROTECTION, STANDARD 701602	L SUM	1	1	0	0
70102635	TRAFFIC CONTROL AND PROTECTION, STANDARD 701701	L SUM	1	1	0	0
70102640	TRAFFIC CONTROL AND PROTECTION, STANDARD 701801	L SUM	1	1	0	0
70200100	NIGHTTIME WORK ZONE LIGHTING	L SUM	1	1	0	0
78200011	BARRIER WALL REFLECTORS, TYPE C	EACH	50	50	0	0
X0323902	CTA FENCE	FOOT	120	120	0	0
X0326791	NOISE ABATEMENT WALL REPAIRS	L SUM	1	1	0	0
X6700407	ENGINEER'S FIELD OFFICE, TYPE A (D1)	CAL MO	12	12	0	0
X7011015	TRAFFIC CONTROL AND PROTECTION (EXPRESSWAYS)	L SUM	1	1	0	0
Z0007122	REMOVING AND RE-ERECTING EXISTING RAILING	FOOT	45	45	0	0
Z0012754	STRUCTURAL REPAIR OF CONCRETE (DEPTH EQUAL TO OR LESS THAN 5 INCHES)	SQ FT	1	1	0	0

SUMMARY OF QUANTITIES			URBAN TOTAL QUANTITIES	100% STATE 0013		
Code No.	Description	Unit	Total Quantities	Quantity1	Quantity2	Quantity3
Z0030850	TEMPORARY INFORMATION SIGNING	SQ FT	205.6	205.6	0	0
Z0048665	RAILROAD PROTECTIVE LIABILITY INSURANCE	L SUM	1	1	0	0
Z0076604	TRAINEES - TRAINING PROGRAM GRADUATE	HOUR	500	500		

Ø 0042



MODEL: S0001 [Sheet]
 FILE NAME: P:\Roadway\Projects\2023\230001\Drawings\DOT\Office\Drawings\1.ORD\Project\118629\CA\Sheet\CA_S0001.dgn

USER NAME = navsed.hassan	DESIGNED -	REVISED -
PLOT SCALE = 0.16666633' / in.	DRAWN -	REVISED -
PLOT DATE = 2/15/2024	CHECKED -	REVISED -
	DATE -	REVISED -

**STATE OF ILLINOIS
DEPARTMENT OF TRANSPORTATION**

SUMMARY OF QUANTITIES	
SCALE:	SHEET OF SHEETS STA. TO STA.

F.A. RTE.	SECTION	COUNTY	TOTAL SHEETS	SHEET NO.
VAR	2023 VAR BARRIER/SOUND WA	VARIOUS	70	3
CONTRACT NO. 62V18				
ILLINOIS FED. AID PROJECT				

REVISD SHEET 4/3/2024

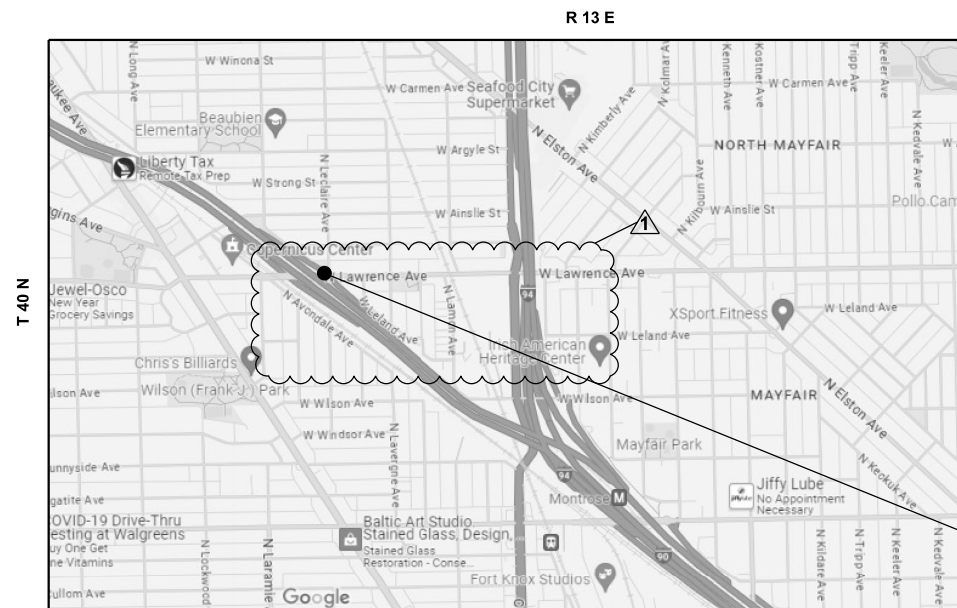

TRAFFIC DATA
 I-90
 2022 ADT = 135400
 SPEED LIMIT = 55 MPH

LOCATION 29
 I-90 W.B. ENTRANCE RAMP
 AT LAWRENCE AVE.
 (SN: 016-0836)



CITY OF CHICAGO
COOK COUNTY
COORDINATES: 41.967984 N, -87.755196 W

LOCATION 29. PARTIAL DEPTH PARAPET REPAIR
REPLACE APPROXIMATELY 5 FT OF PARAPET
LOCATED AT I-90 W.B. ENTRANCE RAMP AT LAWRENCE AVE.

BILL OF MATERIALS

BAR	SIZE	LENGTH	SHAPE	QUANTITY
e(E)	#3	5'	—	8
CONCRETE REMOVAL			CU. YDS	0.85
REINFORCEMENT BARS EPOXY COATED			LBS	15
CONCRETE SUPERSTRUCTURE			CU. YDS	0.85
MECHANICAL SPLICERS			EACH	16
PROTECTIVE COAT			SQ. YDS	5.0
SAW CUT			FOOT	7.0
REMOVING AND RE-ERECTING EXISTING RAILING			FOOT	5.0

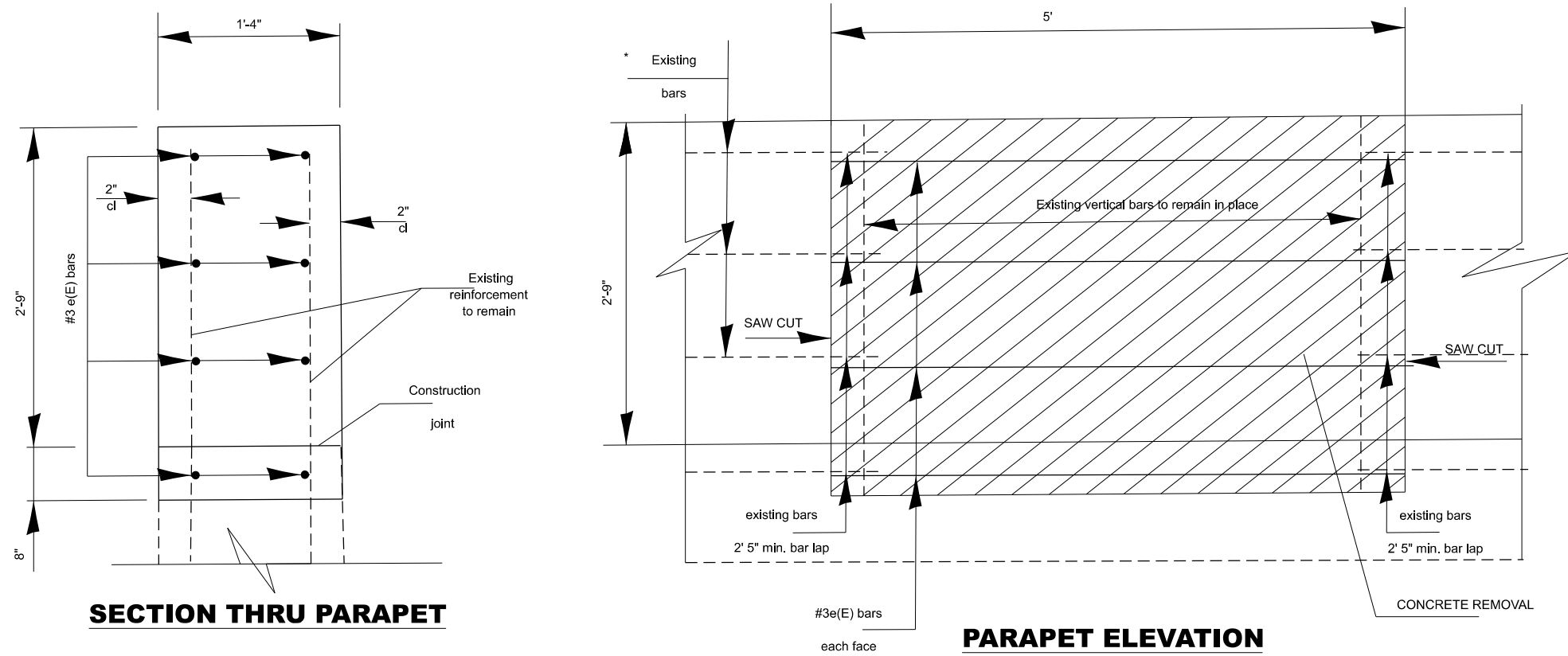

NOTE

- EXISTING REINFORCEMENT BARS EXTENDING INTO REMOVAL SHALL BE CLEANED, STRAIGHTENED AND INCORPORATED INTO THE NEW CONSTRUCTION. EXCEPT OTHERWISE NOTED, ANY REINFORCEMENT BARS THAT ARE DAMAGED OR DAMAGED DURING CONCRETE REMOVAL SHALL BE REPLACED WITH AN APPROVED BAR SPLICER OR ANCHORAGE SYSTEM. COST INCLUDED WITH CONCRETE REMOVAL.
 - ALL REINFORCEMENT BARS SHALL BE CUT IN FIELD TO FIT EXISTING SHAPE AND CLEARANCE.
 - IN LIEU OF THE CAST-IN-PLACE ANCHOR DEVICE SHOWN, THE CONTRACTOR HAS THE OPTION OF DRILLING AND SETTING STAINLESS STEEL ANCHOR RODS OF THE SAME DIAMETER AND GRADE AS THE SPECIFIED CAP SCREWS ACCORDING TO ARTICLE 50 9.06 OF THE STANDARD SPECIFICATIONS. EMBEDMENT SHALL BE ACCORDING TO THE MANUFACTURER'S SPECIFICATIONS.
- ★ BARS MUST BE LAPPED MINIMUM AS CALLED FOR IN BRIDGE MANUAL ON PAGE 880 FOR THE "CLASS B BASIC LAP" LENGTH CORRESPONDING TO THE REBAR SPACING FOR THE REBAR SIZE'S CLEARANCE.

MODEL: Location 29 (Sheet)
 FILE NAME: c:\pwworking\hassan\0909294\11623-shh-Details.dgn

USER NAME = naveed.hassan	DESIGNED -	REVISED -
	DRAWN -	REVISED -
	CHECKED -	REVISED -
PLOT DATE = 4/2/2024	DATE -	REVISED -

STATE OF ILLINOIS
DEPARTMENT OF TRANSPORTATION

LOCATION 29 (SN: 016-0836)
I-90 W.B. ENTRANCE RAMP AT LAWRENCE AVE.

SCALE: SHEET OF 3 SHEETS STA. TO STA.

F.A. RTE.	SECTION	COUNTY	TOTAL SHEETS	SHEET NO.
VAR	2023 VAR BARRIER/SOUND WA	VARIOUS	70	42
			CONTRACT NO. 62V18	
ILLINOIS FED. AID PROJECT				

REVISED SHEET 4/3/2024