

STATE OF ILLINOIS
DEPARTMENT OF TRANSPORTATION

F.A.P. RTE.	SECTION	COUNTY	TOTAL SHEETS	SHEET NO.
304	100B-BDS-4	MADISON	13	1
		ILLINOIS	CONTRACT NO. 76R12	

FOR INDEX OF SHEETS, SEE SHEET NO. 2

FAP ROUTE 304 (US 67) ADT

2024 = 22,100 (ESTIMATED)
SU = 1.9% MU = 1.3%

FUNCTIONAL CLASSIFICATION:
EXPRESSWAY

PROPOSED
HIGHWAY PLANS

FAP ROUTE 304 (US 67)
SECTION 100B-BDS-4
PROJECT NHPP-ZVCL(114)
BRIDGE DECK SEAL
MADISON COUNTY

C-98-097-22

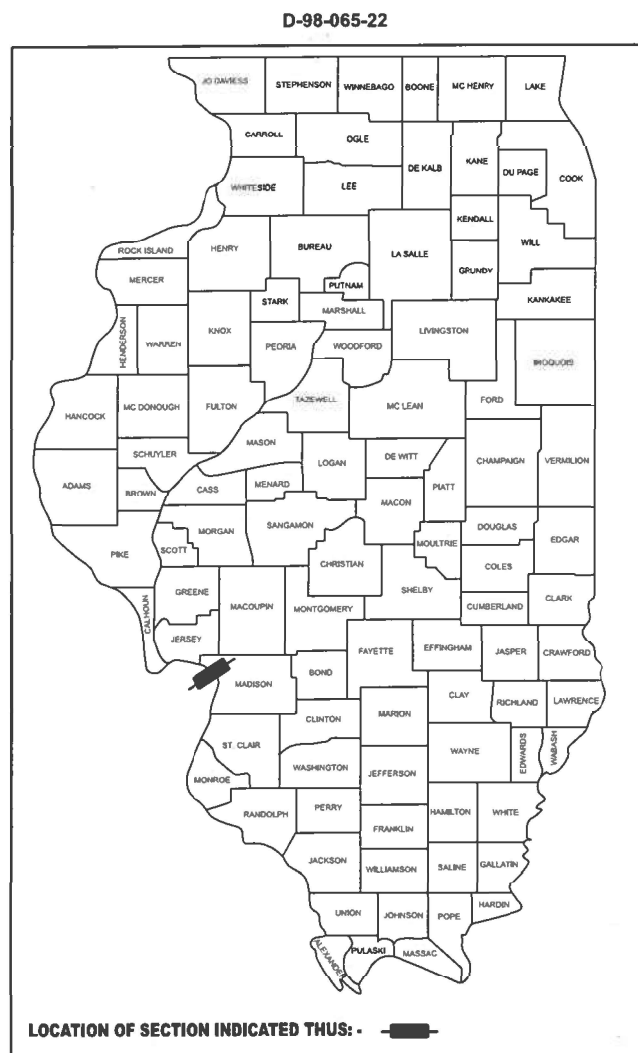

BEGIN PROJECT
US 67 AT
SN 060-0255
STA. 208+35
LAT: 38.87936 'N
LONG: 90.18440 'W

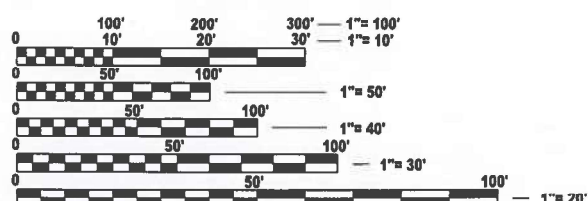
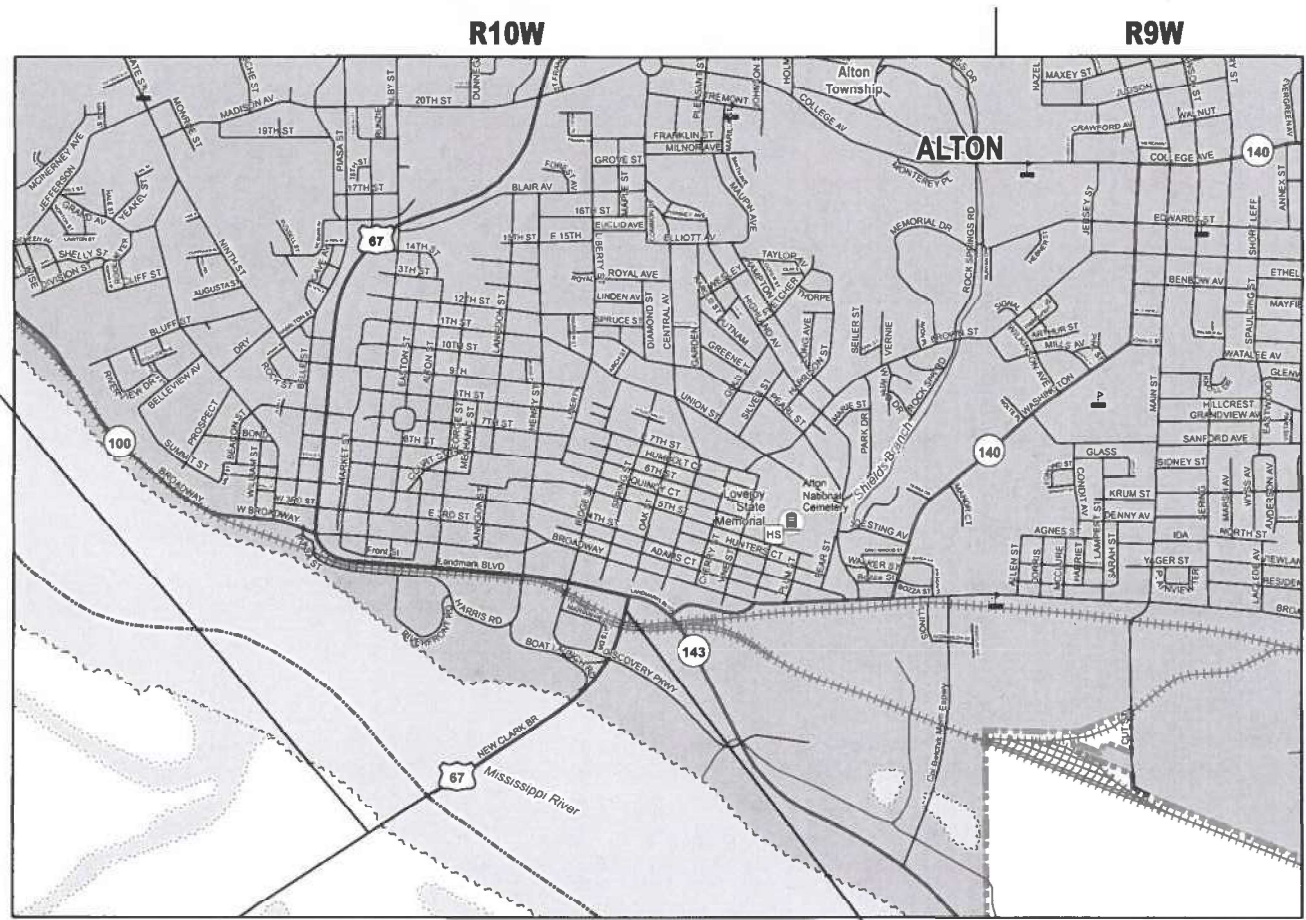

FULL SIZE PLANS HAVE BEEN PREPARED USING STANDARD ENGINEERING SCALES. REDUCED SIZED PLANS WILL NOT CONFORM TO STANDARD SCALES. IN MAKING MEASUREMENTS ON REDUCED PLANS, THE ABOVE SCALES MAY BE USED.

J.U.L.I.E.
JOINT UTILITY LOCATION INFORMATION FOR EXCAVATION
1-800-892-0123
OR 811

PROJECT ENGINEER: BILLIE OWEN
PROJECT MANAGER: BRANDON HUMPHREYS

CONTRACT NO. 76R12

GROSS LENGTH = 4,620.00 FT. = 0.875 MILE
NET LENGTH = 4,620.00 FT. = 0.875 MILE

END PROJECT
US 67 AT
SN 060-0255
STA. 254+55
LAT: 38.88748 'N
LONG: 90.17259 'W

STATE OF ILLINOIS
DEPARTMENT OF TRANSPORTATION

SUBMITTED January 26 20 24
Keith H. Browning
REGIONAL ENGINEER

March 22, 2024
John A. Etk
ENGINEER OF DESIGN AND ENVIRONMENT

March 22, 2024
Stephen McNeill
DIRECTOR OF HIGHWAYS PROJECT IMPLEMENTATION

PRINTED BY THE AUTHORITY
OF THE STATE OF ILLINOIS

INDEX OF SHEETS

1. COVER SHEET
2. INDEX OF SHEETS, HIGHWAY STANDARDS, GENERAL NOTES, COMMITMENTS, & PERTINENT INFORMATION
3. SUMMARY OF QUANTITIES
- 4-5. TYPICAL SECTIONS
6. SCHEDULES OF QUANTITIES
- 7-10. PLAN SHEETS
11. DETAIL SHEET
12. BIKE LANE CLOSURE SIGNING PLAN
13. TRAFFIC CONTROL AND PROTECTION, (SPECIAL)

HIGHWAY STANDARDS

- 000001-08 STANDARD SYMBOLS, ABBREVIATIONS, AND PATTERNS
 001006 DECIMAL OF AN INCH AND OF A FOOT
 701422-10 LANE CLOSURE, MULTILANE, FOR SPEEDS ≥ 45 MPH TO 55 MPH
 701901-09 TRAFFIC CONTROL DEVICES

GENERAL NOTES

1. THE UTILITIES KNOWN TO HAVE FACILITIES WITHIN THE PROJECT AREA ARE AS FOLLOWS:
 - CITY OF ALTON - SANITARY SEWER
 - CITY OF ALTON - LIGHTING
 - AT&T ILLINOIS
 - WOOD RIVER DRAINAGE & LEVEE DISTRICT
2. NO SURVEY WAS PERFORMED FOR THIS PROJECT AND THE PLANS WERE CREATED USING MICROFILM AND FIELD MEASUREMENTS.
3. FOUR CHANGEABLE MESSAGE SIGNS SHALL BE REQUIRED FOR THIS PROJECT. THEY SHALL BE PLACED TWO WEEKS PRIOR TO ANY LANE CLOSURE. THE CHANGEABLE MESSAGE BOARDS SHALL BE PLACED ACCORDING TO THE TRAFFIC CONTROL AND PROTECTION, (SPECIAL) SHEET, AND AT THE DIRECTION OF THE ENGINEER.
4. THE DEPARTMENT STRONGLY ENCOURAGES THE PRIME CONTRACTOR AND THEIR APPROVED SUB-CONTRACTORS TO HIRE MINORITY, WOMEN AND DISADVANTAGED INDIVIDUALS FROM ITS FEDERALLY FUNDED HIGHWAY CONSTRUCTION CAREERS TRAINING PROGRAM (HCCTP) TO HELP MEET WORKFORCE AND TRAINEE GOALS. THIS PROGRAM IS TRAINING MINORITIES, WOMEN, AND DISADVANTAGED INDIVIDUALS IN HIGHWAY CONSTRUCTION-RELATED SKILLS, E.G., MATH FOR THE TRADES, JOB READINESS, TECHNICAL SKILLS COURSEWORK (CARPENTRY, CONCRETE FLATWORK, BLUEPRINT READING, SITE PLANS, SITE WORK, TOOLS USE, ETC.) AND OSHA 10 HOUR CERTIFICATION, TO PREPARE THEM FOR A CAREER IN THE HIGHWAY CONSTRUCTION TRADES. GRADUATES ARE WELL-TRAINED AND READY TO BECOME PRODUCTIVE ENTRY-LEVEL CONSTRUCTION WORKERS. CONTACT THE DISTRICT 8 EEO OFFICE AT 618-346-3360 AND/OR THE HCCTP COORDINATOR AT 618-874-6528 TO LEARN MORE ABOUT THE PROGRAM AND FOR ASSISTANCE IN MEETING WORKFORCE AND TRAINEE GOALS.

COMMITMENTS

NONE

PERTINENT INFORMATION

1. SIGNAGE SHALL BE PLACED AT THE BICYCLE TRAIL ON BOTH SIDES OF THE BRIDGE THAT THE BICYCLE TRAIL/ACCOMODATION IS CLOSED DURING CONSTRUCTION.

THE CONTRACTOR SHALL NOTIFY THE FOLLOWING AGENCIES AT LEAST (TWO) 2 WEEKS PRIOR TO PROCEEDING WITH THE WORK:

- DISTRICT 8 TRAFFIC MANAGEMENT CENTER, (618) 346-3233
- GREAT RIVERS GREENWAY, (314) 436-7009
- MADISON COUNTY 911 EMERGENCY TELEPHONE SYSTEM BOARD, (618) 296-5911
- MADISON COUNTY TRANSIT DISTRICT, (618) 797-4600, FAX (618) 797-7547
- METRO EAST PARK AND RECREATION DISTRICT, (618) 346-4905
- MISSOURI DEPARTMENT OF TRANSPORTATION, (314) 453-1749
ATTN: TABITHA LOCKE
- RIDE ILLINOIS, (630) 216-9282
- TRAILNET, (314) 455-6329

MODEL: General Notes Sheet [Sheet]
FILE NAME: c:\pwworking\dwidob\humpreys\bd40838702\08706512-sth-gemnote.dgn

USER NAME = Brandon.Humphreys	DESIGNED -	REVISED -	STATE OF ILLINOIS DEPARTMENT OF TRANSPORTATION	INDEX OF SHEETS, HIGHWAY STANDARDS, GENERAL NOTES, COMMITMENTS, & PERTINENT INFORMATION	F.A.P. RTE. 304	SECTION 100B-BDS-4	COUNTY MADISON	TOTAL SHEETS 13	SHEET NO. 2	
PLOT SCALE = 0.16666633' / in.	CHECKED -	REVISED -			CONTRACT NO. 76R12					
PLOT DATE = 09/15/2023	DATE -	REVISED -			ILLINOIS FED. AID PROJECT					
					SCALE: 1" = 50'	SHEET 1	OF 1	SHEETS	STA.	TO STA.

MODEL: Summary of Quantities 1 (Sheet)
 FILE NAME: c:\pw_work\rev\tdh\humpreys\40838702\0876512-sth-SOO.dgn

CODE NO.	ITEM	UNIT	TOTAL QUANTITY	CONSTRUCTION CODE	
				80% FEDERAL	100% MISSOURI
				20% STATE	BRIDGE
				BRIDGE	BRIDGE
				0047	0047
				060-0255	060-0255
67100100	MOBILIZATION	L SUM	1	0.5	0.5
70100320	TRAFFIC CONTROL AND PROTECTION, STANDARD 701422	L SUM	1	0.5	0.5
70107025	CHANGEABLE MESSAGE SIGN	CAL DA	72	36	36
70200100	NIGHTTIME WORK ZONE LIGHTING	L SUM	1	0.5	0.5
X3000001	RRPM PROTECTION	EACH	118	59	59
X5870015	BRIDGE DECK CONCRETE SEALER	SQ FT	448381	224191	224190
X7010216	TRAFFIC CONTROL AND PROTECTION, (SPECIAL)	L SUM	1	0.5	0.5

USER NAME = Brandon.Humphreys	DESIGNED -	REVISED -
	DRAWN -	REVISED -
PLOT SCALE = \$\$SCALE\$	CHECKED -	REVISED -
PLOT DATE = 2/7/2024	DATE -	REVISED -

**STATE OF ILLINOIS
 DEPARTMENT OF TRANSPORTATION**

SUMMARY OF QUANTITIES

SCALE: 1" = 50' SHEET 1 OF 1 SHEETS STA. TO STA.

F.A.P. RTE.	SECTION	COUNTY	TOTAL SHEETS	SHEET NO.
304	100B-BDS-4	MADISON	13	3
CONTRACT NO. 76R12				
ILLINOIS FED. AID PROJECT				

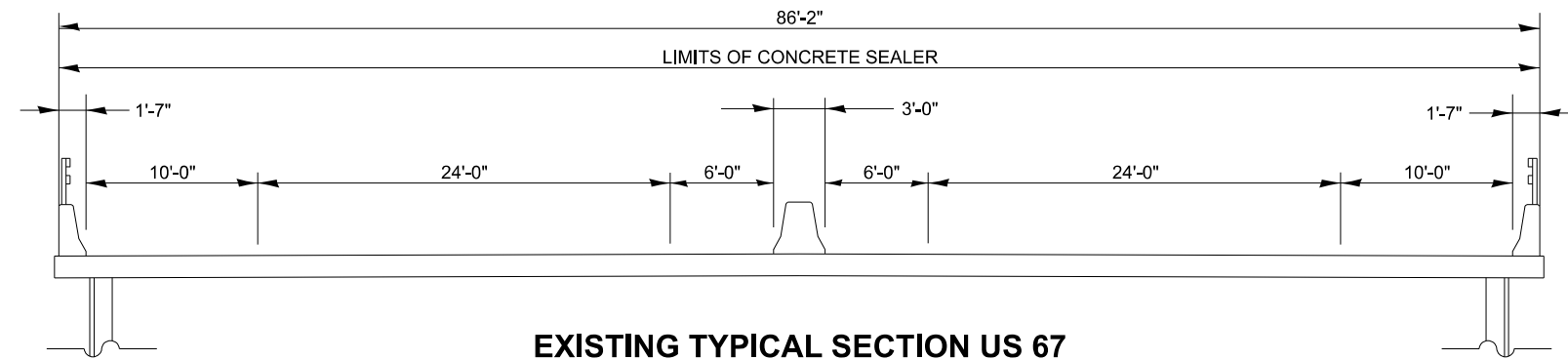

**EXISTING TYPICAL SECTION US 67
S.N. 060-0255 (CLARK BRIDGE)**

STA. 208+35.00 TO STA. 224+43.04
STA. 237+97.12 TO STA. 250+62.00

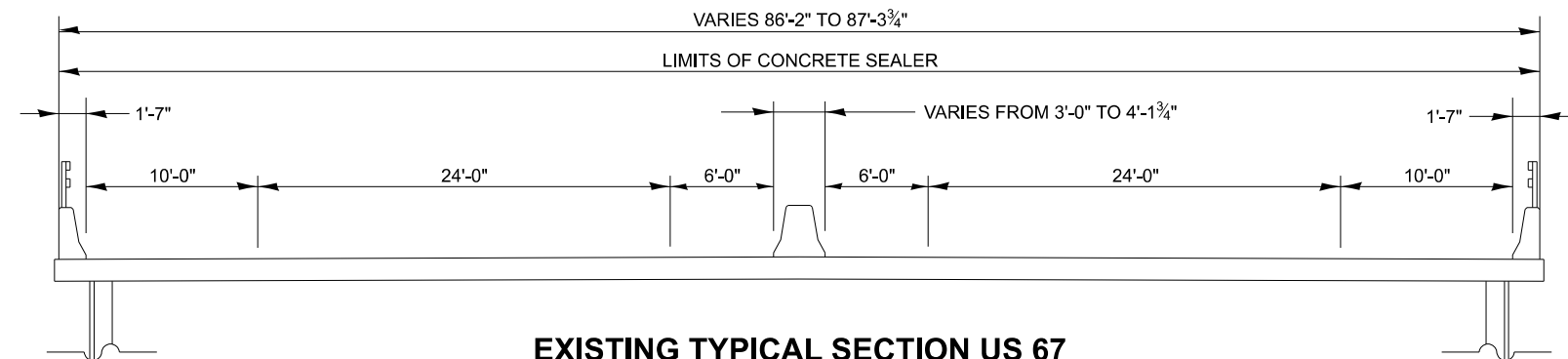

**EXISTING TYPICAL SECTION US 67
S.N. 060-0255 (CLARK BRIDGE)**

STA. 224+43.04 TO STA. 225+21.50
STA. 237+18.50 TO STA. 237+97.12

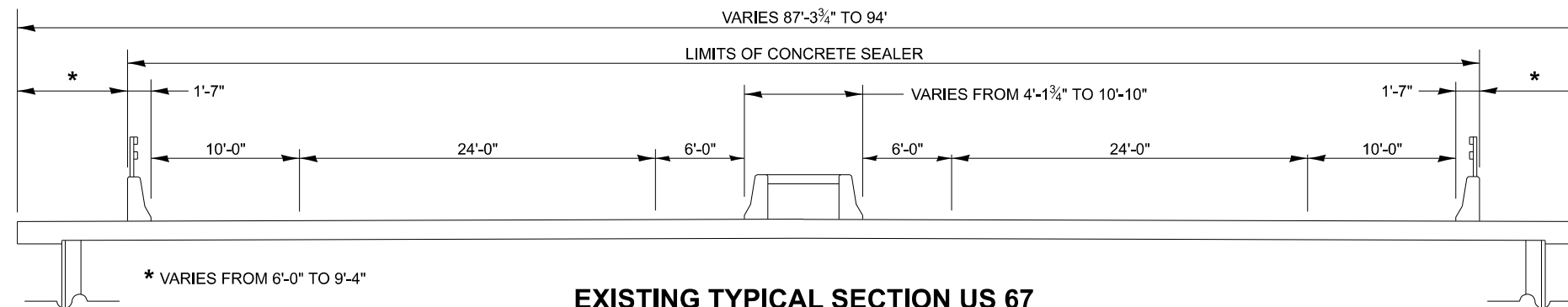

**EXISTING TYPICAL SECTION US 67
S.N. 060-0255 (CLARK BRIDGE)**

STA. 225+21.50 TO STA. 227+22.00
STA. 235+18.00 TO STA. 237+18.50

MODEL: Typical Section 1 (Sheet)
FILE NAME: c:\pwworkspace\brandon.humphreys\bd40838702\0870612-sh1-typical.dgn

USER NAME = Brandon.Humphreys	DESIGNED -	REVISED -
	DRAWN -	REVISED -
PLOT SCALE = 0.16666633' / in.	CHECKED -	REVISED -
PLOT DATE = 12/18/2023	DATE -	REVISED -

**STATE OF ILLINOIS
DEPARTMENT OF TRANSPORTATION**

EXISTING TYPICAL SECTIONS

SCALE: 1" = 50' SHEET 1 OF 2 SHEETS STA. 208+35.00 TO STA. 250+62.00

F.A.P. RTE.	SECTION	COUNTY	TOTAL SHEETS	SHEET NO.
304	100B-BDS-4	MADISON	13	4
CONTRACT NO. 76R12				
ILLINOIS FED. AID PROJECT				

BRIDGE DECK CONCRETE SEALER SCHEDULE								
STATIONING	DISTANCE	DECK AREA	OUTSIDE PARAPET AREA	INSIDE PARAPET AREA	INSIDE SOLID MEDIAN AREA	INSIDE 4" MEDIAN SURFACE AREA	RAISED CONCRETE MEDIAN AREA	PYLONS AREA
(FOOT)	(FOOT)	(SQ FT)	(SQ FT)	(SQ FT)	(SQ FT)	(SQ FT)	(SQ FT)	(SQ FT)
208+35 TO 224+43	1608	128640	12350		12077			
224+43 TO 225+22	79	6320	607		800			
225+22 TO 227+22	200	16000	1536	1470		932		
227+22 TO 235+18	796	63680	6114	5851		6368		1120
235+18 TO 237+19	201	16080	1544	1478		936		
237+19 TO 237+97	78	6240	600		790			
237+97 TO 250+65	1268	101440	9739		9523			
250+65 TO 254+55	390	31200	2996				1950	
SUBTOTALS	4620	369600	35486	8799	23190	8236	1950	1120
TOTALS					448381			

MODEL: Schedules_1 [Sheet]
FILE NAME: c:\p\work\brandon.humphreys\brandon.humphreys\brandon.humphreys\12-sft-schedule.dgn

USER NAME = Brandon.Humphreys	DESIGNED -	REVISED -
	DRAWN -	REVISED -
PLOT SCALE = 0.16666633' / in.	CHECKED -	REVISED -
PLOT DATE = 1/9/2024	DATE -	REVISED -

**STATE OF ILLINOIS
DEPARTMENT OF TRANSPORTATION**

SCHEDULES OF QUANTITIES

SCALE: SHEET 1 OF 1 SHEETS STA. TO STA.

F.A.P. RTE.	SECTION	COUNTY	TOTAL SHEETS	SHEET NO.
304	100B-BDS-4	MADISON	13	6
ILLINOIS FED. AID PROJECT			CONTRACT NO. 76R12	

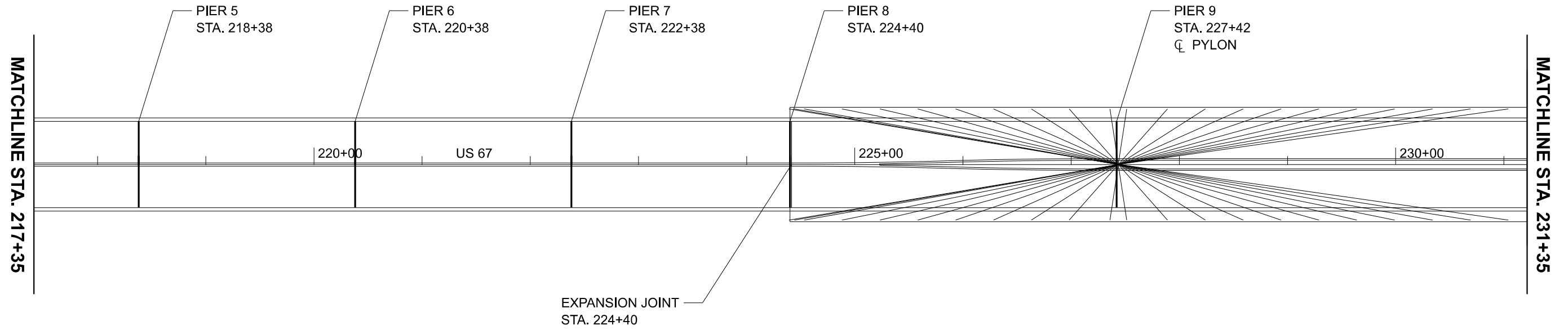
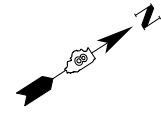

MODEL: Plan Sheets 2 (Sheet)
 FILE NAME: c:\pw\work\wisdot\humphreys\bd40838702\0870612-sth-plan.dgn

USER NAME = Brandon.Humphreys	DESIGNED -	REVISED -
	DRAWN -	REVISED -
PLOT SCALE = 0.16666633' / in.	CHECKED -	REVISED -
PLOT DATE = 1/9/2024	DATE -	REVISED -

**STATE OF ILLINOIS
 DEPARTMENT OF TRANSPORTATION**

PLAN SHEETS

SCALE: 1" = 50' SHEET 2 OF 4 SHEETS STA. 217+35 TO STA. 231+35

F.A.P. RTE.	SECTION	COUNTY	TOTAL SHEETS	SHEET NO.
304	100B-BDS-4	MADISON	13	8
CONTRACT NO. 76R12				
ILLINOIS FED. AID PROJECT				

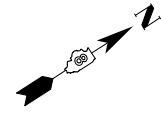

MATCHLINE STA. 231+35

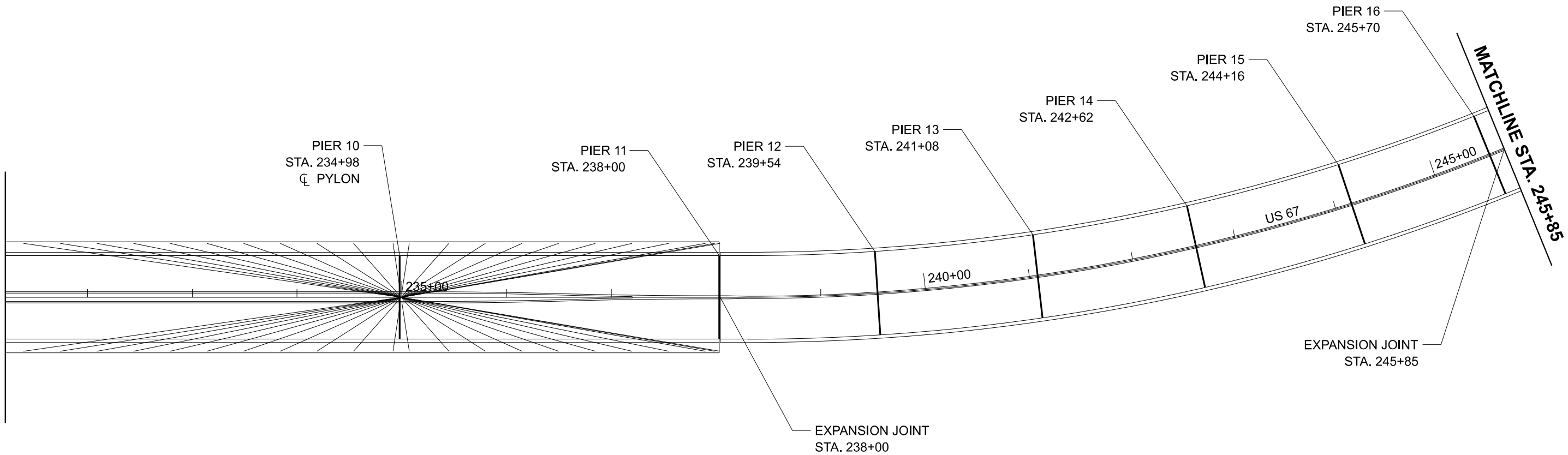

MODEL: Plan Sheets 3 (Sheet)
FILE NAME: c:\pwworking\brandon.humphreys\brandon.humphreys\d0838702\0876512-sth-plan.dgn

USER NAME = Brandon.Humphreys	DESIGNED -	REVISED -
	DRAWN -	REVISED -
PLOT SCALE = 0.16666633' / in.	CHECKED -	REVISED -
PLOT DATE = 1/9/2024	DATE -	REVISED -

**STATE OF ILLINOIS
DEPARTMENT OF TRANSPORTATION**

PLAN SHEETS

SCALE: 1" = 50' SHEET 3 OF 4 SHEETS STA. 231+35 TO STA. 245+85

F.A.P. RTE.	SECTION	COUNTY	TOTAL SHEETS	SHEET NO.
304	100B-BDS-4	MADISON	13	9
CONTRACT NO. 76R12				
ILLINOIS FED. AID PROJECT				

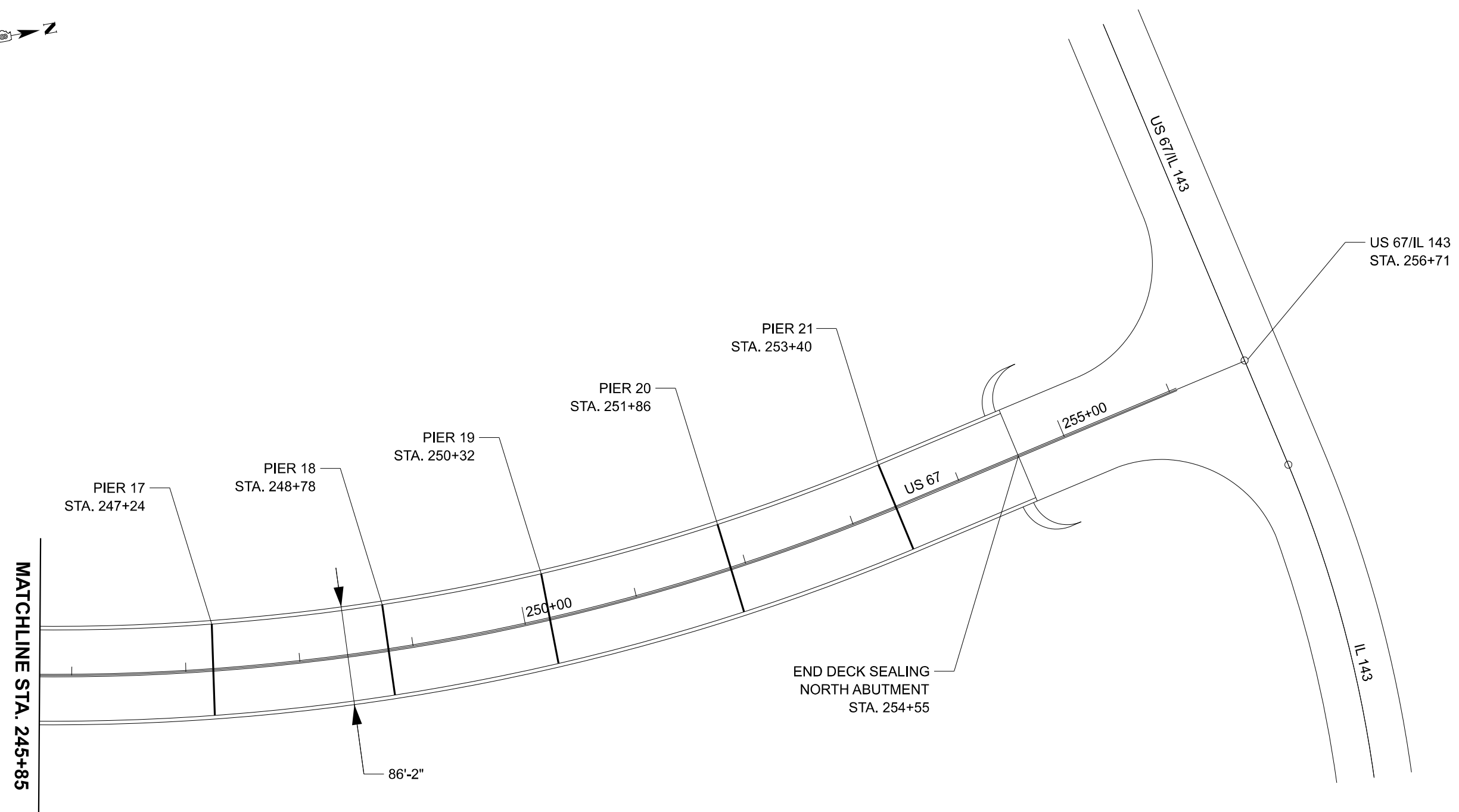
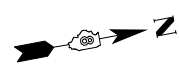

MODEL: Plan Sheets 4 (Sheet)
 FILE NAME: c:\p\work\p\wisid\humpreys\bd40838702\0876512-stl-plan.dgn

USER NAME = Brandon.Humphreys	DESIGNED -	REVISED -
	DRAWN -	REVISED -
PLOT SCALE = 0.16666633' / in.	CHECKED -	REVISED -
PLOT DATE = 1/9/2024	DATE -	REVISED -

**STATE OF ILLINOIS
 DEPARTMENT OF TRANSPORTATION**

PLAN SHEETS			
SCALE: 1" = 50'	SHEET 4	OF 4 SHEETS	STA. 245+85 TO STA. 254+55

F.A.P. RTE. 304	SECTION 100B-BDS-4	COUNTY MADISON	TOTAL SHEETS 13	SHEET NO. 10
ILLINOIS FED. AID PROJECT				

CONTRACT NO. 76R12

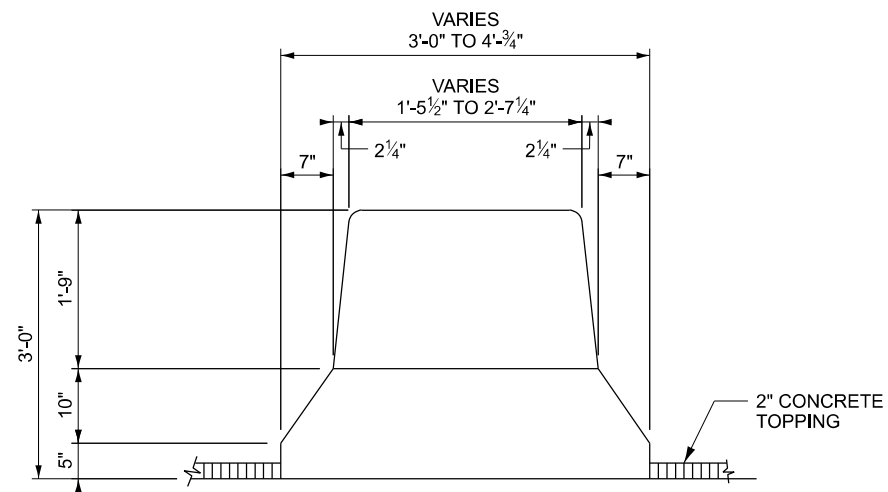

DETAIL A
SOLID MEDIAN

STA. 224+43.04 TO STA. 225+21.50
STA. 237+18.50 TO STA. 237+97.12

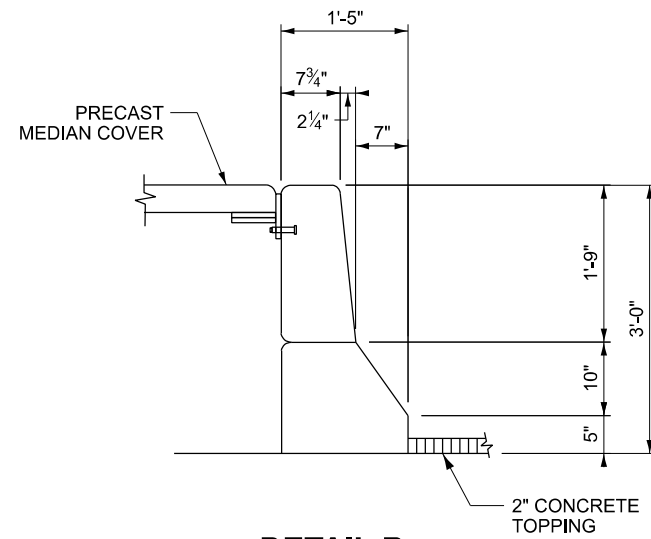

DETAIL B
INSIDE PARAPET

STA. 225+21.50 TO STA. 237+18.50

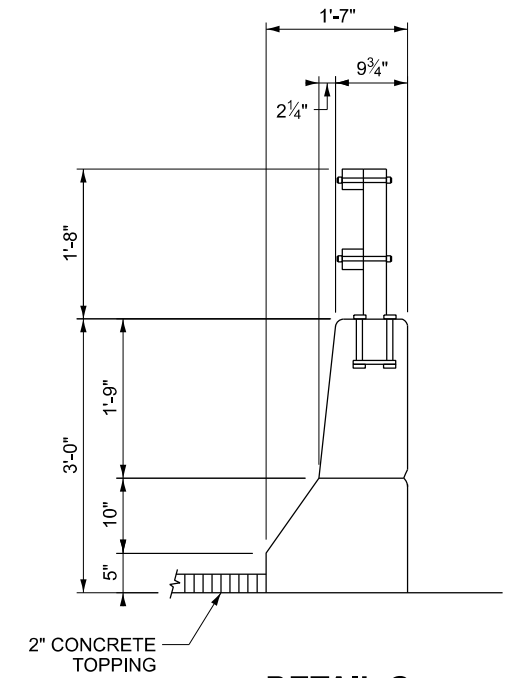

DETAIL C
OUTSIDE PARAPET

STA. 208+35.00 TO STA. 254+55.00

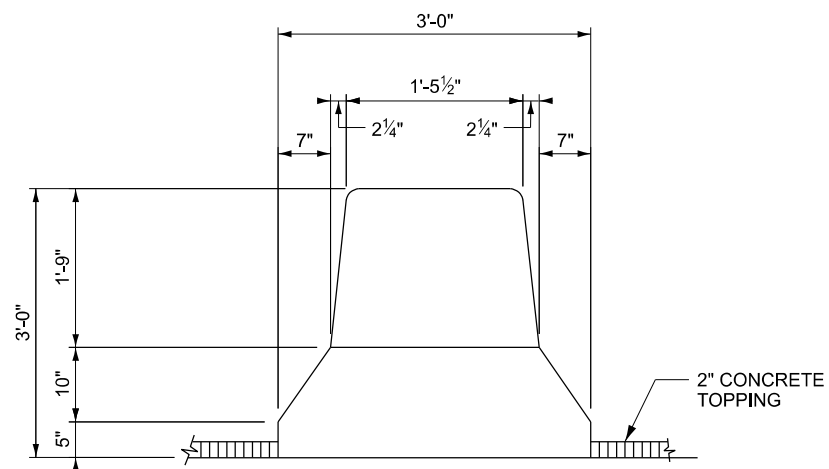

DETAIL D
SOLID MEDIAN

STA. 208+35.00 TO STA. 224+43.04
STA. 237+97.12 TO STA. 250+65.00

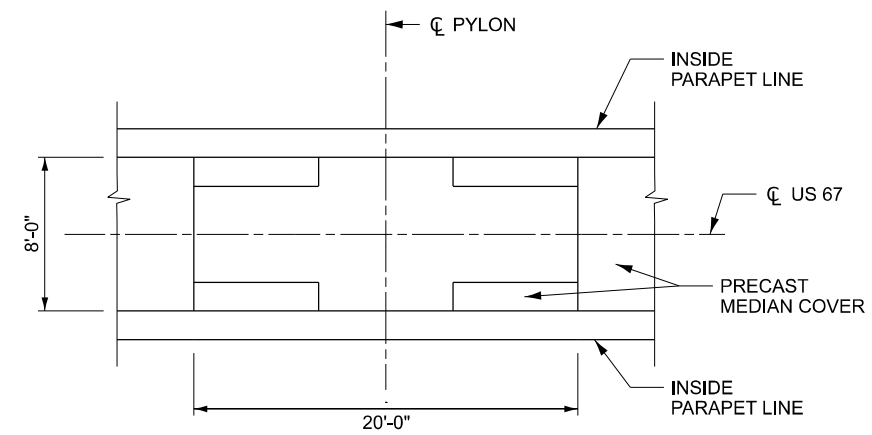

DETAIL E
PLAN VIEW OF PYLON

STA. 227+42.00
STA. 234+98.00

THE HEIGHT OF APPLICATION FOR THE PYLONS SHALL BE 10 FEET ABOVE THE PRECAST MEDIAN COVER SLAB ON ALL 4 FACES.

MODEL: Detail Sheet [Sheet]
FILE NAME: c:\p\work\revit\humpreys\bd40838702\0876512-sht-details.dgn

USER NAME = Brandon.Humphreys	DESIGNED -	REVISED -
	DRAWN -	REVISED -
PLOT SCALE = 0.16666633' / in.	CHECKED -	REVISED -
PLOT DATE = 1/3/2024	DATE -	REVISED -

STATE OF ILLINOIS
DEPARTMENT OF TRANSPORTATION

DETAIL SHEET

SCALE: SHEET 1 OF 1 SHEETS STA. TO STA.

F.A.P. RTE.	SECTION	COUNTY	TOTAL SHEETS	SHEET NO.
304	100B-BDS-4	MADISON	13	11
CONTRACT NO. 76R12				
ILLINOIS FED. AID PROJECT				

NOTES

- ① LOCATIONS OF MESSAGE BOARDS IN ILLINOIS TO BE COORDINATED WITH THE RESIDENT ENGINEER.
- ② LOCATION OF MESSAGE BOARD IN MISSOURI TO BE COORDINATED WITH THE RESIDENT ENGINEER AND BY THE MISSOURI DEPARTMENT OF TRANSPORTATION.
- ③ MESSAGE BOARDS SHALL BE ERECTED 2 WEEKS PRIOR TO START OF BRIDGE DECK SEALING AND WILL BE PAID FOR SEPARATELY.
- ④ THE MESSAGE BOARD SHALL BE USED TO DISPLAY STATUS OF LANES WITHIN THE PROJECT. THE PRIMARY MESSAGES SHALL BE:

PRIOR TO CONSTRUCTION

CLARK BRIDGE CONSTRUCTION	BEGIN XX/XX/XX
---------------------------------	-------------------

DURING CONSTRUCTION

CLARK BRIDGE	X LANE CLOSED
-----------------	---------------------

- ⑤ THREE, TYPE II BARRICADES, DRUMS, OR VERTICAL BARRICADES AT 50' CENTERS.
- ⑥ M5-1(O) MAY BE USED IN PLACE OF W1-6.

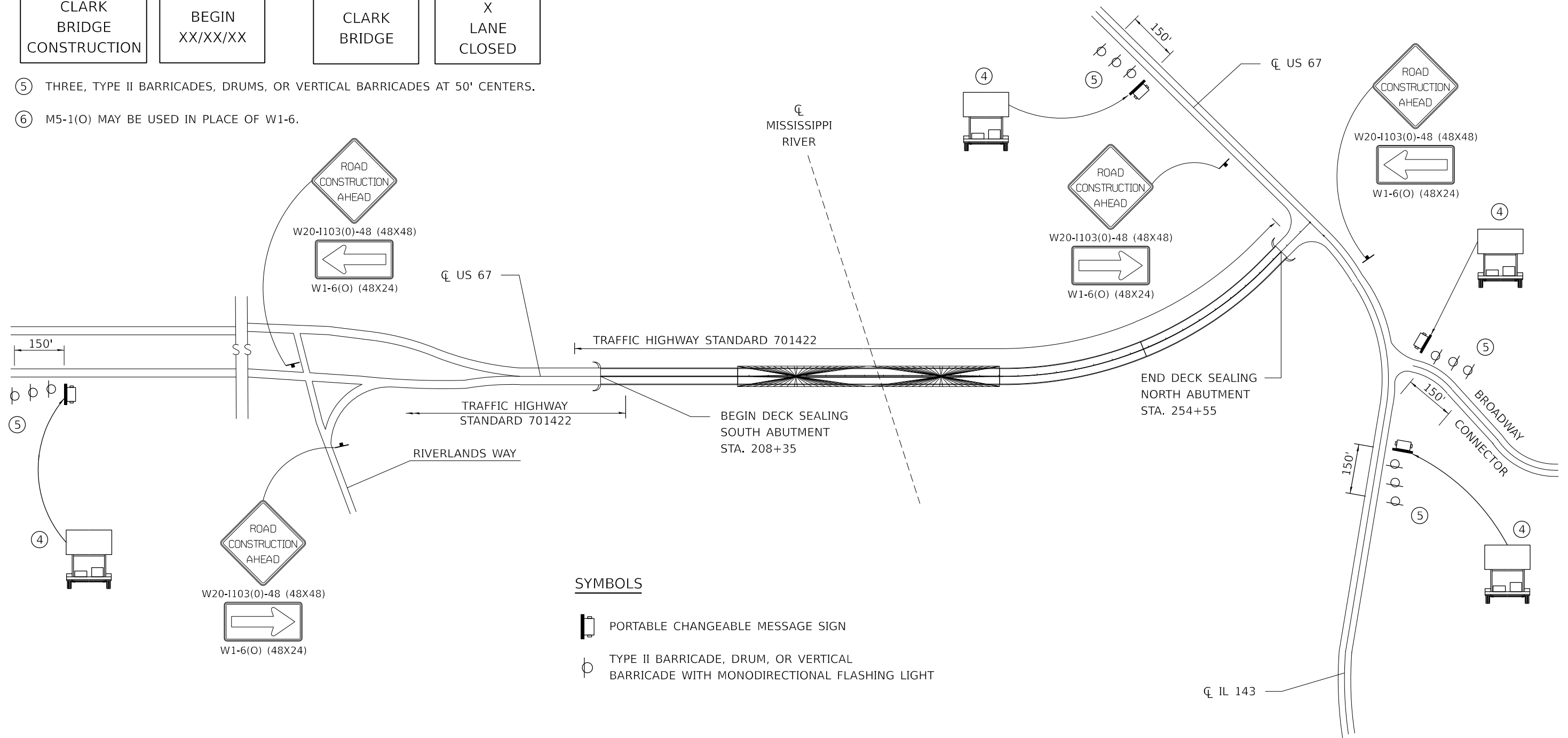

SYMBOLS

- PORTABLE CHANGEABLE MESSAGE SIGN
- TYPE II BARRICADE, DRUM, OR VERTICAL BARRICADE WITH MONODIRECTIONAL FLASHING LIGHT

MODEL: Traffic Control Sheet [Sheet]
FILE NAME: c:\pwwork\brandonh\humpreys\brandonh\12-shl-ctg.dgn

USER NAME = Brandon.Humphreys	DESIGNED -	REVISED -
PLOT SCALE = 0.16666633' / in.	DRAWN -	REVISED -
PLOT DATE = 1/9/2024	CHECKED -	REVISED -
	DATE -	REVISED -

**STATE OF ILLINOIS
DEPARTMENT OF TRANSPORTATION**

TRAFFIC CONTROL AND PROTECTION, (SPECIAL)

SCALE: N/A SHEET 1 OF 1 SHEETS STA. TO STA.

F.A.P. RTE. 304	SECTION 100B-BDS-4	COUNTY MADISON	TOTAL SHEETS 13	SHEET NO. 13
CONTRACT NO. 76R12				
ILLINOIS FED. AID PROJECT				