

F.A. RTE.	SECTION	COUNTY	TOTAL SHEETS	SHEET NO.
		POPE	16	8
STA.	TO STA.			
FED. ROAD DIST. NO.	ILLINOIS	FED. AID PROJECT		
IDNR PROJECT NO. 5-06-004				

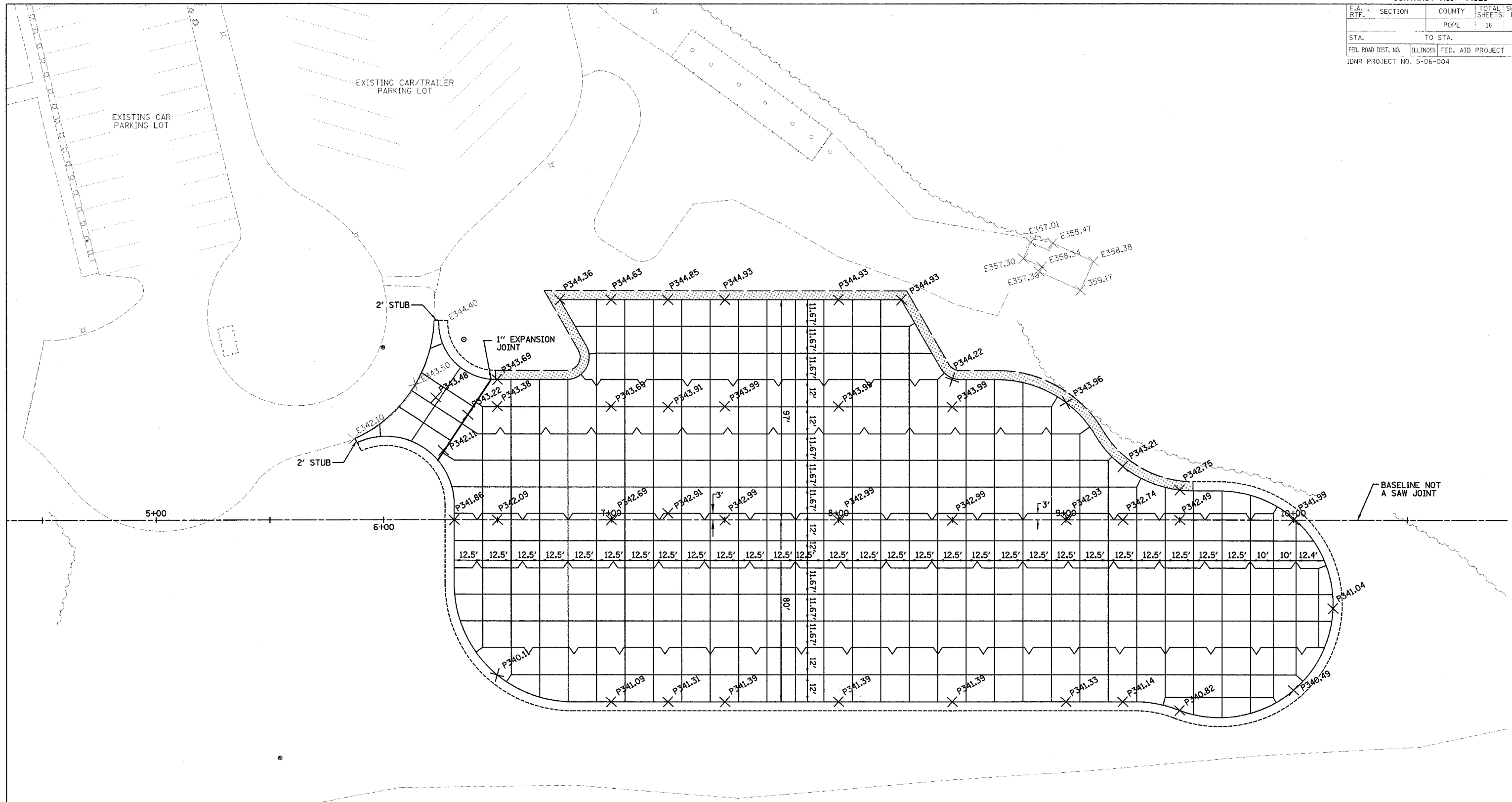

LEGEND

- E342.1 X EXISTING GROUND ELEVATION
- P340.95 X PROPOSED GROUND ELEVATION
- SAWED JOINT
- KEYED LONGITUDINAL CONSTRUCTION JOINT
- 1" EXPANSION JOINT

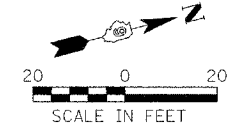

REVISIONS	
NAME	DATE

ILLINOIS DEPARTMENT OF TRANSPORTATION  
 PARKING LOT SAW JOINTS  
 & ELEVATION DETAIL  
 IDOT / IDNR  
 GOLCONDA MARINA RECREATION AREA

SCALE: VERT. DATE: 8/17/06  
 HORIZ. DRAWN BY: MAL  
 CHECKED BY: RGD