

F.A.P. RTE.	SECTION	COUNTY	TOTAL SHEETS	SHEET NO.
344	2005-059 TS	LAKE	12	12
STA.		TO STA.		
FED. ROAD DIST. NO.	ILLINOIS FED. AID PROJECT			

CONTRACT NO. 60A45

INTERCONNECT SCHEMATIC LEGEND

EXISTING INTERSECTION CONTROLLER	
PROPOSED INTERSECTION CONTROLLER	
EXISTING MASTER CONTROLLER	
PROPOSED MASTER CONTROLLER	
MASTER MASTER CONTROLLER	
EXISTING INTERSECTION & SAMPLING (SYSTEM) DETECTORS	
PROPOSED INTERSECTION & SAMPLING (SYSTEM) DETECTORS	
EXISTING INTERSECTION LOOP DETECTORS	
PROPOSED SAMPLING (SYSTEM) DETECTORS	
EXISTING SAMPLING (SYSTEM) DETECTORS	
PROPOSED SAMPLING (SYSTEM) DETECTORS	
EXISTING SAMPLING (SYSTEM) DETECTORS, PROPOSED INTERSECTION AND SAMPLING (SYSTEM) DETECTORS.	
EXISTING SAMPLING (SYSTEM) DETECTORS, PROPOSED SAMPLING (SYSTEM) DETECTORS.	
EXISTING PREFORMED INTERSECTION & SAMPLING (SYSTEM) DETECTORS	
PROPOSED PREFORMED INTERSECTION & SAMPLING (SYSTEM) DETECTORS	
EXISTING SAMPLING (SYSTEM) PREFORMED DETECTORS	
PROPOSED SAMPLING (SYSTEM) PREFORMED DETECTORS	
EXISTING FIBER OPTIC CABLE IN CONDUIT, NO. 62.5/125, MM12F SMI2F	
PROPOSED FIBER OPTIC CABLE IN CONDUIT, NO. 62.5/125, MM12F SMI2F	
EXISTING INTERCONNECT CABLE - NO. 62.5/125 12F FIBER OPTIC CABLE	
PROPOSED INTERCONNECT CABLE - NO. 62.5/125 12F FIBER OPTIC CABLE	
EXISTING INTERCONNECT CABLE - NO. 18 3 PAIR TWISTED, SHIELDED	
PROPOSED INTERCONNECT CABLE - NO. 18 3 PAIR TWISTED, SHIELDED	
EXISTING LOOP DETECTOR CABLE 2/C TWISTED, SHIELDED	
PROPOSED LOOP DETECTOR CABLE 2/C TWISTED, SHIELDED	
EXISTING ELECTRIC CABLE, 1/C (AS SPECIFIED)	
PROPOSED ELECTRIC CABLE, 1/C (AS SPECIFIED)	
EXISTING TELEPHONE CONNECTION	
PROPOSED TELEPHONE CONNECTION	
UNINTERRUPTIBLE POWER SUPPLY (U.P.S.)	

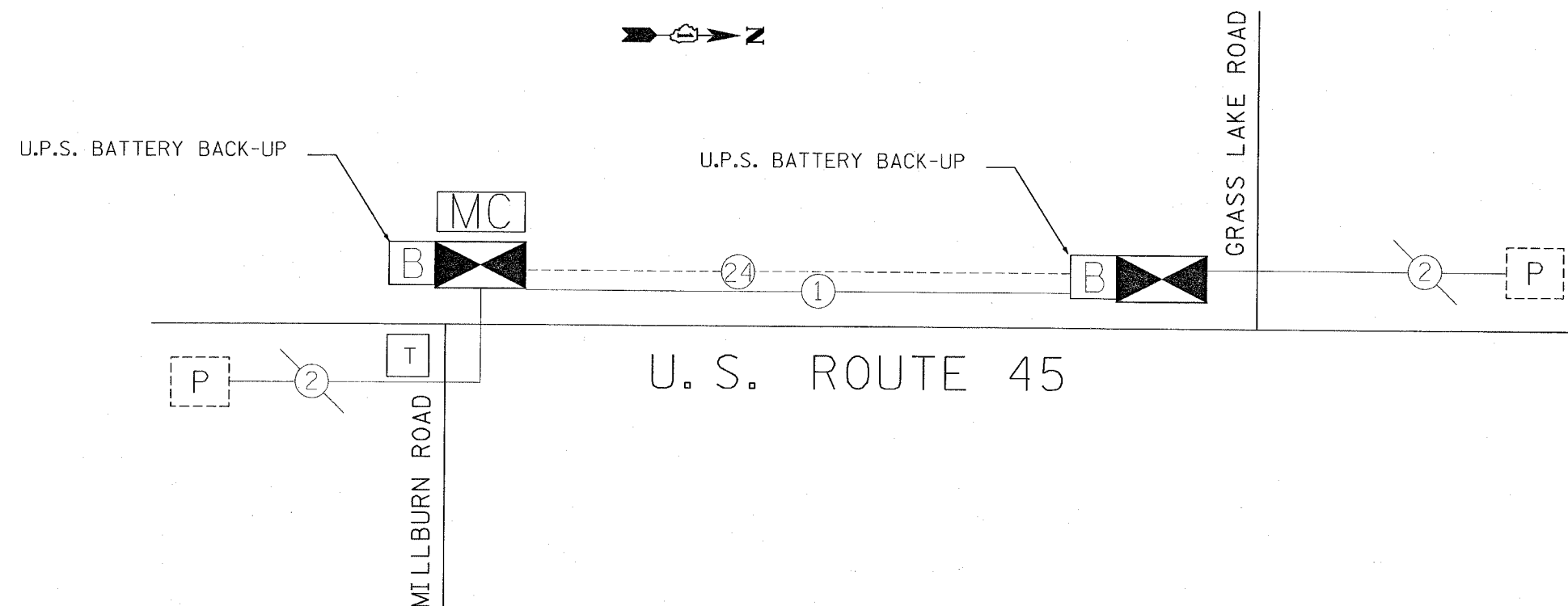

SCHEDULE OF QUANTITIES

ITEM	UNIT	QUANTITY
ENGINEER'S FIELD OFFICE, TYPE A	CAL MO	1
FIBER OPTIC CABLE IN CONDUIT, NO. 62.5/125 MM 12F & SM12F	FOOT	331
REMOVE ELECTRIC CABLE FROM CONDUIT	FOOT	300
ELECTRIC CABLE IN CONDUIT, TRACER NO.14 1C	FOOT	300
MASTER CONTROLLER	EACH	1
OPTIMIZE TRAFFIC SIGNAL SYSTEM	EACH	2

REVISIONS		ILLINOIS DEPARTMENT OF TRANSPORTATION INTERCONNECT SCHEMATIC U. S. ROUTE. 45 FROM GRASS LAKE ROAD TO MILLBURN ROAD SCALE: NONE DATE: 2/5/2007	DRAWN BY: SN DESIGNED BY: SN CHECKED BY: DAD
NAME	DATE		

11:07:37 02/05/2007