

F.A.P. RTE.	SECTION	COUNTY	TOTAL SHEETS	SHEET NO.
346	2005-058-TS	LAKE	23	19
STA.	TO STA.			
FED. ROAD DIST. NO.	BLINDS	FED. AID PROJECT		

CONTRACT# 60A47

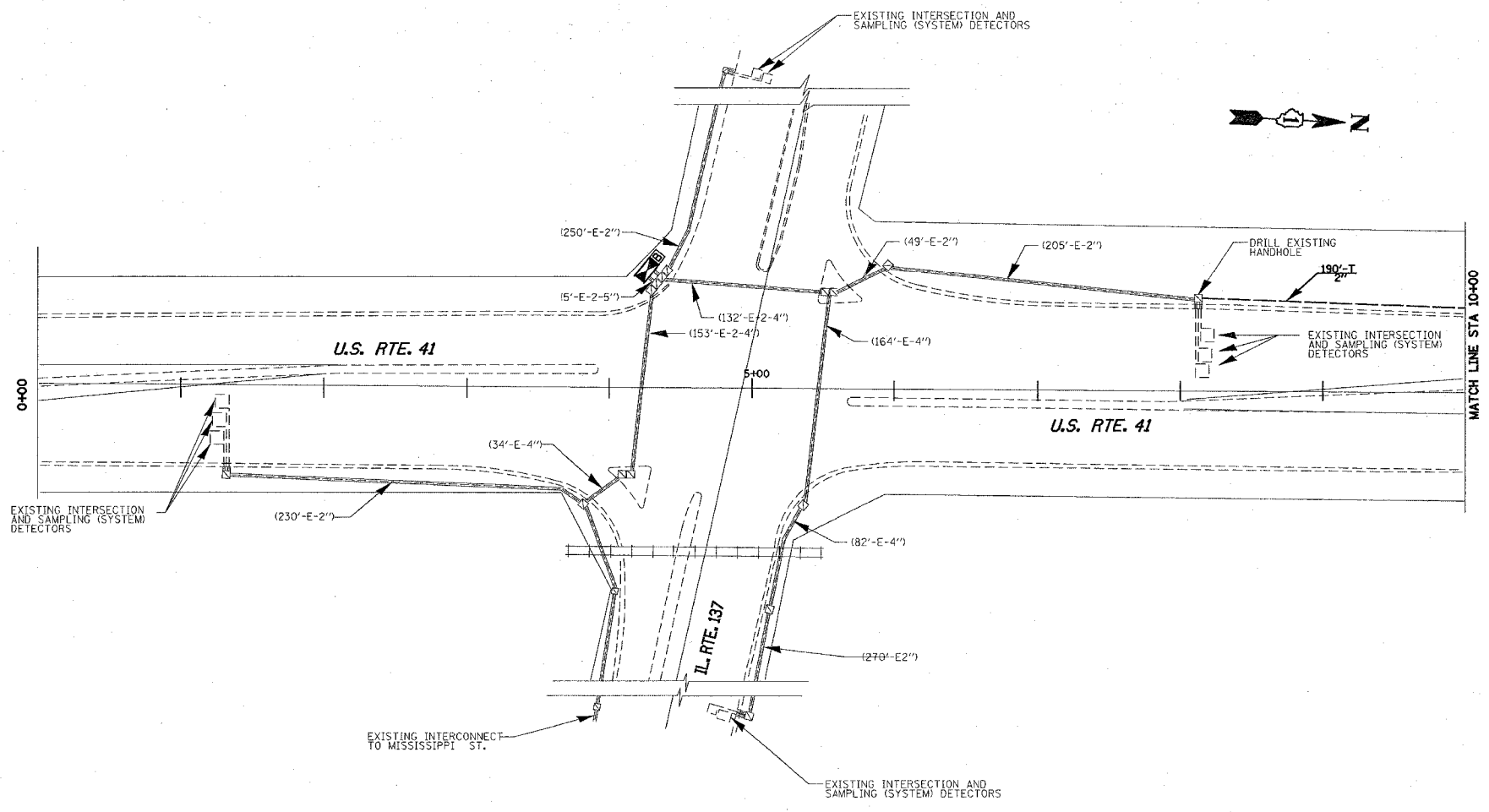

INTERCONNECT PLAN LEGEND

	PROPOSED	EXISTING
CONTROLLER	[Symbol]	[Symbol]
HANDHOLE	[Symbol]	[Symbol]
HEAVY DUTY HANDHOLE	[Symbol]	[Symbol]
DOUBLE HANDHOLE	[Symbol]	[Symbol]
G.S. CONDUIT IN TRENCH OR PUSHED	[Symbol]	[Symbol]
DETECTOR LOOP	[Symbol]	[Symbol]
SYSTEM	[Symbol]	[Symbol]
INTERSECTION	[Symbol]	[Symbol]
UNIT DUCT	[Symbol]	[Symbol]
COMMON TRENCH	[Symbol]	[Symbol]

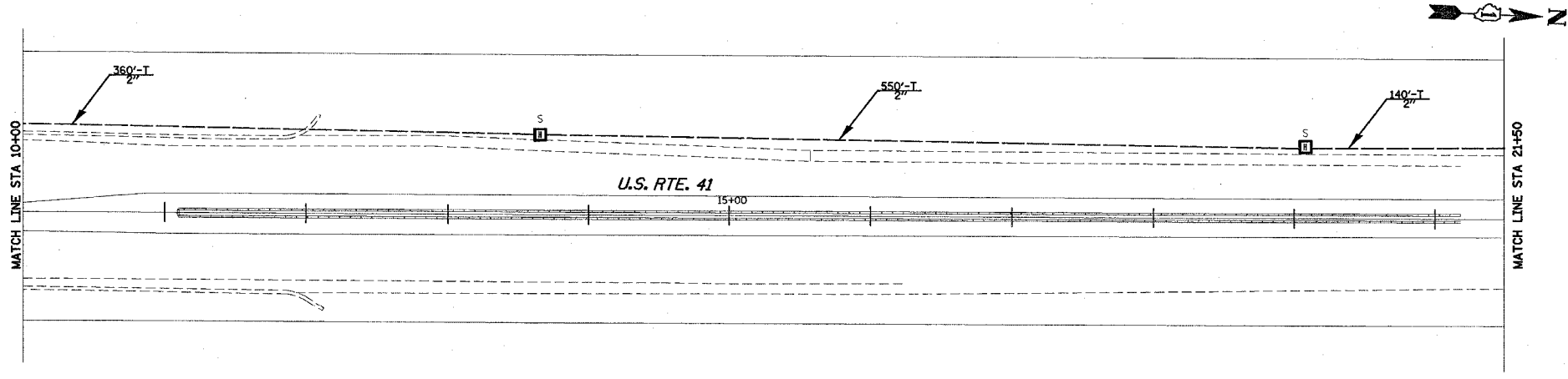

MORRIS ENGINEERING, INC.
 5100 S. LINCOLN AVE. (RTE. 53)
 LISLE, IL 60532-2119
 PHONE: 630-271-0770
 FAX: 630-271-0774

REVISIONS	
NAME	DATE

ILLINOIS DEPARTMENT OF TRANSPORTATION
INTERCONNECT PLAN
 U.S. RTE. 41 &
 IL. RTE. 137
 (SHEET 1 OF 4)
 SCALE: 1"=50'
 DATE: 1/31/07
 DRAWN BY: PRT
 DESIGNED BY: RKF
 CHECKED BY: JVV