

F.A.I. RTE.	SECTION	COUNTY	TOTAL SHEETS	SHEET NO.
80/94	2003-106LS	COOK	88	75
STA.	TO STA.			
FED. ROAD DIST. NO.	ILLINOIS	FED. AID PROJECT		
CONTRACT NO. 62699				

ALL DIMENSIONS IN METERS EXCEPT PAY ITEMS AND UNLESS NOTED OTHERWISE

VINE/PERENNIAL BED TREATMENT TYPE A - B - C (TYP)

V-PARTHEN QUINQ 1G (1 M / 3' O.C. ALONG WALL) - (20)

PERENNIAL PLANTS GAL POT (5 UNITS)

MULCH BED INC W/PAY ITEM

WEED CONT N SEL/N RES (20 SQ M)

SAND PLACEMENT (20 SQ M)

(SEE DETAIL PLANS & SCHEDULES LSM-28B)

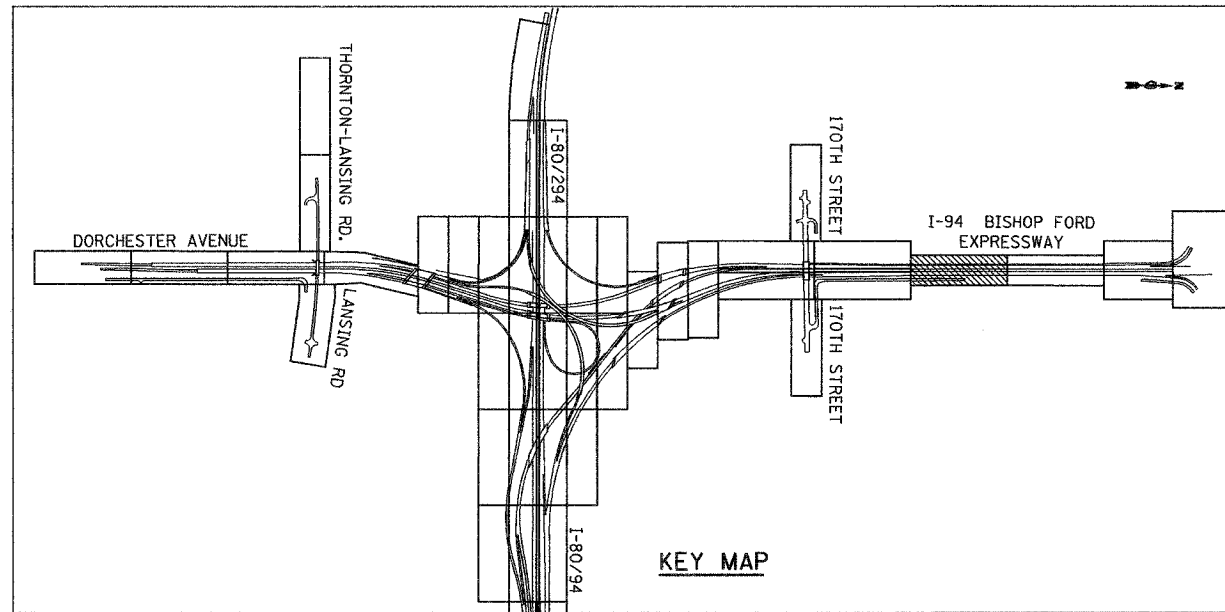
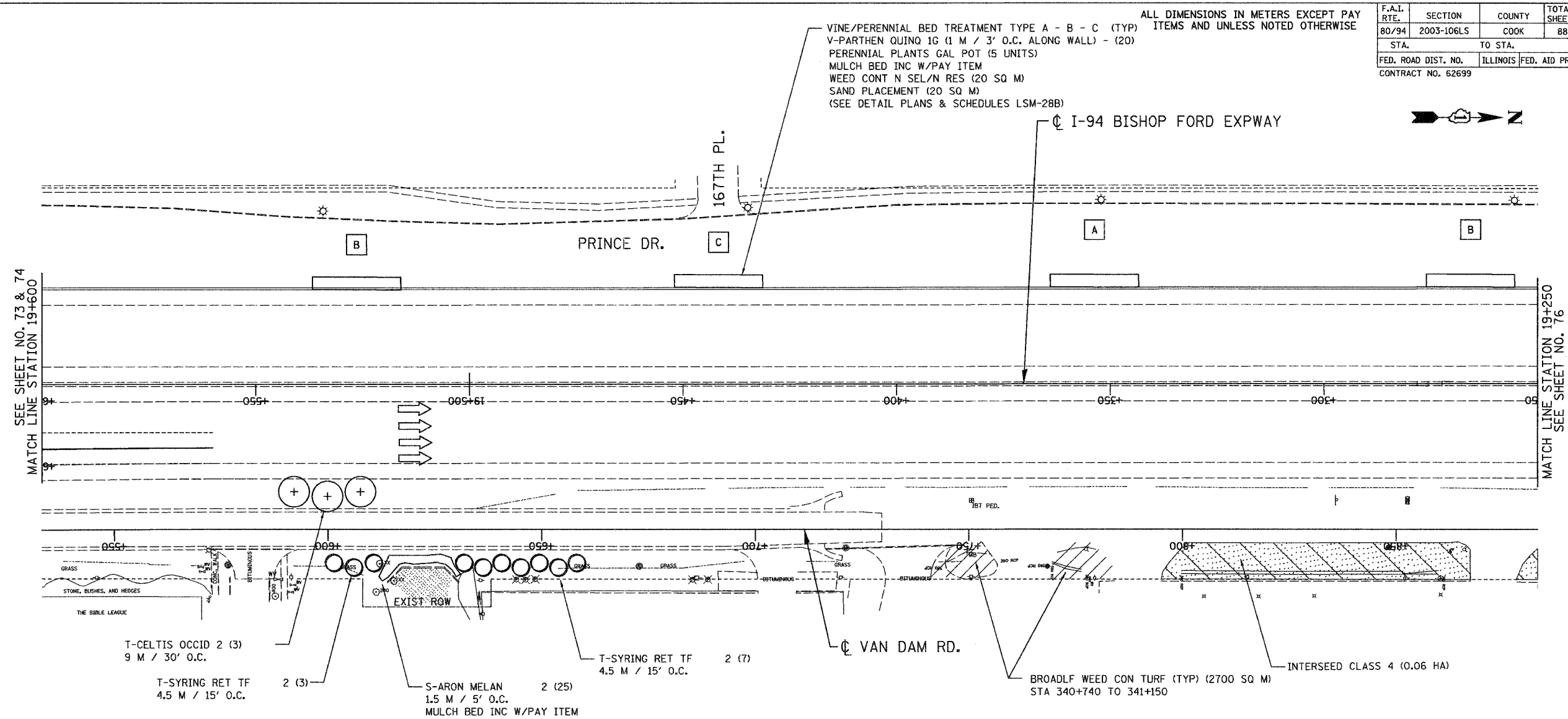

LSNS - 62

REVISIONS	
NAME	DATE

ILLINOIS DEPARTMENT OF TRANSPORTATION  
I-80/94/US 6  
KINGERY-BORMAN EXPRESSWAY  
BURNHAM ROAD TO US 41  
**LANDSCAPING PLAN**  
I-94 BISHOP FORD EXPWAY

SCALE 1:500  
DATE 12/13/06

DRAWN BY ACE/CAD  
CHECKED BY TJW

**AMERICAN**  
CONSULTING ENGINEERS

12/12/2006  
 3:07:14 PM  
 S:\Project\20140801\CADD\Contract US LS 62.rds